

# PHOENIX SUBDIVISION (0685)

| Radio Display:<br>Picacho to CP PX962 - 014-014 *65<br>CP PX962 to MP 802.8 - 045-045 *65 |              |                   |       |                              |                              |                            |       |      |
|---|--------------|-------------------|-------|------------------------------|------------------------------|----------------------------|-------|------|
| Mile Post   | Track Layout | Rule 6.3          | CP #s | WEST Stations/Control Points | EAST Stations/Control Points | Sta. #s<br>Siding Capacity |       |      |
| 979.7   |              | CTC               | SP937 | WEST PICACHO (0.4)           |                              |                            |       |      |
| 979.3   |              |                   | PX979 | PICACHO WYE (1.7)            | T                            |                            |       |      |
| 977.6   |              |                   | PX977 | CP PX977 (Hold) (15.2)       |                              |                            |       |      |
| 962.4   |              | TWC ABS           | PX962 | COOLIDGE (12.9)              |                              | LB377                      |       |      |
| 949.5   |              |                   |       | MAGMA (11.6)                 |                              | LB389                      |       |      |
| 948.3   |              |                   |       | GERMANN (26.0)               |                              | LB400                      | 8207  |      |
| 937.9   |              |                   |       | KENDALL (5.9)                |                              | LB427                      | 5383  |      |
| 936.2   |              |                   |       | PHOENIX (0.6)                |                              | BTY                        | LB432 |      |
| 911.9   |              |                   |       | BNSF CROSSING (11.9)         |                              | (X)                        |       |      |
| 910.8   |              |                   |       | CASHION (17.5)               |                              |                            | LB445 | 4825 |
| 906.0   |              |                   |       | BUCKEYE (14.4)               |                              |                            | LB462 | 3707 |
| 905.4   |              |                   |       | ARLINGTON (39.7)             |                              | T                          | LB476 | 3628 |
| 893.5   |              |                   |       | HYDER (19.1)                 |                              |                            | LB515 | 3688 |
| 892.5   |              | END OF MAIN TRACK |       |                              |                              |                            |       |      |
| 876.0   |              |                   |       |                              |                              |                            |       |      |
| 875.2   |              |                   |       |                              |                              |                            |       |      |
| 861.6   |              |                   |       |                              |                              |                            |       |      |
| 860.8   |              |                   |       |                              |                              |                            |       |      |
| 821.9   |              |                   |       |                              |                              |                            |       |      |
| 822.3   |              |                   |       |                              |                              |                            |       |      |
| 802.8   |              |                   |       |                              |                              |                            |       |      |

(176.9)

**SI-01 MAIN TRACK AUTHORITY**

**CTC between:**  
 CP SP937 and CP PX962;  
 CP SP936 and CP PX979  
 (west leg Picacho wye).

**ABS between:**  
 MP 962.4 and MP 802.8.

**TWC between:**  
 MP 962.4 and MP 911.0;  
 MP 899.0 and MP 802.8.

**Yard Limits between:**  
 MP 911.0 and MP 899.0.

**SI-02 MAXIMUM SPEED TABLE**

| Maximum Speed            | MPH       |
|--------------------------|-----------|
| <b>Between Mileposts</b> |           |
| <b>979.7 and 802.8</b>   |           |
| <b>(Except as Below)</b> | <b>60</b> |
| 979.7 and 979.3          | 25        |
| 959.5 and 956.5          | 40        |
| 924.2 and 922.1          | 40        |
| 922.1 and 921.8          | 20        |
| 921.8 and 920.8          | 25        |
| 920.8 and 915.8          | 40        |
| 915.8 and 912.7          | 25        |
| 912.7 and 908.2          | 40        |
| 908.2 and 904.7          | 20        |
| 904.7 and 901.7          | 25        |
| 901.7 and 858.6          | 40        |
| 858.6 and 802.8          | 10        |

**SI-03 OTHER SPEED RESTRICTIONS**

| Maximum Speed   | MPH |
|---|-----|
| <b>1. Thru Sidings &amp; Turnouts.</b>  |     |
| All sidings .....   | 10  |
| <b>2. Dual Control Switch Turnouts.</b>   |     |
| <b>3. Misc. Speed Restrictions.</b>   |     |
| All movements within Palo Verde Power Plant with locomotive bell ringing ...                | 5   |
| Picacho: west leg of wye .....  | 10  |
| Magma: Copper Basin and Magma RR yard tracks and west lead between tracks 602 and 604 ..... | 5   |
| Campo: Yard 5-all curves in tracks 113, 720, 736, 745 & 760 .....                           | 5   |
| <b>4. Key Trains: Crude Oil / High Hazard Flammable</b>                                     |     |
| Between Mileposts   |     |
| MP 949.0 and MP 878.0 .....   | 40  |

**SI-04 MAIN TRACK DESIGNATIONS**

**Main Track out of service** between MP 858.6 and MP 802.8. Any movement between these limits must be under the supervision of Maintenance of Way employee(s) and track inspected prior to use.

**SI-05 MILEPOST EQUATIONS**

Phoenix Sub. MP 979.69 = MP 936.68 Gila Sub.  
 MP 958.42 = MP 957.09  
 MP 924.20 = MP 924.18

**SI-06 RCL OPERATIONS**

**Remote Control Area:**  
 All tracks between MP 911.0 and MP 899.0.

**Remote Control Zones:**  
 For all Phoenix Yard Zone Status Contact:  
 Phoenix Yardmaster. Channel: 066-066

See Superintendent Bulletin for detailed RCL operation information.

**Zone 1:** Starting at the west fouling point of the 131 switch, eastward to the fouling point of track 001.

**Zone 1A:** Starting at track 760 (work lead), at the west fouling point of the 14 switch, eastward to the west fouling point of the 131 switch to include the west fouling points of all inside track switches.

Note: Zone 1A may only be established in conjunction with Zone 1 and/or Zone 4.

**Zone 2:** Track 131 beginning at the fouling point west of the 19 switch (run around track), westward to and including the west fouling points of the Auto Facility and support tracks (132, 781-791, 872-874).

**Zone 3:** Begins at the fouling point west of the 14 switch, westward down the freight lead to a point east of fouling 4th Street.

**Zone 4:** Starting at east fouling point of the 760 crossover, eastward on track 001, to fouling point of 760 lead (work lead).

**SI-07 ITEM 13 TRAIN DEFECT DETECTORS**

|            |            |            |
|------------|------------|------------|
| % 975.8    | % 937.8    | % 880.0    |
| % 975.6    | % 931.9    | (#)+ 874.3 |
| (#)+ 969.9 | (#)+ 927.5 | (#) 836.5  |
| (#)+ 953.0 | (#)+ 911.0 | (#) 816.5  |
| (#)+ 941.6 | % 899.0    | % 808.9    |
| % 939.5    | (#)+ 890.5 |            |

# PHOENIX SUBDIVISION (0685)

## SI-08 RULES ITEMS

**Rule 2.7 Phoenix:** Authorized channels for yard and local crews working on other than main track:  
 Phoenix Yard: 066-066  
 Tempe / Auto Facility: 058-058  
 Campo Yard: 008-008 or 017-017  
 East Valley: 014-014  
 West Valley: 024-024

**Rule 5.8.4:** Item 9 of the System Special Instructions applies at and between:  
 MP 918.54 (Price Road NB) DOT# 748176E and  
 MP 914.29 (1st Street) DOT# 741547N;

applies at and between:  
 MP 906.50 (4th Street) DOT# 741477B# and  
 MP 905.98 (3rd Avenue) DOT# 741466N.

**Rule 6.32.2:** All trains and engines comply with Procedure XH at MP 893.52 (107th Ave.).

**Rule 7.7 Campo, Yard 4:** Do not kick cars into the 800 lead which would make contact with another car(s) in the curve connecting to the main track.

**Rule 7.10 Phoenix Yard:** Following applies for movements on east and west legs of wye, tracks 1/112 and 1/113:

- \*Before movement commences, gates must be opened and locked.
- \*When movement is completed, gates must be immediately closed and locked.

**Rule 8.3 Phoenix Yard:** Main track switches at the east end of Trk 113, MP 908.3, and the west end of Trk 114, MP 906.3 (Central Ave), may be left lined and locked for other than main track movement.

**Rule 8.20 Buckeye Siding:** Normal position for east and west derails located on siding track at Buckeye is the derailing position. When not in use to permit movement, derails must be left lined and locked for derailing position.

**Rule 9.3 Phoenix Yard BNSF Crossing MP 905.4:**  
 Westward: When signal governing movement over crossing displays Restricted Proceed, train or engine may move toward crossing but must stop at least 50 feet before fouling crossing and not proceed until a member of the crew determines that conflicting route is clear and both derails are in derailing position.  
 Eastward: When signal governing movement over crossing displays Restricted Proceed, train or engine must first stop short of signal and not proceed over crossing until member of crew determines that conflicting route is clear and both derails are in derailing position.

## SI-08 RULES ITEMS Continued....

**Rule 81.7 Riding Equipment:**  
 Addition to Part F:  
 When servicing customers listed at the select locations shown below, employees may ride the side ladder of loaded bulkhead or centerbeam flat cars only when the car is the first car of a shoving movement or the last car in a cut of cars being handled. Car must be equipped with horizontal handholds or two vertical handholds. When practical, avoid riding a bulkhead or centerbeam flat car by using a shoving platform or switching car to a different position.

| CUSTOMER                   | LOCATION/CIRC     |
|----------------------------|-------------------|
| Alliance Wholesale         | Germann/LB400     |
| Boise Cascade Corp.        | Campo/LB435       |
| Capitol Lumber             | Campo/LB435       |
| Eighty Four Lumber         | Chandler/UO007    |
| Erikson Lumber             | W. Chandler/UO207 |
| Foxworth Galbraith Lumber  | Gilbert/LB411     |
| Miller Wholesale Lumber    | Normal Jct./LB420 |
| Precision Components Inc.  | Campo/LB435       |
| R&K Building Supply        | Tremain/UO001     |
| Rew Materials Inc.         | Phoenix/LB432     |
| Trio Forest Products       | Mcqueen/LB414     |
| Universal Forrest Products | W. Chandler/UO207 |
| Weyerhaeuser Lumber        | Campo/LB435       |

## SI-09 FRA EXCEPTED TRACKS

**Phoenix:**  
 Main Track: MP 802.8 to MP 858.6.  
 Yard 01: Sears Lead Trks. 770 - 780.  
 Yard 03: Buchanan St. Drill Trks. 708 - 712.

**Campo:**  
 Yard 04: 44th Ave. Drill Trks. 720 - 728.

**Aristuc:** Yard 01: Trk. 718 - 738.

## SI-10 BUSINESS TRACKS

| Track Name              | MP    | STA. #S |
|-------------------------|-------|---------|
| Randolph .....          | 966.4 | LB373   |
| Higley .....            | 932.0 | LB405   |
| Gilbert .....           | 927.0 | LB411   |
| McQueen .....           | 923.6 | LB414   |
| Mesa .....              | 921.8 | LB416   |
| Tempe Jct. ....         | 915.3 | LB424   |
| Tempe .....             | 914.4 | LB423   |
| Aristuc .....           | 909.4 | LB429   |
| 23rd. Ave Phoenix ..... | 904.0 | LB434   |
| Campo .....             | 902.0 | LB435   |
| Cotpro .....            | 900.8 | LB436   |
| Pipeola .....           | 900.4 | LB437   |
| Fowler .....            | 898.1 | LB440   |
| Tolleson .....          | 895.7 | LB442   |
| Litchfield .....        | 889.7 | LB447   |
| Litchfield Jct. ....    | 889.3 | LB448   |
| Dixie .....             | 865.7 | LB472   |
| Gillespie .....         | 851.0 | LB487   |
| Horn .....              | 813.2 | LB525   |

# PHOENIX SUBDIVISION (0685)

**SI-11 INDUSTRIAL LEADS**

**Grade Crossings:** All movements must not foul a crossing equipped with automatic warning devices until the device has been operating long enough to provide warning and the crossing gates, if equipped, are fully lowered. Movements are on other than main track or siding.

**Tempe Industrial Lead (0687)**

10.2 miles; MP 0.0 to MP 10.2.  
 Maximum Gross Weight Restrictions:  
 143 Tons, Restrictions A and Q.

Between main track switch MP 0.0 (Tempe Jct.) and Chandler Blvd. MP 10.2 (West Chandler):  
 Maximum speed is 20 MPH.

**Exceptions:**

- 10 MPH between MP 7.7 and end of lead MP 9.7.
- Yard 7: 5 MPH on all curves in track 705,

Radio Channel: 045-045

Derail located on lead track at MP 0.2.

Rule 5.8.4: Item 9 of the System Special Instructions applies at and between:

- MP 6.65 (Ray Road) DOT# 741579U and
- MP 7.68 (Chandler Blvd.) DOT# 741580N.

| <b>Business Tracks</b> | <b>MP Sta.#'S</b> |
|------------------------|-------------------|
| Peterson .....         | 2.4 UO202         |
| Helena .....           | 4.0 UO203         |
| West Chandler .....    | 7.7 UO207         |

**Chandler Industrial Lead (0688)** 20.4 miles long;

MP 923.6 to MP 944.0 (end of track).  
 Maximum Gross Weight Restrictions:  
 MP 923.6 to MP 935.0:  
 143 Tons, Restrictions A and Q;  
 MP 935.0 to MP 944.0:  
 134 Tons, Restrictions A and S.

Maximum speed 20 MPH.

**Exception:**

- 10 MPH between MP 942.6 and MP 944.0.

Radio Channel: 045-045

Track Out of Service between MP 936.0 and MP 944.0 (end of track). Any movement within these limits must be authorized by Maintenance of Way employee(s) and inspected prior to use.

Rule 5.8.4: Item 9 of the System Special Instructions applies at and between:

- MP 925.98 (Elliot Rd) DOT# 741664J and
- MP 930.87 (Germann Rd.) DOT# 741676D.

| <b>Business Tracks</b> | <b>MP Sta.#'S</b> |
|------------------------|-------------------|
| Tremaine .....         | 925.4 UO001       |
| Chandler .....         | 929.3 UO007       |
| Serape .....           | 934.3 UO012       |
| Dock .....             | 943.2 UO016       |

**SI-11 INDUSTRIAL LEADS Continued....**

**Roll Industrial Lead (0689)**

32.1 miles; MP 770.7 to MP 802.8.

**Maximum Gross Weight Restrictions:**

- MP 770.7 to MP 776.0:  
 143 Tons, Restrictions A and S;
- MP 776.0 to MP 802.8:  
 134 Tons, Restrictions A and S.

**Track out of service between**

MP 782.2 and MP 802.8. Any movement within these limits must be under the supervision of maintenance of way employee(s) and track inspected prior to use.

Red flag and Derail located at MP 782.2.

FRA excepted track between MP 782.2 to MP 802.8.

Maximum speed 20 MPH.

- Exceptions:** 10 MPH between MP 771.0 and MP 774.0;  
 10 MPH between MP 782.2 and MP 802.8.

ABS in effect on entire lead.

All movements in ABS on the Roll Industrial Lead must be made at restricted speed regardless of signal indication.

**Derails located on Lead Track at:**

MP 771.0 and MP 777.0.

Rule 6.32.2: All trains and engines comply with Procedure XH at MP 774.92 (Avenue 34 East) account Automatic Crossing Device(s) disabled.

| <b>Business Tracks</b> | <b>MP Sta.#'S</b> |
|------------------------|-------------------|
| McElhaney .....        | 774.8 LB567       |
| Roll .....             | 780.9 LB567       |
| Growler .....          | 793.0 LB555       |

**SI-12 TONNAGE RESTRICTIONS/TPOB**

**Maximum Gross Weight Restrictions:**

158 Tons, Restrictions A and N.

**SI-13 TRAIN MAKE-UP RESTRICTIONS**

No additional restrictions to system requirements.

# PHOENIX SUBDIVISION (0685)

**SI-14 MISC. INSTRUCTIONS**

**Phoenix Yard:**

Trains must receive permission from the Yardmaster or their representative before:  
 \* Entering or departing Phoenix Yard.  
 \* Westward trains pass MP 912 to obtain yarding instructions.

Freight trains or engines departing yard to enter TWC must receive permission to depart from Train Dispatcher and Yardmaster.  
 Stop sign at MP 906.4 (1st Street) for Westward movements operating on the Freight Lead.

Tracks 520, 522 and 538 designated as locomotive servicing and car facilities tracks.

**Track Breach Protection - Phoenix Yard Limits:**  
 The Phoenix Yardmaster will act as Track Breach Protection EIC between MP 911.0 and MP 899.0. To establish Track Breach Protection or before entering or passing the above locations, contact the Phoenix Yardmaster on channel 045-045. If yardmaster cannot be contacted after three attempts, train may proceed, looking out for employees working in the area, continuing to contact yardmaster.

Note: When crew members are performing work activities adjacent to the main track within Phoenix Yard Limits, they must have radio display set to channel 045-045.

**Campo Yard Lighting System:** To activate lighting system by radio, use radio channel 045-045 and enter 3215\* on radio keypad. The lights will remain on for approximately two hours. A strobe light located above the circuit breaker box will start flashing ten minutes before lights automatically turn off. If additional time is needed, re-enter 3215\*. There is also a pushbutton mounted on the breaker box labeled "Yard Lights On". This will activate the two hours timer. When not needed, employees should turn off the yard lights by entering 3215#. A photocell will override radio control during daylight hours.

**Hot Wheel Detectors:**

As referenced in SSI Item 13.1, bridge(s) with a through truss structure located at the following locations:

- MP 777.81 Roll Industrial Lead;
- MP 891.00;
- MP 913.91;
- MP 959.08.

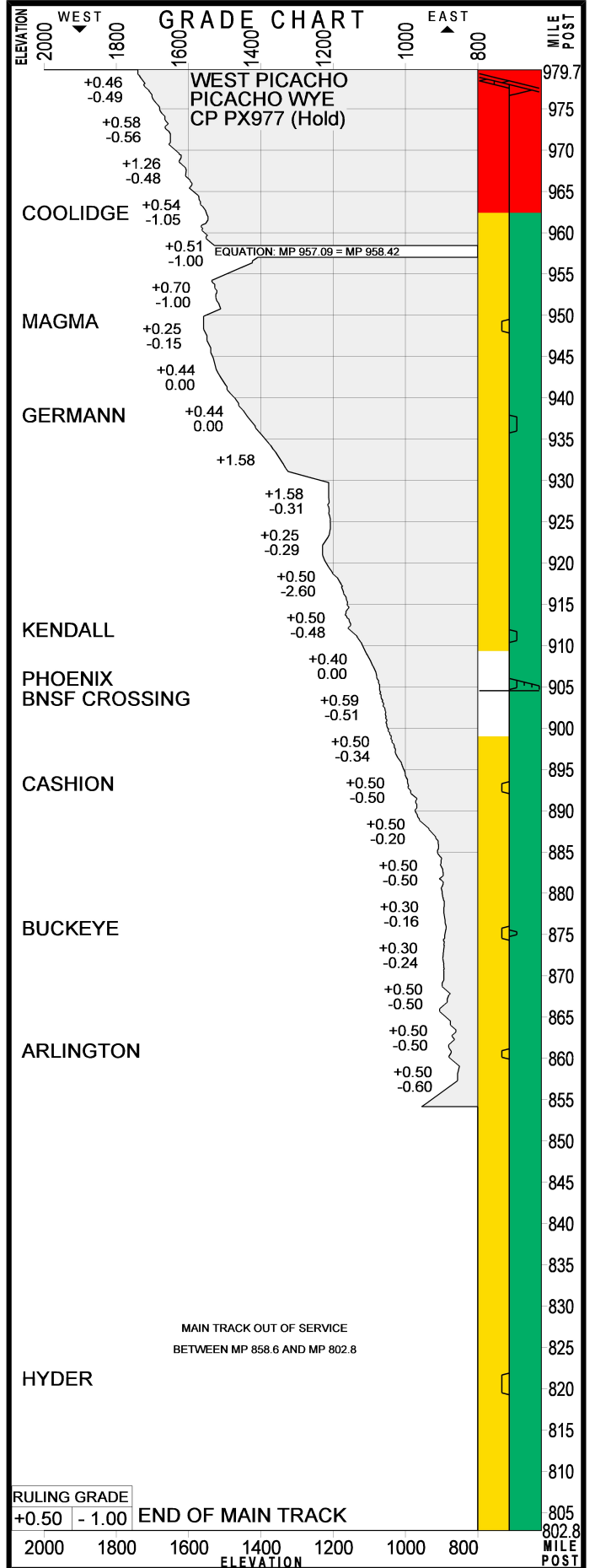

# Phoenix Area Map

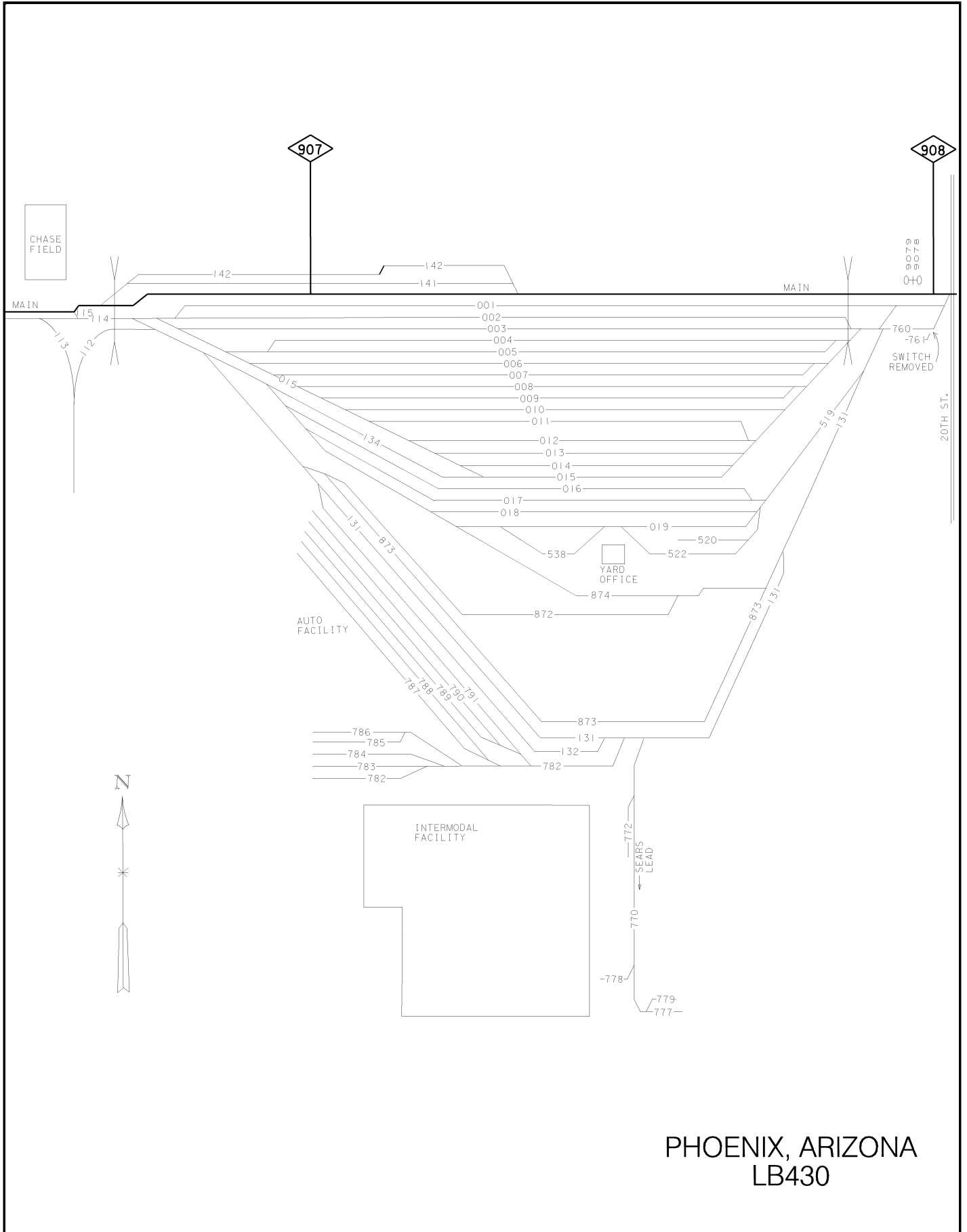

**NOTES:**

|  |
|--|
|  |
|--|

|  |
|--|
|  |
|--|