

PRESSURIZED NAVAJO

PARTS CATALOG

CARD 1 OF 2

PA-31P PRESSURIZED NAVAJO

PIPER AIRCRAFT CORPORATION

(PART NUMBER 753 769)

REVISED: SEPTEMBER 10, 2009

INTRODUCTION

This Illustrated Parts Catalog is designed to provide simple but positive identification of replacement parts for the Piper Model PA-31P, "Pressurized Navajo", manufactured by the Piper Aircraft Corporation of Lock Haven, Pennsylvania.

NOTE UNDER NO CIRCUMSTANCES SHALL THIS CATALOG BE USED FOR RIGGING AND INSTALLATION PURPOSES.

It is suggested that this catalog be thoroughly studied to determine its arrangement prior to its utilization.

1. The Catalog is divided into fourteen (14) major sections described as follows:
 - a. Section I to XIII inclusive contains all replacement parts for the complete airplane. Each section is subdivided and each division includes an illustration and a parts listing.
 - b. Section XIV is the Miscellaneous Group. This Group includes an illustration and parts list for the Placards and Exterior Stencils and a listing of the Optional Equipment Kits, Repair Kits and Special Tools.
2. The following is a brief explanation of the columns in the parts lists: (Refer to EXAMPLE below).
 - a. The "FIGURE AND INDEX NUMBER" column indicates the illustration figure number and its part index number. Example: (2-1), the 2 is the figure number and the 1 is the index number. The figure number appears only at the top of each parts list page.
 - b. The "PART NUMBER" column contains the identifying number of the replacement part and this number must be shown on all Parts Orders.
 - c. The "CODE" column is for the purpose of indicating special uses of the part. An explanation of the letter code used is shown below each listing.
 - d. The "NOMENCLATURE" column indicates the part name. This name must be shown on all Parts Orders.
 - e. The "NO. REQ." (Number Required) column represents the total quantity of parts used per aircraft per figure when the part is not indented and the quantity of parts used per assembly when the part is indented. The symbol "AR" listed in this column means "As Required."
 - f. The "SERIAL NUMBERS AFFECTED" column indicates the part application by airplane serial number.

EXAMPLE					
Figure and Index Number	Part Number	Code	NOMENCLATURE	No. Req.	SERIAL NUMBERS AFFECTED
2-1	XXXXX-XX		DOOR ASSEMBLY - Baggage compartment	X	
-2	XXXXX-XX		* TUBE ASSEMBLY - Baggage door latch	X	
-3	XXXXX-XX		* * CLEVIS - Door latch tube assembly	X	
-4	XXXXX-XX		* * CLIP - Door latch tube assembly	X	

In the Nomenclature column, the next higher assembly relationship of items covered is shown by the degree of indentation of each item and is indicated by an asterisk (*). One asterisk signifies one indentation, two signifies two indentions, etc. The example listing above is interpreted as follows:

If the DOOR ASSEMBLY (not indented) is ordered, it will include the three items listed under the Door Assembly.

If the TUBE ASSEMBLY (indented one space) is ordered, it will include the two items indented under the Tube Assembly.

If you want only a CLEVIS or CLIP, you order only that item.

3. The "ATTACHING PARTS" such as nuts, bolts, screws, etc., that are available as commercial hardware items, are not generally supplied by the Piper Aircraft Corporation. This catalog lists, for your convenience, those attaching parts required for main assemblies and installations. The identifying number for these parts appears after the part name.
4. All items of Optional Equipment are contained in the parts list in their proper sequence and sections. These items were not marked optional, since they are fully identified by their descriptions.

Note Control Horn on Bottom of Elevator Trim Tab in Diagram

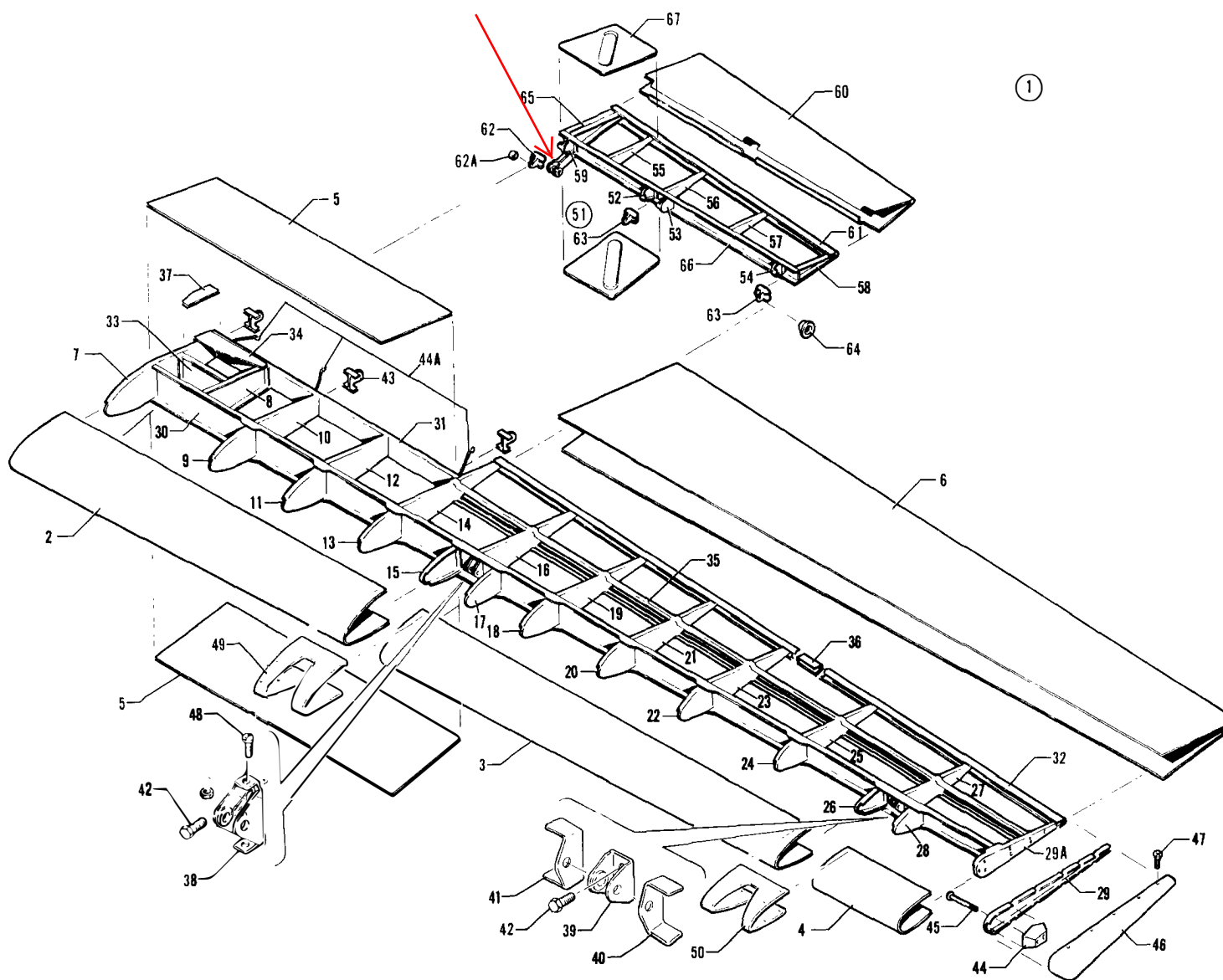

Figure 38. Elevator Assembly

PIPER PARTS CATALOG

Figure and Index Number	Part Number	Code	NOMENCLATURE	No. Req.	SERIAL NUMBERS AFFECTED
38-1	46022-18	A,C	ELEVATOR ASSEMBLY - Left (less tab assembly)	1	
	46022-26	D	ELEVATOR ASSEMBLY - Left (less tab assembly)	1	
	46022-22	B,E	ELEVATOR ASSEMBLY - Left (with tab assembly)	1	
	46022-28	F	ELEVATOR ASSEMBLY - Left (with tab assembly)	1	
	46022-17	A,C	ELEVATOR ASSEMBLY - Right (less tab assembly)	1	
	46022-27	D	ELEVATOR ASSEMBLY - Right (less tab assembly)	1	
	46022-21	B,E	ELEVATOR ASSEMBLY - Right (with tab assembly)	1	
	46022-29	F	ELEVATOR ASSEMBLY - Right (with tab assembly)	1	
-2	46022-05		* SKIN - Elevator leading edge, B.L. 7.05 to B.L. 45.31	1	
-3	46022-06		* SKIN - Elevator leading edge, B.L. 49.81 to B.L. 99.31	1	
-4	46022-07		* SKIN - Elevator leading edge, B.L. 103.81 to B.L. 115.1	1	
-5	46022-11		* SKIN - Elevator, inboard, B.L. 7.05 to B.L. 38	2	
-6	46022-08		* SKIN ASSEMBLY - Elevator, outboard, B.L. 38 to B.L. 115.1, left	1	
	46022-23		* SKIN ASSEMBLY - Elevator, outboard, B.L. 38 to B.L. 115.1, right	1	
-7	54755-02	I	* RIB ASSEMBLY - Elevator, B.L. 7.62	1	
-8	45795-00		* RIB - Elevator, intermediate, B.L. 13	1	
-9	45775-00		* RIB - Elevator, leading edge, B.L. 19.5	1	
-10	45775-03		* RIB - Elevator, intermediate, B.L. 19.5	1	
-11	45784-02		* RIB - Elevator, leading edge, B.L. 28.5	1	
-12	45784-03		* RIB - Elevator, intermediate, B.L. 28.5	1	
-13	45792-02		* RIB - Elevator, leading edge, B.L. 38	1	
-14	45792-03		* RIB - Elevator, main, B.L. 38	1	
-15	45935-03		* RIB - Elevator, leading edge, B.L. 45.31	1	
-16	45742-00		* RIB ASSEMBLY - Elevator, main, B.L. 48	1	
-17	45935-02		* RIB - Elevator, leading edge, B.L. 49.81	1	
-18	45770-02		* RIB - Elevator, leading edge, B.L. 58	1	
-19	45770-03		* RIB - Elevator, main, B.L. 58	1	
-20	45785-02		* RIB - Elevator, leading edge, B.L. 68	1	
-21	45785-03		* RIB - Elevator, main, B.L. 68	1	
-22	46020-02		* RIB - Elevator, leading edge, B.L. 78	1	
-23	46020-03		* RIB - Elevator, main, B.L. 78	1	
-24	46019-02		* RIB - Elevator, leading edge, B.L. 90	1	
-25	46019-03		* RIB - Elevator, main, B.L. 90	1	
-26	45934-02		* RIB - Elevator, leading edge, B.L. 99.31	1	
-27	46011-00		* RIB ASSEMBLY - Elevator, main, B.L. 102	1	
-28	45934-03		* RIB - Elevator, leading edge, B.L. 103.81	1	
-29	51775-10		* RIB ASSEMBLY - Elevator tip, left, B.L. 115.1	1	
	51775-11		* RIB ASSEMBLY - Elevator tip, right, B.L. 115.1	1	
-29a	45998-05		* RIB - Elevator tip	1	
-30	45951-14	G	* SPAR ASSEMBLY - Elevator leading edge, B.L. 7.62 to B.L. 115.1	1	
-31	45956-00		* SPAR - Elevator stub, B.L. 6.5 to B.L. 38	1	
-32	46022-02		* CHANNEL - Elevator, trailing edge, outboard	1	
	46022-03		* CHANNEL - Elevator, trailing edge, inboard	1	
-33	45807-00	G	* CHANNEL ASSEMBLY - Elevator, B.L. 7.62 to B.L. 13	1	
	45807-03	H,I	* CHANNEL ASSEMBLY - Elevator, B.L. 7.62 to B.L. 13	1	
			A - Used on serial nos. 31P-3 to 31P-7400219 inclusive, and 31P-7400228 to 31P-7530012 inclusive.		
			B - Used on serial nos. 31P-7400220 to 31P-7400227 inclusive and 31P-7530013 to 31P-7730012 incl.		
			C - Order part with code "D" if Elevator Inspection and Reinforcement Kit 763 943 has been installed per Service Bulletin No. 658.		
			D - Used on code "A" serial nos. if Elevator Inspection and Reinforcement Kit 763 943 has been installed per Service Bulletin No. 658.		
			E - Order part with code "F" if Elevator Inspection and Reinforcement Kit 763 943 has been installed per Service Bulletin No. 658.		
			F - Used on code "B" serial nos. if Elevator Inspection and Reinforcement Kit 763 943 has been installed per Service Bulletin No. 658.		
			G - Used on aircraft with serial nos. 31P-3 to 31P-7730012 inclusive. Order part with code "H" if Elevator Inspection and Reinforcement Kit 763 943 has been installed per Service Bulletin No. 658.		
			H - Used on aircraft which have had Elevator Inspection and Reinforcement Kit 763 943 installed per Service Bulletin No. 658.		
			I - See latest revision Piper Service Bulletin 897 and Piper Service Letter 778.		

When ordering, always specify Part Number, Description, and Serial Number of Aircraft

PIPER PARTS CATALOG

Figure and Index Number	Part Number	Code	NOMENCLATURE	No. Req.	SERIAL NUMBERS AFFECTED
38-34	45989-00		CHANNEL - Elevator reinforcement, B.L. 7.62 to B.L. 13	1	
-35	46022-12		CHANNEL - Elevator, B.L. 38 to B.L. 115.1	2	
-36	40140-27		SPLICE - Channel, elevator trailing edge	1	
-37	46004-00		GUSSET - Elevator reinforcement, B.L. 7.62	2	
-38	44955-07	D	HINGE ASSEMBLY - Elevator, inboard	1	
-39	44963-00	C,D	HINGE ASSEMBLY - Elevator, outboard	1	
-40	44961-00		HINGE - Elevator, outboard	1	
-41	44962-00	C,D	HINGE ASSEMBLY - Elevator, outboard	1	
-42	400 438		BOLT - Elevator hinge assembly attachment (AN3-4A)	4	
-43	45945-02		BRACKET ASSEMBLY - Elevator tab hinge, inboard	1	
	45945-04		BRACKET ASSEMBLY - Elevator tab hinge, center	1	
	45945-06		BRACKET ASSEMBLY - Elevator tab hinge, outboard	1	
-44	46126-00	A	WEIGHT - Elevator tip	1	
	48860-02	B	WEIGHT - Elevator tip	1	
-44a	49972-04		STRAP ASSEMBLY - Lightning protection	3	
-45	400 885		BOLT - Elevator weight attachment (AN23-36A)	2	
	407 564		WASHER - Elevator weight attachment (AN960-10)	2	
	404 887		NUT - Elevator weight attachment (MS20365-1032C)	2	
-46	46384-04		TIP - Elevator, left	1	
	46384-03		TIP - Elevator, right	1	
-47	414 748		SCREW - Elevator tip attachment (MS24693-S28)	10	
	494 071		WASHER - Elevator tip attachment (A3236-012-1)	10	
	406 355		NUT - Elevator tip attachment (A6052-632-1)	10	
-48	410 319		SCREW- (MS27039C1-06)	2	
	404 835		NUT - (MS20364-1032C)	2	
-49	46034-02		COVER - Elevator hinge, inboard left	1	
	46034-03		COVER - Elevator hinge, inboard right	1	
-50	46028-00		COVER - Elevator hinge, outboard left	1	
	46028-01		COVER - Elevator hinge, outboard right	1	
-51	45751-00		TAB ASSEMBLY - Elevator, left	1	
	45751-01		TAB ASSEMBLY - Elevator, right	1	
-52	45932-03		RIB - Elevator tab, leading edge, center, inboard	1	
-53	45932-04		RIB - Elevator tab, leading edge, center, outboard	1	
-54	45932-05		RIB - Elevator tab, leading edge, outboard	1	
-55	45884-04		RIB - Elevator tab, main, B.L. 13	1	
-56	45775-04		RIB - Elevator tab, main, B.L. 19.5	1	
-57	45784-04		RIB - Elevator tab, main, B.L. 28.5	1	
-58	45884-05		RIB - Elevator tab, main, B.L. 36.51	1	
-59	45932-02		RIB - Elevator tab, leading edge, inboard	1	
			<p>A - Used on serial nos. 31P-3 to 31P-7400219 inclusive, and 31P-7400228 to 31P-7530012 inclusive.</p> <p>B - Used on serial nos. 31P-7400220 to 31P-7400227 inclusive, and 31P-7530013 and up.</p> <p>C - See latest revision Piper Service Bulletin 737.</p> <p>D - See latest revision Piper Service Letter 916.</p>		

When ordering, always specify Part Number, Description, and Serial Number of Aircraft