

SERVICE BULLETIN

DATE: 20 NOVEMBER 2019

PAGE 1 OF 6

/// MANDATORY ////////////////////////////////// MANDATORY ////////////////////////////////// MANDATORY ///

INSTALL COTTER PINS IN THE SEAT-BELT INSTALLATIONS

1. PLANNING INFORMATION

A. Aircraft Affected:

All 369H, 369HE, 369HS, and 369HM helicopter models
All 369D helicopters
All 369E helicopters
All 369FF helicopters
All 500N helicopters
All 600N helicopters

B. Installations Affected By This Bulletin:

NOTE: Base part numbers (no dash number) include all dash numbers.

M30093 Columbia Contract Equipment Modification
369A4000 Model 369A Helicopter Equipment Installation
369A6500 Model 369A Complete Equipment Installation
369D26521 Equipment Installation
369D26523 Upholstery and Equipment Installation
369D290170 Litter Kit Installation
369D296500 Military Kit Equipment Installation
369H6500 Equipment Installation (HM)
396H6502 Commercial Military Seat Belt Installation
369H6503 Standard and Executive Seat Belt Installation
369H6521 First and Second Generation 369HS Regular Production Equipment Installation
369H6530 369HE Equipment Installation
369H90011 Customer Option Litter Installation
369H90018 Pilot and Copilot Harness Installation
369H90035 Customer Option Seating and Belts for Installation
421-099 Shoulder Harness and Seat Belt Inertia Reel Installation
600N6500 Interiors and Equipment Installation

C. Reason:

This bulletin improves the installation of the seat belts with the installation of cotter pins to prevent the hook-ends from disengagement from the attachment points.

Failure to comply with this bulletin can cause a pilot, copilot, or passenger to fall out of the helicopter in-flight or on the ground.

D. Description:

Procedures in this bulletin give owners and operators information to install an MS24665-151 cotter pin in all seat-belt restraint assemblies with a hook-end fitting.

E. Time of Compliance:

The instructions in this bulletin must be completed within the next 25 flight-hours after you get this bulletin.

/// MANDATORY ////////////////////////////////// MANDATORY ////////////////////////////////// MANDATORY ///

DATE: 20 NOVEMBER 2019

PAGE 2 OF 6

SERVICE BULLETIN

/// MANDATORY ////////////////////////////////// MANDATORY ////////////////////////////////// MANDATORY ///

F. FAA Approval:

The technical design aspects of this bulletin are FAA-approved.

G. Manpower:

Compliance with this bulletin will be approximately 0.25 man-hours.

H. Interchangeability:

None.

I. Points of Contact:

For further assistance, contact MDHI Field Service at:

<https://www.mdhelicopters.com/contact.html>

J. Material/Part Availability:

Contact MDHI Spare Sales for parts availability at:

<https://www.mdhelicopters.com/contact.html>

REPLACEMENT PARTS/SUPPLIES			
Nomenclature	Part No.	Qty.	Source
Cotter Pins	MS24665-151	As Necessary	Commercial

K. Warranty Policy:

Contact MDHI Warranty for prices, orders, availability, and service at :

<https://www.mdhelicopters.com/contact.html>.

Standard warranty policy applies.

The hours in Manpower (ref. Paragraph G.) are an estimate, and are not reimbursable, unless specified in the Warranty Policy.

L. Disposition of Parts Removed:

N/A

M. Tooling:

N/A

N. Weight and Balance:

N/A

O. Electrical Load Data:

N/A

/// MANDATORY ////////////////////////////////// MANDATORY ////////////////////////////////// MANDATORY ///

SERVICE BULLETIN

DATE: 20 NOVEMBER 2019

PAGE 3 OF 6

/// MANDATORY ////////////////////////////////// MANDATORY ////////////////////////////////// MANDATORY ///

P. Other Publications Affected:

CSP-H-2 Basic Handbook of Maintenance Instructions (Basic HMI)

CSP-H-7 Illustrated Parts Catalog (IPC)

CSP-HMI-2 Basic Handbook of Maintenance Instructions – Servicing and Maintenance

CSP-IPC-4 Illustrated Parts Catalog

Q. Reference Publications:

Refer to the latest revision of these publications for procedures and additional information:

CSP-H-2 Basic Handbook of Maintenance Instructions (Basic HMI)

CSP-H-7 Illustrated Parts Catalog (IPC)

CSP-HMI-2 Basic Handbook of Maintenance Instructions – Servicing and Maintenance

CSP-IPC-4 Illustrated Parts Catalog

2. ACCOMPLISHMENT INSTRUCTIONS

(Ref. Figure 1)

A. Install Cotter Pins in the Seat-Belt Hook-End Fittings

- (1). Open crew and passenger doors to access the attachment point of the seat-belt assemblies.
- (2). Make sure the hook-end fittings of the seat belts are in the closed position.
- (3). Install a cotter pin in the hole in each hook-end fitting in the closed position.
- (4). Close the crew and passenger doors.

B. Compliance Record

- (1). Record compliance to this Service Bulletin in the Compliance Record Log (ref. CSP-RLB-L8) of the Rotorcraft Log Book CSP-RLB.
- (2). Show compliance with this Service Bulletin by one of these methods:
 - (a). Complete a Service Operation Report (SOR) at <https://www.mymd.aero/dashboard>.
 - (b). Put an entry in your <https://www.mymd.aero/> account.
 - (c). Mail a copy or e-mail a scanned copy of the Bulletin Completed Record to your MDHI Field Service Representative.

/// MANDATORY ////////////////////////////////// MANDATORY ////////////////////////////////// MANDATORY ///

DATE: 20 NOVEMBER 2019

PAGE 4 OF 6

SERVICE BULLETIN

/// MANDATORY ///

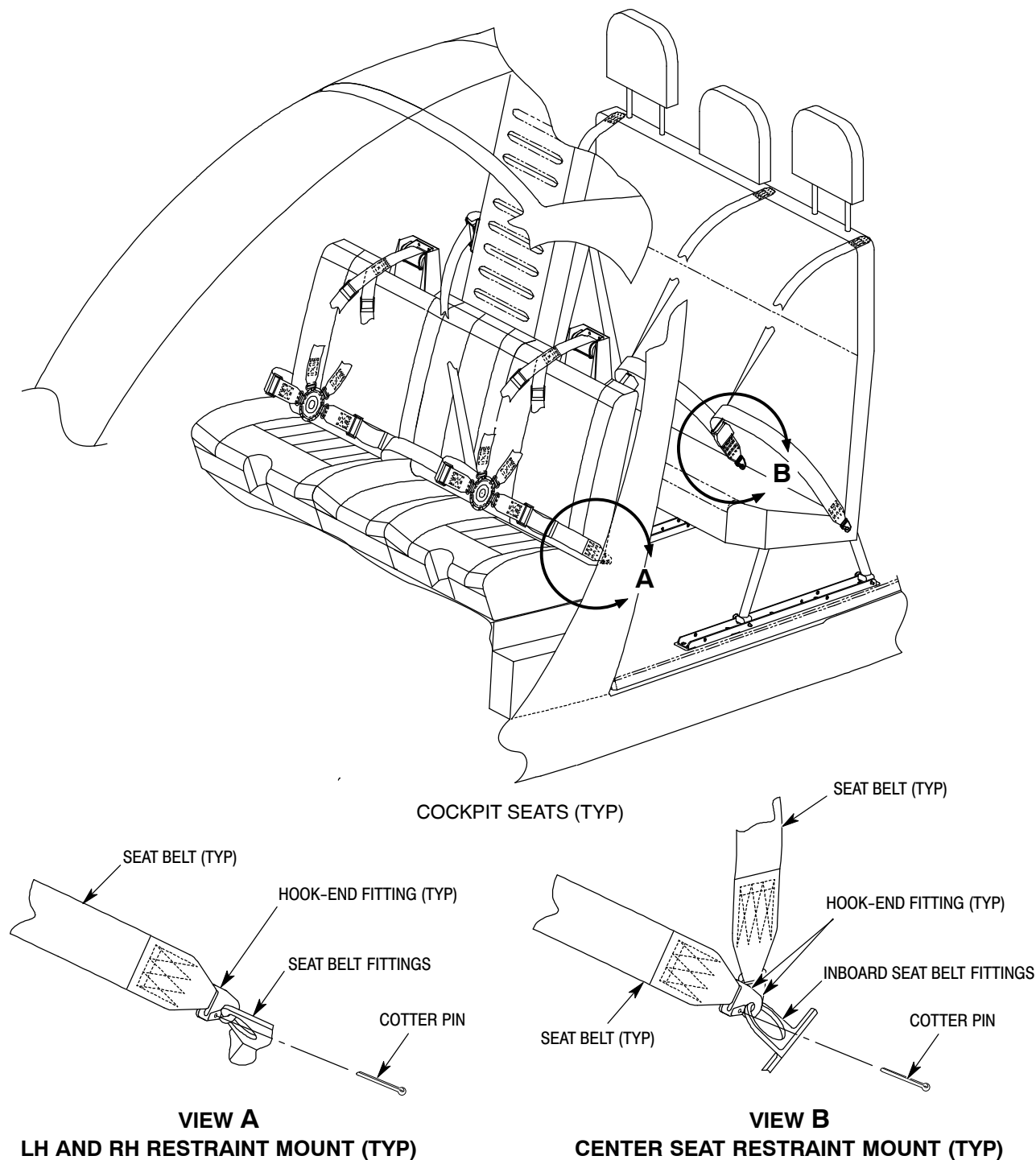

P63-0061-1

Figure 1. Installation of a Cotter Pin in a Restraint (Typical)

/// MANDATORY ///



SB369H-261
SB369E-127
SB500N-064

SB369D-227
SB369F-117
SB600N-078

SERVICE BULLETIN

DATE: 20 NOVEMBER 2019

PAGE 5 OF 6

/// MANDATORY ////////////////////////////////// MANDATORY ////////////////////////////////// MANDATORY ///

Bulletin Completed Record

Install Cotter Pins in the Seat-Belt Installations

MD Helicopters, Inc.
Field Service
4555 East McDowell Road
Mesa, AZ 85215-9734

Phone: 480-346-6300 or 1-480-346-6300 (International)
Website: <https://www.mdhelicopters.com/contact.html>
Or email or speak to your Field Service Representative.

Owner/- Operator: _____	Helicopter Serial No: _____
Address: _____ _____ _____ _____	Helicopter Total Time: _____ Date Complete: _____ Location: _____
Phone: _____	
E-mail: _____	

This bulletin is complete: _____
(Signature)

(Print Name)

(Title)

Comments: _____

/// MANDATORY ////////////////////////////////// MANDATORY ////////////////////////////////// MANDATORY ///

SB369H-261
SB369E-127
SB500N-064

SB369D-227
SB369F-117
SB600N-078



DATE: 20 NOVEMBER 2019

PAGE 6 OF 6

SERVICE BULLETIN

/// MANDATORY /// MANDATORY /// MANDATORY ///

This page intentionally left blank!

/// MANDATORY /// MANDATORY /// MANDATORY ///

*Copyright 1999-2019 by MD Helicopters Inc.
This document may be reproduced and distributed provided no fee is charged,
the text is not modified, and this copyright notice is included.*