

Gauge Pig Specifications

Manufactured by S.U.N. Engineering Inc. and purchased by Entegra L.L.P.
Model 2CC-SM – 24"

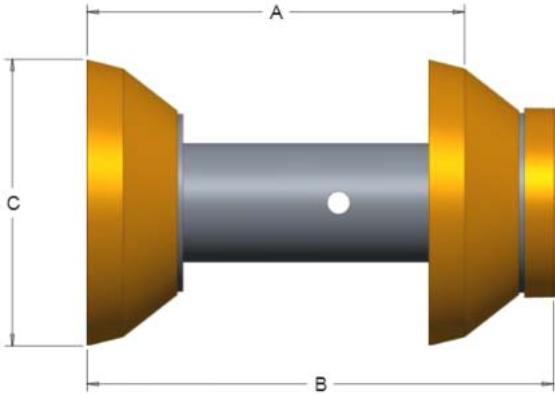

- A – 29.500"
- B – 33.875"
- C – 24.000"
- Weight – 139 lbs

The pig had two aluminum gauge plates 19.92" and 18.72" in diameter. It generally looks like the picture below.



Information obtained from: <https://sunengineeringinc.com/product-catalog/>

INDEX	PART #	DESCRIPTION	A	29.94"	END OF CUP TO END OF CUP	QTY	1
1	2400-SBBN	24" BUMPER NOSE	B	33.06"	SEAL LENGTH	WEIGHT	126 LBS
2	2400-PBFL	24" PULL BAR FLANGE	C	38.94"	OVERALL LENGTH	85DUROMETER PARTS	
3	2400-ICC	24" CONICAL CUP	(14) SAE GRADE 5 FRONT 1/2" X 4.00" BOLT	(14) SAE GRADE 5 BACK 1/2" X 5.50" BOLT	(56) WASHERS / (28) GRADE 8 NYLOCK NUT		
4	2400-2-SB2C	24" 2 CUP STEEL BODY GAUGE PIG					
5	2400-SD	24" SPACER DISC					
6	19.92" 18.72"	19.92" & 18.72" plates					
7	2400-BLFL	24" BLIND FLANGE W/LIFTING EYE					

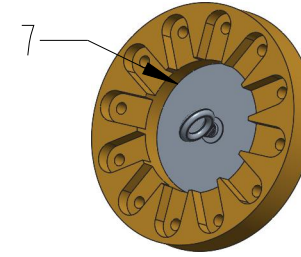
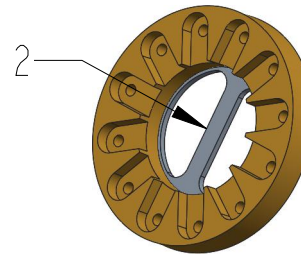

FRONT END

BACK END

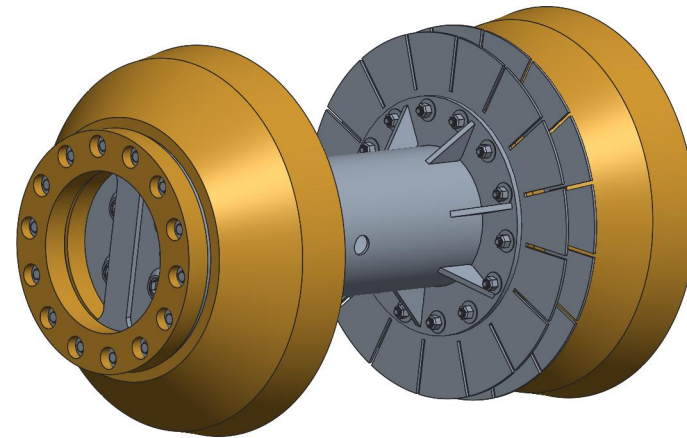
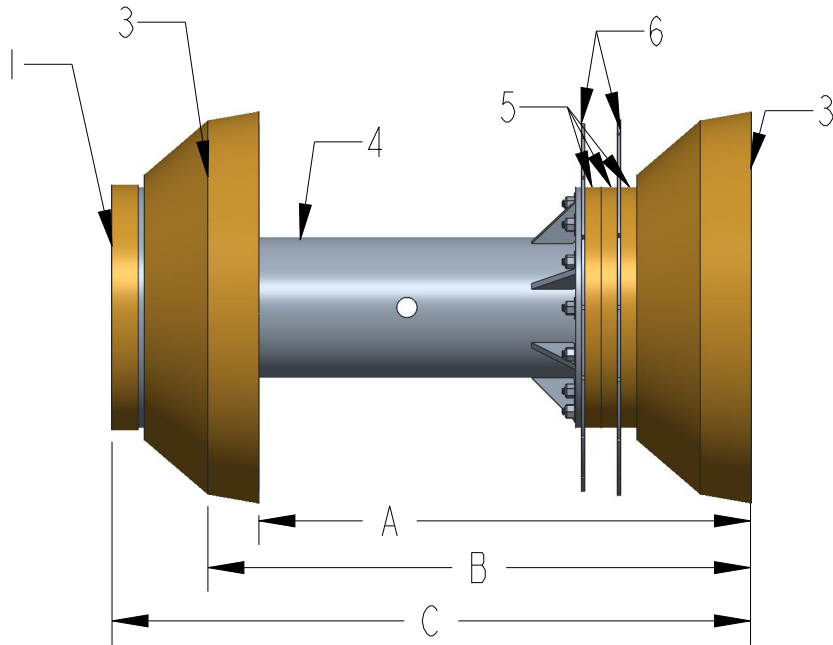

24" GAUGE PIG

DRAWN BY: NRH

DATE: Mar-11-20

ASSEMBLED BY:

DATE:

SCALE: 0.300

SHEET: 1 of 1

DRAWING NO.:

SIZE:

A

AEC-APT-NTSB-000135 (Docket)