



HIGHWAY FACTORS ATTACHMENT

Lighting plans for the westbound Silver Lake rest stop completed in 1984

Highland, IL

HWY23MH015

(4 pages)

STATE OF ILLINOIS
DEPARTMENT OF TRANSPORTATION

F. A. ROUTE NO.	SEC.	COUNTY	TOTAL SHEETS	SHEET NO.
FAI 70	60-13	MADISON	11	1
F. H. A. REG. NO. 4	ILLINOIS	PROJECT	IR-70-2(185)30	

P-98-092-70

- INDEX OF SHEETS
- 1 COVER SHEET
 - 2 SUMMARY OF QUANTITIES & GENERAL NOTES
 - 3-5 LIGHTING PLAN
 - 6 SCHEMATIC DIAGRAMS & CONTROL INSTALLATION, SPECIAL
 - 7 SIGN PANEL, SPECIAL
 - 8 POLE FOUNDATION
 - 9-10 POLE STANDARDS
 - 11 SIGN TRUSS LIGHTING

STANDARDS : 2298-7, 2299-10, 2300-3, 2301-5, 2302-5,
2307-6, 2315-6

PLANS FOR PROPOSED
FEDERAL AID HIGHWAY

FAI ROUTE 70

SECTION 60-13 I-L

MADISON COUNTY

REST PARK LIGHTING

PROJ. IR-70-2(185)30

C-98-007-84

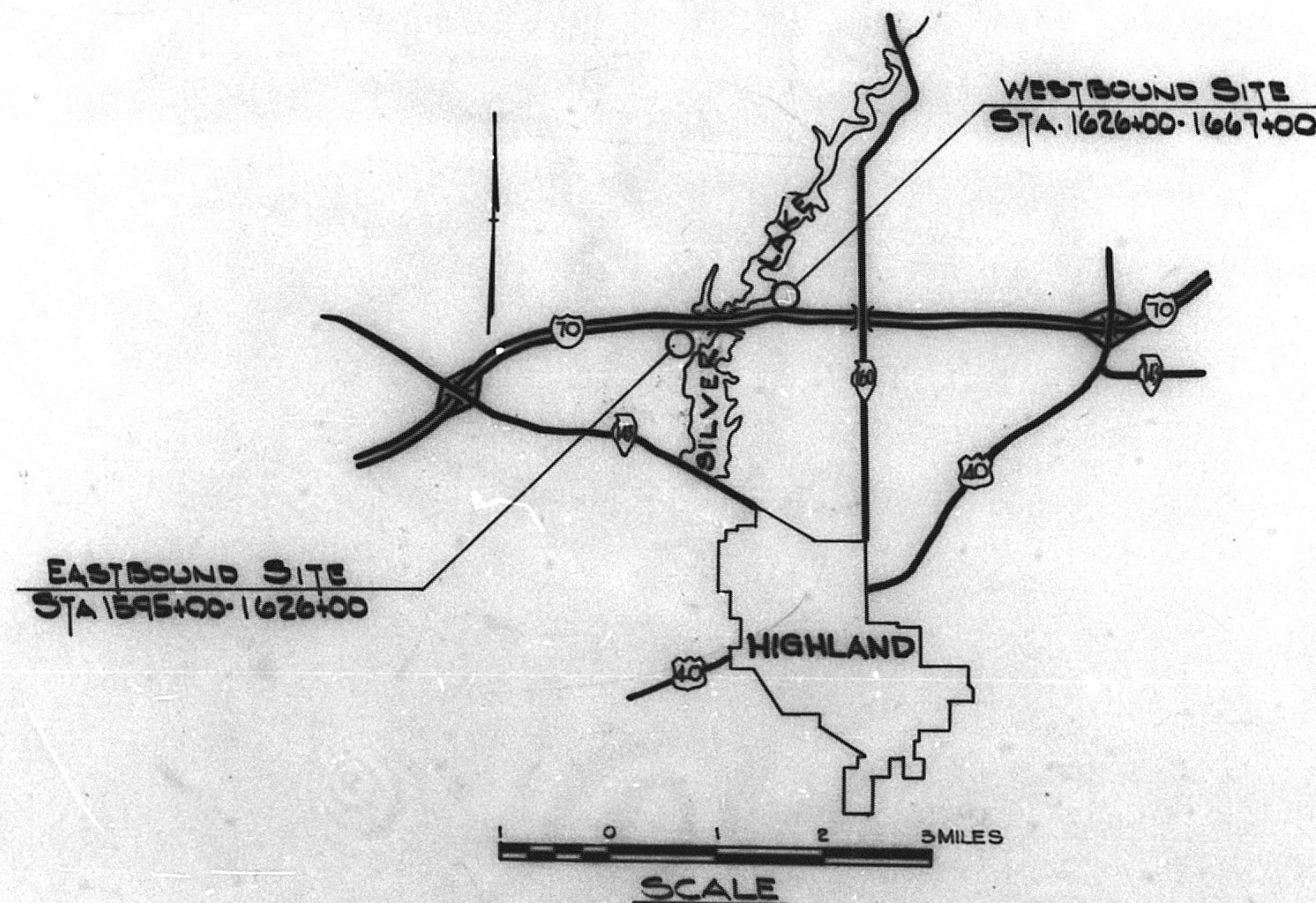
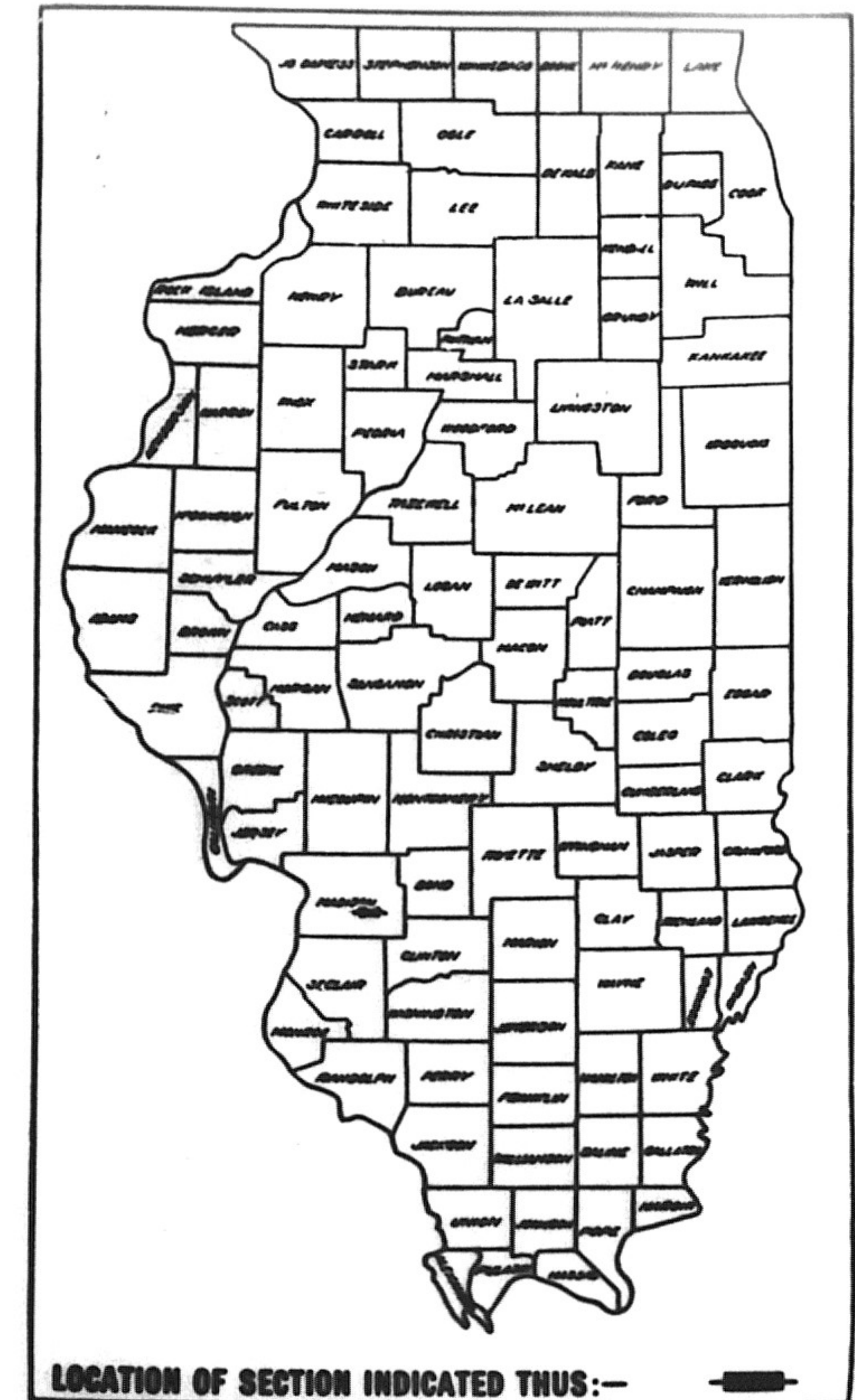

LENGTH OF PROJECT — 7200.00' = 1.364 MI.

MICROFILMED _____
REEL NUMBER _____
AWARDED _____
RESIDENT ENGINEER _____
AS BUILT CHANGES WERE MADE
ON THE FOLLOWING SHEETS

STATE OF ILLINOIS
DEPARTMENT OF TRANSPORTATION

SUBMITTED: 5/2 1984
EXAMINED: 1-23 1985
PASSED: 1-23 1985
APPROVED: 1-23 1985
DIRECTOR OF HIGHWAYS

DEPARTMENT OF TRANSPORTATION
FEDERAL HIGHWAY ADMINISTRATION

APPROVED: _____
DIVISION ADMINISTRATOR

DATE: _____

REV. SET 1-23-85

CONTRACT NO. 38338

Madison COUNTY SECTION 60-13I-L F.A. ROUTE 70

Rev. 2-25-85

ROUTE NO.	SECTION	COUNTY	TOTAL SHEETS	SHEET NO.
FAI 70	60-131	MADISON	11	4
FED. ROAD DIST. NO. 7	ILLINOIS	PROJECT		



SEE SHEET 2 FOR
LEGEND AND NOTES

LIGHTING PLAN
WESTBOUND REST AREA



ROUTE NO.	SECTION	COUNTY	TOTAL SHEETS	SHEET NO.
FAI 70	60-131	MADISON	11	5
FED. ROAD DIST. NO. 7 ILLINOIS PROJECT-				



SCHEDULE OF BREAKAWAY COUPLINGS

POLE NO.	LOCATION	BREAK-AWAY DEVICE
EASTBOUND REST AREA		
EB1	—	NO
EB2	RT. 10+60	YES
EB3	RT. 7+80	YES
EB4	RT. 4+80	YES
EB5	RT. 1+80	YES
EB6	RT. 19+70	YES
EB7	RT. 22+70	NO
EB8	RT. 25+70	NO
WESTBOUND REST AREA		
WB1	—	NO
WB2	LT. 29+20	YES
WB3	LT. 32+20	YES
WB4	LT. 35+20	YES
WB5	LT. 38+20	YES
WB6	LT. 20+88	YES
WB7	LT. 18+00	YES
WB8	LT. 15+00	YES
WB9	LT. 12+00	YES
WB10	LT. 9+00	NO
WB11	LT. 6+00	NO

SEE SHEET 2 FOR LEGEND AND NOTES

LIGHTING PLAN
EASTBOUND AND WESTBOUND
REST AREA RAMPS