

ATTACHMENT I

SPECIFICATIONS

1 VESSEL

1. HULL – 84'x30'x11'
Bottom – ½" plate w/ ¾" plate under stern
Sides – 3/8" plate
Deck – 3/8" plate
Bulkheads – 5/16" plate
Push Knees – ½"x14'x2'6"
Bulwarks – 5/16" plate x2' high (closed)
2. SUPER STRUCTURE –
Main Deck House – ¼" plate, 5/16" deck plate
Second Deck House – ¼" plate, 5/16" deck plate
Wheel House – ¼" plate
Handrails – 1 ¼" & 1" galvanized pipe, flat bar stanchions
3. FUEL TANKS – 33,000 gallon capacity (Approximately)
1 – Port, 1 Stb'd forward – 25,000 gallons each approximately
1 – Port, 1 Stb'd aft – 14,000 gallons each approximately
1 – 3" fill each tank – S.S. at deck penetration
1 – 3" view pipe each tank – S.S. at deck penetration
1 – 2" vent each tank – S.S. at deck penetration
1 – Suction with 3" crossover
1 – Settlement, strainer pot in engine room bilge w/ 1½" Sch80 pipe from tanks to pot
1 – 1" drain collar and valve for each tank
1 – Pet cocks in bulkhead of each tank fitted with plug
1 – Manual pull type fuel shutoff for each of 4 fuel tanks
1 – Fuel hose rack and fuel piping mounted at Stbd pushnee
4. POTABLE WATER TANKS – 12,000 gallon capacity (Approximately)
2 – Tanks with interior coating – 6000 gallons each approximately
1 – 3" fill each tank - S.S. at deck penetration
1 – 2" vent each tank – S.S. at deck penetration
1 – 3" crossover line with valve between tanks
1 – Pressure sets with tank.
1 – Manway hatch access in each tank
5. FORWARD ROPE LOCKER –
1 – Access stairway
1 – Suitable water tight door
2 – Overhead lights on one switch and one 110V receptacle.
Flooring with angle framing, decked with wood.
1 – 2" S.S drain pipe through fuel tank to engine room bilge

- 5 – Gang ratchet rack
- 54 – LF of 2' deep wood shelving with 2" lip
- 1 – Ventilation Fan
- 1 – Vent

- 6. DECK HARDWARE –
 - 2 – Electric 40 ton Patterson galvanized winches with remote wheel house control
 - 4 – Deck Buttons – 2 fixed & 2 roller type.
 - 4 – 4" H Bitts, one @ ea. quarter
 - 1 – 8" H Bitt on centerline of bow bulwarks
 - 1 – Button on top of each knee
 - 3 – Cable hooks on each knee
 - 4 – SS hatches on weather deck
 - 4 – Steel hatches on interior deck

- 7. STAIRS AND LADDERS –
 - Engine room stairs to be stationary.
 - Interior house stairs deck to deck..
 - Grab rails provided where necessary.
 - Grab rail and steps @ headlog
 - Recessed stairwell at stern

- 8. STACK –
 - 2 – Single, removable stack with company logo on each side. Exhaust elbows to be SS.

- 9. STEERING SYSTEM -
 - Electric over hydraulic full follow up 45° with 5"x30" cylinder
 - 2 – Steering Rudders with 8" stocks
 - 4 – Flanking Rudders with 6" stocks
 - Galvanized bar grating over steering gear on stern deck

- 10. PROPULSION SYSTEM –
 - 2 – Tailshafts 7" diameter with 7 ¼" Stainless Steel clad liners
 - 2 – Cutlass bearings 2 – 7¼" ID x 9 ¼" OD x 26½" strut bearings, boss approximately 13" OD x 2'6" long
 - 1 – RH & 1 LH, 4 blade propeller properly sized for main engine horsepower and gear ratio

- 11. COOLING SYSTEM -
 - Main Engines – 2 – Grid Style Coolers sized for suitable main engine cooling
 - Generator sets – 2 Grid Style Coolers sized for suitable generator cooling
 - Coolers installed in Recessed ½" plate boxes
 - Cooler Piping to be sch 80

Handwritten signature in blue ink, followed by two black rectangular redaction marks.

12. ELECTRICAL SYSTEM –
 - 1 – Complete standard wiring job
 - 1 – Navigation lighting system, 120V AC w/ 12V back up
13. SANITARY SYSTEM –
 - 1 – 6 man unit. Piping to be sch 40 p.v.c. and sch 80 steel
14. REST ROOMS –
 - 2 ea. with commodes with fiberglass showers, vanity & cabinet
15. WASH ROOM AREA –
 - 1 – Washer
 - 1 – Electric Dryer
 - 1 – Table and shelf
16. AIR CONDITIONING, HEATING AND VENTILATION –
 - 1 – 5 ton units with heat strips ducted to galley, 4 state rooms, wheelhouse and equip. room under wheel house
 - Living areas of houses to be insulated and paneled
 - Overhead of engine room in way of quarters to be insulated
 - 2 – 24" electric supply blowers to engine room
 - 2 – 18" electric exhaust blowers from engine room
 - 1 – 18" electric exhaust blowers in steering room
17. PORT AND STB'D SHAFT GLAND WATER COMPARTMENT –
 - 2 – 1" Teel automatic bilge pump
 - 2 – 1" galvanized overboard discharge line
18. AIR COMPRESSOR –
 - 2 – Quincy 5 HP, 230 volt, 3 phase, two stage compressors with 80 gallon tank
 - 1 – Airline to fore deck inside push knee
19. BILGE AND BALLAST SYSTEM –
 - 2 – 1½" pumps, 1 bilge/ballast and 1 fire pump to meet USCG requirements
 - 1 – 1½" strainers with foot valve in engine room suction line with one 1½" overboard line, 2" stainless steel drain pipe through fuel tanks from forward storage compartment
 - 1 – Cross-over manifold and sea chest for fire system
20. LUBE OIL TANK –
 - 1 – 250 gallon tank in engine room for main eng's. and gen. sets w/ 30' of 1" hose (gravity feed)
 - 1 – 100 gallon tank for hydraulic oil w/ 30' hose (gravity feed)
 - 1 – hand pump connected to each tank with 30' discharge hose
21. ENGINE ROOM FLOOR PLATES – Aluminum floor plates with S.S. fasteners

22. SAFETY EQUIPMENT –
1 – Fire Suppression System compliant with USCG Regulation 46 CFR Subpart C
4– Life Rings and racks (2 Life Rings @ Pilot House w/ lights)
6 – Life Jackets and racks
1 – 14' aluminum skiff with oars
1 – Boat davit, High Tide #25-273, ID# 1700
1 – Fire Axe
1 – Fog Bell
8 – Hand held extinguishers
6 – Emergency egress lights
1 – Fire alarm system with sensors in galley, over each main engine and over each generator
Safety guards on machinery as needed
Safety signs placed as needed.
Galley stove extinguisher
23. DOORS –
All main deck to be stainless steel doors with lites
Engine room to galley passage to be insulated steel door
Exterior 2nd deck and wheelhouse to be stainless steel doors and frames w/ lights
Interior doors to be wood construction
Interior wood door @ main deck and 2nd deck stair landing
24. GALLEY -
1 – "L" shaped settee with storage under
1 – Wood table with pipe stanchions
1 – Double sink with high spout faucet
1 – Formica top counter with cabinets and drawers under and cabinets over
1 – 30" electric oven with four burner top with sea rails
1 – Vent a hood with light
1 – Refrigerator/Freezer with Icemaker, Water/Ice in door
1 – Freezer (upright)
2 – Fixed glass windows with mini blinds
1 – TV rack over coffee bar, cabinets/storage under coffee bar
25. CAPTAINS QUARTERS -
1 – Single bunk with mattress & pillow
1 – Desk and chair
1 – Closet
1 – O.H. Light
1 – Bunk Light
1 – Fixed glass window with mini blinds
1- Lavatory w/ 110VAC receptacle over
1 – TV mount with coax cable, 110 VAC receptacle
26. PILOTS QUARTERS -

A handwritten signature in blue ink is visible in the bottom right corner, partially overlapping a large black rectangular redaction box.

- 1 – Single bunk with mattress & pillow
 - 1 – Desk and chair
 - 1 – Closet
 - 1 – O.H. Light
 - 1 – Bunk Light
 - 1 – Fixed glass window with mini blinds
 - 1 – TV mount with coax cable, 110 VAC receptacle
27. MAIN DECK STATE ROOM –
- 1 – Double bunk stacked with mattress, pillow & ladder
 - 2 – Closets
 - 1 – O.H. Light
 - 2 – Bunk Light
 - 1 – Fixed glass window with mini blinds
 - 1 – TV mount with coax cable, 110 VAC receptacle
28. 2ND DECK CREWS QUARTERS –
- 1 – Double bunk stacked with mattress, pillows and ladder
 - 2 – Closets
 - 1 – O.H. Light
 - 2 – Bunk Lights
 - 1 – Fixed glass window with mini blinds
 - 1 – TV mount with coax cable, 110 VAC receptacle
29. LOCKERS –
- 6 – mounted in upper engine room
30. FLOORING –
- Deck covering in all interior living quarters to be low profile radial rubber tile
31. WHEELHOUSE –
- 1 – Console with cabinet under, formica top, paneling and wood trim
 - 1 – Settee
 - 1 – Lavatory with cabinet
 - 1 – FIC-2114, 2x250 watt “Color Lite”
 - 1 – 500 W Xenon spot light
 - 1 – Clock and barometer
 - 1 – Wheelhouse chair
 - 1 – Chart Table
 - All – 7/32” safety glass fixed windows
 - 2 – Stainless steel doors with stainless steel jams and glass windows
 - 8 – Antenna Mounts
32. MAIN ENGINE AND GENERATOR EXHAUST –

A handwritten signature in blue ink is located in the bottom right corner of the page. Below the signature, there are two rectangular black redaction marks.

Insulated from flex to and including mufflers with blanket type insulation

33. AIR HORN –
One Kahlenberg Model D-2 air horn or equal
34. ELECTRIC WINDSHIELD WIPER –
One on center wheelhouse window
35. P.A. SYSTEM –
Speaker in galley, quarters, steering room, upper and lower engine room, equipment room and forward deck house.
36. NAME BOARDS –
One port and one stb'd
Name welded on bulwarks port and stb'd and on stern bulwarks along with bailing port using 1/4" plate letters, welded solid
37. PENNANT STANCHIONING –
On Port and Stb'd knees
38. CATHODIC PROTECTION –
Furnish and install 30 M-24 zinc plates
39. WORK BENCH
Tool board and work bench w/ 4" vice and air hose fitting in steering room
40. ENGINE ALARMS –
Furnish and install 20 point Rio Marine engine alarm system
41. GENERAL ALARM –
Furnish and install a general alarm system with flashing lights and siren in engine room
42. BILGE ALARM –
Furnish and install an engine room bilge alarm with buzzer and flashing light
43. WALL COVER –
Install vinyl wall covering on all un-paneled steel BHDS in quarters, galley, passage & stairways
44. MOP SINK –
Install on main deck in aft engine room
45. COATING -
Blast and coat vessel with Ameron as per paint manufacturers specifications.
46. WATER HOSE BIBS –



- 6 – Water hose connections, one at forward end main deck house, one at Port side near Fr. #8, one at forward, one at aft end of second deck house, one at wheel hse., and one at upper engine room
47. ELECTRONICS – As per Premium Electronics quote dated 01/18/06
Radar, radios, GPS and AIS as specified by owner to be furnished, mounted and wired by John Bludworth Shipyard, LLC. and/or Premium Electronics.
48. MAIN ENGINES –
2 – Cummins KTA38-M1 Marine engines, 1000 BHP @ 1800 RPM, complete with mufflers, expansion joints, exhaust elbows, flanges, gaskets, fuel & lube oil filters, gauge panels (wheel house & remote), air intake filters, vibration dampers, gear oil cooler, torsional analysis, throttle, gear controls, air starters, set up for keel cooling. Fuel and lubricants to be furnished by Buffao Marine.
49. MARINE GEARS –
Twin Disc MG-540 marine gears, close coupled with 6.18:1 ratio
50. GENERATOR SET – Cummins 75kW gensets configured for keel cooling complete with mufflers, expansion joints, exhaust elbows, flanges, gaskets, fuel and lube oil filters, gauge panels, air intake filters, vibration dampeners, set up for electric start
51. FENDER FAIRING PLATES –
Furnish and install fairing plates to fore and aft sides of laminated fenders on Port and Stbd. side shells.
52. ENGINE CUT-OUT PORTABLE GRATING –
Furnish and install portable angle framing with galvanized bar grating on way of Port and Stbd. main engine cut-outs.
53. INTERIOR PANEL & OVERHEAD –
Furnish and install FRP on ½" plywood on walls and overhead in all living areas.
54. FUEL OIL CONTAINMENT DRAINS –
Furnish and install ½" Stainless steel drains from containments to engine room with valve.
55. STEERING ROOM GREASE LINES –
Furnish and install pipe and hoses to central manifold.
56. FUEL OIL PUMP –
Furnish and install pump and pipe to Stbd. push knee complete with hose rack.

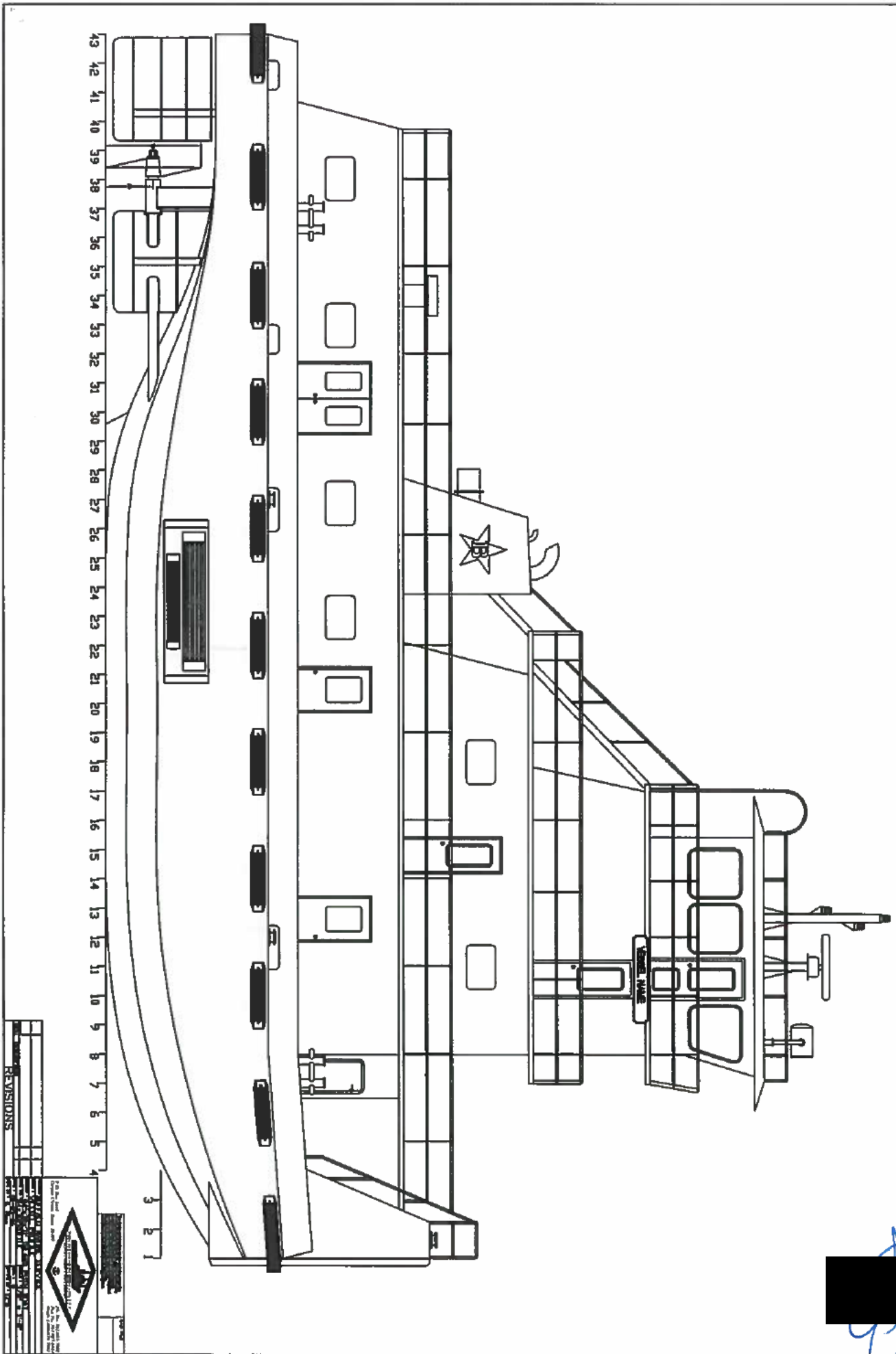

REVISIONS	
1	Initial Design
2	Revised Design
3	Final Design
4	Construction
5	Completed



Handwritten signature and date: 10/1/78

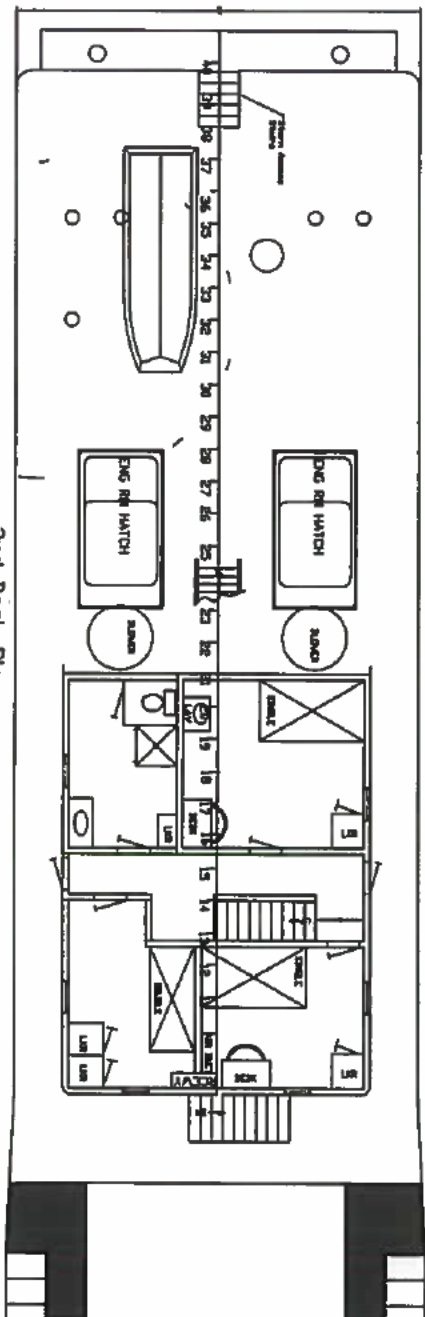

2nd Deck Plan
(View Looking Down)

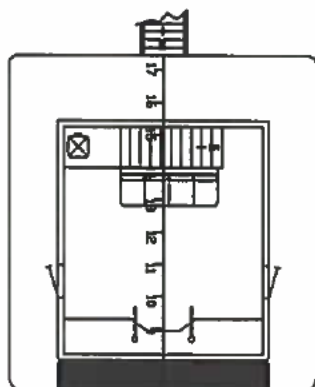

Pilot House Deck Plan
(View Looking Down)

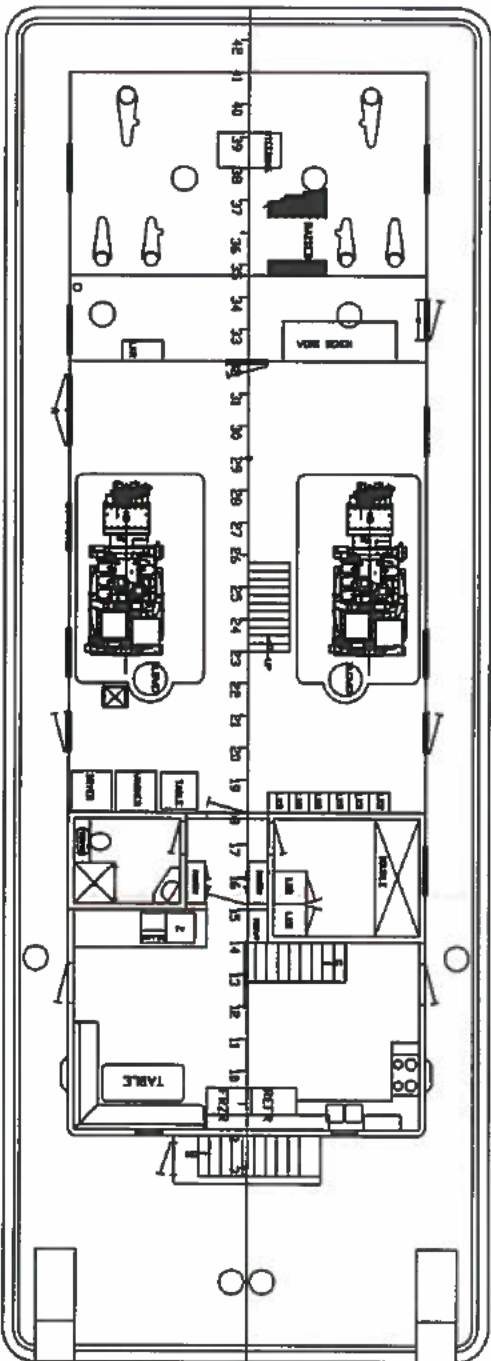

Main Deck Plan
(View Looking Down)

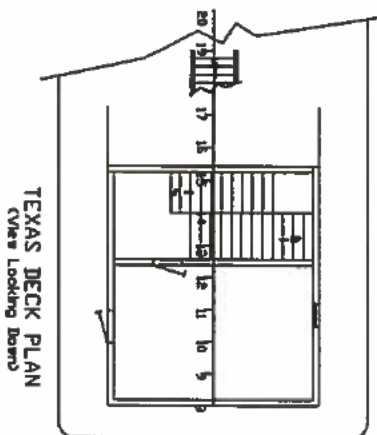

Texas Deck Plan
(View Looking Down)

REVISIONS	DATE	BY	DESCRIPTION
1	10/1/80	J. L. B.	Initial Design
2	10/1/80	J. L. B.	Revised Design
3	10/1/80	J. L. B.	Final Design



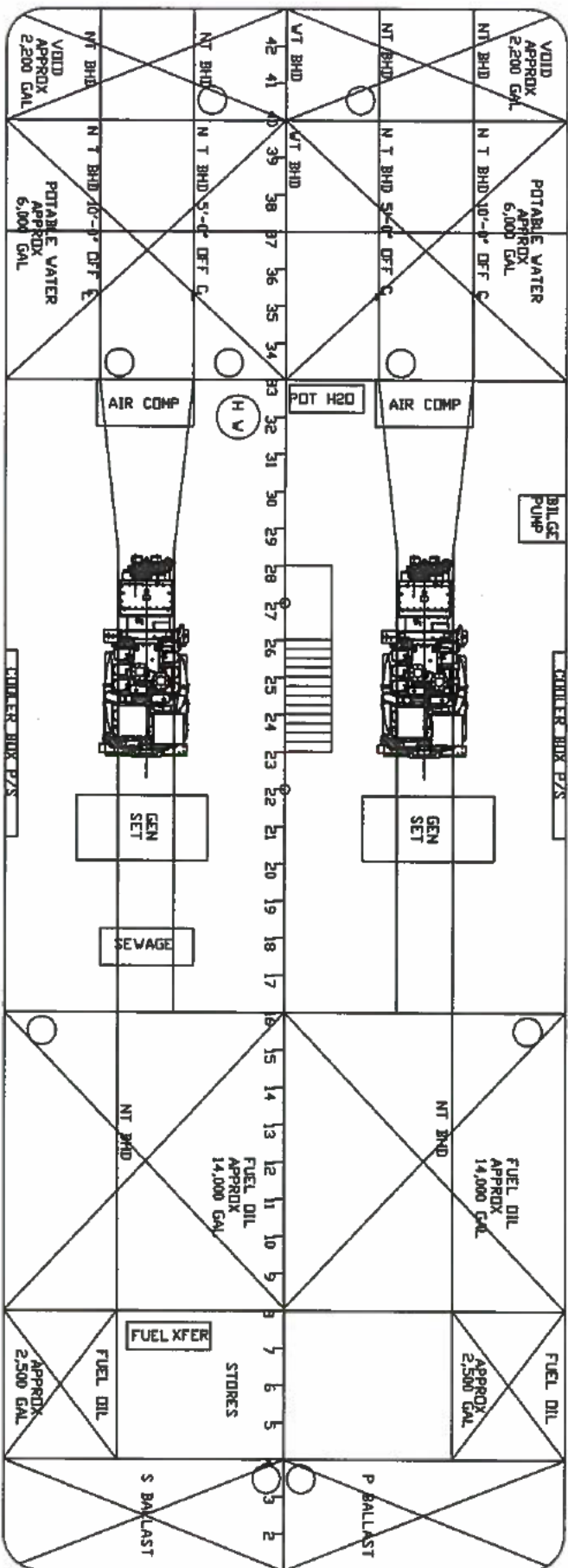

TANK ARRANGEMENT
(View Looking Down)

NO.	REVISIONS
1	
2	
3	
4	
5	
6	
7	
8	
9	
10	
11	
12	
13	
14	
15	
16	
17	
18	
19	
20	
21	
22	
23	
24	
25	
26	
27	
28	
29	
30	
31	
32	

