



HIGHWAY FACTORS-TECHNICAL RECONSTRUCTION  
FACTUAL REPORT ATTACHMENT

ATTACHMENT: Highway Plans (2017)

Millersburg, OR  
HWY23FH013

(3 pages)

14987 Contract Plans 15/70

50V-051

Sec. 33, T. 9S., R. 3 W., W.M.

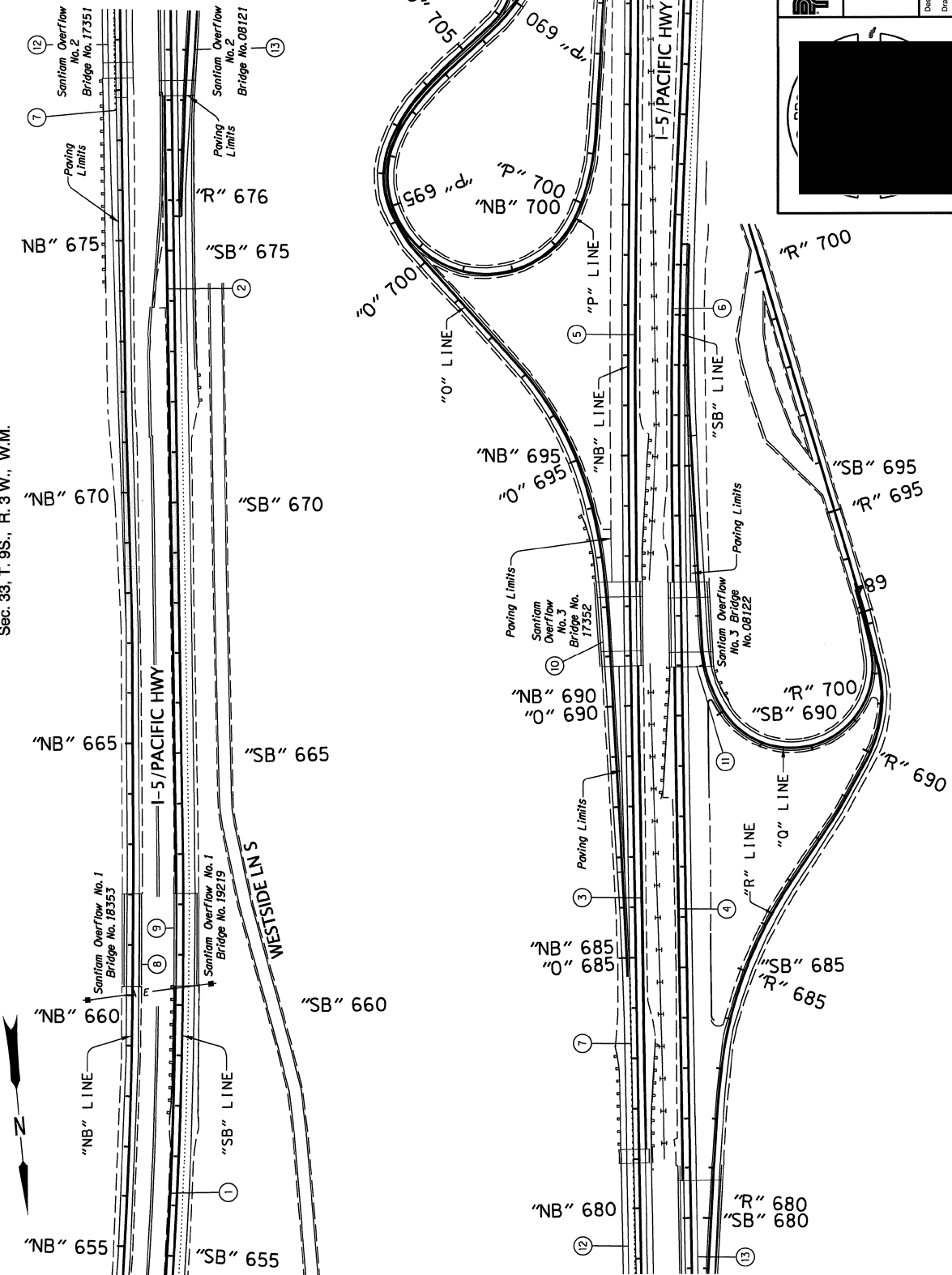

- 1 See sht. C04, note 5  
Const. continuous pattern rumble strips
- 2 Sta. "SB" 662+20 to Sta. "SB" 678+05.11.  
Const. continuous pattern rumble strips - 1585'  
(For details, see sht. B801)
- 3 Sta. "NB" 681+20 to Sta. "NB" 690+80.84  
Const. continuous pattern rumble strips - 960'  
(For details, see sht. B801)
- 4 Sta. "SB" "680+70" to Sta. "SB" 691+00.11.  
Const. continuous pattern rumble strips - 1030'  
(For details, see sht. B801)
- 5 Sta. "NB" "692+50" to Sta. "NB" 709+40.81.  
Const. continuous pattern rumble strips - 1690'  
(For details, see sht. B801)
- 6 Sta. "SB" 692+70 to Sta. "SB" 709+80.11.  
Const. continuous pattern rumble strips - 1710'  
(For details, see sht. B801)
- 7 Sta. "NB" 677+60 to Sta. "NB" 684+60  
Install 4" white dotted lane line
- 8 Structure no. 18353  
No work
- 9 Structure no. 19219  
No work
- 10 Structure no. 17352  
Pave end panels
- 11 Structure no. 08122  
Pave end panels
- 12 Structure no. 17351  
Pave end panels
- 13 Structure no. 08121  
Pave end panels

<p>DAVID EVANS AND ASSOCIATES INC. 630 Center Street NE Suite 605 Salem Oregon 97301 Ph: 503.361.8635</p>	<p>I-5 N. JEFFERSON - N. ALBANY SECTION PACIFIC HIGHWAY LINN AND MARION COUNTY</p>	<p>DESIGNER: Tai Inamura REVIEWER: Paul Tappana DRAFTER: Tammy Taggart CHECKER: Terry Wheeler</p>	<p>SHEET NO. C05</p>
			<p>GENERAL CONSTRUCTION</p>

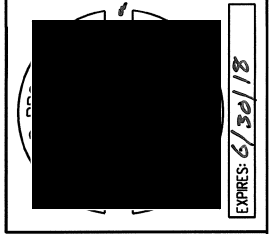

14987 Contract Plans 16/70

Sec. 39, T. 9S., R. 3 W., W.M.  
 Sec. 4, T. 10S., R. 3 W., W.M.

50V-051

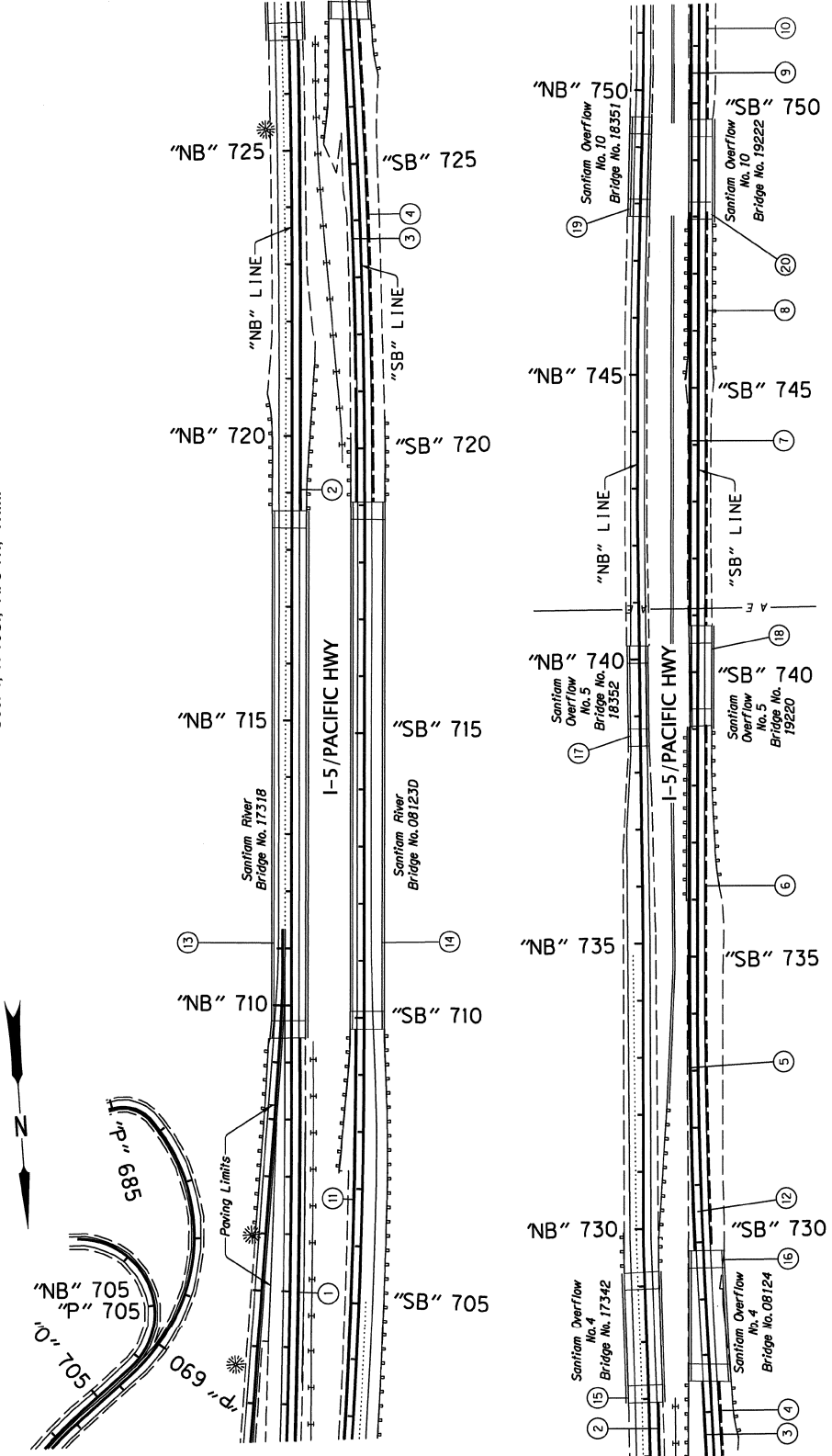

- ① See sht. C05, note 5  
Const. continuous pattern rumble strips
- ② Sta. "NB" 718+70 to Sta. "NB" 726+95, Rt.  
Const. continuous pattern rumble strips - 825'  
(For details, see sht. B801)
- ③ Sta. "SB" 719+10 to Sta. "SB" 727+55, L.I.  
Const. continuous pattern rumble strips - 845'  
(For details, see sht. B801)
- ④ Sta. "SB" 719+10 to Sta. "SB" 727+50, Rt.  
Const. bicycle gap pattern rumble strips - 840'  
(For details, see sht. B801)
- ⑤ Sta. "SB" 729+80 to Sta. "SB" 739+10, L.I.  
Const. continuous pattern rumble strips - 930'  
(For details, see sht. B801)
- ⑥ Sta. "SB" 729+80 to Sta. "SB" 739+10, Rt.  
Const. bicycle gap pattern rumble strips - 930'  
(For details, see sht. B801)
- ⑦ Sta. "SB" 740+80 to Sta. "SB" 747+95, L.I.  
Const. continuous pattern rumble strips - 715'  
(For details, see sht. B801)
- ⑧ Sta. "SB" 740+80 to Sta. "SB" 747+95, Rt.  
Const. bicycle gap pattern rumble strips - 715'  
(For details, see sht. B801)
- ⑨ Sta. "SB" 749+70 to Sta. "SB" 757+00, L.I.  
Const. continuous pattern rumble strips - 730'  
(For details, see sht. B801)
- ⑩ Sta. "SB" 749+75 to Sta. "SB" 752+50, Rt.  
Const. bicycle gap pattern rumble strips - 275'  
(For details, see sht. B801)
- ⑪ See sht. C05, note 6  
Const. continuous pattern rumble strips
- ⑫ AC pavement repair - 402 sq. yd.  
(For details, see sht. B802)
- ⑬ Structure no. 17318  
Pave end panels
- ⑭ Structure no. 08123D  
Pave end panels
- ⑮ Structure no. 17342  
No work
- ⑯ Structure no. 08124  
Pave end panels



**DAVID EVANS AND ASSOCIATES INC.**  
 500 NE Oregon Street  
 Salem, Oregon 97301  
 Phone: 503.361.8635

**I-5: N. ALBANY SECTION**  
 PACIFIC HIGHWAY  
 LINN AND MARION COUNTY

Designer: Tai Iimamura  
 Checker: Tom Wheeler

**GENERAL CONSTRUCTION**

SHEET NO. C06

EXPRES: 6/30/18

- ⑰ Structure no. 18352  
No work
- ⑱ Structure no. 19220  
No work
- ⑲ Structure no. 18351  
No work
- ⑳ Structure no. 19222  
No work