

To: Carl Allen- FAA Carl.k.allen@ [REDACTED]

Subject: Airplane crash- Goodan Ranch/Sycamore Canyon Park

Location: See attached map

While hiking at Goodan Ranch-Sycamore Canyon Reserve on December 29, our attention was drawn to the plane by the noise of the engine. The engine seemed to be struggling, cutting in and out. The plane initially appeared to gain altitude and appeared to be headed to the south or southeast. As we watched the plane it entered into a slow flat spin (we think it was to the right) almost like it was practicing engine shutdown, stall and recovery except that the spin continued and appeared to be poorly done- pitching in multiple directions. The engine continued to miss but the plane appeared to pull out of the spin as the engine restarted and the plane seemed to get power and started to pull up but then nosed over at a fairly steep angle and the engine went quiet. It disappeared behind the near ridge and a few seconds later we hear a loud thud and no more airplane noise. We concluded that the airplane had crashed and told the County Park's maintenance person, who happened to be driving by, what we saw but he went on about his business. When we saw him later he mentioned that he had heard on the radio that a plane had crashed.

The weather conditions were:

- mostly cloudy with some blue sky patches
- light wind
- cool

The plane when first observed was well beneath the cloud layer probably several thousand feet above the prevailing terrain.

Goodan Ranch/Sycamore Canyon Preserve

THIS MAP IS PROVIDED WITHOUT WARRANTY OF ANY KIND, EITHER EXPRESS OR IMPLIED, INCLUDING, BUT NOT LIMITED TO, THE IMPLIED WARRANTIES OF MERCHANTABILITY AND FITNESS FOR A PARTICULAR PURPOSE.

This product may contain information from SANDAG Regional Information System, which cannot be reproduced without the written permission of SANDAG.

This product may contain information which has been reproduced with permission granted by Thomas Brothers Maps.

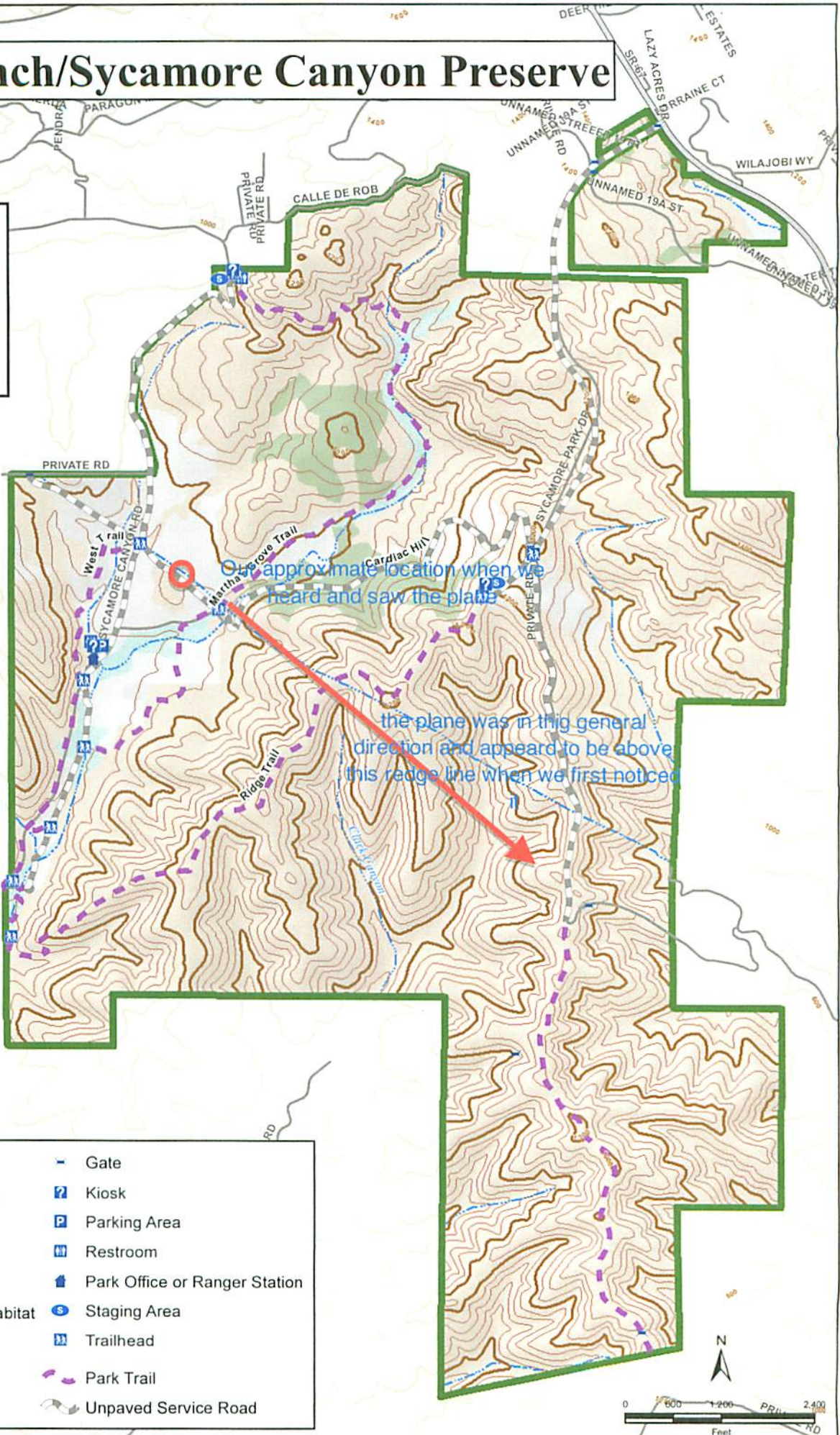

On approximate location when we heard and saw the plane

the plane was in this general direction and appeared to be above this ridge line when we first noticed

Park Boundary	Gate
200' Topographic Contours	Kiosk
40' Topographic Contours	Parking Area
Street	Restroom
Riparian and Bottomland Habitat	Park Office or Ranger Station
Scrub and Chaparral	Staging Area
Woodland	Trailhead
Non-Native or Developed	Park Trail
	Unpaved Service Road

