



Vehicle Attachment 1
Final Record and Technical Specifications for the Accident Bus

New York, NY
HWY-11-MH-005

(11 pages)

PREVOSTSte-Claire, Qué., Canada
G0R 2V0AUT.
H3-45Serial No.:
2PCH33491X1013259

Coach No.:

Date: OCTOBER 1999

Customer: WORLD WIDE TRAVEL, LTD.

Rev.:

PARTS NAME	MAKE	MODEL	PARTS NAME	MAKE	MODEL
ENGINE	D. DIESEL	SERIE 60 6067MK28	WHEEL SIZE	ACCURIDE	28510PW
SERIAL NO.		06R0508542	TOILET PUMP	ALCOA	893002, 893001
TRANSMISSION	ALLISON	B500	OPTIONAL EQUIPMENT		
SERIAL NO.		6610044402	EXTERIOR DOOR LOCKS: KEY CODE: PS11 KEYLESS IGNITION SWITCH FRONT ROOF EMERGENCY HATCH/VENT AUX. PREHEATING SYSTEM (WEBASTO 45,000 BTU) CONDENSOR WITH COPPER FINNS OVERHEAD A/C SYSTEM JACOBS ENGINE BRAKES ENG.WARR.5 Y/500,000 MI.PARTS & LABOR/S60(55) AUT.TRANS.WARRANTY/5 YEARS (W/O RETARDER) SPLASH GUARDS BETWEEN DIFF. AND TAG AXLES FIRESTONE MYLAR SPACERS (6) BEHIND WHEELS QUICK FRT.KNEEL.SUSP.(W/FULL HIGH & LOW BUOY) RADIO R.E.I. , VIDEO SYSTEM (5 MONITORS) SCENIC VIEW CAMERA SYSTEM (R.E.I.) COMPACT DISK PLAYER (6 STACKS) BATTERY CHARGER (24V/20 AMPS) A REAR LAVATORY ROLL TOWEL DISPENSER (90656)		
BELT, ALTERN. 24V	DAYCO	23523003	PAINT		
V-BELT, A/C	GATES RUBB.	BX-100	PAINT COLOR	MAKE	NUMBER
V-BELT, FAN	DAYCO	AX73	BLACK	BASIS (STANDOX)	MIX 571
BELT, TRANSF. FAN	DAYCO	5100495	WHITE (ROOF)	BASIS (STANDOX)	PREV.
AIR FILTER EL.	NELSON	70337-N	APRICOT	SCOTCHCAL 3M	220-64
ALTERNATOR	BOSCH	0 120 689 552	BRT. YELLOW	SCOTCHCAL 3M	220-15
SERIAL NO.		T1 964	OLYMPIC BLUE	SCOTCHCAL 3M	220-57
VOLTAGE REG.	DELCO-REMY	10457699	PEACOCK BLUE	SCOTCHCAL 3M	220-77
FRONT AXLE	GKN	S84 (0186)	BRT. GREEN	SCOTCHCAL 3M	220-186
REAR AXLE	ROCKWELL	RC23165NFCF1	DK. GREEN	SCOTCHCAL 3M	220-56
CARRIER	ROCKWELL	A-58-3200-P-1706	WHITE	SCOTCHCAL 3M	220-10
RADIO	ROCKWELL	4.30	BLACK	BASIS (STANDOX)	GM 41U 984A
TAG AXLE	DANA-SPICER	TS-6	CLEAR COAT	2K MS (RAPID CLEAR)	11760
AIR DRYER	BENDIX	AD-9	FINITION MATERIAL SPECIFICATIONS		
FR. BRK. CHAMB.	KNORR	BS3457II34671	MATERIAL	COLOR	NUMBER
RR. BRK. CHAMB.	KNORR	BS3456II34670	FLOOR COVERING	TARA GALAXY	8780
TAG BRK. CHAMB.	NKORR	BS9524II35699	LEATHERETTE	BLACK	860424
REAR BELLOWS	GOODYEAR	1R11-089		GREY	860585
FR. & TAG BEL.	GOODYEAR	1R12-319	FABRIC	A 416 WA	860783
STEERING PUMP	TRW	PS251615L10200		A 426 WA	860794
STEERING BOX	TRW	TAS 85097	FORMICA	N/A	
A/C COMPRESSOR	CARRIER	05GC141B10	CARPET	CR151	860808
SERIAL NO.		1899J04225			
COND. FAN MOT.	LEROY-SOMER	TF-12 (2)			
EVAP. FAN MOT.	LEROY-SOMER	T17, 2HP			
DRYER	HENRY	TC30RC			
DRIVER'S SEAT	ISRI	860912			
TIRES	MICHELIN	XZA-1			
SERIAL NO.	HRC 01087V	HRC 01382V			
	HRC 04359V	HRC 01381V			
	HRC 01390V	HRC 01387V			
	HRC 01411V	HRC 01084V			
	HRC 01061V				

Name: WORLD WIDE TRAVEL OF GREATER N.Y. LTD.
33 2ND AVE.

BROOKLYN NY
US 11215

Tel : 718-381-1775

Fax: 718-381-1804

Vehicle Type: Coach

Spec. Number : PD-99/04/15 11:10

Ref. P. L. : 3/1/1999

Contact : Michael Shub

Sales Manager : Tony Febbo

Conf. Vehicle

Conf. Vehicle

Conf. Vehicle

X3258 2PCH3349XX1013258

X3259 2PCH33491X1013259

OPTIONAL EQUIPMENT

Qty

WINDOWS & BODY ACCESSORIES

01.030	Thermopane side windows		1
01.060	Exterior door locks: key code: _____	PS 11	1
01.080	Keyless ignition switch (n/a w/W.C.L.)		1

A/C, HEATING & VENTILATION

02.020	Front roof emergency hatch/vent		1
02.032	Aux. preheating system ("WEBASTO" 45,000 BTU)		1
02.040	Condensor with copper fins		1
02.100	Overhead A/C system		1

ENGINE & MECHANICAL ACCESSORIES

03.046	Series "60" engine 12.7 l.(Fed.& Cal)		1
03.055	6-speed auto. "WORLD" trans. "B-500"		1
03.170	Differential ratio 4.30 (opt w/World trans)		1
03.195	"Jacob" engine brake on series 60 engine		1
03.210	Road speed governor (72 MPH) or Specify _____		1
03.290	Engine coolant filter (STD)		1
03.427	Eng.warr.5 Y/500,000 mi,parts & labor/S60 (55)		1
03.500	Aut. trans. warranty/5 years (W/O retarder)		1

BRAKES, WHEELS & SUSPENSION

04.010	Antilock braking system "ABS" STD		0
04.090	Aluminum polished wheels (9")(Max: 7) Qty: _____	7	7
04.100	Splash guards between diff. and tag axles		1
04.110	"Firestone" mylar spacers (6) behind wheels		1
04.187	Quick frt.kneel.susp.(w/full high & low buoy)		1
04.210	MICHELIN 315/80 R 22.5 "pilot" tires Qty: _____ STD	9	9

DRIVER SEAT & ACCESSORIES

05.017	"Ramco" ext. mirrors w/convex mirror on top (BLACK)		1
05.025	"ISRI" air-operated driver seat (6801 model)	MODEL 6800	1

Name: WORLD WIDE TRAVEL OF GREATER N.Y. LTD.
33 2ND AVE.

BROOKLYN NY
US 11215

Tel : 718-381-1775 Fax: 718-381-1804

Vehicle Type: Coach
Spec. Number : PD-99/04/15 11:10
Ref. P. L. : 3/1/1999
Contact : Michael Shub
Sales Manager : Tony Febbo

OPTIONAL EQUIPMENT

Qty

DRIVER SEAT & ACCESSORIES

05.080	Folding adjustable armrest L.H.	1
05.090	Folding adjustable armrest R.H.	1
05.170	Electronic speedometer & tachometer (STD) MI	1
05.220	Electrically adjustable outside mirrors STD	1
05.232	"12"-volt plug at left of driver	1

SOUND SYSTEM

06.020	R.E.I. AM/FM cassette receiver	1
06.040	Two extra speakers in driver area	1
06.080	Microphone outlet in R.H. modesty panel	1
06.090	Microphone outlet in L.H. modesty panel	1
06.165	Video system (5 monitors)	1
06.175	Scenic View camera system (R.E.I.) *SPECIAL*	1
06.200	Compact disk player (6 stacks)	1

ACCESSORIES

07.010	Battery charger (24 V/20 amps) at rear.	1
--------	---	---

WASHROOM

08.015	Lavatory roll towel dispenser (90-0656)	1
08.095	Lavatory "waste tank" heating system	1

PASSENGER SEAT & ACCESSORIES

09.020	Closed-type parcel racks	1	
09.090	Tour conductor seat (w/rh small plexiglass)	1	
09.100	Tourismo 42" seat model (std) Qty_____	56	56
09.170	Footrest Qty_____	52	52
09.175	Push button passenger chimes Qty_____ STD		0
09.280	Two card tables STD		1
09.340	Seat fabric trim no: _____	A 416 WA	1
09.350	(A/B) Seat cushions: _____	86-0783 A 416 WA	1
09.370	(C) Headrest: _____	86-0783 A 416 WA	1
09.380	(D/E) Sideboxing: _____	86-0794	1
09.390	(F) back of seat: _____	86-0808 CR151	1

Name: WORLD WIDE TRAVEL OF GREATER N.Y. LTD.
33 2ND AVE.

BROOKLYN NY
US 11215

Tel : 718-381-1775 **Fax:** 718-381-1804

Vehicle Type: Coach

Spec. Number : PD-99/04/15 11:10

Ref. P. L. : 3/1/1999

Contact : Michael Shub

Sales Manager : Tony Febbo

OPTIONAL EQUIPMENT

Qty

INTERIOR TRIM (ANNEX)

10.020	(A) Driver seat: _____	86-0783 /794	1
10.040	(B) Modesty panel: fabric_(ea.) _____ Qty _____	86-0783 A 416 WA	2
10.080	(C) Parcel racks: fabric _____	86-0783 A 416 WA	1
10.082	(C) TV Monitor covering (if not the same as 10.070/80)	86-0794	1
10.100	(D) Rear end: carpet _____	86-0808 CR151	1
10.130	(E) Side walls: carpet _____	86-0808 CR151	1
10.160	(F) Lavatory walls: carpet _____	86-0808 CR151	1
10.200	(G) Lavatory door: fabric _____	86-0783 A 416 WA	1
10.220	(H) Ceiling: fabric _____	86-0783 A 416 WA	1
10.230	(I) Floor: mat _____ color _____ no _____	TARA GALAXY 8780	1

DESTINATION SIGN (ANNEX)

11.010	No destination sign STD		1
--------	-------------------------	--	---

PAINT (ANNEX)

12.005	Base coat / clear coat paint type.		0
12.040	Paint scheme as proposed by PREVOST REF: _____	PROP REV. 99-05-17	1
12.080	No painted lettering STD		1
12.115	* Clear plastic stripes at frt. (anti-chip)		1
12.120	Scotchlite lettering (Quotation on request _____)		1
12.185	Lighter color on roof only (Qty:1)		1
12.500	EXTERIOR PAINT & LETTERING		0
12.510	BLACK GM 41U 984A	BAS. STANDOX	0
12.520	WHITE (ROOF) PREV	BAS. STANDOX	0
12.530	BLACK (STD.) MIX 571	BAS. STANDOX	0
12.540	BRT. YELLOW 220-15	3M SCOTCHCAL	0
12.550	OLYMPIC BLUE 220-57	3M SCOTCHCAL	0
12.560	PEACOCK BLUE 220-77	3M SCOTCHCAL	0
12.570	BRT. GREEN 220-186	3M SCOTCHCAL	0
12.580	DK. GREEN 220-56	3M SCOTCHCAL	0
12.581	APRICOT 220-64	3M SCOTCHCAL	0
12.582	WHITE 220-10	3M SCOTCHCAL	0

PREVOST

ORDER SPECIFICATION : H3-45 (H3)

Name: WORLD WIDE TRAVEL OF GREATER N.Y. LTD.
33 2ND AVE.

BROOKLYN NY
US 11215

Tel : 718-381-1775

Fax: 718-381-1804

Vehicle Type: Coach

Spec. Number : PD-99/04/15 11:10

Ref. P. L. : 3/1/1999

Contact : Michael Shub

Sales Manager : Tony Febbo

CHAPTER 8 : TECHNICAL INFORMATION

DIMENSIONS

Length Overall (over bumpers)

H3-4545' (13 716 mm)
H3-4141' (12 497 mm)

Width, Overall 102" (2 591 mm)

Height, Overall 12' (3 658 mm)
(over closed roof hatches)

Wheelbase

H3-45 317" (8 052 mm)
H3-41 268" (6 807 mm)

Cabin Floor Height 63" (1601 mm)

Ground Clearance 11" (280 mm)

Floor-to Ceiling Height 77" (1 956 mm)

Center Aisle Width 14" (356 mm)

Step Height from Ground 14" (356 mm)

Height of other Steps 7" (178 mm)

Entrance Door Opening Width 27" (685 mm)

Front Overhang 71.5" (1 816 mm)

Rear Overhang 103.5" (2 628 mm)

Front Track 84.4" (2 145 mm)

Drive Track 76.7" (1 949 mm)

Rear Track 83.6" (2 124 mm)

Turning Radius (exterior front corner)

H3-4545.7' (13 930 mm)
H3-4139' (11 885 mm)

WEIGHTS

GVW 49 000 lbs (22 270 kg)

Dry Weight (w/6-Cyl. & World. Trans.)

H3-45 33 800 lbs (15 330 kg)
H3-41 32 400 lbs (14 695 kg)

Gross Axle Weight Rating (G.A.W.R.)

Refer to the Coach Final Record located in the technical publication package supplied with the coach.

STORAGE VOLUME

Exterior baggage compartments:

H3-45470 ft³ / 13,3 m³
H3-41360 ft³ / 10,2 m³

Parcel racks:

H3-4592 ft³ / 2,6 m³
H3-4184 ft³ / 2,4 m³

SEATS

Seating capacity: (Normal configuration)

Including 1 or 2 card table(s)

H3-4556
H3-4148

NOTE : *Several seating layouts may be obtained through a combination of available equipment with the addition or removal of some items such as passengers' seats, card table, galley and lavatory.*

H3-45 OVERALL DIMENSIONS (SIDE ELEVATION)

115

18449

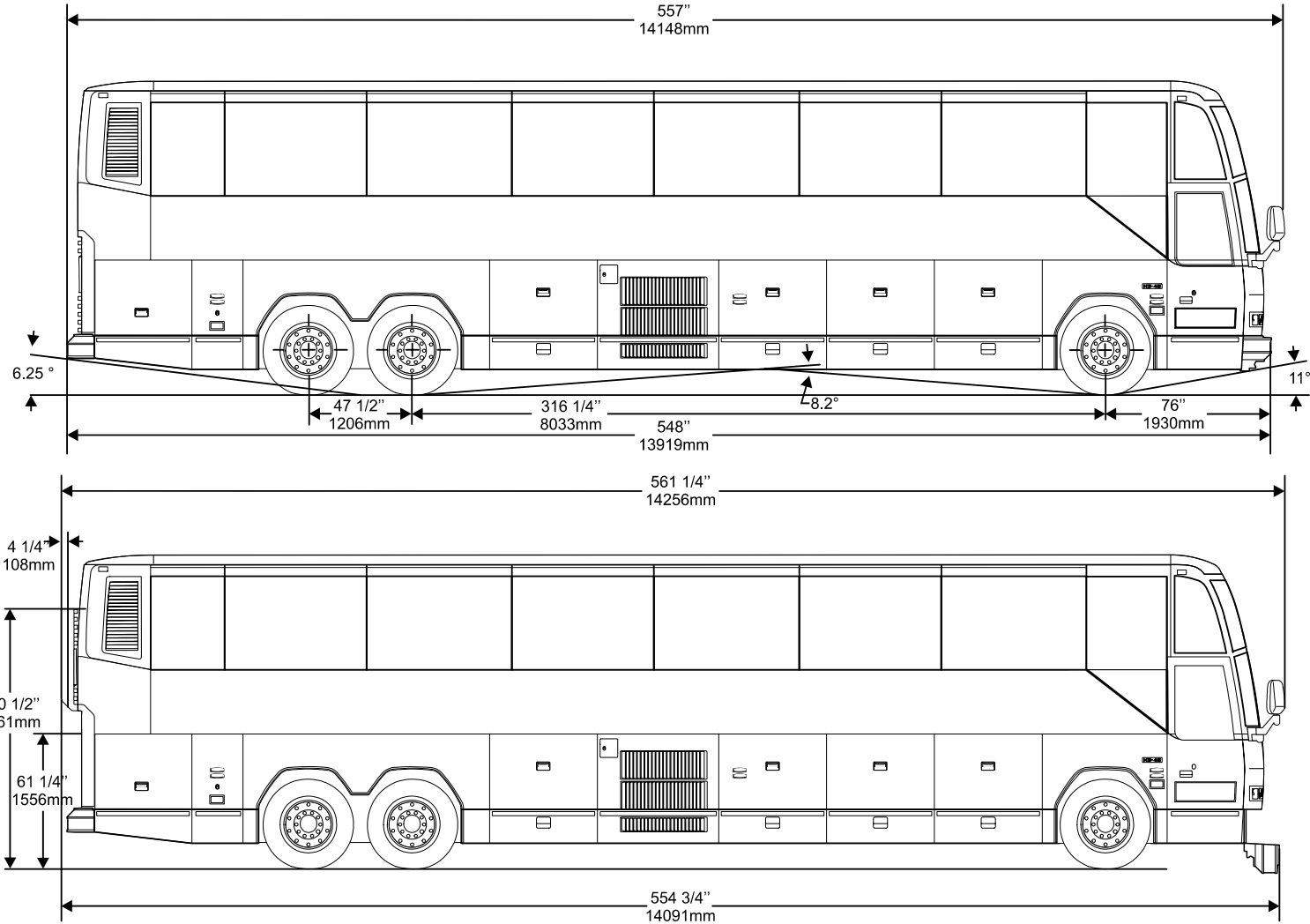

TECHNICAL INFORMATION

TECHNICAL INFORMATION

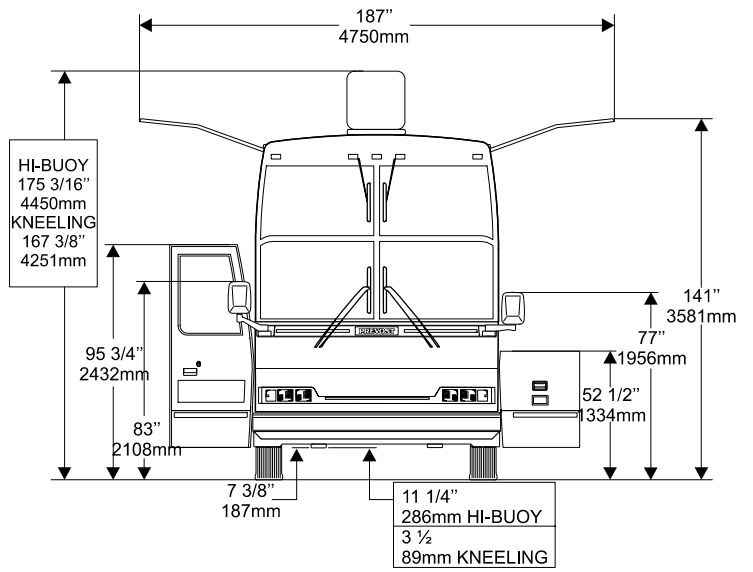
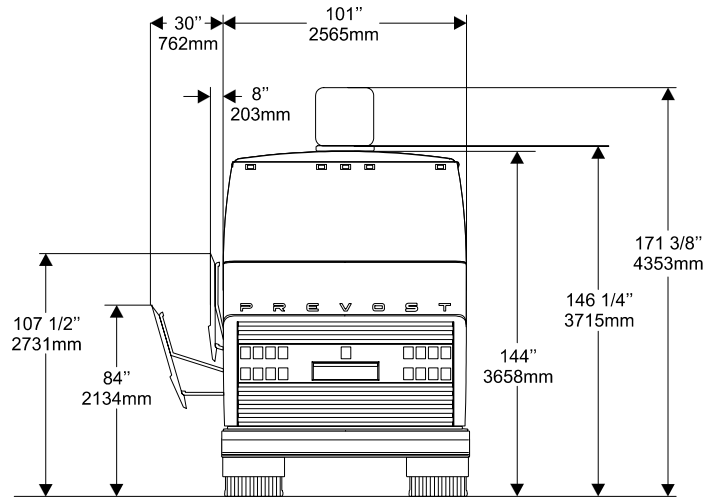
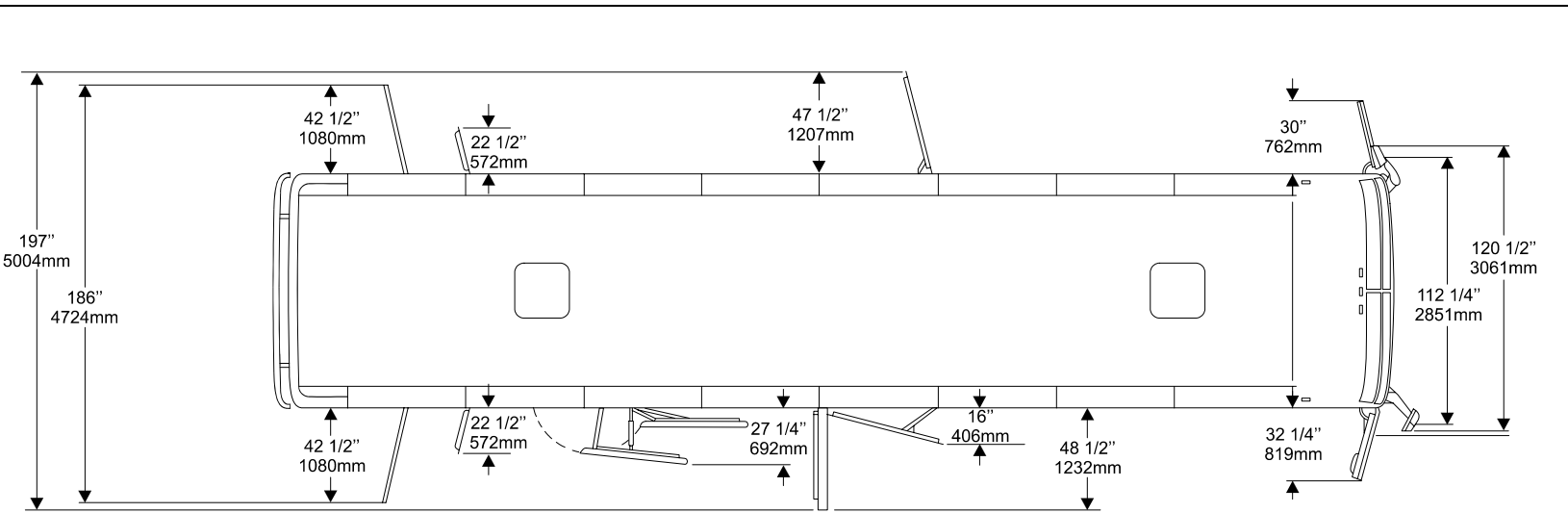

H3-41 AND H3-45 OVERALL DIMENSIONS (TOP, FRONT AND REAR VIEWS)

BANDES DE PLANCHER AVEC SIEGES AMAYA AUTOCAR H3-45'

LISTES	NBRE PASSAGERS	TABLE CARTE	POSITION TABLE A CARTE				" DROITE "														POSITION PIEDESTALS														" GAUCHE "													
			GA.	DR.	T. G.	TG. 2	T. D.	TD. 2	A	B	C	D	E	F	G	H	I	J	K	L	M	N	R.D.	O	P	Q	R	S	T	U	V	W	X	Y	C	A1	B1	C1	R.G.									
1	325813	52 PASS. SANS TABLE	0	0			723	1593	2463	3333	4203	5073	5943	6813	7683	8553	9423	10293	11163	599	558	1468	2370	3272	4174	5076	5978	6880	7782	8684	9586	10488	11390					604										
2	325583	52 PASS. 1 TABLE CARTE G.	1	0	10626		723	1593	2463	3333	4203	5073	5943	6813	7683	8553	9423	10293	11163	599	558	1468	2353 R	3318	4216	5114	6012	6910	7808	8706	9604	10502	11400					594										
3	325582	52 PASS. 2 TABLES A CARTE	1	1	10626	10737	723	1608 R	2573	3433	4293	5153	6013	6873	7733	8593	9453	10313	11173	589	558	1468	2353R	3318	4216	5114	6012	6910	7808	8706	9604	10502	11400					594										
4	325815	52 PASS. 4 TABLES A CARTE	2	2	10626	8776 10737 8887	723	1608 R	2573	3458 R	4423	5267	6111	6955	7799	8643	9487	10331	11175	587	558	1468	2353 R	3318	4203 R	5168	6057	6946	7835	8724	9613	10502	11391					603										
5	325817	54 PASS. SANS TABLE	0	0			723	1593	2463	3333	4203	5073	5943	6813	7683	8553	9423	10293	11163	599	558	1468	2300	3132	3964	4796	5628	6460	7292	8124	8956	9788	10620	11452					542									
6	325819	54 PASS. 1 TABLE A CARTE G.	1	0	10626		723	1593	2463	3333	4203	5073	5943	6813	7683	8553	9423	10293	11163	599	558	1468	2353 R	3318	4132	4946	5760	6574	7388	8202	9016	9830	10644	11458					536									
7	325821	54 PASS. 1 TABLE A CARTE C.	0	1		10737	723	1608 R	2573	3433	4293	5153	6013	6873	7733	8593	9453	10313	11173	589	558	1468	2300	3132	3964	4796	5628	6460	7292	8124	8956	9788	10620	11452					542									
8	325580	54 PASS. 2 TABLES A CARTE	1	1	10626	10737	723	1608 R	2573	3433	4293	5153	6013	6873	7733	8593	9453	10313	11173	589	558	1468	2353 R	3318	4132	4946	5760	6574	7388	8202	9016	9830	10644	11458					536									
9	325823	54 PASS. 4 TABLES A CARTE	2	2	10626	8776 10737 8861	723	1608 R	2599	3484 R	4475	5313	6151	6989	7827	8665	9503	10341	11179	584	558	1468	2353 R	3318	4203 R	5168	5949	6730	7511	8292	9073	9854	10635	11416					578									
10	325577	56 PASS. SANS TABLE	0	0			723	1530	2337	3144	3951	4758	5565	6372	7179	7986	8793	9600	10407	11214	548	558	1468	2300	3132	3964	4796	5628	6460	7292	8124	8956	9788	10620	11452					542								
11	325581	56 PASS. 1 TABLE A CARTE C.	1	0	10626		723	1530	2337	3144	3951	4758	5565	6372	7179	7986	8793	9600	10407	11214	548	558	1468	2353 R	3318	4132	4946	5760	6574	7388	8202	9016	9830	10644	11458					536								
12	325825	56 PASS. 1 TABLE A CARTE C.	0	1		10737	723	1608 R	2573	3360	4147	4934	5721	6508	7295	8082	8869	9656	10443	11230	532	558	1468	2300	3132	3964	4796	5628	6460	7292	8124	8956	9788	10620	11452					542								
13	325576	56 PASS. 2 TABLES A CARTE	1	1	10626	10737	723	1608 R	2573	3360	4147	4934	5721	6508	7295	8082	8869	9656	10443	11230	532	558	1468	2353 R	3318	4132	4946	5760	6574	7388	8202	9016	9830	10644	11458					536								
14	325827	56 PASS. 4 TABLES A CARTE	2	2	10626	8776 10737 8887	723	1608 R	2573	3458 R	4423	5185	5947	6709	7471	8233	8995	9757	10519	11281	482	558	1468	2353 R	3318	4203 R	5168	5949	6730	7511	8292	9073	9854	10635	11416					578								
15	325579	56 PASS. SANS TABLE	0	0			723	1530	2337	3144	3951	4758	5565	6372	7179	7986	8793	9600	10407	11214	548	558	1468	2236	3004	3772	4540	5308	6076	6844	7612	8380	9148	9916	10684	11452					542							
16	325578	56 PASS. 1 TABLE A CARTE C.	0	1		10737	723	1608 R	2573	3360	4147	4934	5721	6508	7295	8082	8869	9656	10443	11230	532	558	1468	2236	3004	3772	4540	5308	6076	6844	7612	8380	9148	9916	10684	11452					542							

"R" = SIEGE ROTATIF (PIEDESTAL COURT)

CANCEL

Remplacé par : D360288P2
DAC # 17010
MARCEL BARRIBEAULT, 2005/06

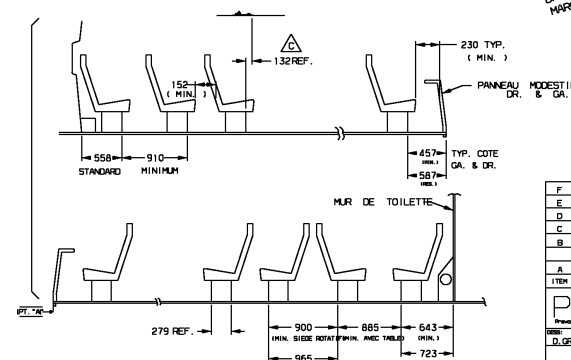
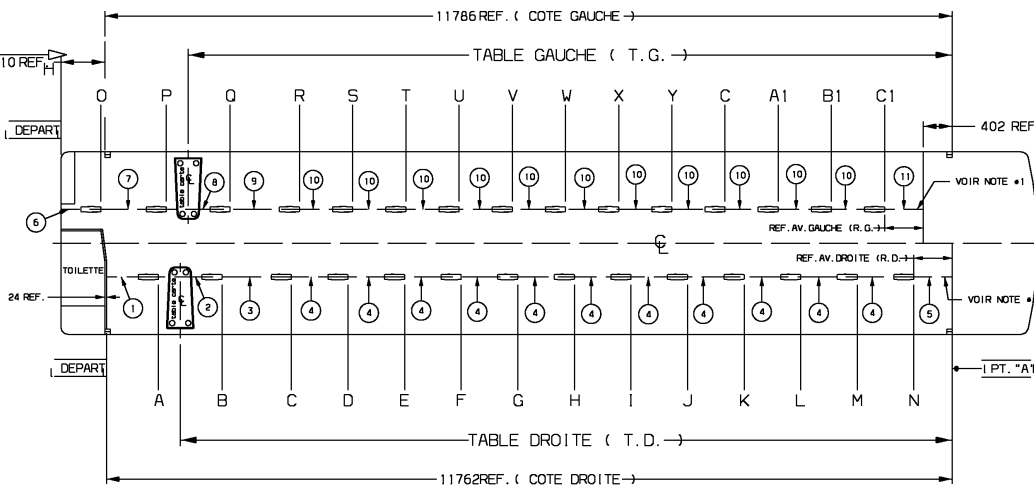

NOTE 1: DECOUPER LES BANDES #5 ET #11 SI NECESSAIRE.

DESSIN FAIT EN SOUS-TRAITANCE
PAR: A. CLAVEAU GENI CADE

MATERIEL: N/A
FINI: N/A

REF.: AMENAGEMENT SIEGES TOURISMO & ULTIM
TITRE: BANDES DE PLANCHER AUTOCAR H3-45'

PIECE No: D360288 P1

COPIE NON A L'ECHELLE

PRESTO logo and revision table:

F	2004/09	CHANGEMENT BANDES AVEC O.C. 000004	JPT
D	2003/12	AJOUT DE LA PAGE 2	PLAN
E	06/01	C.D. #4879 D.C. #11719	R.L.
C	11/91	C.D. #3678 D.C. #7053	J.L.
B	02/97	REVISION GENERALE	R.L.
A	96/07	LANCE O.C. #35173	D.G.
1788		REVISION	PLAN

PRESTO logo and technical details:

PROJET DE: M. BARRIBEAULT
DATE: 05/07
NOM: S. CHARRIER
TOL. GENERALES: (ECHELLE: 1:5) (PROJ.)
3- CIG - COORDONNEE: #0360210

4

3

2

1

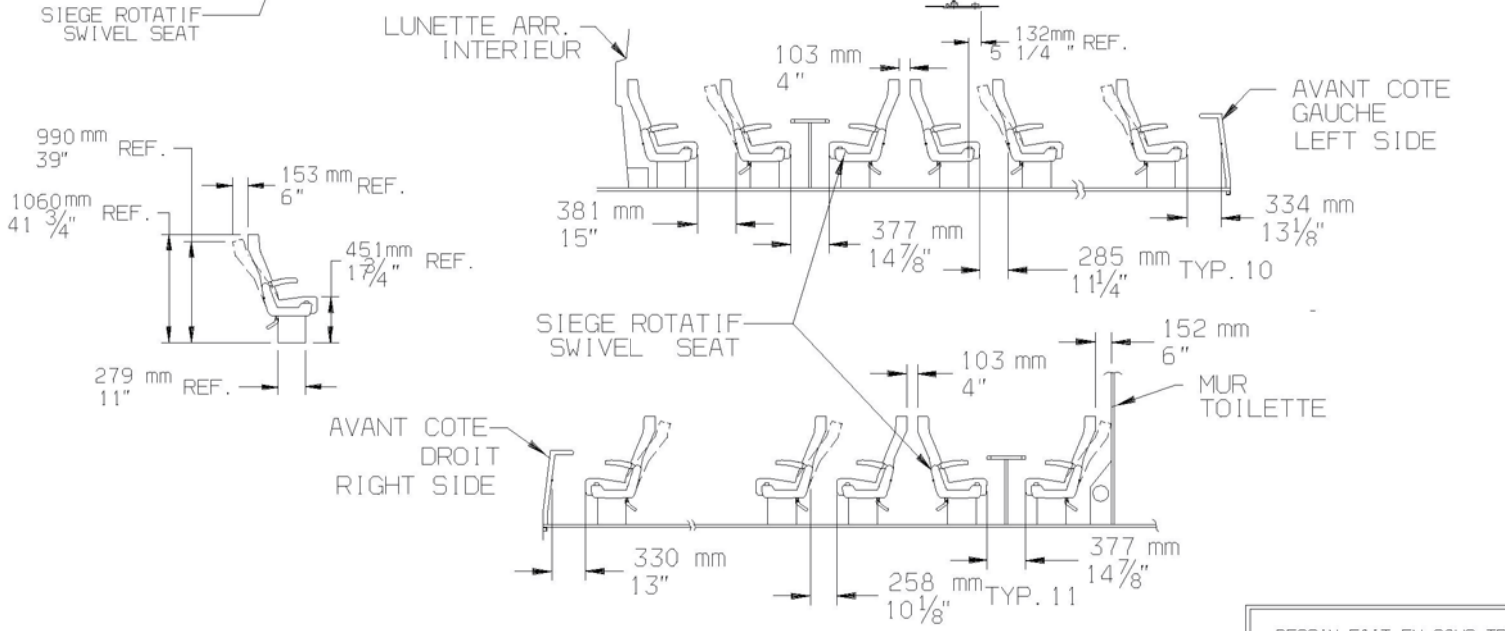
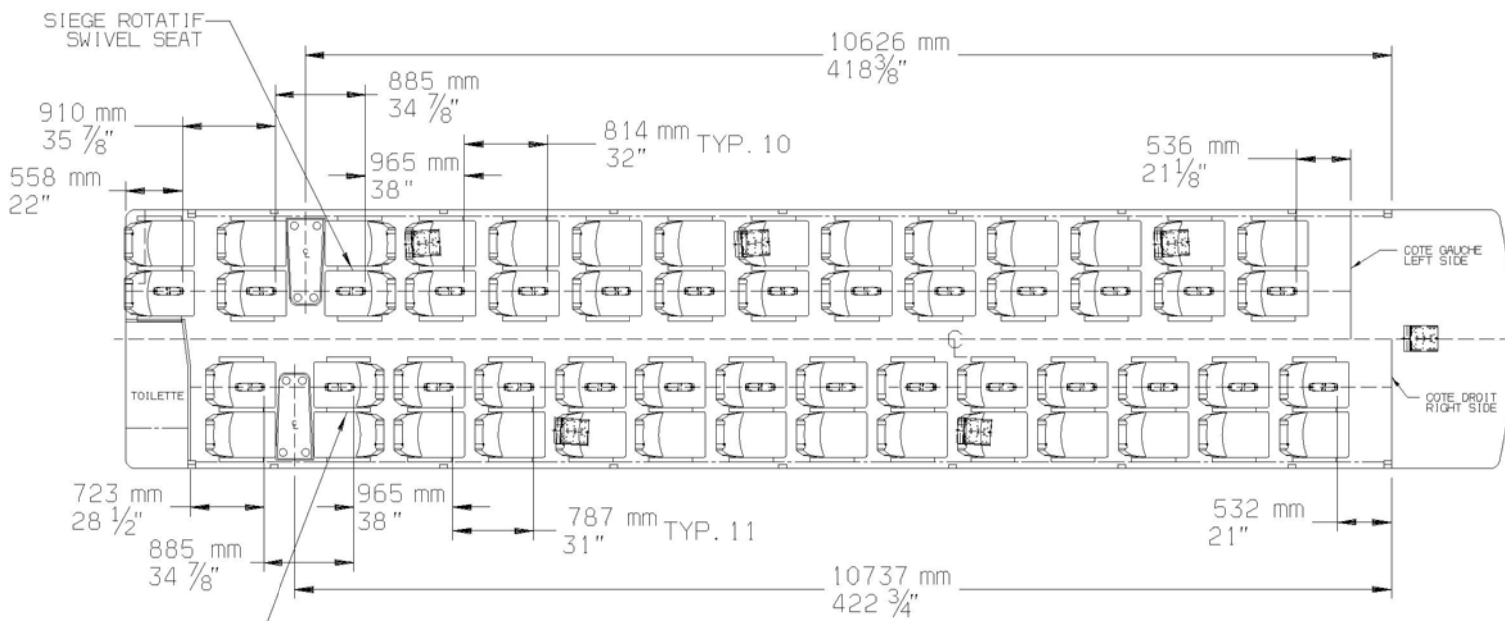

DESSIN FAIT EN SOUS-TRAITANCE
 PAR: D. MENARD DE: GENICAD

CE DOCUMENT EST LA PROPRIETE EXCLUSIVE DE PREVOST CAR INC. S'IL EST REPRODUIT OU UTILISE SANS LE CONSENTEMENT ECRIT DE PREVOST CAR INC. THIS DOCUMENT IS THE EXCLUSIVE PROPERTY OF PREVOST CAR INC. S'IL EST REPRODUIT OU UTILISE SANS LE CONSENTEMENT ECRIT DE PREVOST CAR INC.

A	08/00		R. L.
ITEM	DATE	REVISION	PAR
PREVOST		3° ANGLE	
Prevost Car Inc. Ste-Clair, Quebec, Canada G0R 2V0		METRIQUE	
DESS:	DATE:	VER:	APP:
R. LAPOINTE	31/08/00		S. CARRIER
TOL. GENERALES		ECHELLE: 1=1	POIDS:
mm ± 2	deg ±	DESSIN REF.:	
MATERIEL: N/A			
FINI.: N/A			
REF.: VEHICULE H3-45 (SIEGE PREVOST)			
TITRE: ARR. SIEGE 56P. 2TB			
PIECE No: D360491P15			CAD

4

3

2

1