

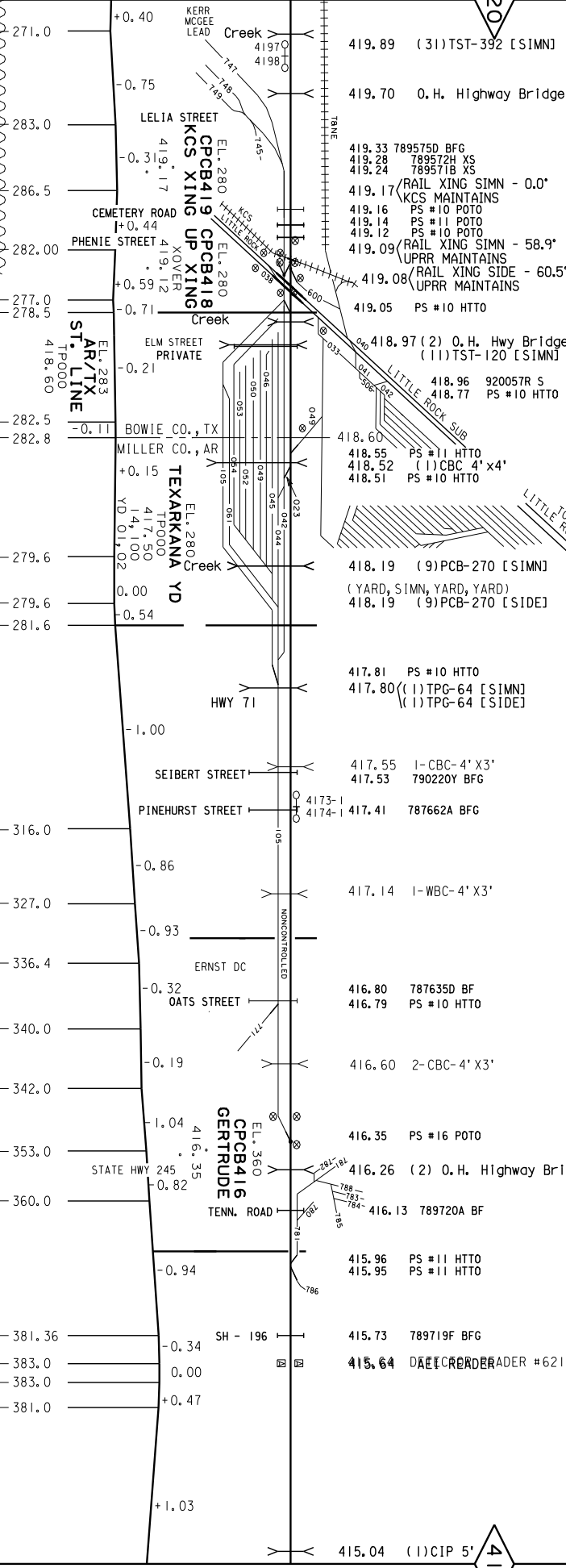

\* CONSTRUCTED BY TEXAS AND ST. LOUIS RAILWAY-1882 AS NARROW GAUGE-CHANGED TO STANDARD GAUGE 10-18-1886  
 \* NARROW GAUGE-CHANGED TO STANDARD GAUGE 1-12-1887 AS  
 ST. LOUIS SOUTHWESTERN RAILWAY ACQUIRED BY UNION PACIFIC - STB FINANCE DOC # 32760 EFFECTIVE SEPTEMBER 11, 1996



CURVE	SPEED
60	60
170	70
20	70
10	10
35	35
20	20
50	50

RAIL	SIMN	RAIL	SIMN	RAIL	SIMN	RAIL	SIMN	RAIL	SIMN
	136	136	136	136	136	136	136	136	136
2014	2014	2014	2014	2014	2014	2014	2014	2014	2014
2014	2014	2014	2014	2014	2014	2014	2014	2014	2014
2012	2012	2012	2012	2012	2012	2012	2012	2012	2012
2010	2010	2010	2010	2010	2010	2010	2010	2010	2010
2013	2013	2013	2013	2013	2013	2013	2013	2013	2013
2010	2010	2010	2010	2010	2010	2010	2010	2010	2010
2014	2014	2014	2014	2014	2014	2014	2014	2014	2014
2012	2012	2012	2012	2012	2012	2012	2012	2012	2012
2014	2014	2014	2014	2014	2014	2014	2014	2014	2014
2013	2013	2013	2013	2013	2013	2013	2013	2013	2013
2014	2014	2014	2014	2014	2014	2014	2014	2014	2014

Lost Updated: 07/16/2015

p:\15 north little rock\pages\pine bluff sub\08\pine bluff sub-08-1d