

11-8-96-1

# RIGHT WING RW37

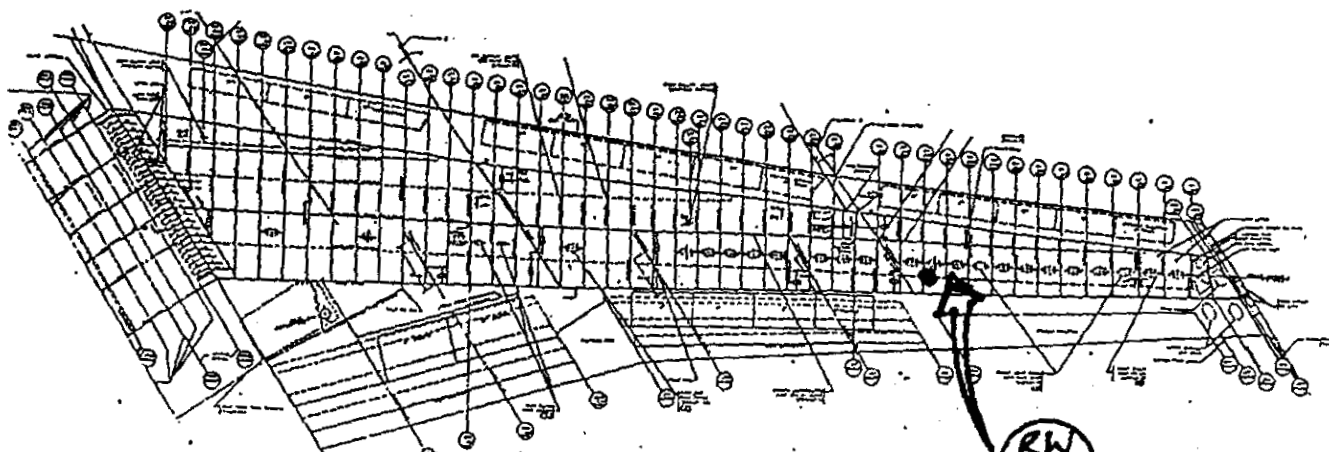

ORANGE W2003  
 LOG # C 6592-134  
 TARGET # -

COORD LAT N/A -  
 LONG N/A -  
 OBSERV FIELD GREEN

RIGHT WING UPPER SKIN PANEL LOCATED JUST OUTBOARD OF THE NO 4 NAAGLE RIB. THE 3' X 4' SECTION EXTENDS FROM WS 1196 TO WS 1252 AND ENCOMPASSES STRINGER REMAINT'S 5 THRU 9, INCLUDING A SECTION OF REAR SPAR CHORD FLANGE. A SECTION OF FIXED TRAINING GOUGE UPPER FIBER GLASS PANEL EDGE REMAINS ATTACHED AND EXTENDS ALONG THE AFT SKIN EDGE. THE PANEL SKIN SECTION SEPARATED IN A DUCTILE MANNER WITH STRINGER NO'S 5 THRU 9 AND THE REAR SPAR CHORD FLANGE, SEPARATING ALONG THE JUNCTION RADIUS OF EACH STRINGER ELEMENT STEM AT THE FLANGE TO SKIN AS INDICATED IN SECTION A-A.

THE PANEL FINISH IS PRIMARILY INTACT WITH NO DEGRADATION OR OBVIOUS ANOMALY, EXCEPT FOR SOME SALT WATER CORROSION ALONG THE EXTERNAL SURFACE BETWEEN STRINGERS 5 AND 7 COVERING APPROX 5" X 10". THE PANEL SHOWED NO SIGNS OF SCOTCH, FIRE OR IMPACT DAMAGE, AND THE SKIN IS RELATIVELY FLAT EXCEPT FOR SOME SLIGHT OUT OF PLANE DEFORMATION ALONG THE INBOARD EDGE INDICATIVE OF PANEL BENDING.

Stephen D. Johnson - ALPA  
 1/3-22-97

Chanderhinder  
 JWA 3/22/97

Dominicanting IAM  
 4-3-97

Stephen F. Klupach J  
 FAA-04-03-97 KNP  
 11.9.96

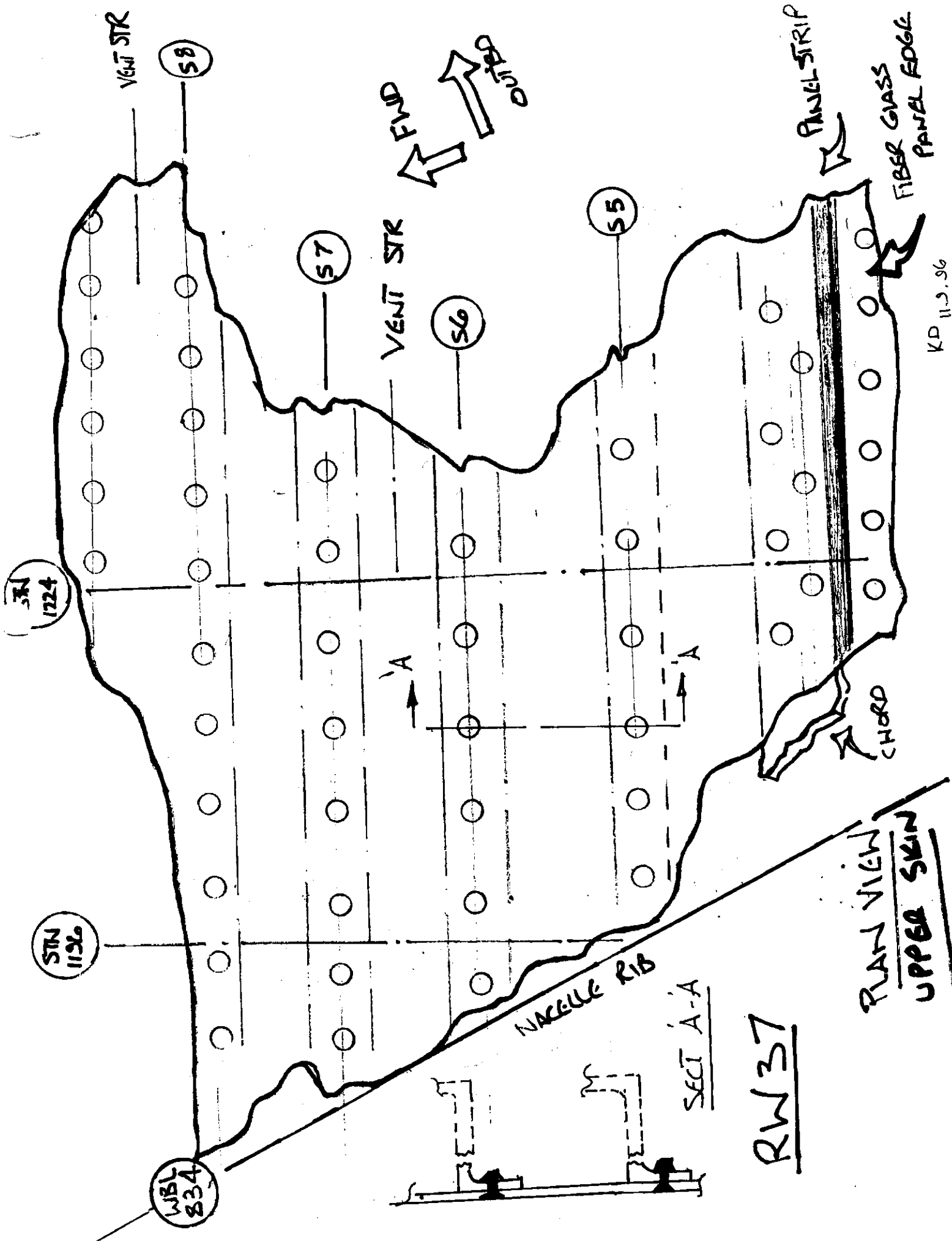

KD 11.9.96

NPA STRUT

WS 1196

WS 1214

WS 1252

WS 1280

WS 1308

WS 1336

WS 1364

FRONT SPAR

RWB

RW20

RW4

S13

S8

REAL SPAR

RW 9

RW 37

FWD

INBD

NOT RECOVERED

11.9.96

