

RIGHT WING RW-32

Page 1 of 2

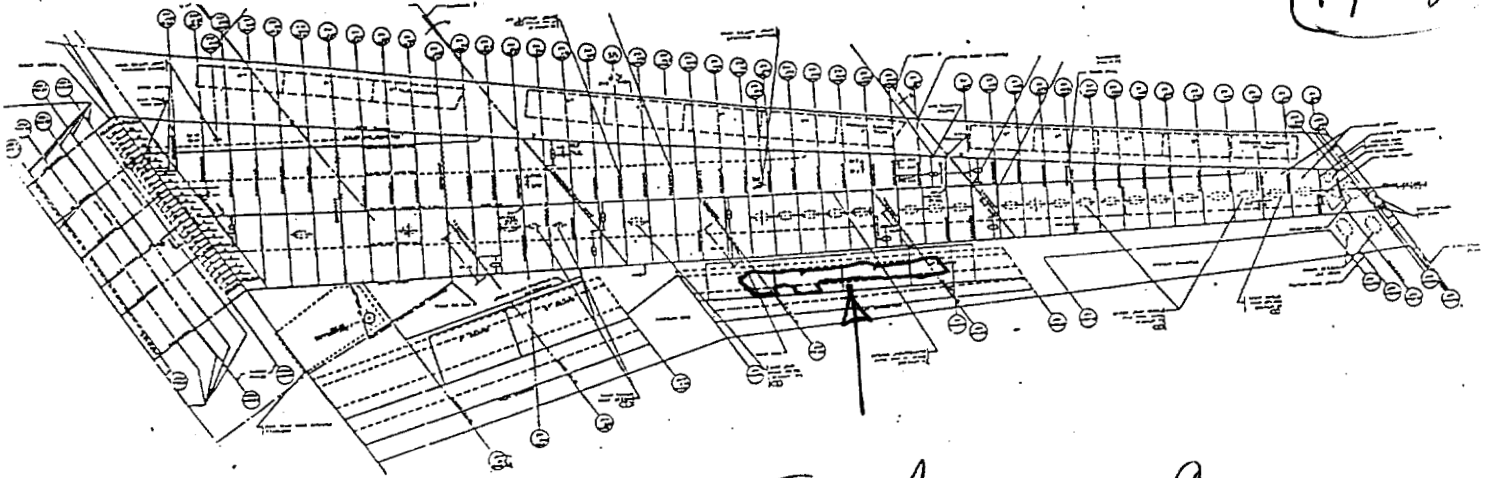

SEE ADDITIONAL COMM

LOG # RW-32
TARGET # C-210

COORD: LAT 40.39.47
LONG 72.37.27
DEBRIS FIELD GREEN

RH WING - OUTBOARD FOREFLAP SEGMENT, 16 FT LONG, BETWEEN FLAP TRACKS #7 AND #8, LEADING EDGE TORN OFF, EVIDENCE OF WATER IMPACT DAMAGE, SOME LIGHT SCOOTING. MOST OF TE WEDGE TORN OFF. ONE FOREFLAP TRACK STILL ATTACHED.

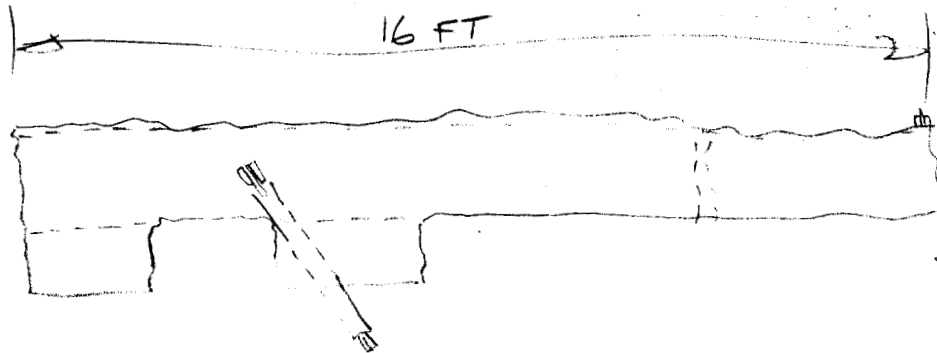

D. ORTH - BOEING
10/20/96

Stephen F. [unclear]
FAA 10 27 96
MC PHOTO

B. VANDERHOUTEN
TWA 11/18/96

Dennis Lortz IAM
11-27-96

SD GREEN
11-13-96

REFER FIRE AND EXPLOSION GROUP NOTES FOR FIRE D.

1

RW-32 Additional Comments

This piece exhibits a significant spanwise crease just aft of the spanwise web (spar?), This crease passes across the fore flap track, and corresponds with the spanwise web rolling aft to nearly flat.

SD GREEN ALPA

11-13-96

D. Olt
BOEING 6 DEC 96

Dennis Santiago IAM
12-6-96

 - IAM
12-6-96

Neil Serville - TWA

12-6-96

Tom Thomas
IAM 12-6-96