

# RIGHT WING RW-31

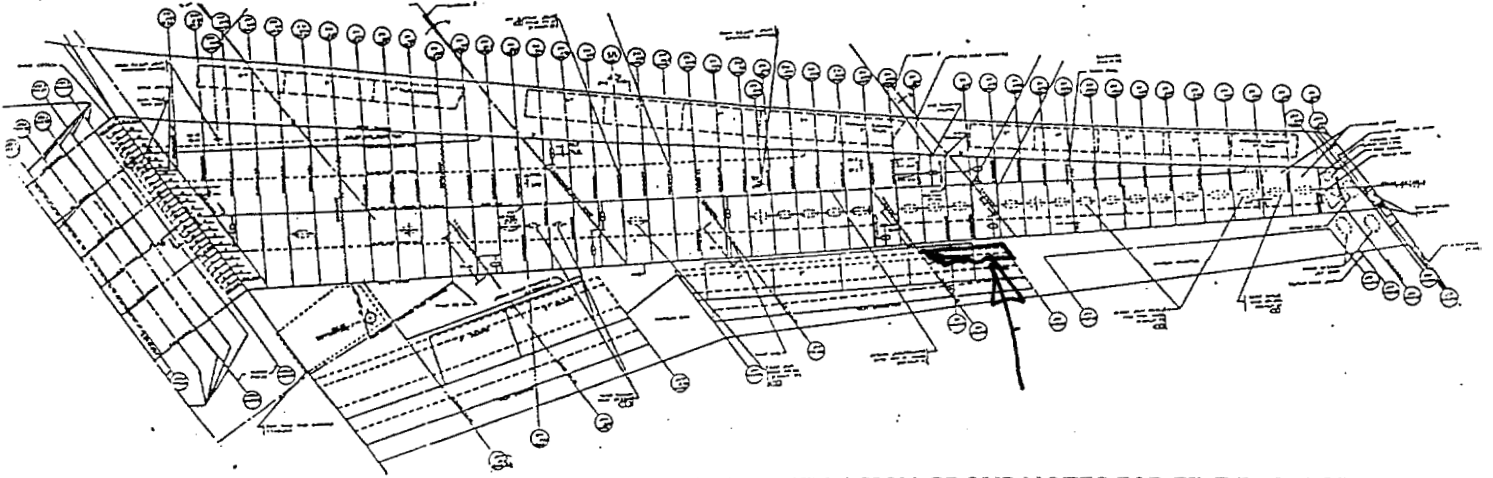

REFER FIRE AND EXPLOSION GROUP NOTES FOR FIRE DAMAGE

LOG # RW-31

COORD: LAT \_\_\_\_\_

TARGET # \_\_\_\_\_

LONG \_\_\_\_\_

DEBRIS FIELD GREEN

TAG # C2374

RH OUTBD FLAPS - FOREFLAP SEGMENT - 8 FT LONG  
BY 1 FT WIDE, LEADING EDGE OF FORE FLAP WITH  
ENTIRE TRAILING EDGE WEDGE TORN OFF. LIGHT SOOT,  
NO BURNING EVIDENT. APPARENT IMPACT DAMAGE.

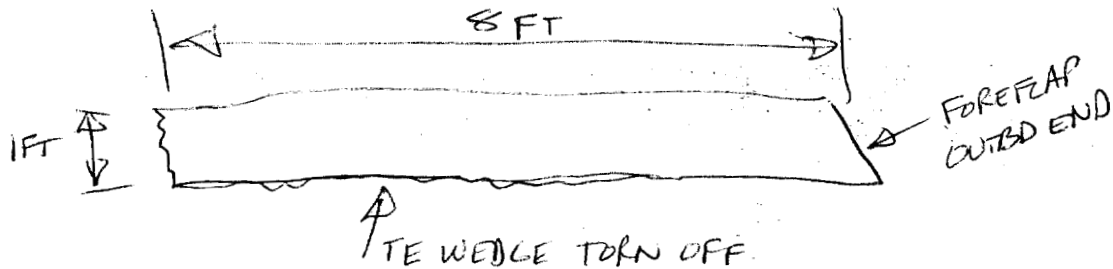

REFER FIRE AND EXPLOSION GROUP NOTES FOR FIRE DAMAGE

Dennis Santiago IAM  
11-27-96

D. ORTH - BOEING  
10/20/96

Stephen F. Klepall Jr.  
FAA 10-29-96  
No Photo

SB GREEN ALPA  
11-13-96

B. VANDERHEIDEN  
TWA 11/18/96

1