

WING UPPER SURFACE SKIN PIECES

RW 19 (9/25/96-2) Z 2807

RW 20 (9/19/96-1, Z 3274, GREEN)

RW 21 (9/22/96-1) Z 2806

LENGTHS + WIDTHS (IN)	L	W
RW19	36	11
RW20	96	33
RW21	67	14

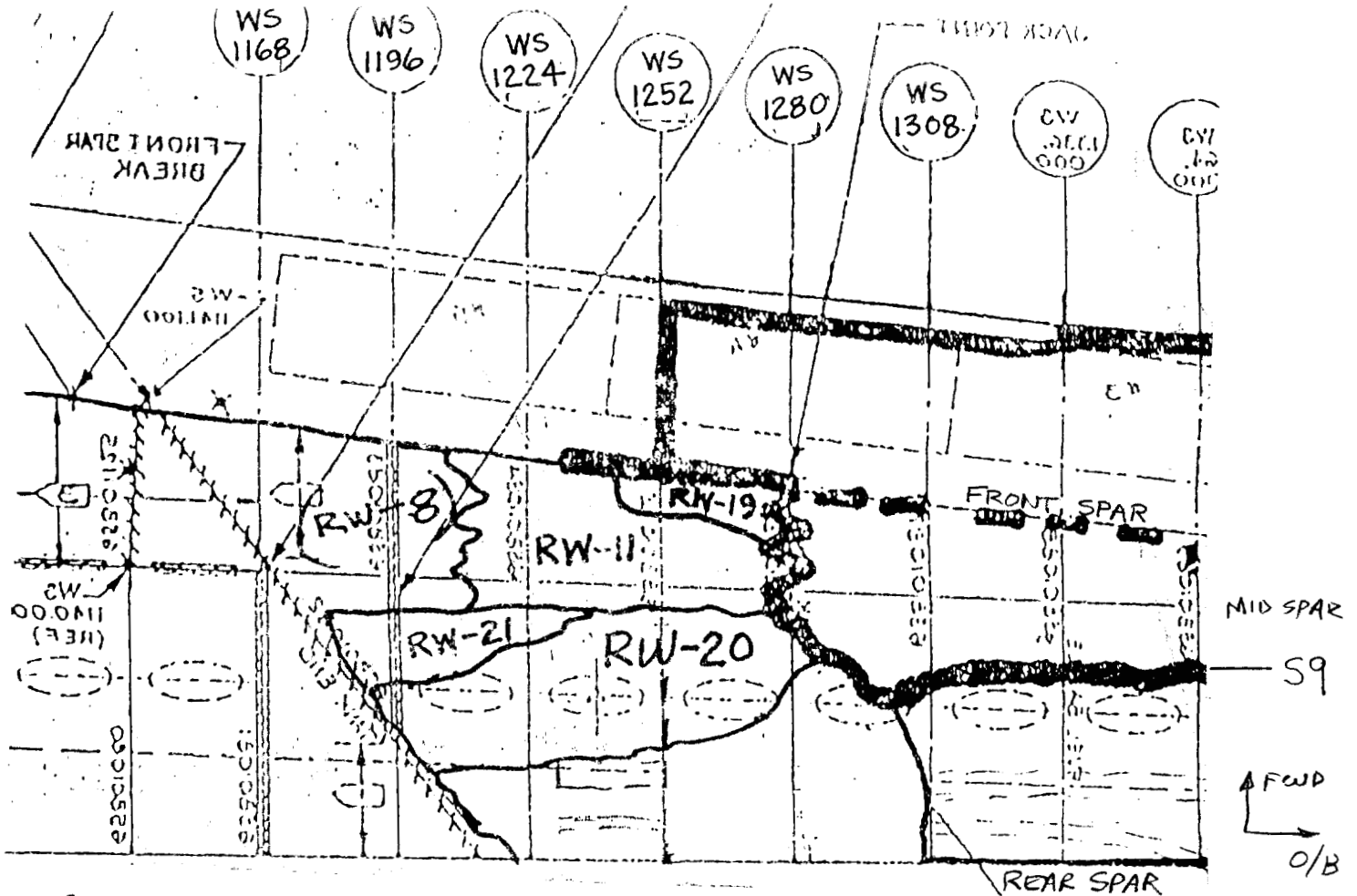

COMMON DETAILS

- NO SOOT ON INSIDE OR OUTSIDE OF SKIN EXCEPT UNDER LEADING IN FRONT OF FRONT SPAR
- FRACTURE FACES JAGGED AND FREE OF SOOT
- PORTIONS OF STRINGERS AND SPARS ATTACHED FRACTURED AT UPSTANDING WEB BASE.
- ENDS OF PANELS BENT UP

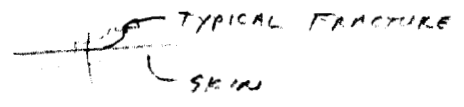

SCREEN - ACFT
1-13-96 IAM
Damaged 11-24-96 TWA
10-13-96 FIA
10-14-96

L. Thompson - BOEING

9-28-96