

LOG # RF 59 ^{RF 10/21/96}

TARGET # 14

COORD: LAT 40:39:50:14

LONG 72 37 27-24

GREEN TAG C236

DEBRIS FIELD GREEN

TAG# C 236

THIS SECTION IS THE UPPER FWD INBOARD SECTION OF THE RIGHT HAND WHEEL WELL AND IS APPROX 2 1/2 FEET X 6 FT IN DIMENSION. IT INCLUDES TWO OF THREE WHEEL WELL LIGHTS, L131 & L132. IT RUNS FROM STATION ^{1265 RA/12/14/96} ~~1360~~ BACK TO ^{1327 RA/12/17/96} ~~1360~~. ALSO ATTACHED IS A PORTION OF THE WHEEL WELL FIRE DETECTION LOOP. THE VERTICAL SECTION OF ^{BL 98.58 FLR BEAM RA/12/14/96} ~~STATION 1360~~, APPROX 10 INCHES IN HEIGHT, IS CRUSHED, FRACTURED AND SHOWS SIGNS OF HEAVY SMOKE DAMAGE.

NAC 27 FEL-397
" "

TOD mo 1 ZABDIA
FAA

8/26/96

R Hanover 12/17/96
TBC

Dennis Santiago
IAM 10/19/96

Stephen F Klapach sr
01-22-97 FAA

Dennis Santiago IAM
12-17-96

RF 59

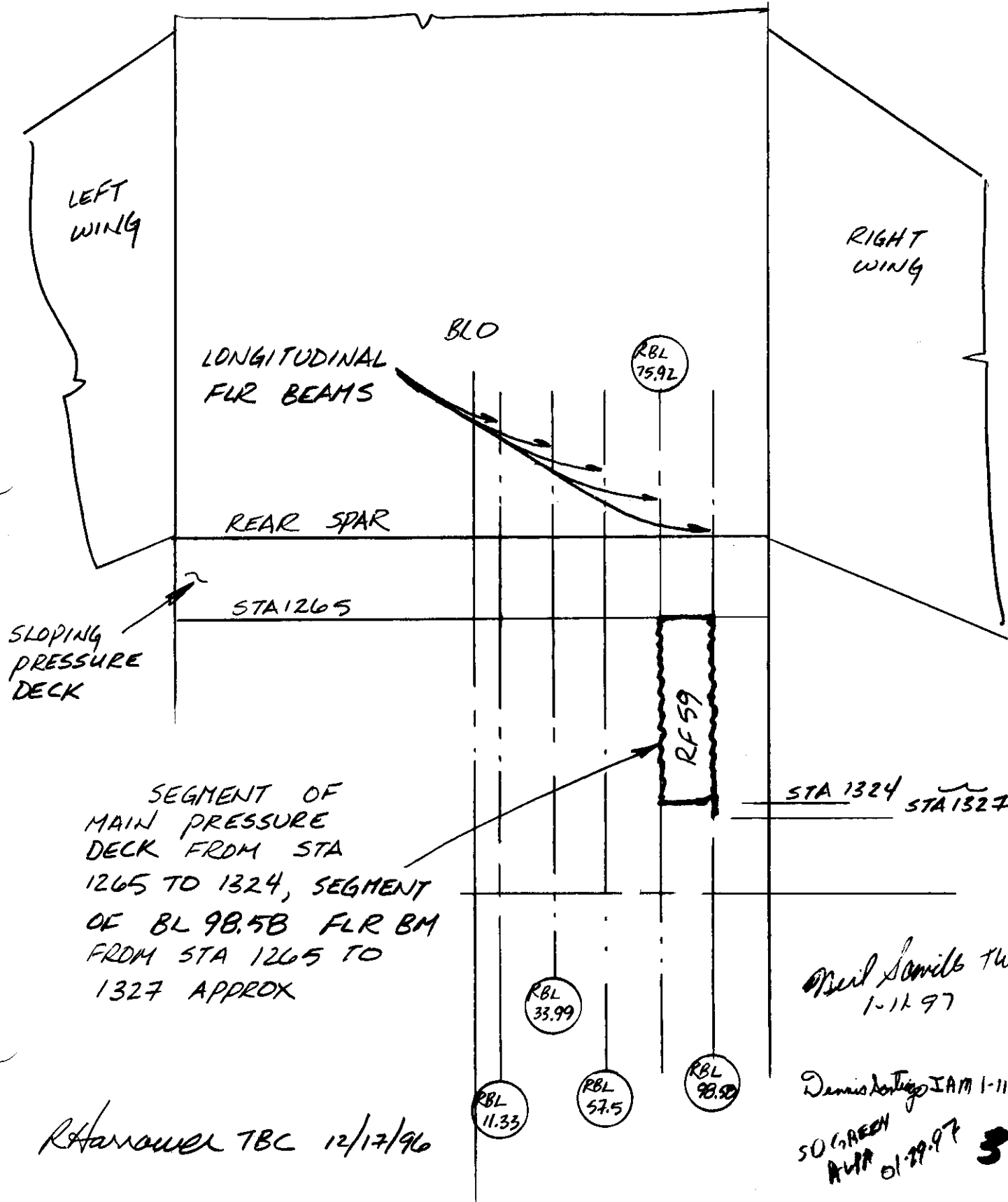

**LEFT
WING**

STA
1360

STA
1380

STA
1480

LEFT
MAIN
GEAR

RIGHT
MAIN
GEAR

RF59

**RIGHT
WING**

FWD
↑

**TOP VIEW
RF59**

4

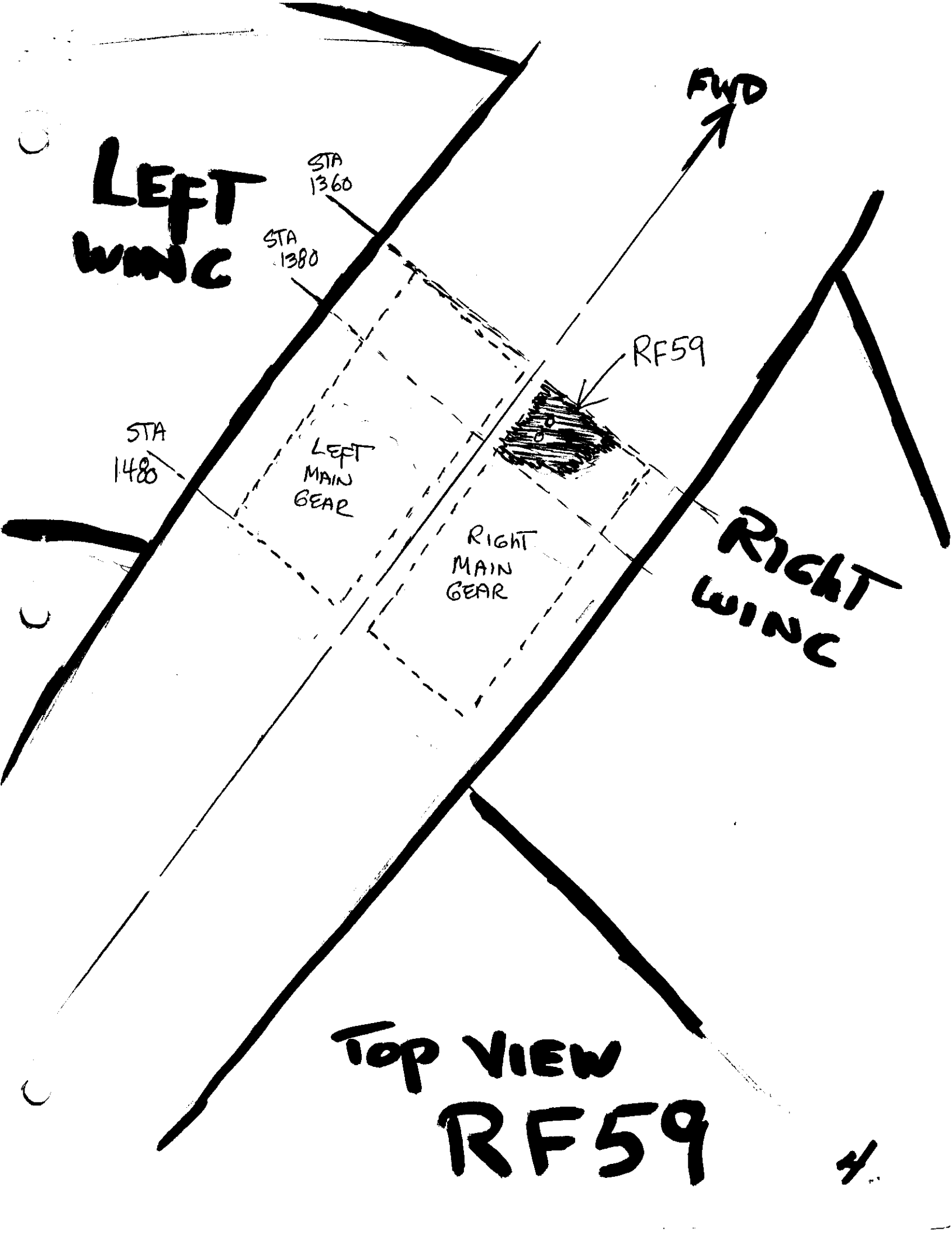

LEFT WING

STA 1302

STA 1360

STA 1380

STA 1480

LEFT MAIN GEAR

RIGHT MAIN GEAR

FWD
↗

RF59

RIGHT WING

Revise text to say sta 1280 to 1320
Remove "The vertical section of STA 1360....."
leave Heavy Soot into

Revision to

TOP VIEW

RF59

Jim Powers
Being
11-13-96

5

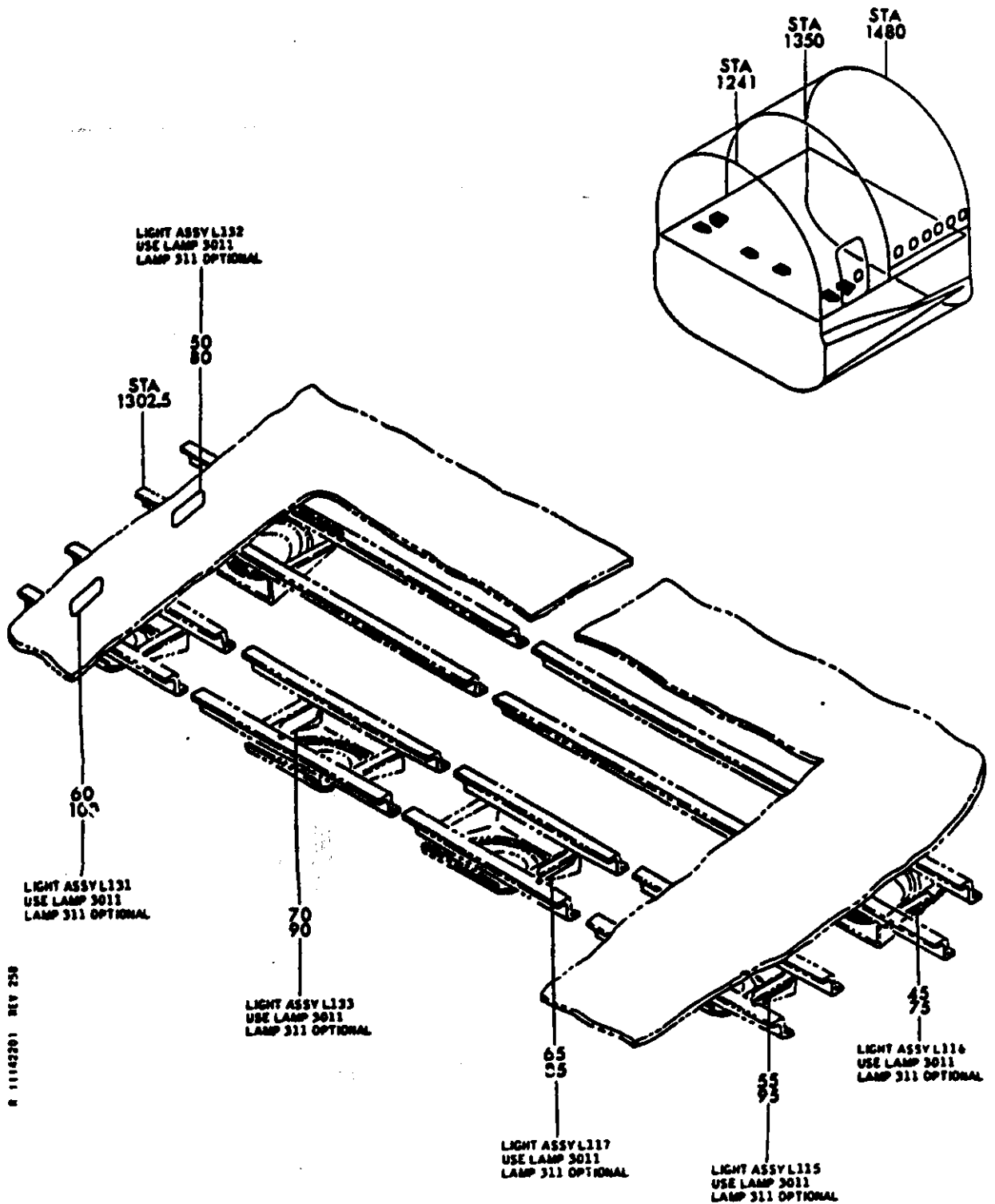

REV 238
11142200 R

LIGHT INSTL-FWD MAIN WHL WELL SERV (REQUIRED PLACARDS ONLY)
 FIGURE 1 (SHEET 1)