

SEE ADDITIONAL COMMENTS

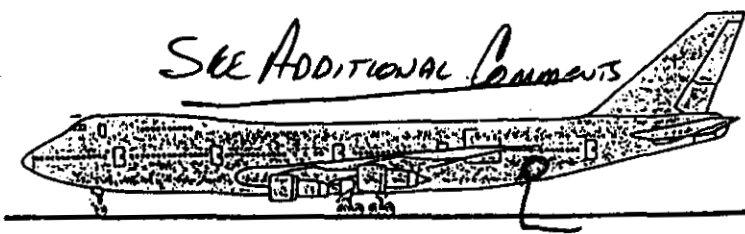

LOG # RF44A *RF 10-11-96*

TARGET # _____

COORD: LAT _____
LONG _____

BULK CARGO DOOR SURROUND
STRUCTURE STA 1960 TO 2080
S-23 TO S-45

DEBRIS FIELD GREEN
C 2254

RF44A

Pg 143

PIECE ENCOMPASSES STA 1980-2080
STRINGERS 36R-54S

STRUCTURE CONTAINS LOWER DOOR SILL OF BULK CGO
STRUCTURE IS DEFORMED, TORN SKIN AREAS, RIPPED
CRACKED & SEVERED. STRINGERS S-36R-45R EITHER
FRACTURED, SEVERED, FLATTENED, PULLED FROM SKIN.
PIECE IS CURVED OUT & INWARD, MANGLED WITH
JAGGERED EDGES.

FRAME STA 2040 SMALL SECTION ATTACHED TO SKIN
FRAME STA 2060 MISSING.

REFER FIRE AND EXPLOSION GROUP NOTES FOR FIRE DAMAGE

STEVE IC
FBI
08-19-96

*Tom Todaro
FAA - 10-17-96*

Dennis Santiago IAM
10/18/96

*Jim Powers
Boeing
11-11-96*

7R (D)
 8R
 9R (A)
 10R
 11R (A)
 12R
 13R (A)
 14R
 15R (A)
 16R
 17R (A)
 18R
 19R (149)

20
 23R
 24
 25
 26
 28
 30
 32
 34
 36
 39
 40
 41
 42
 43
 44
 45
 46
 47
 48
 49
 50
 51

LAP
 28
 30
 32
 34 LAP
 36
 38
 40 LAP
 41

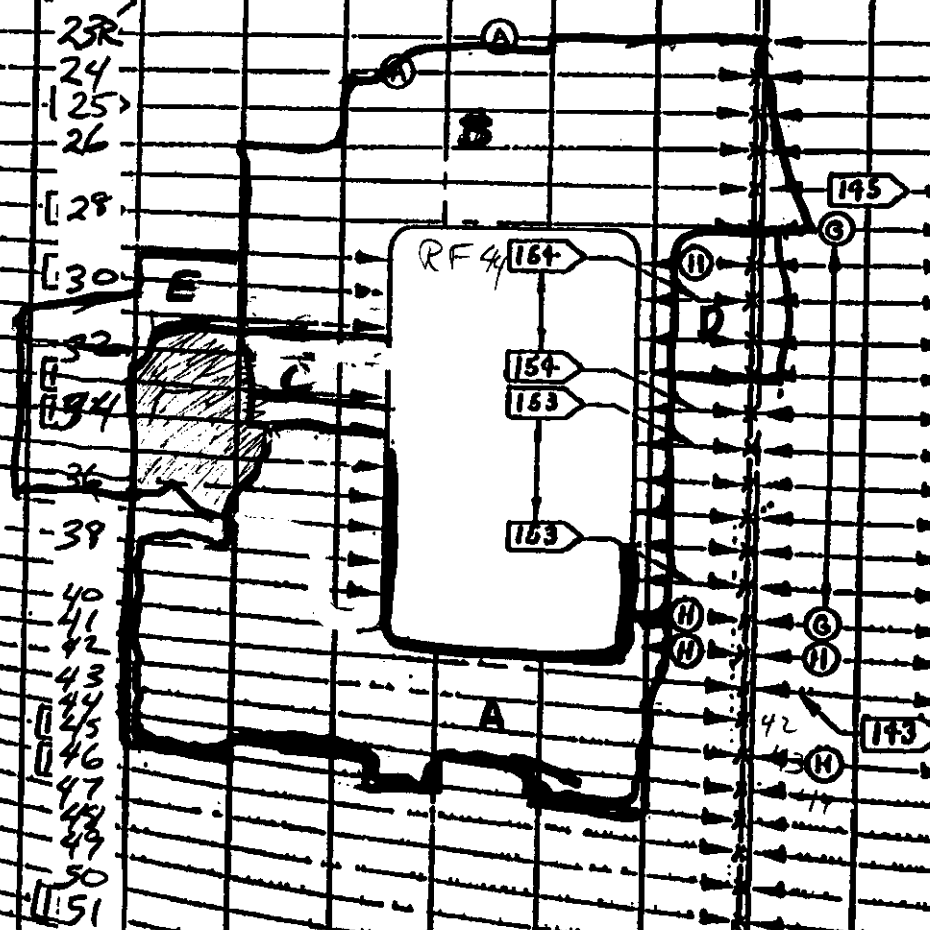

250 240 220 200 198 1961
 RF 44A

RIA

3 R/14

ADDITIONAL COMMENTS

RFH4A

RTTETTER 10-11-96

① ENCOMPASSES STRINGERS 34R TO 545R

~~AS~~ - AWA

12-4-96

Dennis Lantieri IAM

12-4-96

Tom T. Duro FAA

12-4-96

Neil Scoville - TWA

12-4-96

Rob Hanover - TBC

12/4/96

Jim Powers
11-11-96
Boeing

4

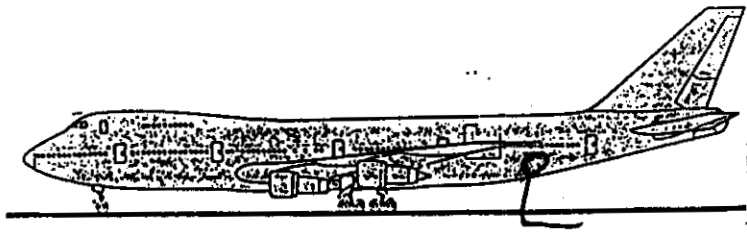

LOG # RF 44 B ^{RF3} ¹⁰⁻¹⁷⁻⁹⁶

TARGET # C 268

COORD: LAT _____
LONG _____

DEBRIS FIELD GREEN
~~C 268~~

BULK CARGO DOOR SURROUND
STRUCTURE STA 1960 TO 2080
S-23 TO S-45

RF 44 B

STATION 1960 - 2060

STRINGERS 23 R - 36 R

SECTION OF FUSELAGE MEASURES APPROXIMATELY

11' X 40" & STA ~~240~~ ^{2200 THICK} EXTENDING DOWN 14"

STA 1980 EXTENDING DOWN 49". BOTH STA 1980 &

TCT 10-17-96 STA ~~2070~~ ^{2200 THICK} OUTER EDGES OF BULK CGO DOOR
OPENING.

STRUCTURE COMPLETELY DEFORMED ENCOMPASSES
BENT, MANGLED STRINGERS, FLATTENED

FRAME 2060 MISSING & STA 1960

TWO HINGES & HOLD OPEN ACTUATOR ARE ATTACHED
TO THE STRUCTURE.

PIECE HAS CURLED & JAGGARED EDGES
ALSO PIECE CURLED IN & OUTWARD.

Steve K
FAA

08-19-96

THICK
TO
FAA 10-17-96

Jim Powers
Boeing
11-11-96

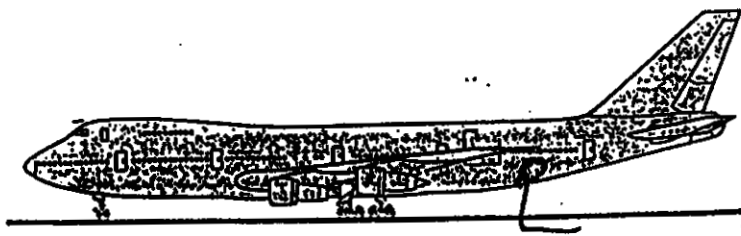

LOG # RF 44C R/S
10/11/96

TARGET # _____

COORD: LAT _____
LONG _____

DEBRIS FIELD GREEN

NO TAG

~~C228~~

C 2277

BULK CARGO DOOR SURROUND
STRUCTURE STA 1960 TO 2080
S-23 TO S-45

RF-44-C

STATION 2040

STRINGERS 32-33

SMALL PIECE OF STRUCTURE - MEASURES 28" X
17"

STRINGERS 32 & 33 BOTH SEVERED 6" OF
STA 2040. PIECE CURLED ^{OUTWARD} ~~TOWARD~~ ^{TRUSS}

*Tom Todman
FAA 10-11-96*

STEVE K
FAA
08-19-96

*Tom Todman
FAA 10-17-96*

*Jim Rivers
11-11-96
Boeing*

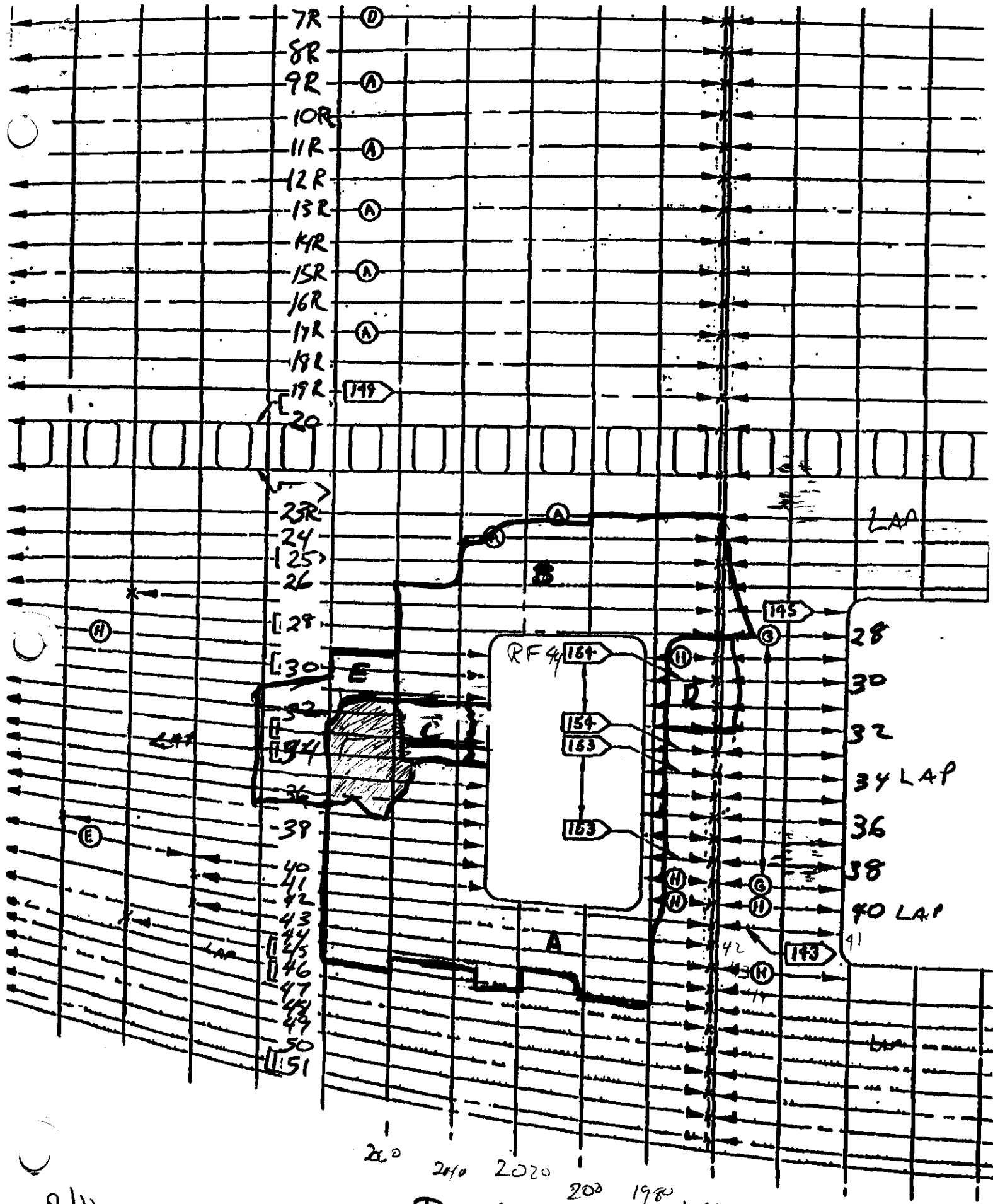

RIA

RF 44 C

R/108

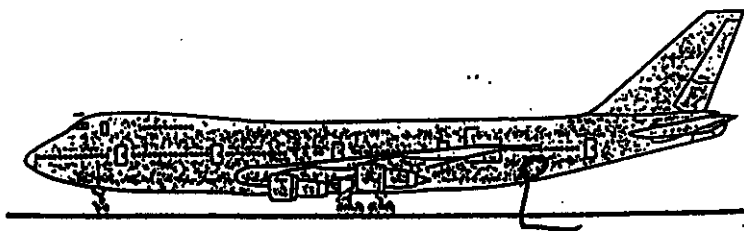

LOG # RF 44 D 10/28

TARGET # _____

COORD: LAT _____
LONG _____

DEBRIS FIELD GREEN
NO TAG

BULK CARGO DOOR SURROUND
STRUCTURE STA 1960 TO 2080
S-23 TO S-45

RF 44 D

~~C2384~~
C2384
PG
10/28

STATION 1960-1980 1 APPROX. 9meters
STRINGER S-28R-31R

FUSELAGE MEASURES APPROXIMATELY 22' X 25"
STRUCTURE IS COMPLETELY FOLDED OVER

CRUSHED DEFORMED JAGGERED EDGES
CURLLED INWARD.

STEVE K
FAA
08-19-96
- - -
- - -

Marking
TUSA 10-11-96
Tom Todino
FAA 10-17-96

Boeing
Jim Powers
11-11-96

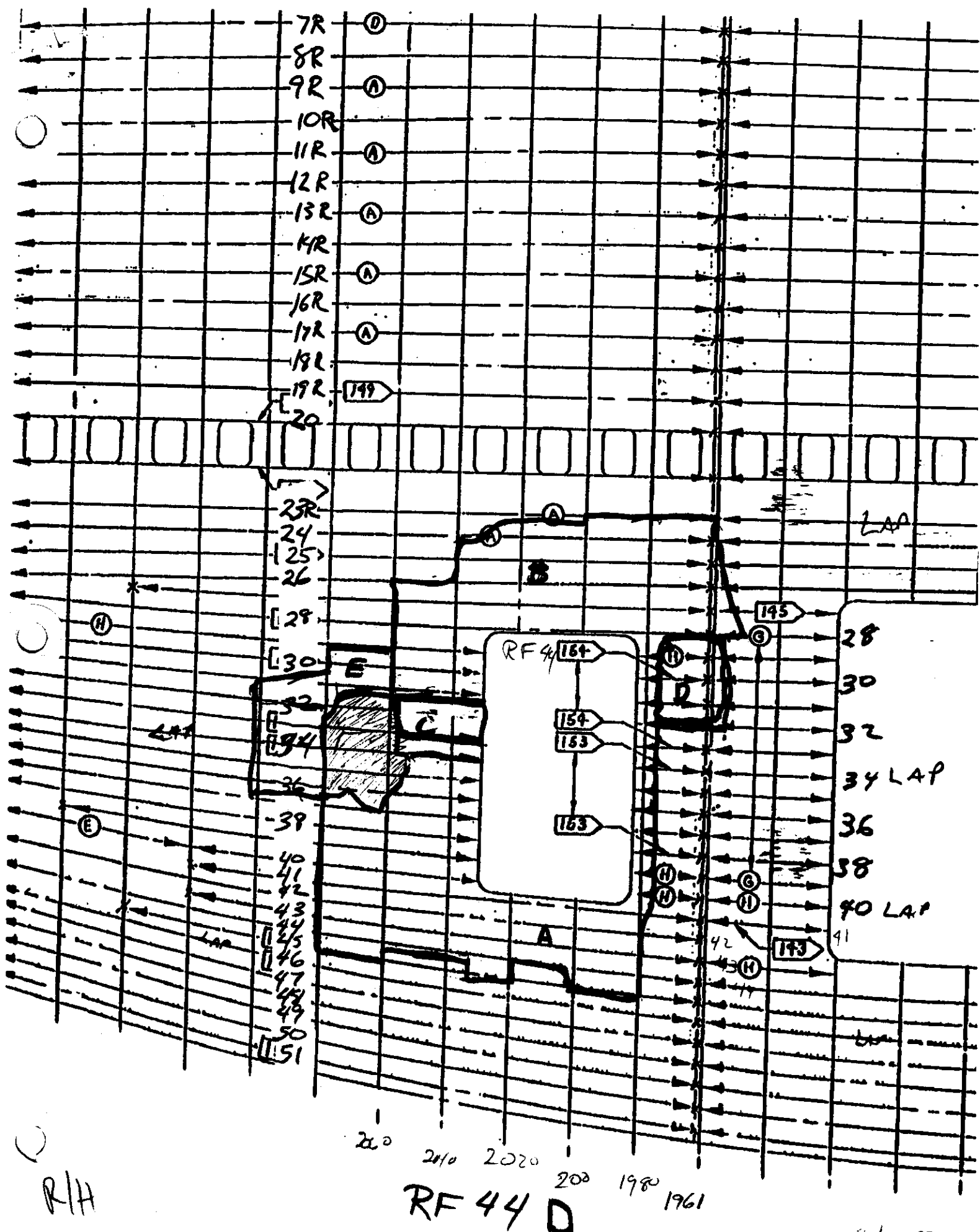

RIA

RF 44 D

R/14 10

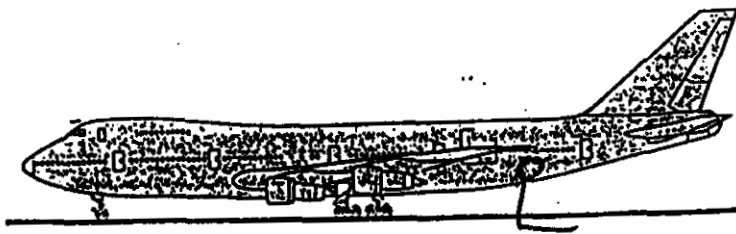

LOG # RF 44 E *MA*

TARGET # _____

COORD: LAT _____

LONG _____

BULK CARGO DOOR SURROUND
STRUCTURE STA 1960 TO 2080
S-23 TO S-45

DEBRIS FIELD GREEN

~~NO TAG~~

~~2349~~

C2349

Pa

10/28

RF 44-E

2100 TCT 10-17-96

STATION 2060 - ~~2000~~

STRINGERS - S-29 S36

FUSELAGE MEASURES 5'7" x 3'

All FRAMES MISSING

STRINGER S-29 MISSING & S-36 MISSING

S-30-R STA 2060 ATTACHED TO SKIN

S-31-R STA 2060 ATTACHED TO SKIN SEVERED @ STA 2080

S-32-R SEVERED @ STA 2080 PULLED AWAY FROM SKIN
& ATTACHED STA 2000 2100 TCT 10-17-96

S-33-34 & S-35-R ATTACHED TO SKIN BETWEEN STA
2080 & ~~2000~~ 2100 TCT 10-17-96

FUSELAGE SKIN RIPPED & CURLED OUTWARD MANY
CUTS IN SKIN, ALL STRINGERS FLATTENED SEVERED
& CRUSHED SHARP EDGES.

*ATTACHED
10-11-96*

Tom Todaro
FAA 10-17-96

STEVE IC

FAA

08/19/96

Jim Powers
11-11-96
Boeing

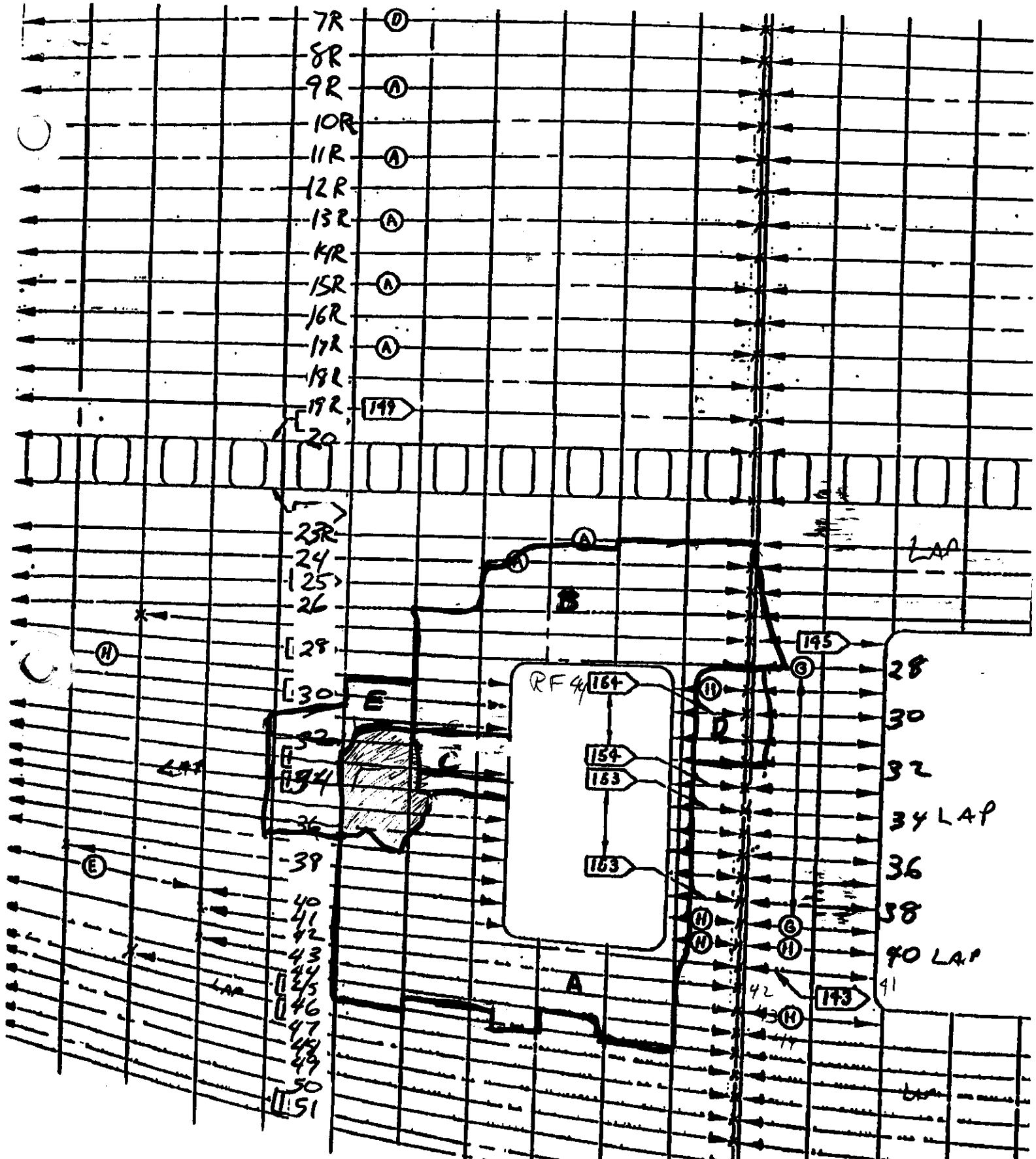

7R
8R
9R
10R
11R
12R
13R
14R
15R
16R
17R
18R
19R
20
23R
24
25
26
28
30
32
34
36
39
40
41
42
43
44
45
46
47
48
49
50
51

28
30
32
34 LAP
36
38
40 LAP
41

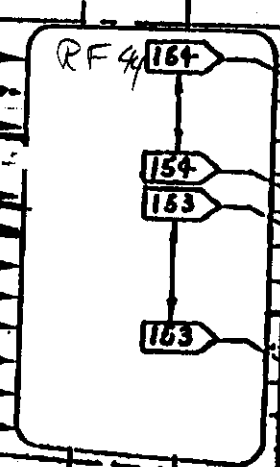

200 210 220 200 1980 1961
RF 44 E

RIA

R/12