

LOG # RF144
 TARGET # D2120
 COORD: LAT _____
 LONG _____

A ←
 B. HOCKING
 BOEING
 2/25/97

DEBRIS FIELD WHITE

PRESSURE DECK SEGMENT, STA 1362 TO 1377,
 RBL 2.0 TO LBL 10.0

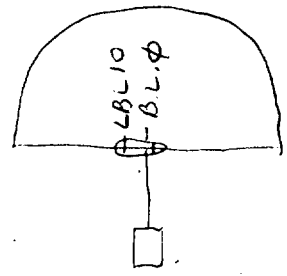

SECTION A-A

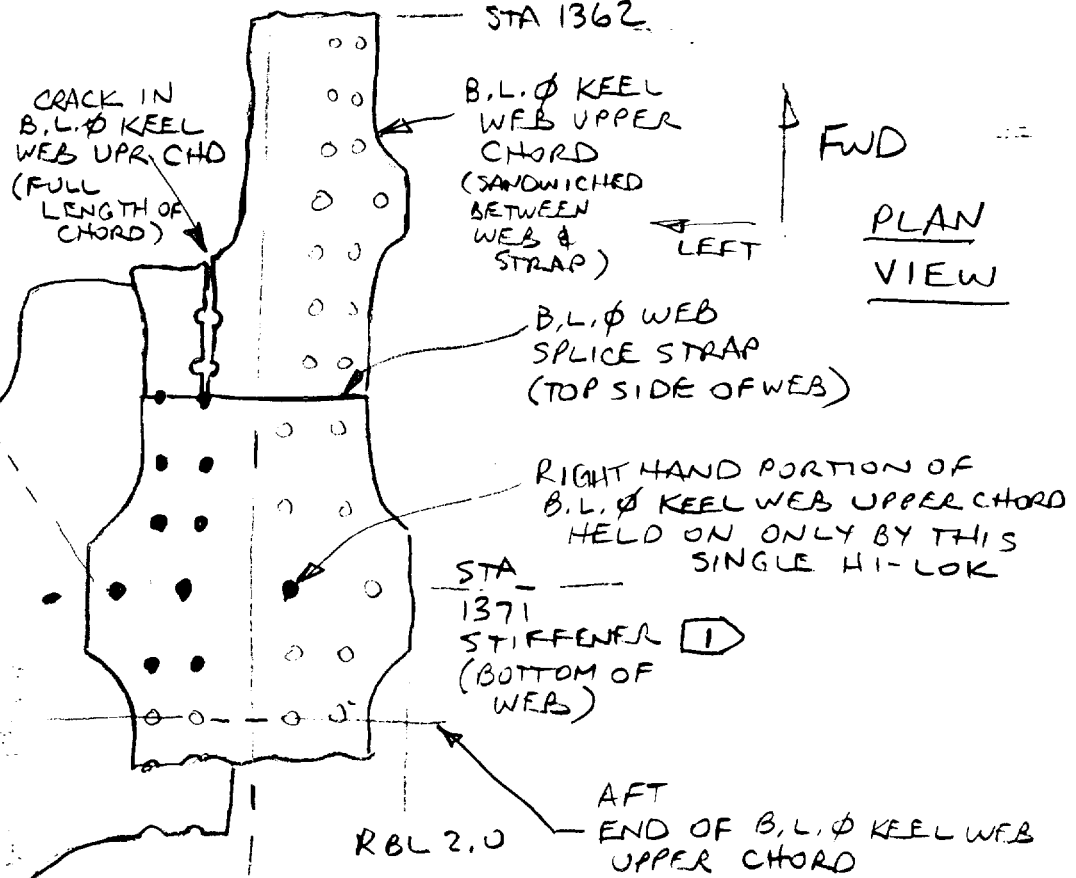

LBL 10.0

BEND LINE

STA 1371 STIFFENER (BOTTOM OF WEB)

STA 1377

PRESSURE DECK WEB.

AFT PORTION OF PRESSURE DECK WEB BEND DOWN ALONG BEND LINE SHOWN, ABOUT 30° FROM HORIZONTAL

NO APPARENT SOOTING OF EITHER UPPER OR LOWER SURFACE.

① LOWER TRANSVERSE STIFFENER RUNS FROM LBL 10 TO LBL 0.5.

High D Solinas - ALPHA
 3-18-97

Dennis Santiago IAM
 2/28/97

Stephen F. Klappach J. III
 FMA-03 06-97

James G. ... TWIN
 3-11-97

1/2

65B13364 - 2
65B13364 - 72

00

LOG #
RF144

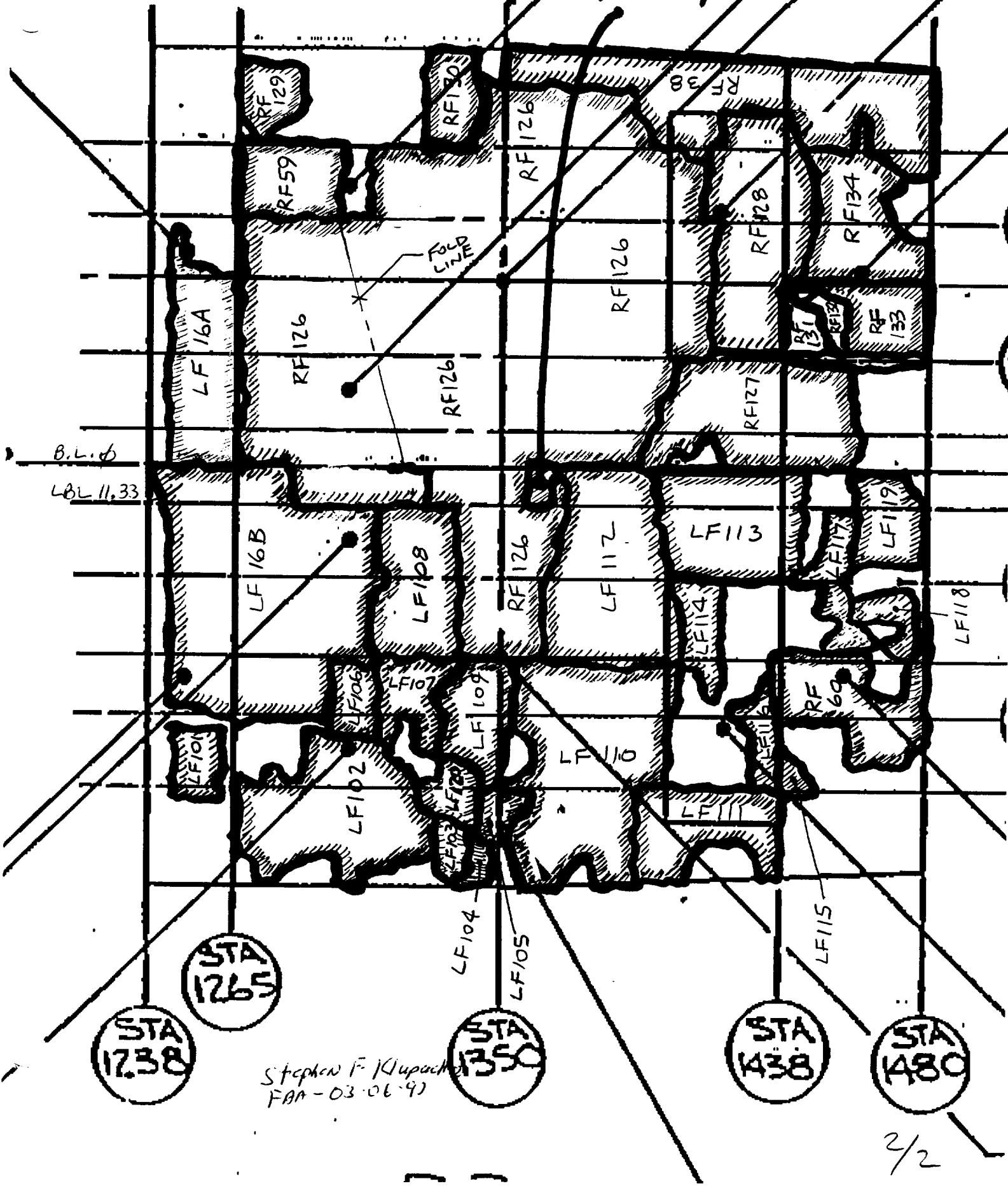

Stephen F. Klupack
FAA - 03-06-92