

RUDDER R4

LOWER RUDDER SECTION

LOC'N = FLOATER

BLUE TAG # E 2034

FBI # = N/A

PART DATED 7/19'

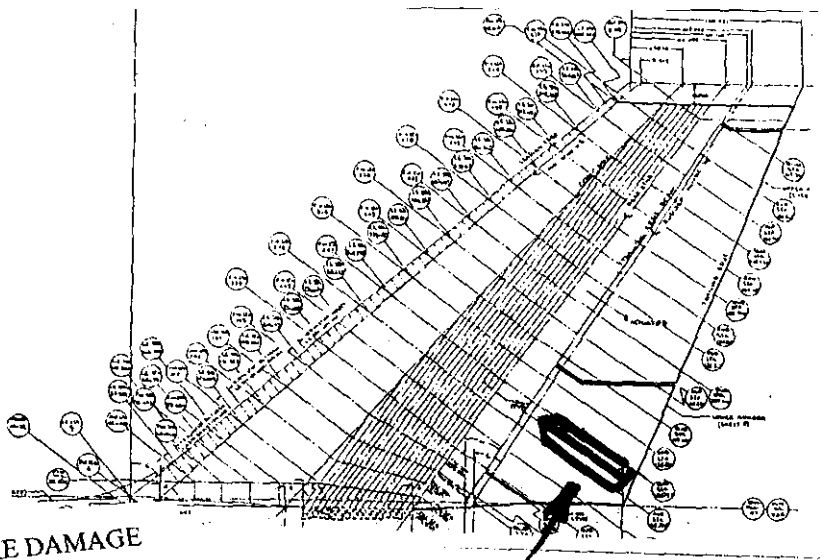

REFER FIRE AND EXPLOSION GROUP NOTES FOR FIRE DAMAGE

LOWER SECTION OF RUDDER MEASURES APPROX 28" X 62" FROM RUDDER STA 82.8 TO 107.75, PART DOES NOT QUITE REACH TRAILING EDGE - SEE SKETCH. AN AREA OF THE LHS SKIN IS NOT ATTACHED BETWEEN RU. STA 82.8 & 95.27. OUTER SKINS HAVE CRACKING, PUNCTURES, SURFACE ABRASIONS WITH SOME EXPOSED HONEY COMB PORTIONS OF RIBS AT RU. STA'S 82.8 & 95.2 REMAIN ATTACHED.

[Signature] -ALPA
12-13-96

[Signature] K Hanauer TBC
12/13/96

[Signature] Dennis Santiago IAM
12-16-96

Stephen F. Klupach S.I.E. IAM
01-10-97

[Signature] 12-16-96
TWA

482.655

R4

VIEW LKG INBD FROM LHS

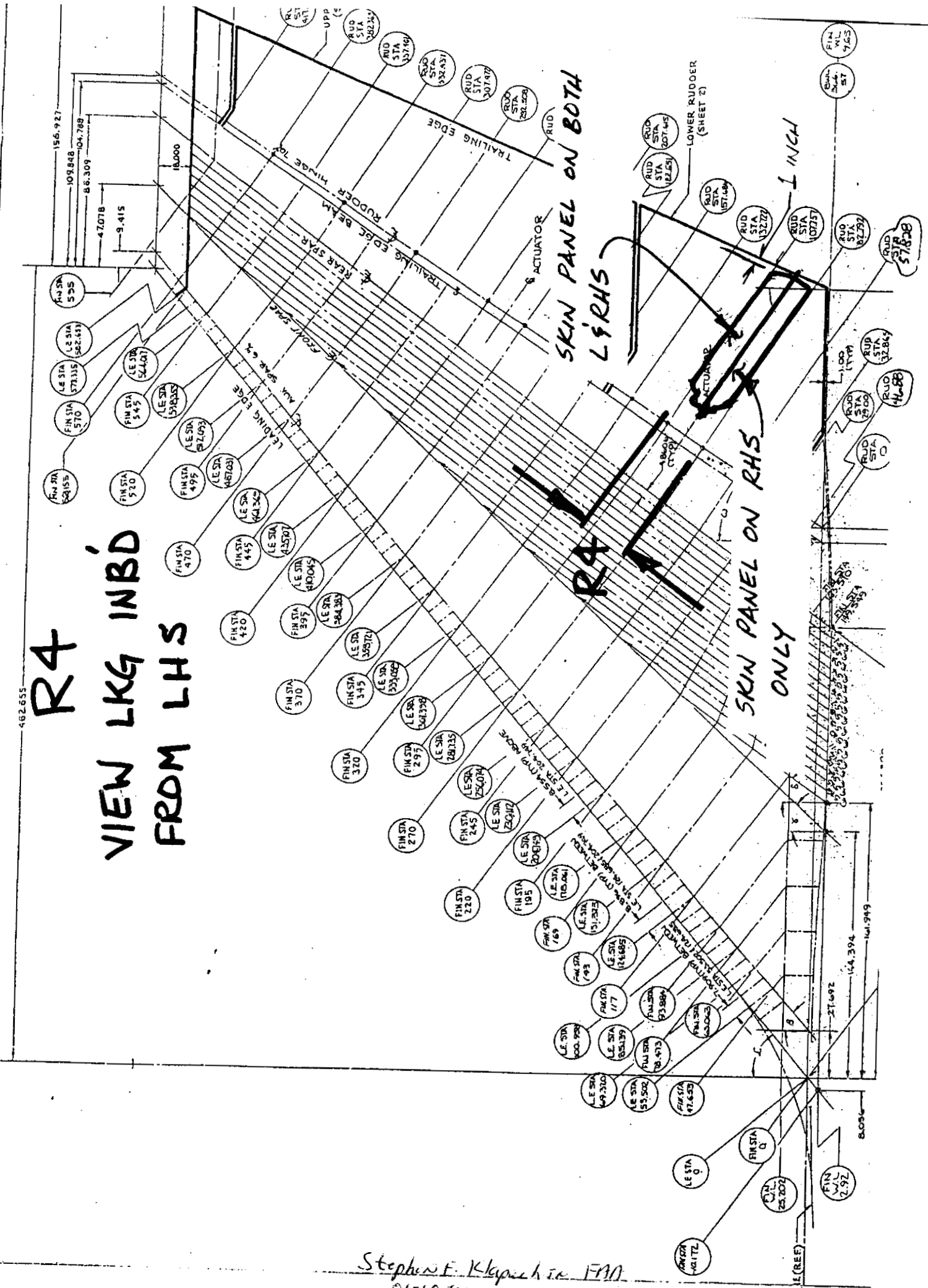

Stephen F. Klyachuk 1770
01-10-97

R 4

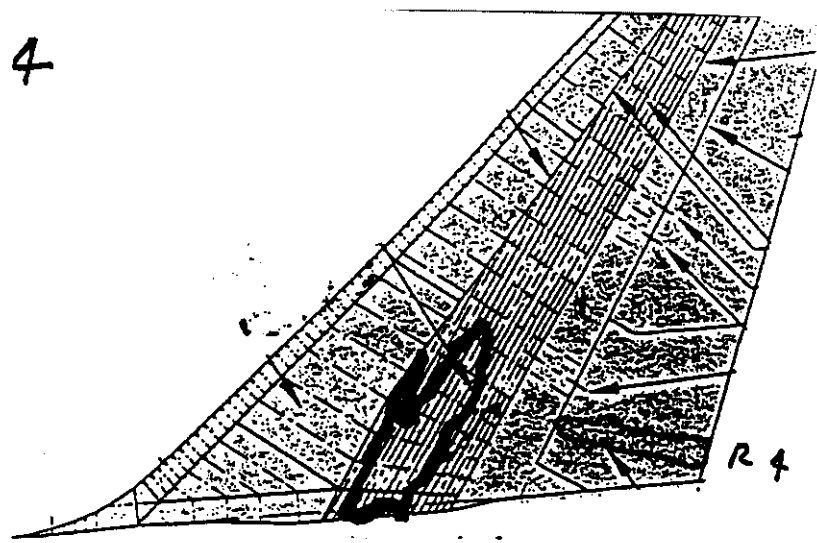

NO PHOTO

R-4 Lower Rudder (Float)

Lower section of Rudder measures approximately 24' x 64"

Encompasses Ru Sta 107.757 & Ru Sta 82.792

Piece is Ripped - cracked & Torn at All Station

Honey Comb is Exposed in some AREAS.

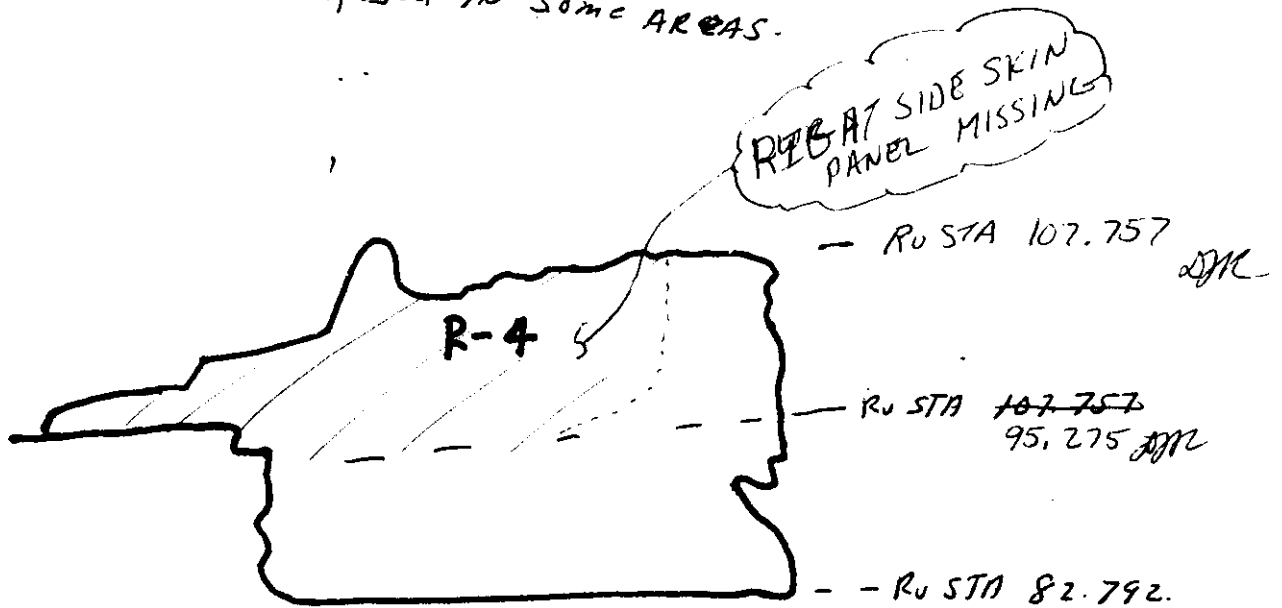

Stephen F Klapach Sr FAI
12-02-96

R 4

6055514-3

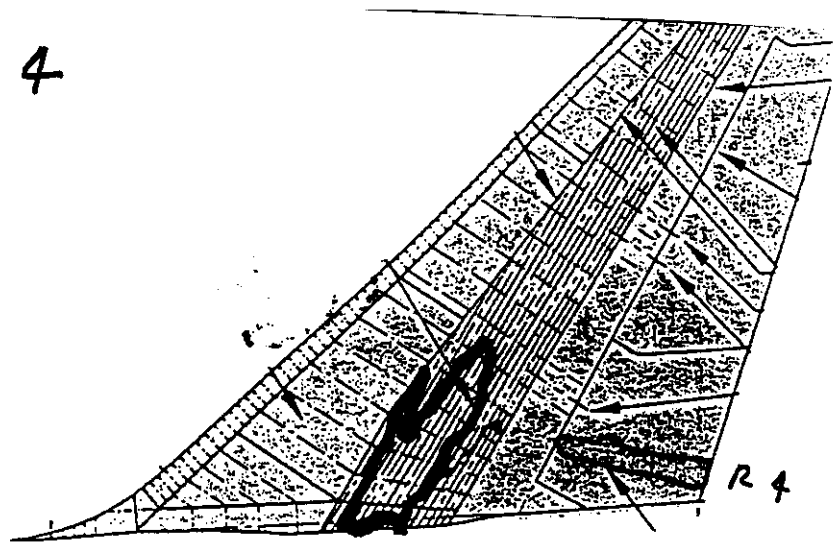

R-4. Lower Rudder (Float) BLUE TAG # E2034

Lower section of Rudder MEASURES APPROXIMATELY

~~24' x 64"~~ 28 x 82

ENCOMPASSES Ru STA 107.757 & Ru STA 82.792

Piece is Ripped - cracked & Torn at All Station

Honey Comb is EXPOSED in some AREAS.

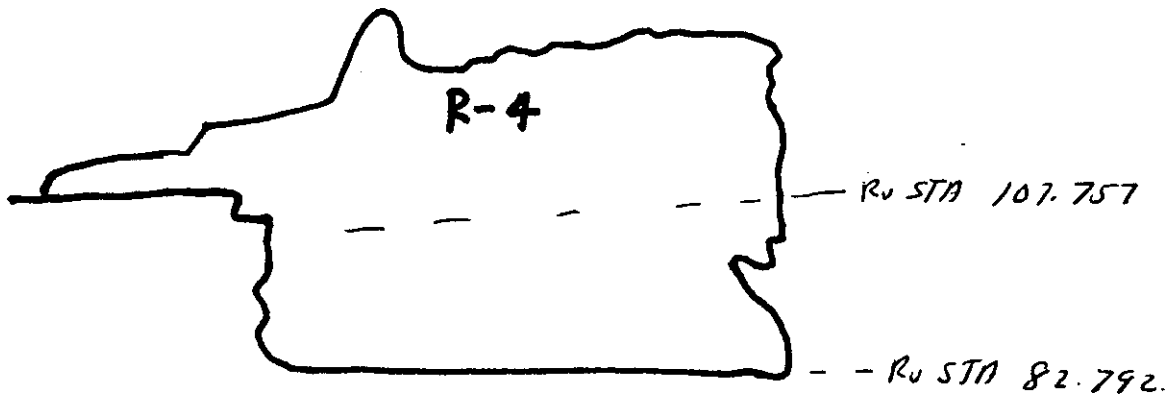

Stephen F. Klupach Sr. FAI
12-02-96

R4

Section

Additional Information

Lower rudder^v from rudder station 82.792 to 107.757 approximately 64 inches from trailing edge running forward. An area of ~~right~~ *left* skin panel is not attached. Portions of ribs at rudder stations 82.792 and 95.275 remain attached. Outer skins have cracking, punctures, and minor surface abrasions.

Steph 12-9-96 TWA

Stephen F. Klupack Jr FAB
01-10-97