

LOG # LF 87

10-23-96

TARGET # _____

COORD: LAT _____

LONG _____

ASSORTED SKINS

STA 920 TO 990

S- 28 TO S-41

DEBRIS FIELD GREEN

TAGS

A	NO TAG ✓	F	Z 2779 ✓
B	Z 2759 ✓	G	NO TAG ✓
C	Z 2758 ✓	H	NO TAG ✓
D	Z 2333 ✓	I	NO TAG ✓
E	Z 2760 ✓		

(A-I EXCEPT B)
LF 87 SKIN & STRINGER SEGMENTS HAVE
CONSISTANT FRACTURES AND BENDS AS LF70B & LF63

LF 87B IS THE SAME FRACTURE APPEARANCE AS
LF 70A WITH THE EXCEPTION OF THE BEND
AS SHOWN.

CJM - IAM
10-22-96

B Smith 10/22/96
BOEING

LOCATION OF PART C
CORRECTED.

P. Hocking
11/3/96

Tom T...
FAA 10-23-96

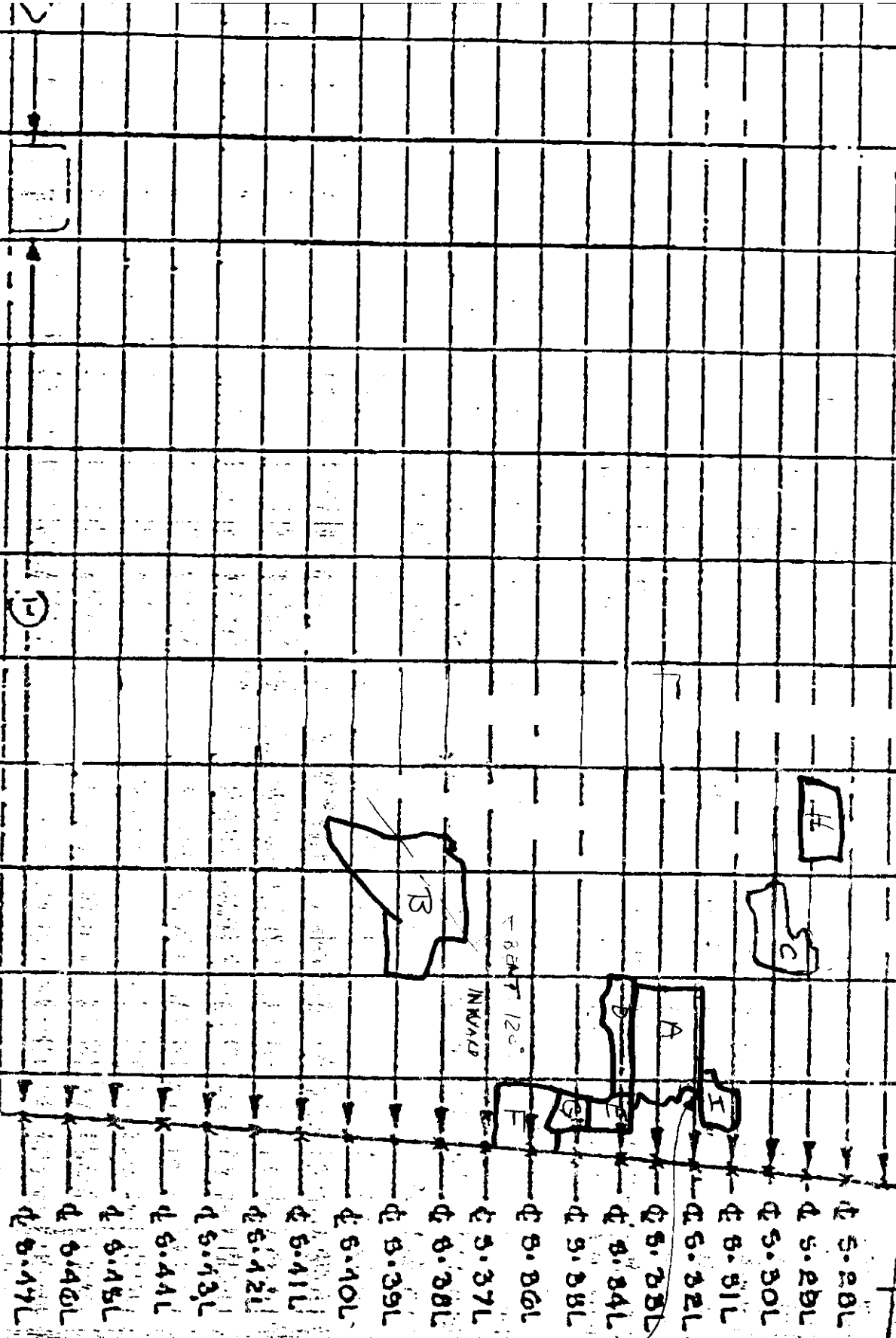

SIA
BRO.00

Time Tables
FAA 10-23-96

LF 87

- Δ 5.28L
- Δ 5.28L
- Δ 5.30L
- Δ 5.31L
- Δ 5.32L
- Δ 5.38L
- Δ 5.38L
- Δ 5.38L
- Δ 5.39L
- Δ 5.40L
- Δ 5.41L
- Δ 5.42L
- Δ 5.43L
- Δ 5.44L
- Δ 5.45L
- Δ 5.46L
- Δ 5.47L

BEAT 120°
NWAD

I BELIEVE
THERE IS
A SYM MET
GAP IN
BETWEEN
I & A
B. Hocking
11/4/96

LF 87

PART C
LOCATION
CORRECTED
B. Hocking
11/3/96

FRONT
SPAR