

LOG # LF 14M

TAG # D 2136

COORD: LAT _____
LONG _____

SEGMENT OF
RHS KEEL BEAM
BOX WEB & STIFFENER

DEBRIS FIELD UNKNOWN
FBI # 8/8/96-31

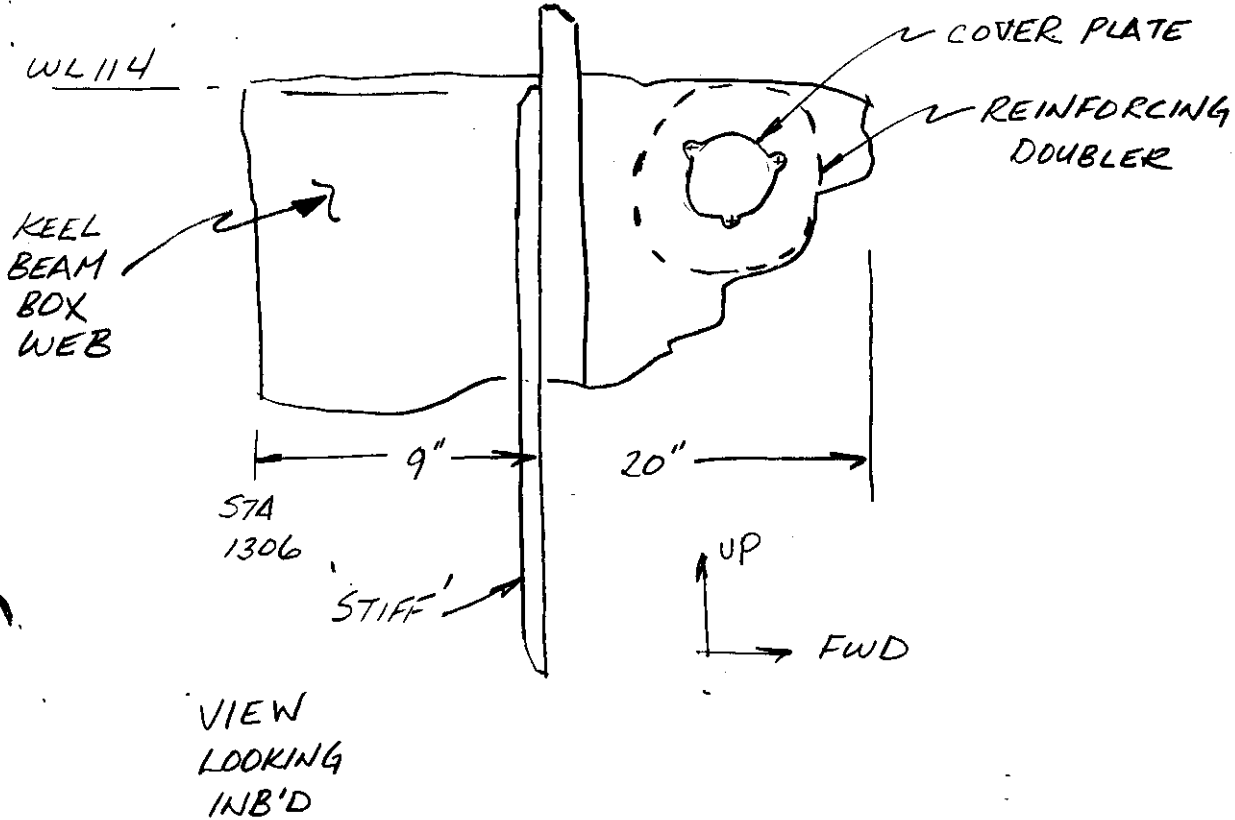

- PART IS LIGHTLY SOOTED ON BOTH INTERIOR AND EXTERIOR SURFACES
- FRACTURE SURFACES ARE SOOT FREE

B. Brandstetter
TWA 3/25/97

V. Cozza
ALM 3/21/97

Dennis Santiago IAM
3-26-97

Tom Todaro
FAA 3-27-97

R. Hansen
3/11/97

RIGHT LAND
SIDE
WHEELWELLS

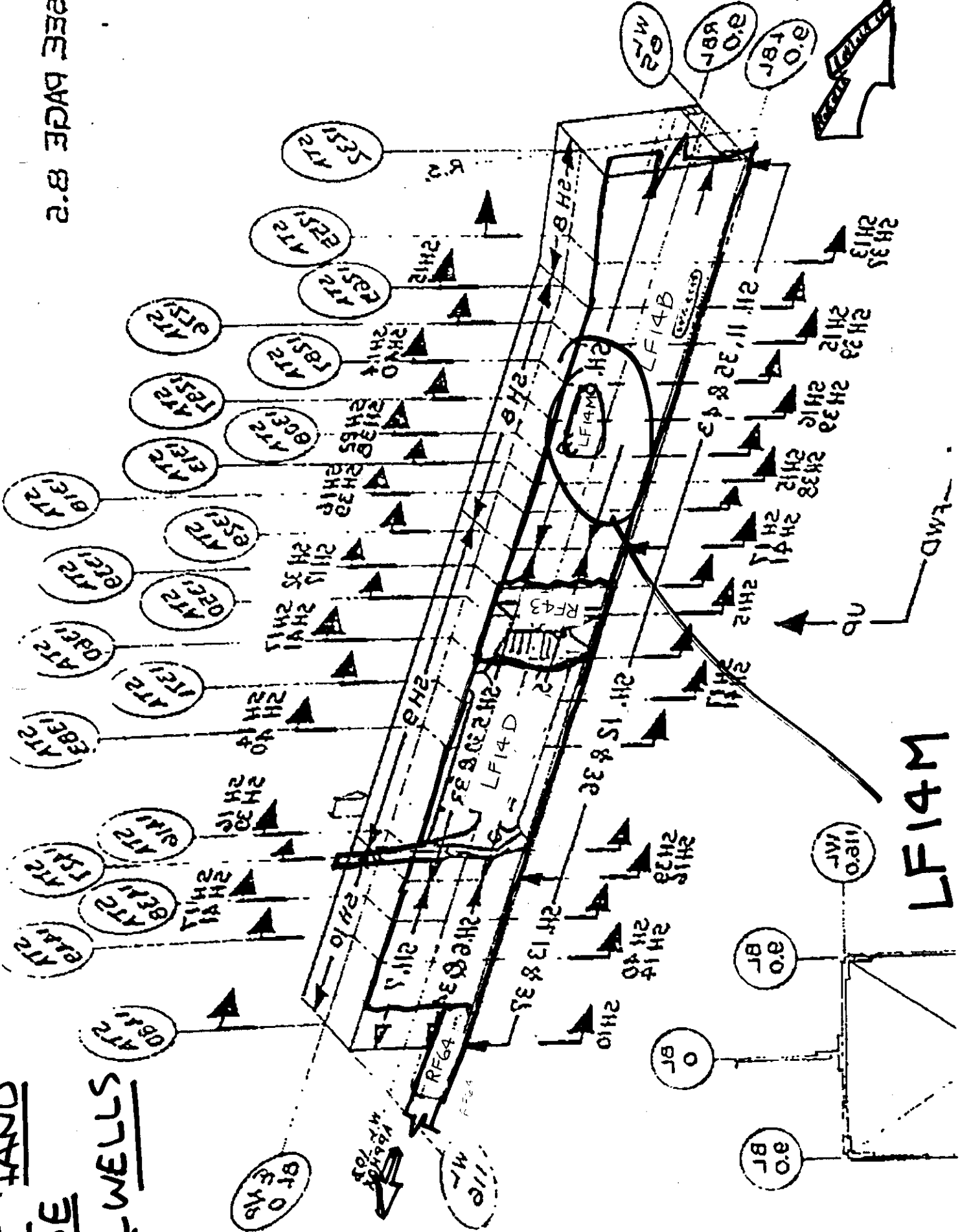

SEE PAGE B.2

LF14M

