

LOG # LF 13

1 RTS 10/24/96  
46

TARGET # 14

COORD: LAT 40 39 46.9

LONG 72 37 27.4

See Additional Comments

GREEN C 120 - 13A

DEBRIS FIELD \_\_\_\_\_

Pg 1 of 3

### LF 13 A

This section of fuselage measures approx 11' x 9' and encompasses station 2000 thru 2130 and stringers S13L thru S22L. Fuselage skin torn horizontally along S11L from STA 2120 thru 2080, then turns vertical to stringer S17L. All stringers fractured. Fractured portion of frame STA 2000 (remaining portion between S16L and S8L not attached). Small portion of frame STA 2040 attached at S16L + S17L. Small section of frame STA 2080 attached at S18L + S19L. Small portion of frame STA 2100 attached at S18L, S19L, S20L. Fuselage skin (with window) is irregular in shape and all edges are jagged and torn. No evidence of fire or smoke damage.

### LF 13 B GREEN C139

This section of fuselage measures approx 8' x 5' and encompasses station location 2120 thru 2180 and stringers S12L thru S22L. All stringers fractured. Frame at 2140 is attached at S18L, S19L, S20L, and S22L, (remaining 4 1/2' of frame fractured and not secured). Frame at STA. 2160 attached at S18L, S19L, + S20L. (remaining 4 1/2' fractured and not secured). Fuselage skin contains 3 main cabin window frames. Skin is irregular in shape, all edges are sheared and jagged. No evidence of fire or smoke damage.

Tom Todman  
FMA  
10-9-96  
C/T/Huber-JAM  
10-22-96

STRINGER 12L IS MISSING.  
ALL OTHER STRINGERS ARE  
PRESENT.

TACKLING  
TWA 10-1-96

Bruce Hocking  
BOEING 10/24/96

Joseph  
FAA  
8/13/96

# LF13

Pg 2  
43

STA  
1800

STA  
1900

Q SPLICE

STA  
2000

STA  
2100

STA  
2200

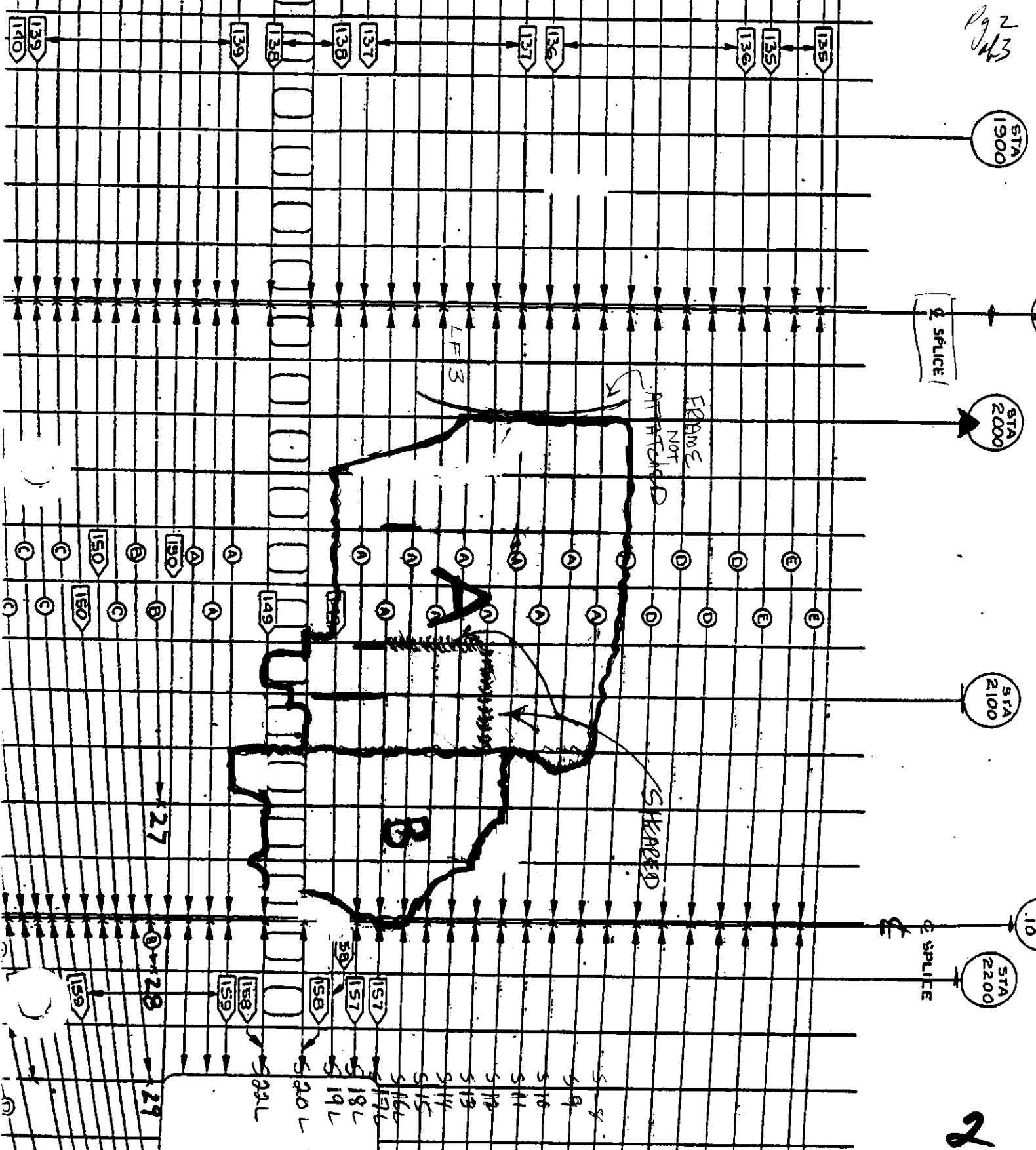

Additional Comments

B.N.  
10/24/96

LF 13A has an external skin penetration at FS 2080, SIG L. The penetration is from fore to aft. Substantial tight curling of the skin <sup>TO THE INSIDE</sup> is present. Some <sup>DARK</sup> material transfer ~~may~~ is ~~be~~ present.

SD GREEN ALIA

08-17-96

Cj Mc IAM 12-5-96

~~AA~~ AOA 12-5-96

R Hanover - TBC

12/5/96

Neil Sewell - TWA

12-5-96

Tom Todaro

12-6-96