

LOG # LF102  
 TARGET # Z 3005  
 COORD: LAT \_\_\_\_\_  
 LONG \_\_\_\_\_

B. HOCKING  
 BOEING  
 2/21/97

C (PAGE 3)  
 DEBRIS FIELD GREEN

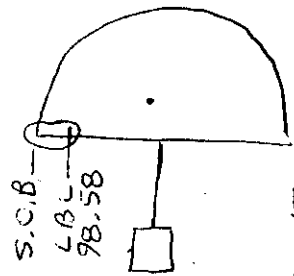

STA 1265  
 STUB BEAM  
 SEGMENT

LBL 98.58 FLOORBEAM  
 SEGMENT

B (PAGE 3)

STA 1265

SEGMENT OF  
 PRESSURE DECK  
 WEB, STA 1265 TO  
 1322, LBL 83 TO S.O.B.

FRAMING  
 STIFFENER

WEB  
 HOLE

WEB  
 CRACK

WEB  
 CRACK

WHEEL WELL  
 LIGHTS,  
 BOTTOM SIDE

TRANSVERSE  
 PRESSURE DECK  
 STIFFENERS,  
 BOTTOM SIDE  
 OF WEB

PULLEY BRACKET  
 SUPPORT  
 STIFFENER,  
 3 PL

ATTACHMENT  
 FLANGE OF  
 STA 1318 STUB BEAM  
 LOWER CHORD

PRESSURE DECK  
 DRAIN WITH  
 HOSE ATTACHED  
 ON BOTTOM  
 SIDE.

WEB  
 CRACK

STA 1318

FWD  
 O/B

NO APPARENT  
 SOOTING OF  
 SURFACES.

LBL  
 98.58

PLAN  
 VIEW

Dennis Hartung IAM  
 -3-24-97

Stephen F. Kipach JR  
 FIAA-08-0797

George Dohd  
 3-14-97

John D. Johnson ALPA  
 19 MAR 97

1/3

65813364 - 2  
65813364 - 72

00

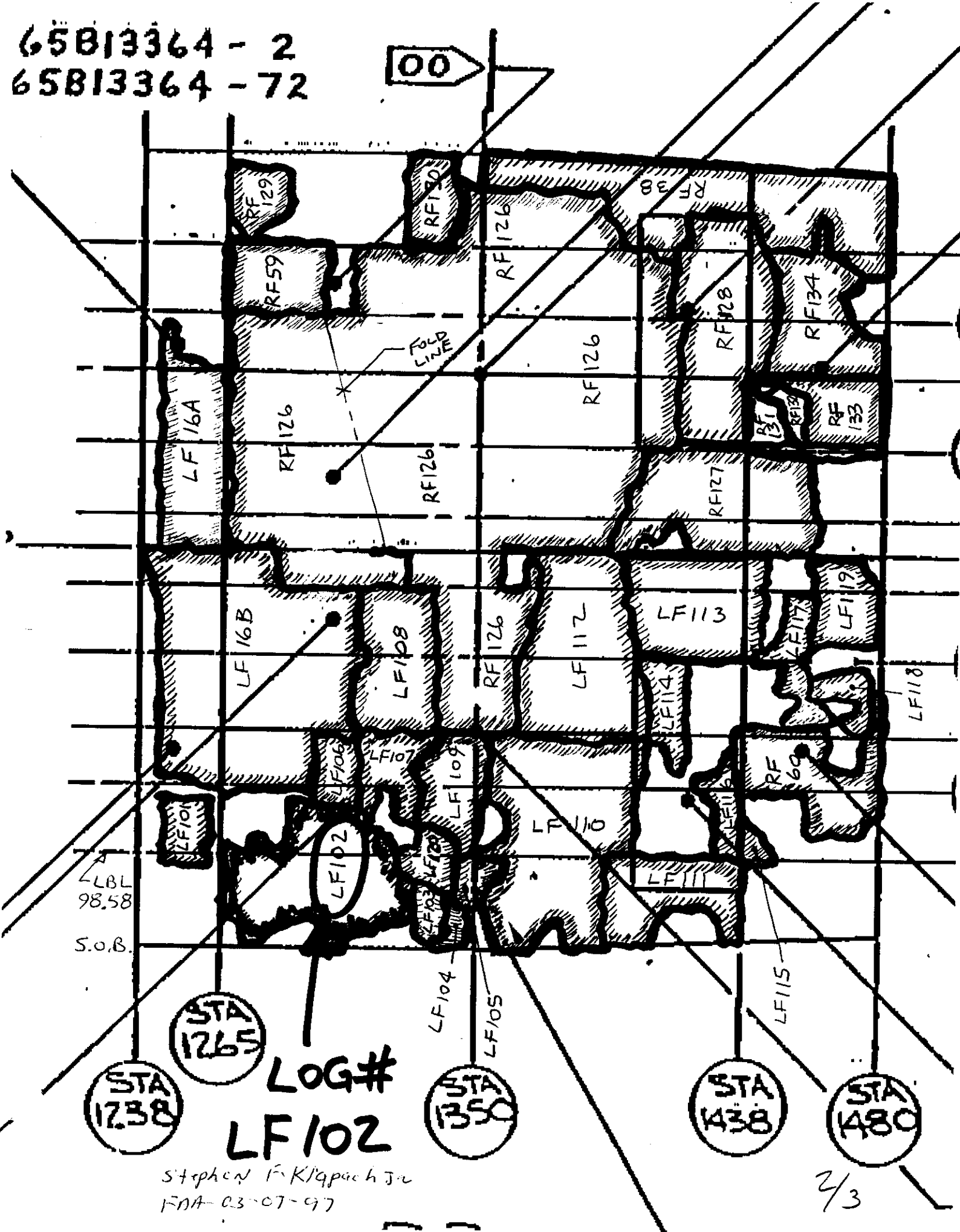

L LBL  
98.58  
S.O.B.

STA 1738

STA 1265

LOG#  
LF102

STA 1350

STA 1438

STA 1480

Stephen F. Klipach Jr  
FNA-03-07-97

2/3

B. HOCKING  
2/21/97

# LOG # LF102

UPPER CHORD  
CRACKED HERE

REMNAINT OF  
FLOOR  
PANEL

LBL 98.58

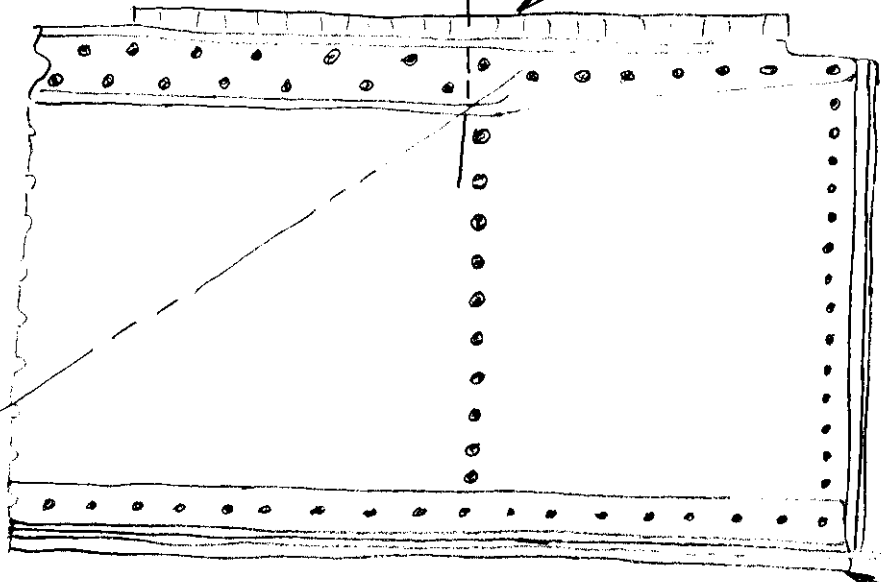

## VIEW B-B

STA 1265  
STUB BEAM  
SEGMENT

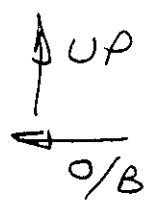

PRESSURE DECK  
WEB

PRESSURE DECK KNEE  
STIFFENER UPPER  
FLANGE. (INTERSECTION  
OF HORIZONTAL DECK  
& SLOPING DECK)

BEND LINE.  
UPPER PORTION  
BENT FWD  
ABOUT 80°.  
LOWER PORTION  
BENT SLIGHTLY  
AFT.

George Scott & Tait  
3-14-97

UPPER PORTION BENT INBOARD  
ABOUT 10°

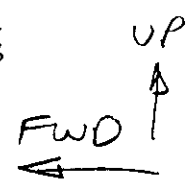
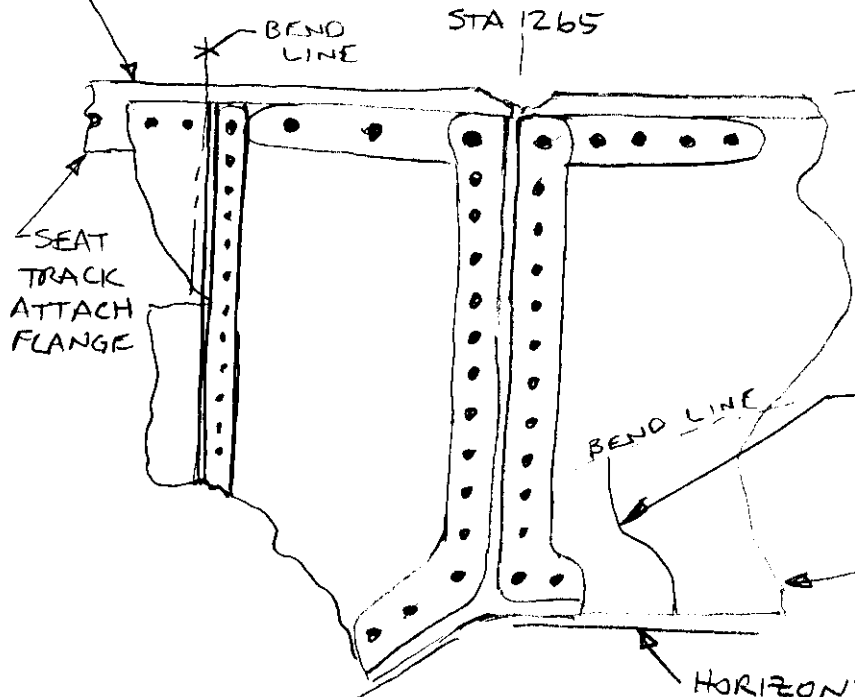

## VIEW C-C

REMNAINT  
OF LBL 98.58  
FLOOR BEAM.

LWR PORTION  
BENT OUTBOARD  
ABOUT 15°.

W.L. 3/3  
186.3  
(W.L. OF P'DECK  
WEB)

SLOPING PLANE

James Santiago & AA  
3-14-97

B. HOCKING  
2/21/97