

23			
89	65B06157-1D	10-2638	
90	65B09193-1	10-5296	
91	65B06614-4	10-5297	
92	65B06616-5	10-2581	
93	65B06614-3	10-2579	
94	65B06614-3	10-2585	
95	65B06614-3	10-5320	
96	65B06614-3	10-5320	
97	65B06614-3	10-2584	
98	65B06615-1	10-2580	
99	65B06615-1	10-2580	
100	65B06615-1	10-2580	

139	65B06157-1D	10-5327	
140	65B06276-10	10-2490	
141	65B06277-3	10-2491	
142	65B06377-3	10-2492	
143	65B06376-5	10-5303	
144	65B06276-10	10-2490	
145	65B06276-9	10-2492	
146	65B06263-5	10-2534	
147	65B06263-1	10-2504	
148	65B06260-5	10-2529	
149	65B06261-1	10-2531	
150	65B06260-6	10-2495	

189	65B06157-3	10-2595	
190	65B06157-1	10-2594	
191	65B06099-1	10-2630	
192	65B06479-1	10-2562	
193	65B06096-1	10-2629	
194	65B06109-6	10-5607	
195	65B06429-1	10-6360	
196	65B06096-1	10-2572	
197	65B06472-1	10-2509	
198	65B06627-1	10-2510	
199	65B0627-1	10-2510	
200	65B06627-1	10-2510	

239	65B06266-1	10-5312	
240	65B06246-600	10-2672	
241	65B06166-1	10-2596	
242	65B06197-1	10-2605	
243	65B06237-1	10-2620	
244	65B06237-1	10-2620	
245	65B06237-1	10-2620	
246	65B06297-1	10-2605	
247	65B06166-3	10-2596	
248	65B06246-2	10-2626	
249	65B06246-2	10-2626	
250	65B0625-2	10-6590	

289			
290			
291			
292			
293			
294			
295			

INSULATION PARTS  
THIS POWER

MAIN DECK

DECOMPRESSION FLOOR PANELS (14 PANELS)

MAIN DECK

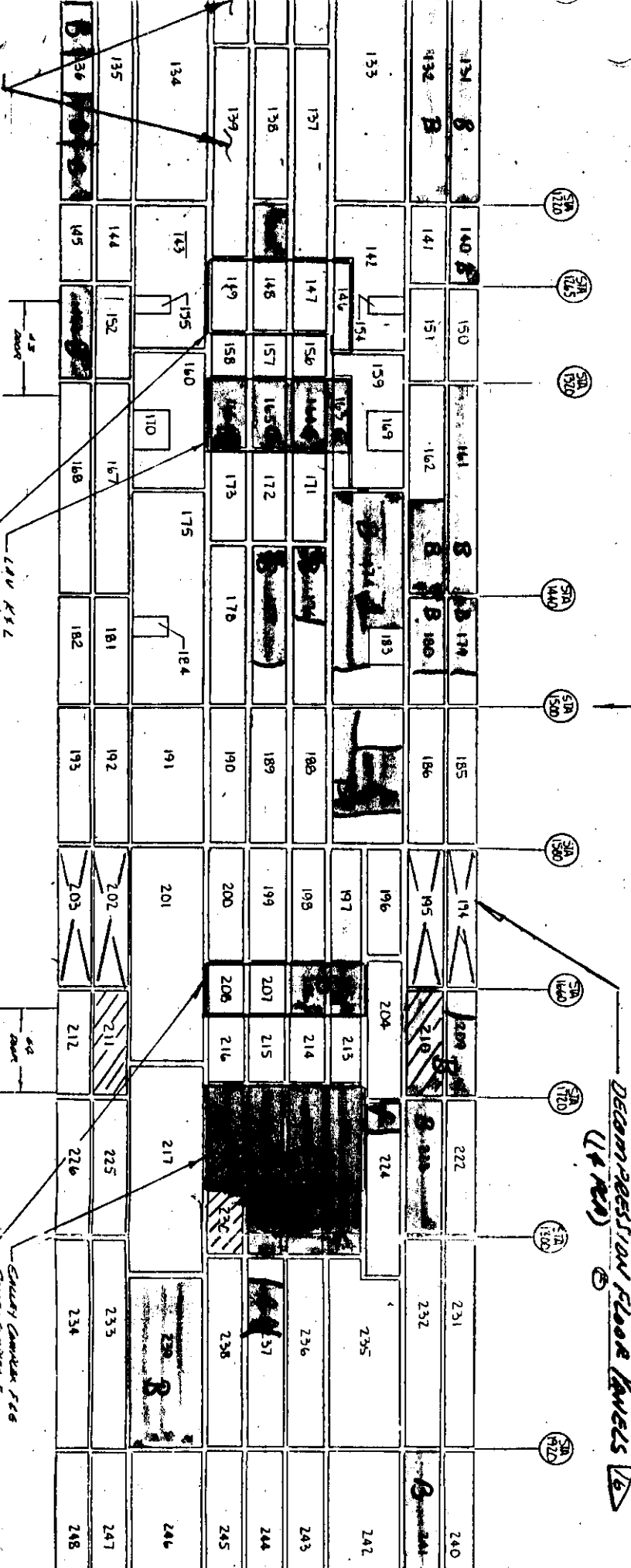

APPROXIMATE POSITION OF PANEL FOR  
STRUCTURE WITH SET BACKS

PANELS MODIFIED PER A10, 96063

APPROXIMATE POSITION OF PANEL FOR  
STRUCTURE WITH SET BACKS

- ▲ P. 115-DN
- ▲ P. 101-117
- ▲ P. 104-DN
- ▲ P. 101-105
- ▲ P. 103-DN
- ▲ P. 101-102
- ▲ P. 102-DN
- ▲ P. 101-119
- ▲ P. 101-106, 114-DN
- ▲ P. 101-103, 105, 101-113
- ▲ P. 107-DN
- ▲ P. 101-106

NOTES:

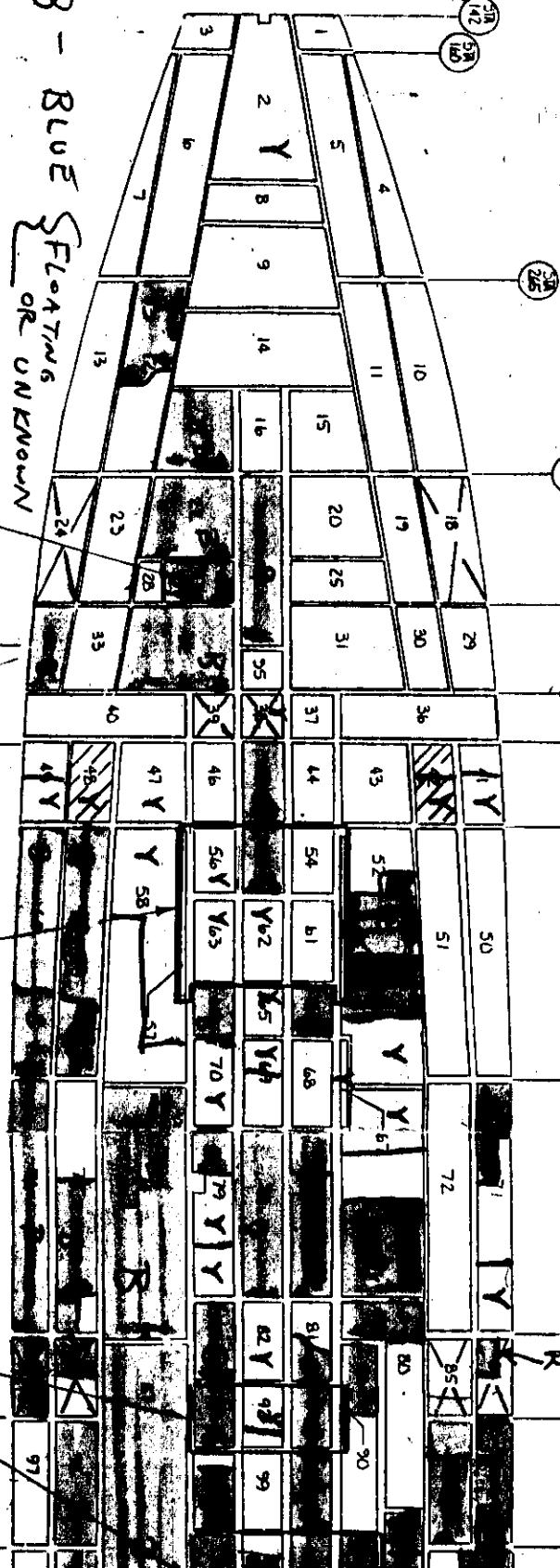
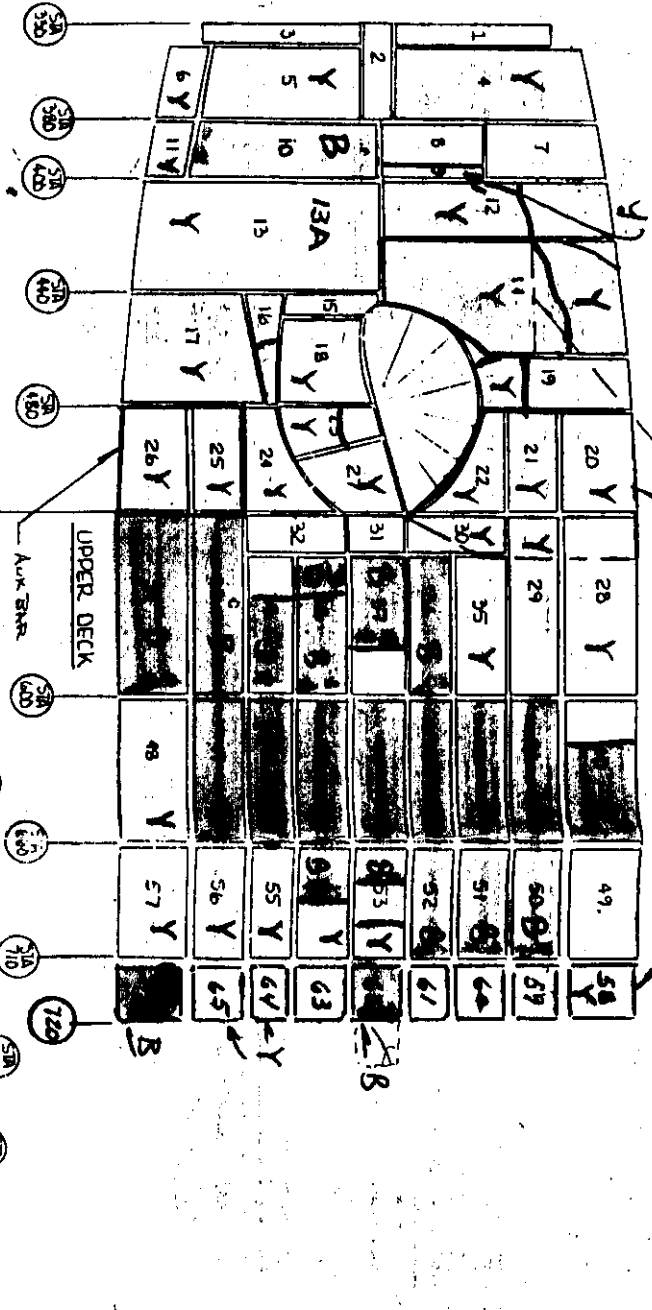

R RED  
G GREEN  
Y YELLOW

B - BLUE  
FLOATING  
OR UNKNOWN

APPROXIMATE POSITION OF PANEL FOR STRUCTURE WITH SET BACKS

CALLEY CAMBER A (AUG. 80)

CALLEY CAMBER B  
CALLEY CAMBER C (10)

IDENTIFIABLE  
FLOOR  
AS OF 10/1

SEC 41 Floor Beams - UPPER DECK

R0103

RA164

65B 00141 - 5002

65B 12400 - 5003

Upr Deck

Floor	440	65B 10932 - 14
Beams	460	65B 10933 - 31 & -32
	480	65B 10934 - 26 & -27
	500	65B 10935 - 22 & -23
	520	65B 10936 - 10

Circular Stairway Cutout

TRUSS 65B 07963 - 1, -2, -3, -4  
 STA 440 - 520

DIAG BEAM 65B 10939

STAIRWAY BEAMS 65B 10937 - 1 L/H

65B 10938 - 1 R/H

65B 11363 - 4 "CREW COMPARTMENT"

Henry Missel  
 Boeing 9-22-96

# FLOOR BEAM WRITEUP TERMINOLOGY

## ACRONYMS / DEFINITIONS

SQ BEAD

CL CENTER LINE

C/T COMMON TO

F/B FLOOR BEAM

S/T SEAT TRACK

F/P FLOOR PANEL OR FLOOR BOARD

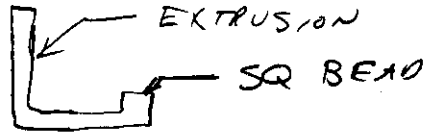

F/P INSERT

FAILURES:

NOTE:

DOESN'T IMPLY STRAIGHT BEARING FAILURE

TEAR OUT



PULL THRU

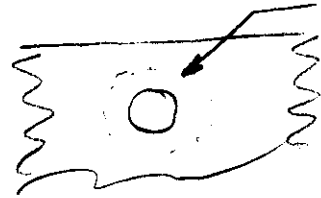

SOME PORTION OF FIBER STILL INTACT BETWEEN INSERT CL & EDGE OF PANEL

FAST FAILURE

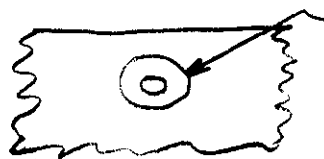

INSERT STILL IN PANEL

SOB - SIDE OF BODY (OR END OF PART)

UPPER CHORD <sup>SHOWN</sup> LOWER CHORD (SIMILAR)  
FLOOR BEAM DAMAGE

DOWNWARD CUP

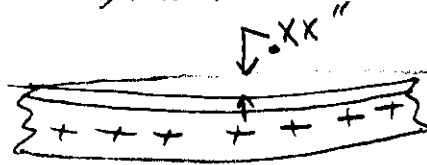

UPWARD BOW

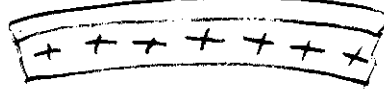

BEND UP  
OR BENT UP

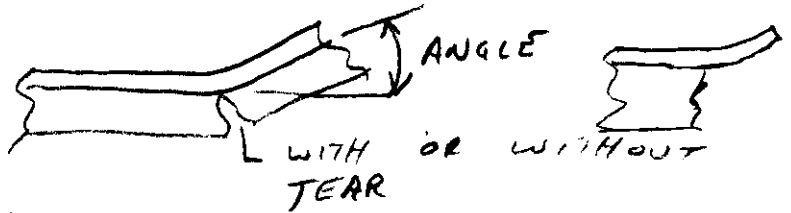

BEND DOWN  
OR BENT DOWN

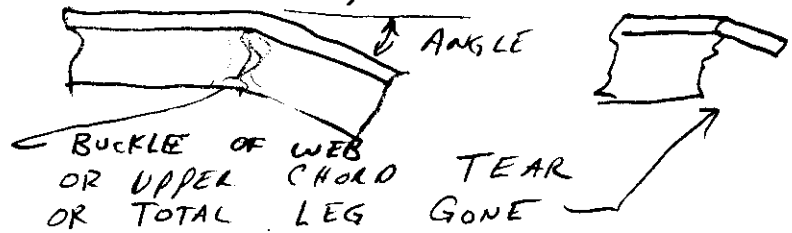

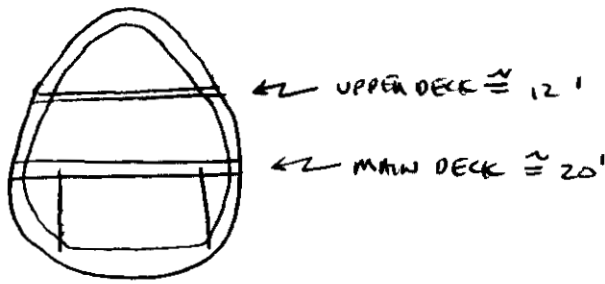

FWD BODY 980  
 $\frac{-420}{560} \Rightarrow 28 \text{ BEAMS}$

AFT BODY 2340  
 $\frac{-1500}{840} \Rightarrow 42 \text{ BEAMS}$   
 $\frac{-4 \text{ (FRAMES)}}{38 \text{ BS}}$

70 BEAMS @ 20' = 1400'  
 $\frac{-80'}{1320' \text{ BS}}$

UPPER DECK 720  
 $\frac{-220}{500} \Rightarrow 25 \text{ BEAMS @ } 12' = 300'$

TOTAL LENGTH OF SUBSET OF FLOOR BEAMS  $\approx 1700'$   
 $1320'$

IN AND AROUND HANGERS

- 1) FLOOR PANEL AREA = 110'
- 2) FUSELAGE LAYOUT = 200'
- 3) FUSELAGE RECONSTRUCTION = 25'
- 4) INTERIORS HANGERS = 20'
- 5) ELECTRICAL LAYOUT AREAS = 70'
- 6) "BACK ROOM" = 25'

TOTAL = 450' (~ 34%)

NOTES

- MANY FLOOR BEAM SECTIONS ARE CONNECTED TO "UNMOVABLE" STRUCTURE
- AN INTACT 3-4 FOOT SECTION OF CHORDS AND WEB IS RARE
- SIGNIFICANTLY MORE UPPER DECK FLOORING IS AVAILABLE (PER %) THAN MAIN DECK

CONCLUSION

\* THE AREA BETWEEN STA 600 AND 1000 (MAIN DECK) IS BEING CONCENTRATED ON.



# IDENTIFIABLE FLOOR BEAM SEGMENTS IN SECTION 42 (YELLOW & RED ZONE)

NUM = FLOOR BEAM RECOVERED

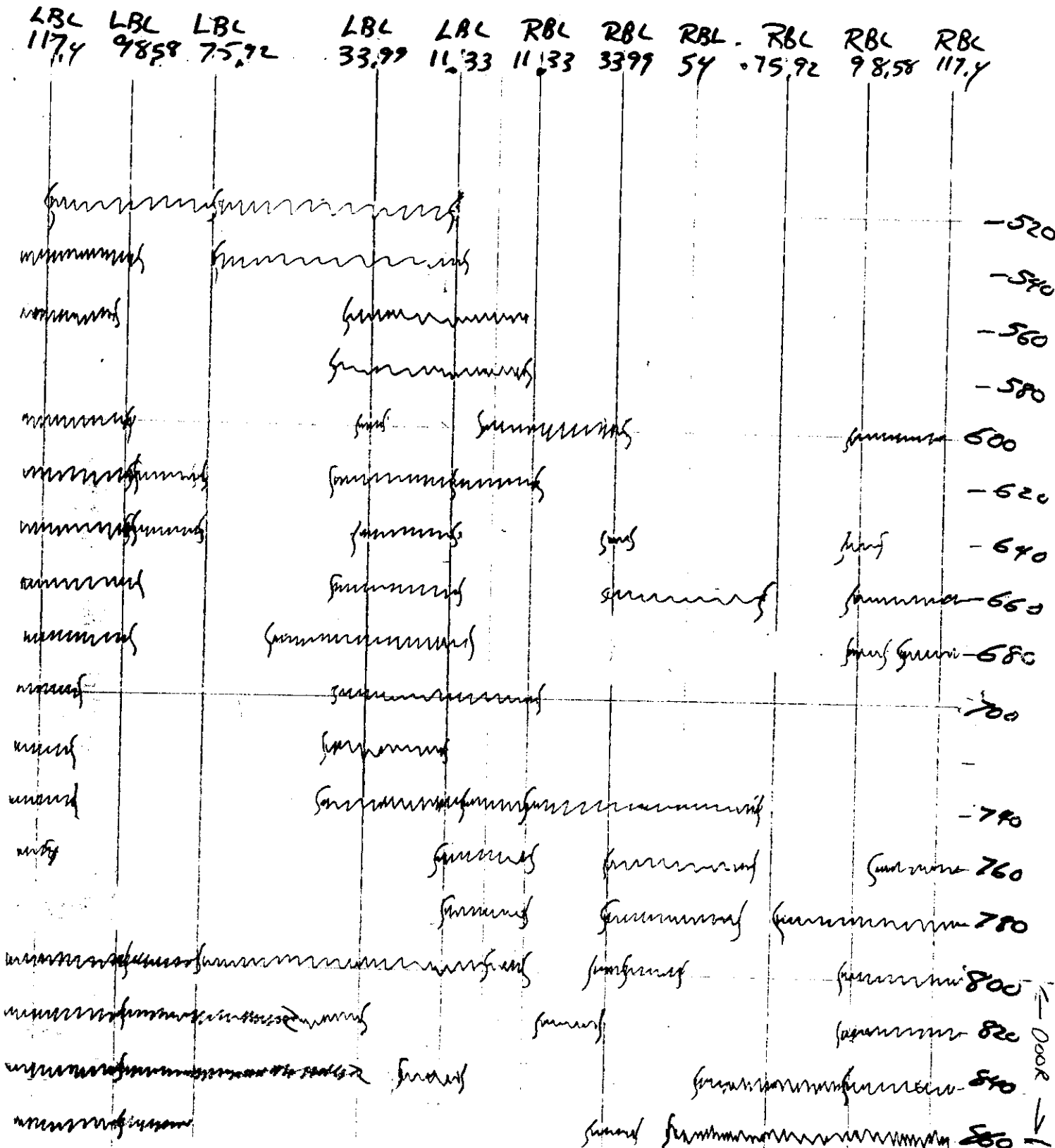

DOOR ↓



<del>XXXXXXXXXXXXXXXXXXXX</del>	<del>XXXXXXXXXXXXXXXXXXXX</del>				-520
<del>XXXXXXXXXXXX</del>	<del>XXXXXXXXXXXX</del>				-540
<del>XXXXXXXXXXXX</del>	<del>XXXXXXXXXXXX</del>				-560
<del>XXXXXXXXXXXX</del>	<del>XXXXXXXXXXXX</del>				-580
<del>XXXXXXXXXXXX</del>	<del>XXXX</del>	<del>XXXXXXXXXXXX</del>		<del>XXXXXX</del>	600
<del>XXXXXXXXXXXX</del>	<del>XXXXXXXXXXXX</del>				-620
<del>XXXXXXXXXXXX</del>	<del>XXXXXXXXXXXX</del>	<del>XXXX</del>	<del>XXXX</del>	<del>XXXX</del>	-640
<del>XXXXXXXXXXXX</del>	<del>XXXXXXXXXXXX</del>	<del>XXXXXXXXXXXX</del>	<del>XXXXXXXXXXXX</del>	<del>XXXXXXXXXXXX</del>	-660
<del>XXXXXXXXXXXX</del>	<del>XXXXXXXXXXXX</del>			<del>XXXX</del>	-680
<del>XXXXXX</del>	<del>XXXXXXXXXXXX</del>				700
<del>XXXXXX</del>	<del>XXXXXXXXXXXX</del>				-
<del>XXXXXX</del>	<del>XXXXXXXXXXXX</del>	<del>XXXXXXXXXXXX</del>	<del>XXXXXXXXXXXX</del>	<del>XXXXXXXXXXXX</del>	-740
<del>XXXXXX</del>	<del>XXXXXX</del>	<del>XXXXXXXXXXXX</del>	<del>XXXXXXXXXXXX</del>	<del>XXXXXXXXXXXX</del>	760
		<del>XXXXXX</del>	<del>XXXXXXXXXXXX</del>	<del>XXXXXXXXXXXX</del>	780
<del>XXXXXXXXXXXX</del>	<del>XXXXXXXXXXXX</del>	<del>XXXXXX</del>	<del>XXXXXX</del>	<del>XXXXXXXXXXXX</del>	800
<del>XXXXXXXXXXXX</del>	<del>XXXXXXXXXXXX</del>	<del>XXXXXX</del>		<del>XXXXXXXXXXXX</del>	820
<del>XXXXXXXXXXXX</del>	<del>XXXXXX</del>	<del>XXXXXXXXXXXX</del>	<del>XXXXXXXXXXXX</del>	<del>XXXXXXXXXXXX</del>	840
<del>XXXXXXXXXXXX</del>	<del>XXXXXX</del>	<del>XXXXXX</del>	<del>XXXXXXXXXXXX</del>	<del>XXXXXXXXXXXX</del>	860
<del>XXXXXXXXXXXX</del>	<del>XXXXXXXXXXXX</del>	<del>XXXXXX</del>	<del>XXXXXXXXXXXX</del>	<del>XXXXXXXXXXXX</del>	880
<del>XXXXXXXXXXXX</del>	<del>XXXXXXXXXXXX</del>	<del>XXXXXX</del>	<del>XXXXXXXXXXXX</del>	<del>XXXXXXXXXXXX</del>	900
<del>XXXXXXXXXXXX</del>	<del>XXXXXXXXXXXX</del>	<del>XXXXXXXXXXXX</del>	<del>XXXXXXXXXXXX</del>	<del>XXXXXXXXXXXX</del>	920
<del>XXXXXXXXXXXX</del>	<del>XXXXXXXXXXXX</del>	<del>XXXXXXXXXXXX</del>	<del>XXXXXXXXXXXX</del>	<del>XXXXXXXXXXXX</del>	940
<del>XXXXXXXXXXXX</del>	<del>XXXXXXXXXXXX</del>	<del>XXXXXXXXXXXX</del>	<del>XXXXXXXXXXXX</del>	<del>XXXXXXXXXXXX</del>	960
<del>XXXXXXXXXXXX</del>	<del>XXXXXXXXXXXX</del>	<del>XXXXXXXXXXXX</del>	<del>XXXXXXXXXXXX</del>	<del>XXXXXXXXXXXX</del>	980

GREEN

WHITE

GREEN/WHITE