

WING CENTER SECTION - SPANWISE BEAM # 2

CW-705
C-2170
GREEN

This section is from LBL 11.00 to LBL 33.00 and from near the upper chord to just below the honeycomb access door. Three stiffeners remain attached to the web and honeycomb access door.

This section is bowed forward at the honeycomb access door area and the stiffeners, web, and the door exhibit forward bending. In between the stiffeners that are above the access door, there is a 4" x 14" section of web that is missing in each stiffener bay. The edges of the remaining web around these holes have a very large quantity of horizontal fractures radiating from the web edge. These web edges are also predominately bent aft with local regions that are bent fwd. The honeycomb door remains attached to the vertical stiffeners on either side of the door but the middle 8" of the door from the top to bottom is missing and the remaining honeycomb is shredded fwd ^{more than} ~~and~~ att. _{all}

There is heavy fire damage and soot accumulations. See the fire and explosion group notes for complete documentation.

W. J. Spang 10/31/96 BOEING
J. J. Spang 11/1/96 FAA
SD GREEN 11/01/96 ALPA
Cl. J. H. 11-75-96 IAM
J. J. Spang 12-14-96 TWA

CW-705

10 Bolts

10 Bolts

10 Bolt

SB # 2

N

7.0"

15"

7"

SNV S SW 4

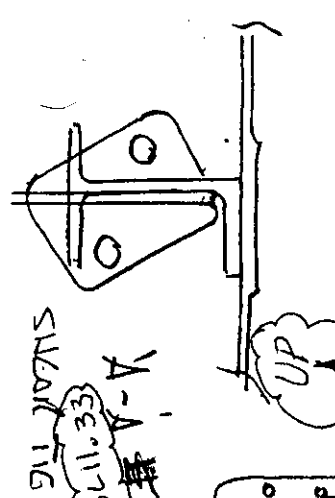

SWEATING

APPROX 5 IN

B'B'

NO LOOKING FROM REAR

CROSS BEAM

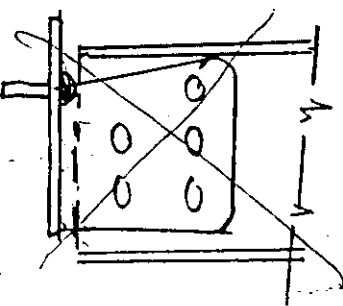
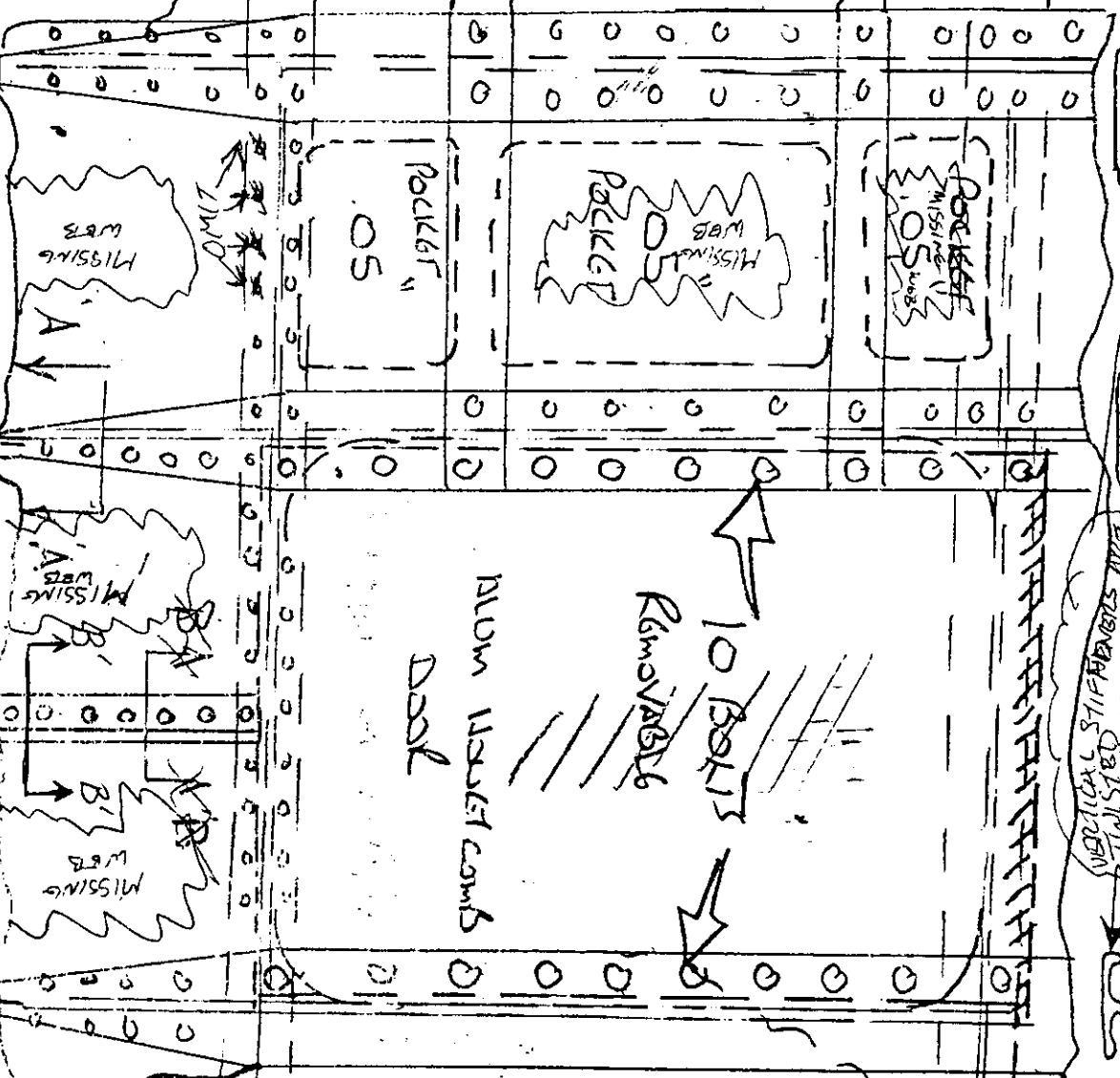

CROSS BEAM