

CW 523
Lot # 11-20-96-82
Dredged Red Debris field
X-4021

Wing Center Section front spar upper chord segment
RBL / 08

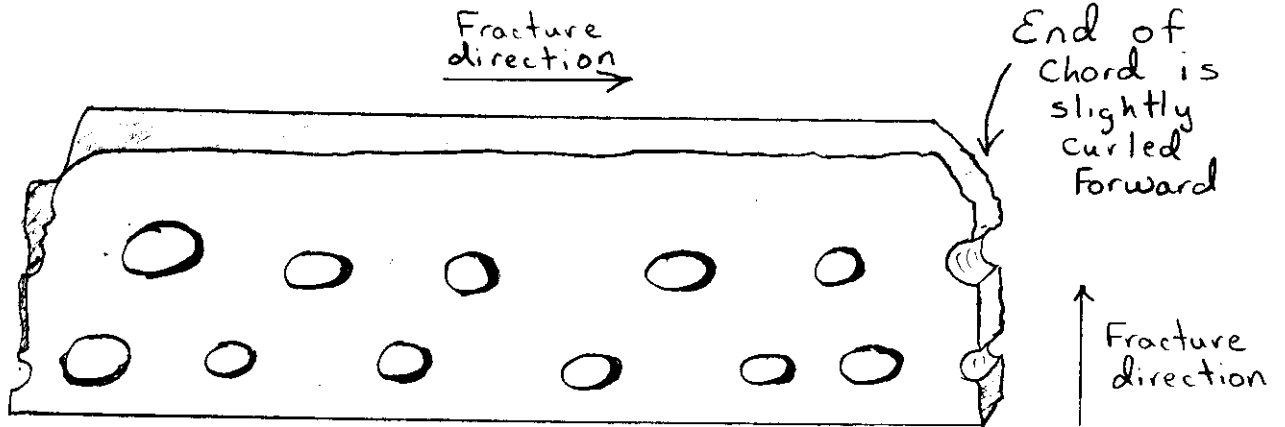

UP
Inbd ←

View Looking Forward

- ALL fasteners common to front spar web are sheared off and show the chord segment, relative to the web, moved outboard.
- Either dirty or has a light layer of soot; more so on the inside surface
- No evidence of slow growth fractures.

John Johnson - ALPA
3-20-97

Demio Santiago IAM
3-28-97

Stephen F. Klupach Jr
FAM 01-10-97
04-02-97

Brandurhuden
TWA 3/23/97

Jim Powers
11-23-96
Boeing

WING CENTER SECTION -

Red
CW 523

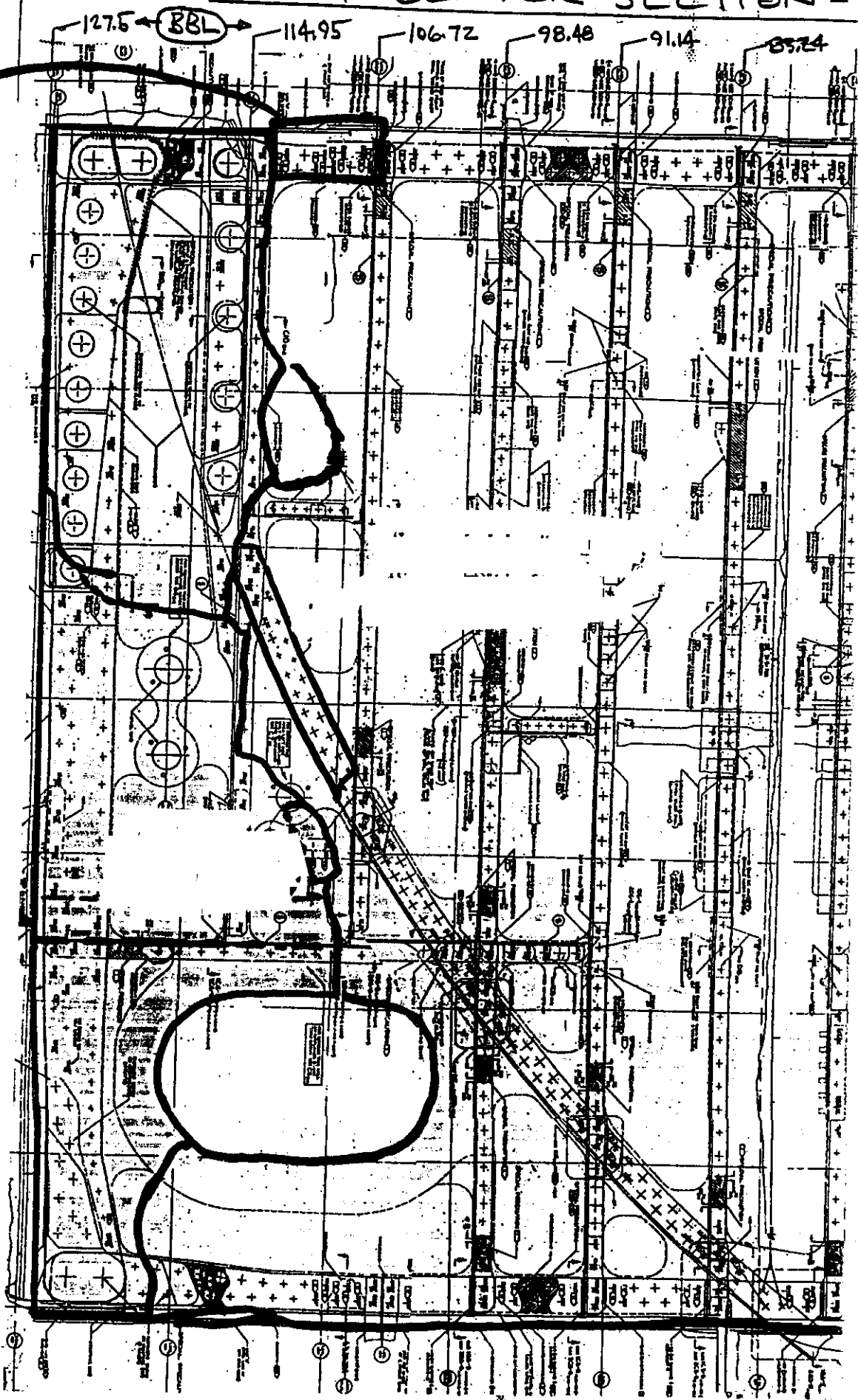

Stephen F. Klapach Sr
FBA 01-10-97
64-02-92