



NATIONAL TRANSPORTATION SAFETY BOARD

Office of Aviation Safety
Washington, D.C. 20594

STRUCTURES GROUP CHAIRMANS FACTUAL REPORT

DCA06MA064
December 19, 2006

Attachment 1
Wreckage Distribution Diagram

Wreckage Distribution¹

Number	Description	X (ft)	Y (ft)	Distance (ft)	Height (ft)
1	Tree	-898.1	-67.2	900.6	6.7
2	Tree	-931.6	-66.4	934.0	7.0
3	Tree	-940.3	-60.8	942.3	8.9
4	Tree	-955.8	-56.3	957.5	12.1
5	Tree	-969.0	-52.1	970.4	Unknown
6	Tree	-998.8	-36.5	999.5	Unknown
7	Tree	-1015.1	-31.2	1015.6	26.3
7	Tree	-1015.1	-31.2	1015.6	24.2
8	Tree	-1025.1	-30.7	1025.6	16.8
8	Tree	-1025.1	-30.7	1025.6	32.8
8	Tree	-1025.1	-30.7	1025.6	33.4
8	Tree	-1025.1	-30.7	1025.6	30.1
9	Tree	-1076.0	-33.3	1076.5	24.3
10	Tree	-1250.0	-43.7	1250.8	20.3
11	Tree	-1263.0	-34.5	1263.5	26.9
12	Tree	Not Used			
13	Tree	-1341.0	-42.2	1341.7	Unknown
14	Tree	-1376.5	-33.7	1376.9	13.8
15	Tree	-1427.4	-124.7	1432.8	Unknown
	Downed Tree	-1703.9	-103.9	1707.1	Unknown
105	CVR	-1785.1	-114.4	1788.8	N/A
106	FDR	-1760.1	-132.7	1765.1	N/A
500	Center wing box and inboard right wing	-1805.6	-64.7	1806.8	N/A
501	Right wing section	-1835.0	-66.0	1836.2	N/A
502	Left inboard wing near fuselage	-1842.0	-127.9	1846.4	N/A
503	NOT USED				
504	Left wing leading edge transition area	-1672.9	-84.1	1675.0	N/A
505	Empennage	-1664.2	-123.2	1668.8	N/A
506	Right outboard wing section with aileron and winglet	-1583.1	-246.9	1602.2	N/A
507	Right inboard flap vane	-1624.9	-77.2	1626.7	N/A
508	Left inboard wing section with spoiler	-1673.6	-127.4	1678.4	N/A

¹ All distances are measured from the end of runway 8/26 and the centerline.

Number	Description	X (ft)	Y (ft)	Distance (ft)	Height (ft)
509	Nose landing gear	-1686.7	-141.9	1692.7	N/A
510	NOT USED				
511	Flap actuator and mounting structure	-1465.6	-81.1	1467.8	N/A
512	Left main landing gear	-1367.3	-14.3	1367.4	N/A
513	Radar antenna	-1360.0	25.3	1360.2	N/A
514	Left wing leading edge - 3' section	-1341.1	-135.8	1348.0	N/A
515	Left outboard wing leading edge section - 15"	-1156.8	-59.9	1158.3	N/A
516	Left front fuselage skin panel - with logo lettering	-1116.3	-79.8	1119.1	N/A
517	NOT USED				
518	Left winglet lower section	-928.7	-73.7	931.6	N/A
519	Left winglet upper section - 18"	-895.4	-71.5	898.3	N/A
520	Inboard flap section	-734.9	-72.1	738.4	N/A
521	Right landing gear door	-408.0	33.5	409.4	N/A
522	Radome section	-980.8	-62.6	982.8	N/A
523	Radome section	-1007.7	-19.8	1007.9	N/A
524	Side stay actuator	-1109.7	-8.7	1109.7	N/A
525	3' wing leading edge section - left side	-1526.6	-109.3	1530.5	N/A
600	NOT USED				
601	VHF antenna	-1098.1	-31.2	1098.5	N/A
602	Air driven generator	-1417.8	21.6	1418.0	N/A
603	Air driven generator spinner blades and hub	-1352.1	-78.6	1354.4	N/A
604	Engine oil replenishment panel	-1506.8	-46.9	1507.5	N/A
605	Portion of left aileron	-1476.0	-63.0	1477.3	N/A
606	Main cabin door handle	-1562.2	-69.3	1563.7	N/A

Number	Description	X (ft)	Y (ft)	Distance (ft)	Height (ft)
607	Captain DAD panel	-1550.6	-59.1	1551.7	N/A
608	CVR panel and footrest	-1562.2	-69.3	1563.7	N/A
609	Rudder pedal - left hand (1)	-1580.5	-64.3	1581.8	N/A
610	Captain's oxygen mask and container	-1588.6	-72.2	1590.2	N/A
611	Windshield Wiper	-1590.0	-70.8	1591.6	N/A
612	Rudder pedal - left hand (2)	-1596.2	-71.2	1597.8	N/A
613	Hydraulic brake accumulator	-1631.9	-93.1	1634.6	N/A
614	Captain's steering tiller	-1656.5	-83.8	1658.6	N/A
615	Loose display unit (MFD)	-1646.4	-66.2	1647.7	N/A
616	Standby altimeter, Display unit (MFD), Rudder pedal (RH), Standby horizon, and GCU test panel	-1780.9	-95.3	1783.4	N/A
617	Left nose gear tire	-1748.8	-180.2	1758.1	N/A
618	Outflow valve and vacuum regulator	-1770.0	-121.5	1774.2	N/A

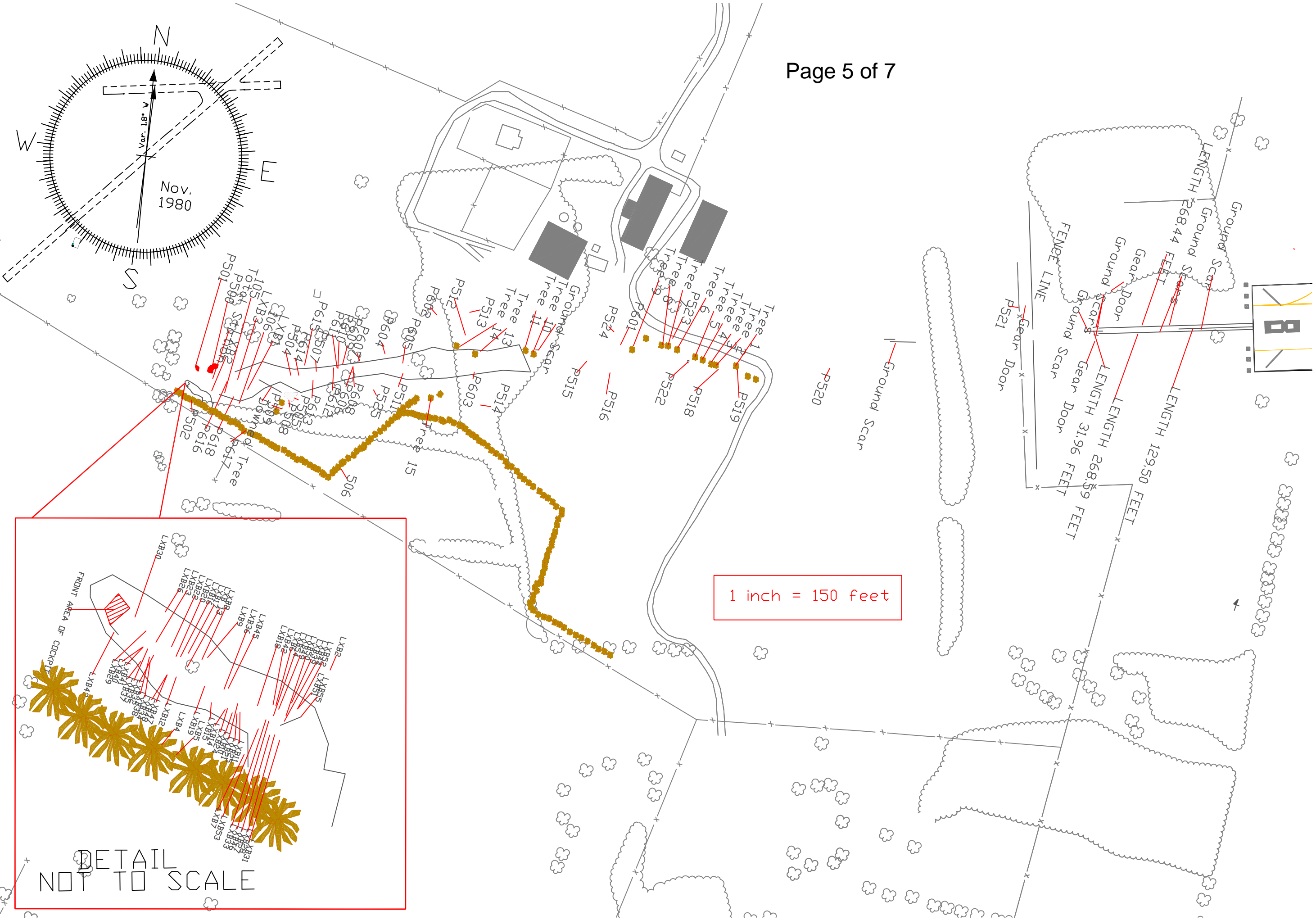

1 inch = 150 feet

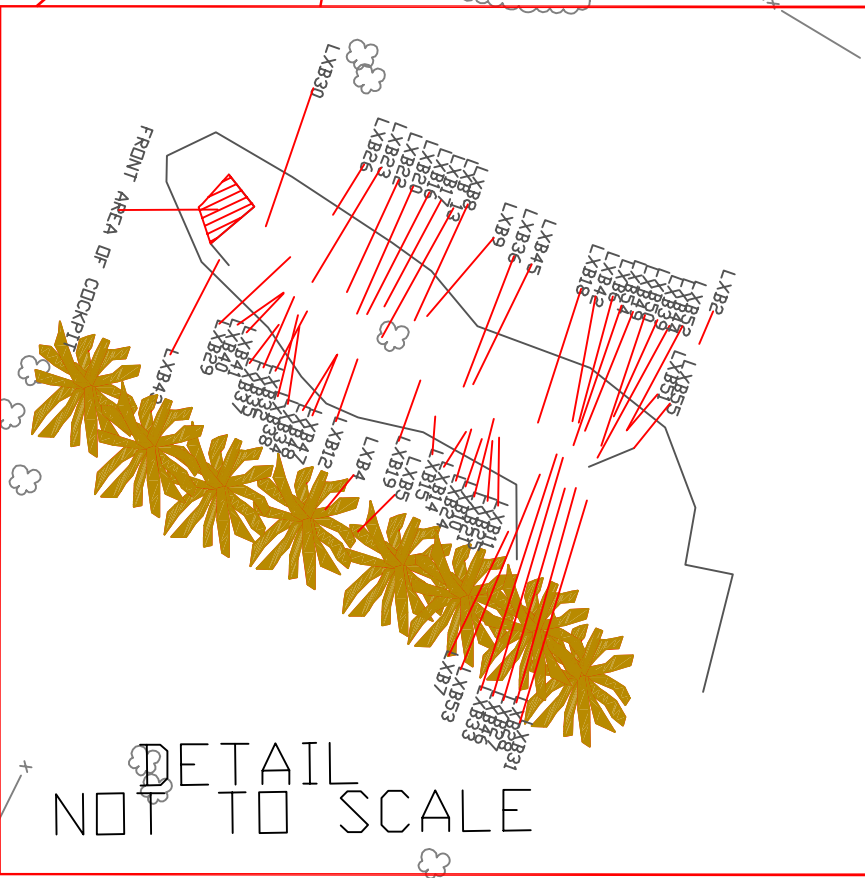

DETAIL NOT TO SCALE

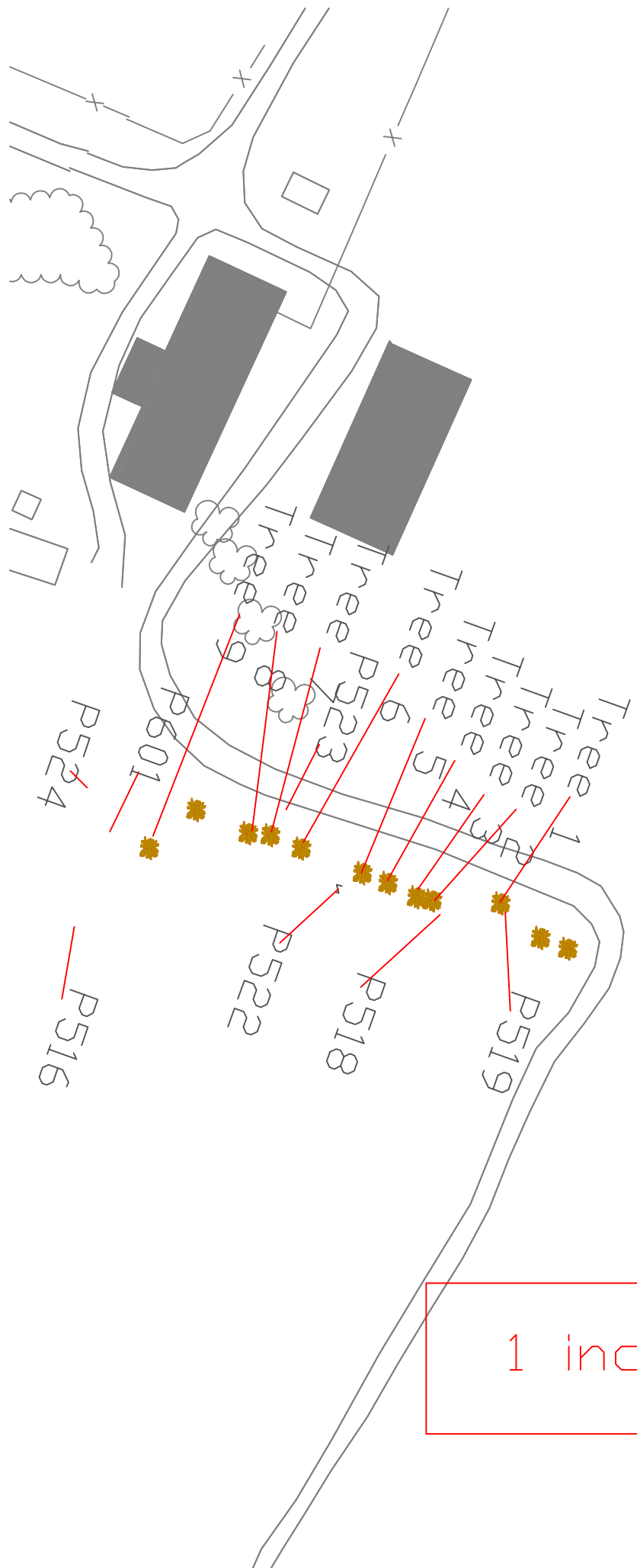

1 inch = 75 feet

Ground Scar

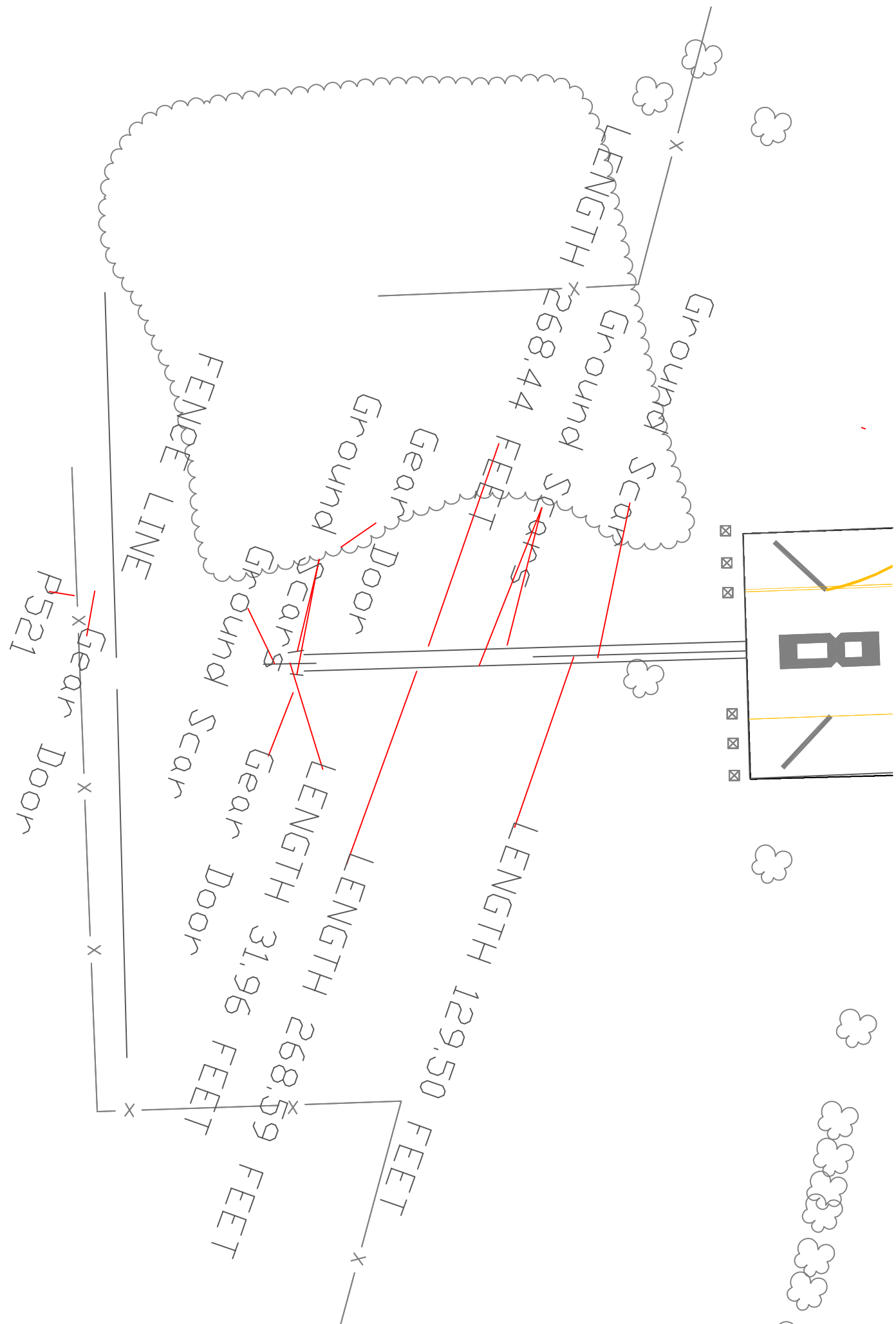
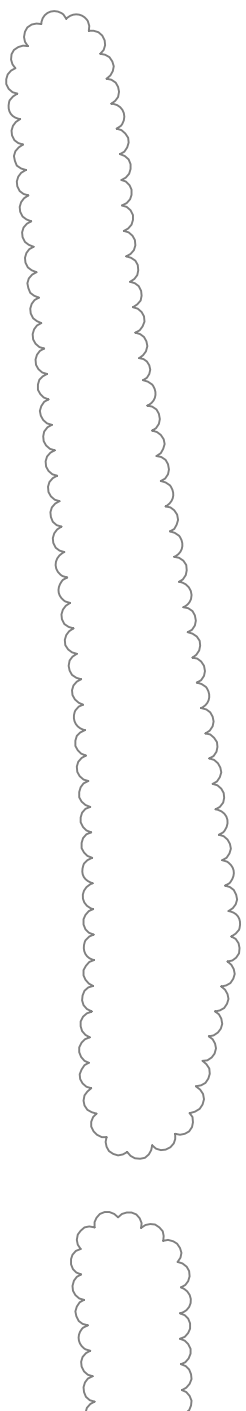

1 inch = 50 feet

