

# MU-2 PARTS CATALOG

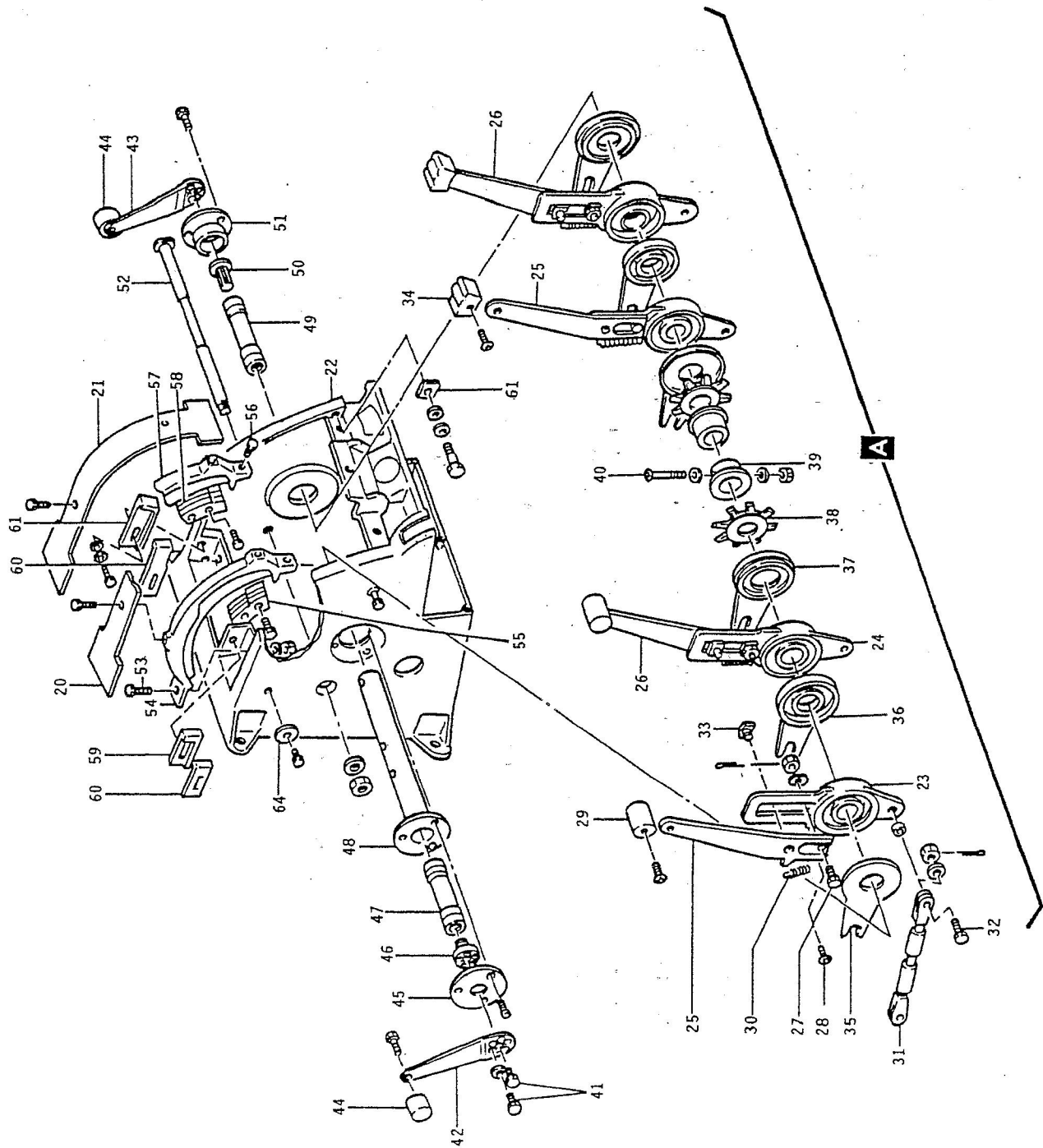

Figure 103. Center Pedestal Inst I (Sheet 2)

# MU-2 PARTS CATALOG

FIGURE AND INDEX NO.	PART NUMBER.	NOMENCLATURE							VENDOR CODE	UNITS PER ASSY	USABLE ON CODE
		1	2	3	4	5	6	7			
103 - 20	016A-91508-5 AN507-1032R5	COVER ASSY							1		
		SCREW							2		
21	022A-91509-9  AN507-1032R5	COVER ASSY							1		
		/ ATTACHING PARTS / SCREW							2		
22	016A-91511-41 016A-91513-41 016A-91513-42 016A-91513-51 016A-91513-52	BOX ASSY							1		
		LEVER ASSY-PWR LEVER LH							1		
		LEVER ASSY-PWR LEVER RH							1		
		LEVER ASSY-CONDITION LEVER LH							1		
		LEVER ASSY-CONDITION LEVER RH							1		
23	016A-91514-1	BELLCRANK-LH							1		
		/ USED ON 016A-91513-41, -51 /									
24	016A-91514-2	BELLCRANK-RH							1		
		/ USED ON 016A-91513-42, -52 /									
25	016A-91515-1  035A-91515-1	LEVER-LH							1	C	
		/ USED ON 016A-91513-41 /									
		LEVER-LH							1	D	
26	016A-91515-1  016A-91515-2	/ USED ON 016A-91513-41 /							1		
		LEVER-LH							1		
		LEVER-RH							1	C	
27	016A-91517 016A-91518 AN320-4 MS24665-134	/ USED ON 016A-91513-51 /							1		
		LEVER-RH							1	C	
		/ USED ON 016A-91513-42 /								1	D
28	035A-91515-2  016A-91515-2	LEVER-RH							1		
		/ USED ON 016A-91513-42 /									
		LEVER-RH							1		
29	016A-91519  016A-91519-11	/ USED ON 016A-91513-52 /							1		
		BOLT							1		
		WASHER							1		
30	016A-91519-11  AN507-1032R12	NUT							1		
		PIN							1		
		SCREW							2		
31	010A-91729 016A-91567-11	KNOB-PWR LEVER							1		
		/ USED ON 016A-91513-41, -51 /									
		/ WHN EXH USE 016A-91519-11 /									
32	NAS1103-6D 220AS-03-450 AN320-3 AN960D10L MS24665-132	KNOB-PWR LEVER							1		
		/ USED ON 016A-91513-41, -51 /									
		/ USE 016A-91519 UNTIL EXH /									
33	016A-91516-3  016A-91516-4	SCREW							1		
		/ USED ON 016A-91513-41, -51 /									
		SPRING							1		
34	016A-91520  016A-91520-11	ROD ASSY							1		
		BOLT							1		
		BUSHING							1		
35	016A-91520-11  AN507-1032R10	NUT							1		
		WASHER							1		
		PIN							1		
36	016A-91523 016A-91524 016A-91525	PIN-LH							1		
		/ USED ON 016A-91513-41, -51 /									
		PIN-RH							1		
37	016A-91526 016A-91527	/ USED ON 016A-91513-42, -52 /									
		KNOB-CONDITION LEVER							1		
		/ USED ON 016A-91513-51, -52 /									
38	016A-91526 016A-91527	/ WHN EXH USE 016A-91520-11 /									
		KNOB-CONDITION LEVER							1		
		/ USED ON 016A-91513-51, -52 /									
39	016A-91526 016A-91527	/ USE 016A-91520 UNTIL EXH /									
		SCREW							1		
		/ USED ON 016A-91513-51, -52 /									
35	016A-91523	FRICTION DISK							2		
		FRICTION DISK							2		
36	016A-91524	FRICTION DISK							2		
		FRICTION DISK							2		
37	016A-91525	FRICTION DISK							2		
		SPRING							2		
38	016A-91526	RETAINER							2		
		RETAINER							2		