

Chris Hill

From: Lindsey Bartlett
Sent: Tuesday, December 17, 2013 6:00 AM
To: Chris Hill; Birmingham Engineering
Cc: Robert Rumph; David Gallagher
Subject: RE: 7544 64th Courtway S
Attachments: 7544-7546_64th_Courtway_S__[235873].tiff

I found one service card for 7544-7546 64th Courtway S. It is attached. I will get you a print of the area with any valves.

-----Original Message-----

From: Chris Hill
Sent: Tuesday, December 17, 2013 5:45 AM
To: Birmingham Engineering
Cc: Robert Rumph; David Gallagher
Subject: 7544 64th Courtway S

We are in need of some assistance with prints for this address and surroundings. We are having trouble locating the service to kill here on an active fire. We need to see where a valve(s) may be if we have to cut this off to stop the gas flow.

David Gallagher's cell # is [REDACTED]
Robert Rumph's cell # is [REDACTED]
My cell # is [REDACTED]

Sent from my BlackBerry Wireless Handheld

1-45 REV.

Bldg. $\frac{E}{20}$

SERVICE RECORD

ALABAMA GAS CORP

OLD HOUSE

NEW HOUSE ☒No. 7544-46-64th Courtway - Marks Village - Gate City

NAME

DATE 10-26-51

SIZE SERVICE $1\frac{1}{2}$ IN. SIZE TAP 1 IN. KIND OF COATING Pipe enamelSERVICE IS 19 FT. IN. FROM E OF W Side $\frac{E}{20}$ MAIN DATA: SIZE $2\frac{1}{4}$ IN. KIND CT DEPTH $2\frac{1}{2}$ MAIN IS 17 FT. IN. FROM N OF N Side $\frac{N}{10}$

CONDITION OF MAIN

New

PIPE

FITTINGS

SIZE	RENEWAL	SERVICE	STUB	ST	ELL	NIPPLE	TEE	CAP	PLUG	RED'R	SER.	SER.	PIPE
	FEET	FEET	FEET	ELL							COCK	COUP.	SADDLE
1"						1-1x2							
1 1/2"			29'	1	1-1 1/2x1						1		

TIED 62 FT. OF 1 IN. PLUMBER'S LINE TO STUB.

ACCT. NO. 441-961-10

ORDER NO. ST 114
AND 7'-1 1/2" PIPEBuckman Const
McClure

FOREMAN

MEERKS VILLAGE
Gate City

SERVICE DRIVE #2C

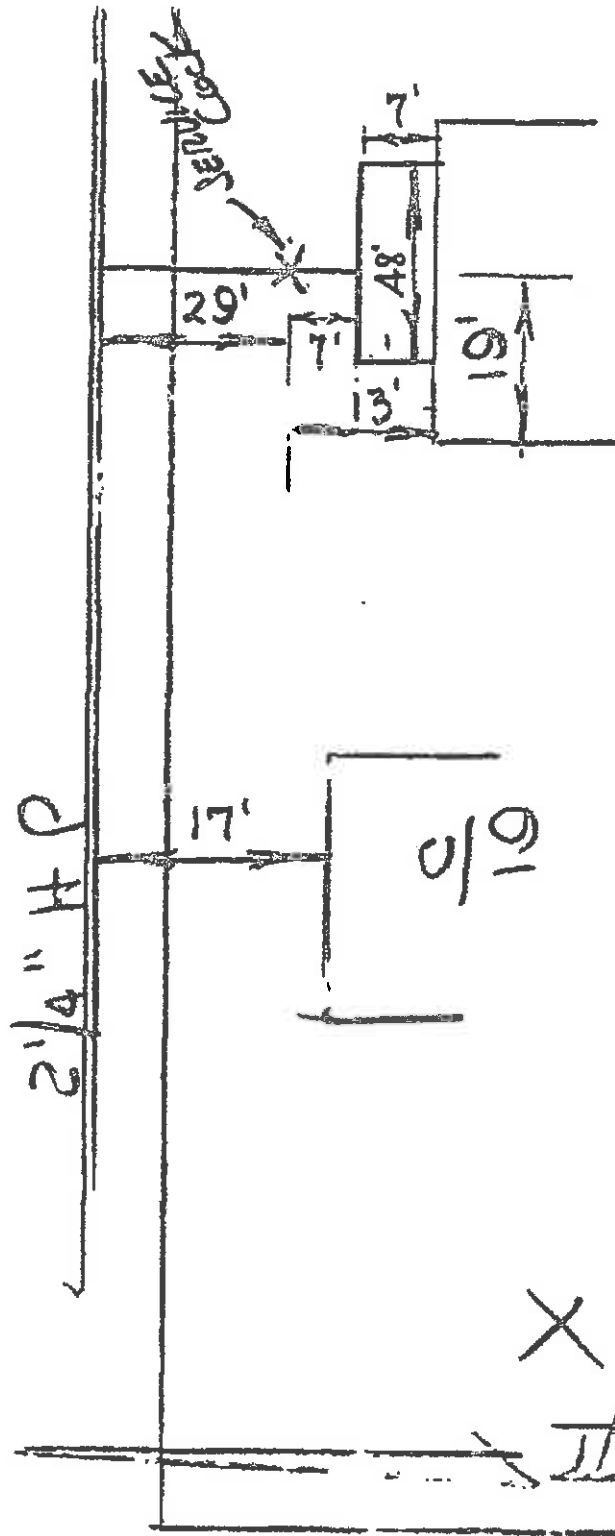

64± Countway $\frac{E}{20}$

X $\frac{E}{18}$

Project Sheet 1