

DCA-08-MR-009

**Head-on Collision of
Metrolink Commuter Train No. 111
and UP Freight Train No. LOF65-12**

Chatsworth, CA

September 12, 2008

**Metrolink's Ventura Subdivision
Track Chart**

14 pages, including cover



MILES 426 427 428 429

SPEED	70-60		53#-48	
CONTROL	CTC (UPRR)		CTC	
HORIZONTAL ALIGNMENT	MAIN TRACK			
CURVE NUMBER	204	205	206	
DEGREE CURVE	02°00'00"	02°00'00"	01°00'00"	
LENGTH CURVE	369'	480'	240'	
LENGTH SPIRAL	369'	300'	240'	
LENGTH CURVE	X"	4.00"	1.00"	
SUPERELEVATION				

← TO SANTA BARBARA

VERTICAL ALIGNMENT

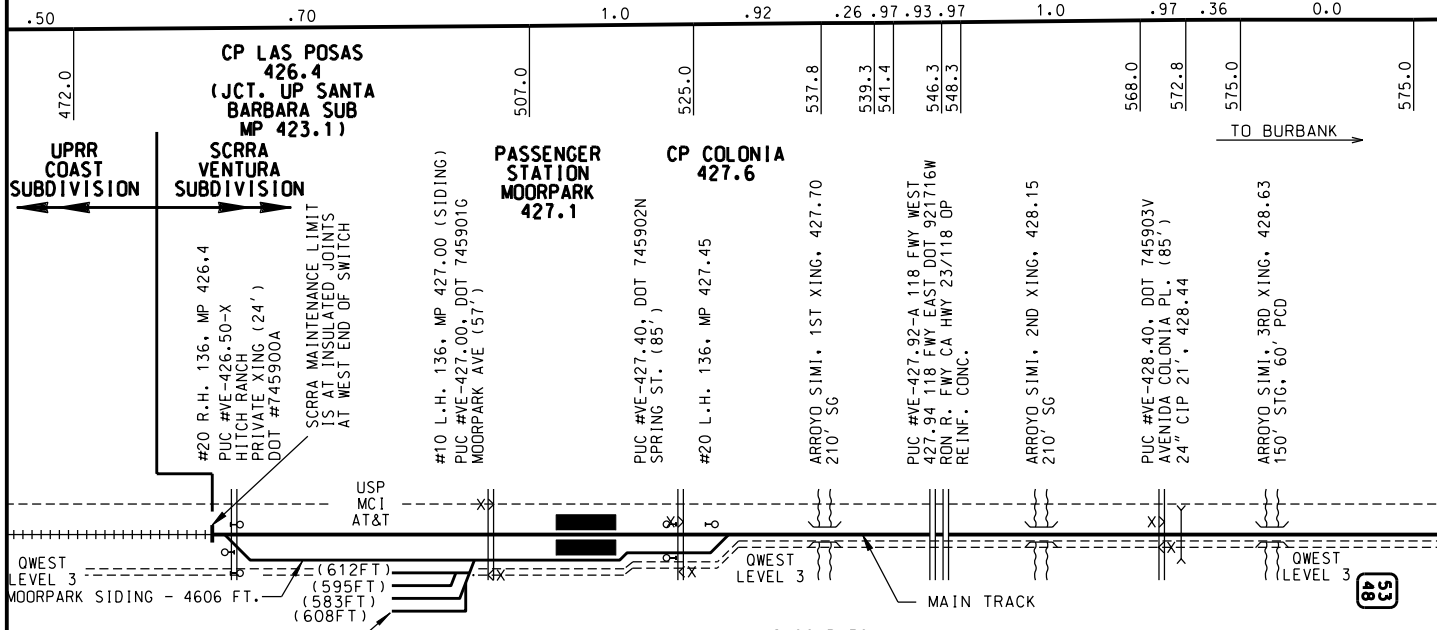

→ TO BURBANK

MILES 426 427 428 429

MAIN TRACK #1	RAIL WT.	132	136	136	132	136	132			
	RAIL YR.	SH86	SH72	03	04	06 PAN	04	SH86	SH74	SH86
	TIES			00				00 (EXCEPT BRIDGES)		
	BALLAST					CR ROCK				

06 PAN

SIDING	RAIL WT.	136-132
	RAIL YR.	01-03 R52-55
	TIES	00 WOOD
	BALLAST	



MILES 429 430 431 432

SPEED	53#-48		73# 60		70# 60	
CONTROL	CTC					
HORIZONTAL ALIGNMENT	FL FL					
MAIN TRACK						
CURVE NUMBER	207	208	209	210	211	
DEGREE CURVE	04° 00' 00"	02° 00' 00"	02° 00' 00"	02° 00' 00"	02° 30' 00"	
LENGTH SPIRAL	460'	360'	360'	360'	400'	
LENGTH CURVE	900'	600'	300'	1360'	1360'	
SUPERELEVATION	4.75"	4.00"	4.00"	4.00"	5.00"	

VERTICAL ALIGNMENT	1.0	.52	.92	.84	.92	1.0	.97	.93	.97	1.0	.97	.93	.97	1.0	.96					
	592.0	598.0	602.2	610.7	614.9	622.2	624.2	630.5	632.5	643.7	645.7	651.0	653.0	689.2	691.2	708.7	710.7	711.5	717.4	720.0

TO MOORPARK

CP MADERA
MP 431.1

TO BURBANK

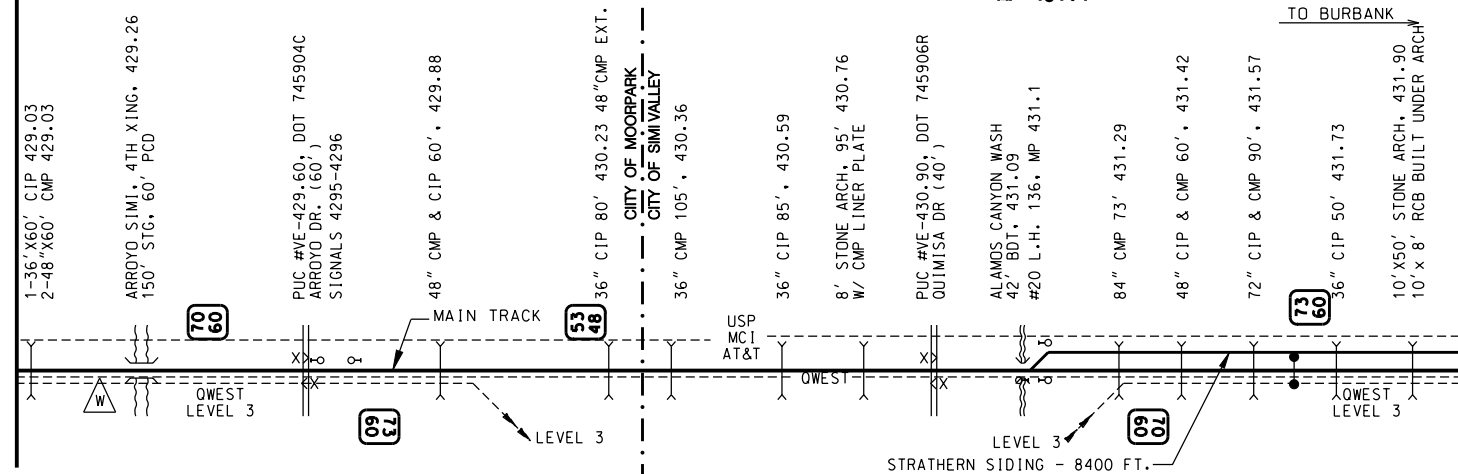

MILES 429 430 431 432

RAIL WT.	136				136				
RAIL YR.	06 PAN	83	SH86 R-52	04	06 PAN	06 PAN	92	03	
TIES	00	98 C FASTCLIP			00		00 NORFAST	00 PAN	00 NORFAST
BALLAST									

RAIL WT.	136	
RAIL YR.	SH03	R84
TIES	91	
BALLAST		

SH86 R51-55



MILES 432 433 434 435

SPEED	70#60		73# 60		79-60	
CONTROL	CTC					
HORIZONTAL ALIGNMENT MAIN TRACK	211 02° 30' 00" 400' 1360' 5.00"	212 02° 00' 00" 380' 1050' 5.00"	213 02° 00' 00" 360' 300' 4.00"	214 02° 00' 00" 360' 300' 4.00"		
VERTICAL ALIGNMENT	.91	.96	1.0	.97	.93	.97

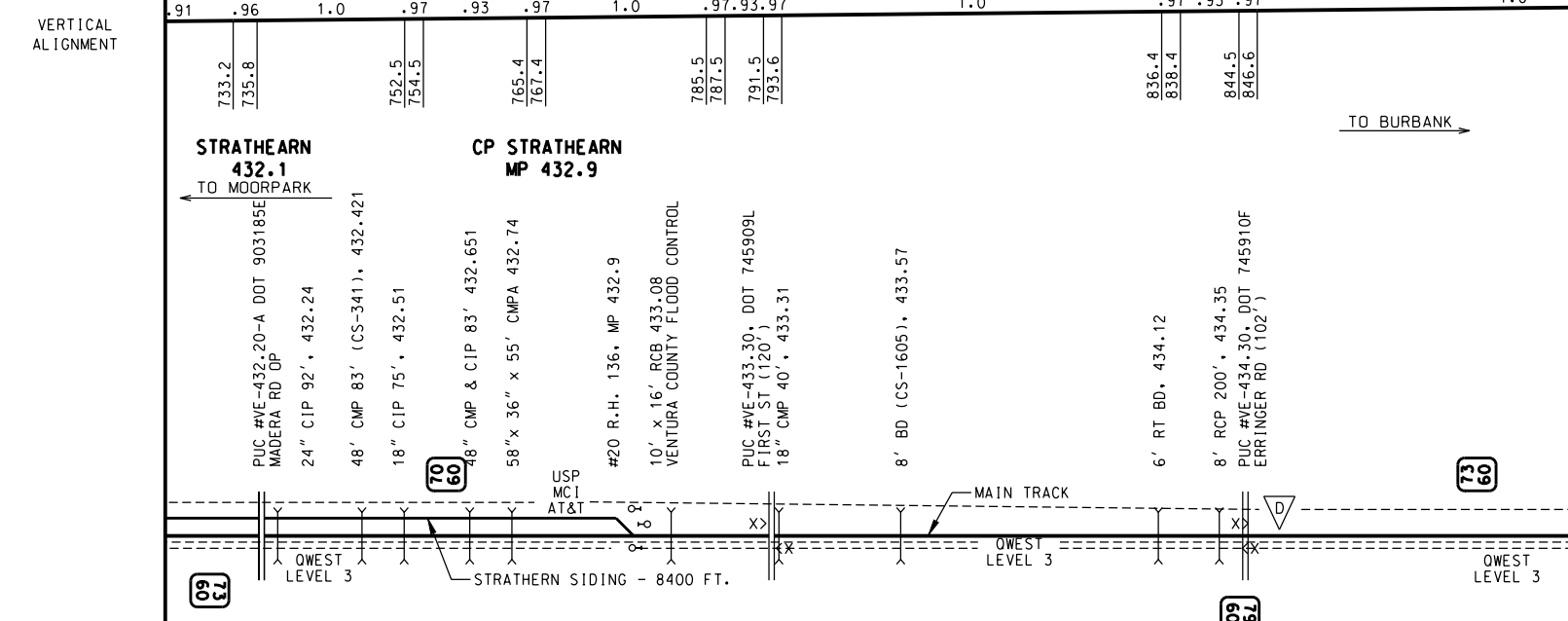

MILES 432 433 434 435

RAIL WT.	136		132		136		132	
RAIL YR.	03		92 SH84		07 SH84 R51-55		84 SH84 R51-55	
TIES	NF	OO PAN	OO NORFAST	OO PAN	07	OO		
BALLAST								

RAIL WT.	136
RAIL YR.	SH03 R84
TIES	91
BALLAST	



MILES 435 436 437 438

SPEED	79-60		60#-40	
CONTROL	CTC			
HORIZONTAL ALIGNMENT	MAIN TRACK			
CURVE NUMBER				215
DEGREE				03° 00' 00"
LENGTH SPIRAL				400'
LENGTH CURVE				800'
SUPERELEVATION				3.75"

VERTICAL ALIGNMENT

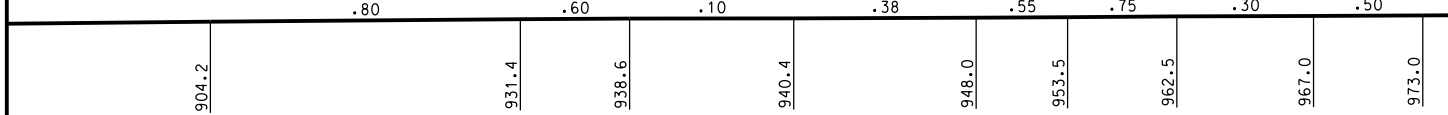

← TO MOORPARK

→ TO BURBANK

**PASSENGER STATION
SIMI VALLEY
437.9**

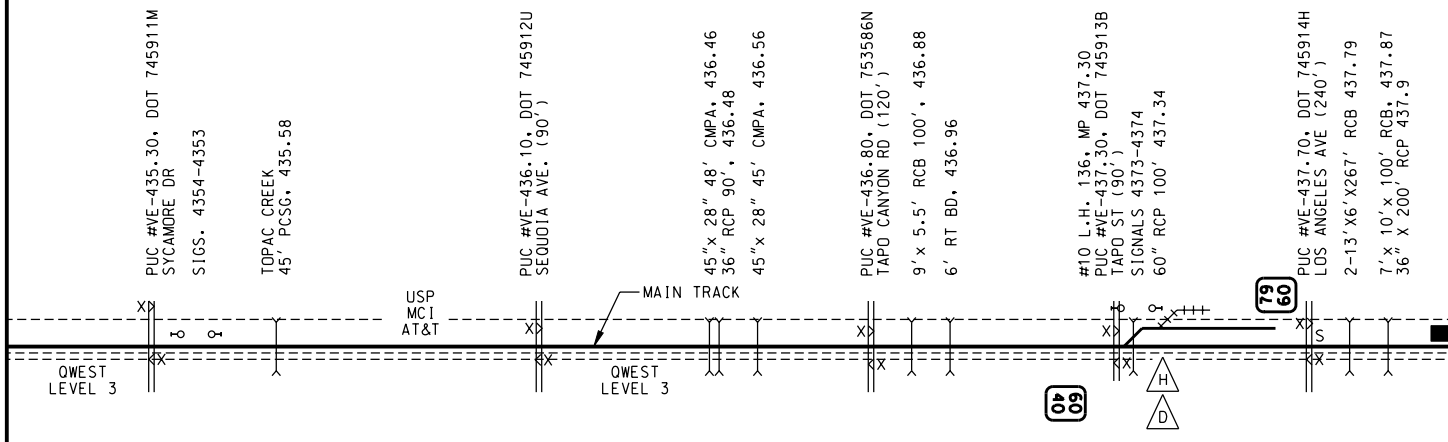

MILES 435 436 437 438

MAIN TRACK #1	RAIL WT.	132	136	136	84	97	84
	RAIL YR.		06 PAN				98
	TIES	00	98		05		
	BALLAST					97	C-FAST

06 NORFAST — 06 PAN

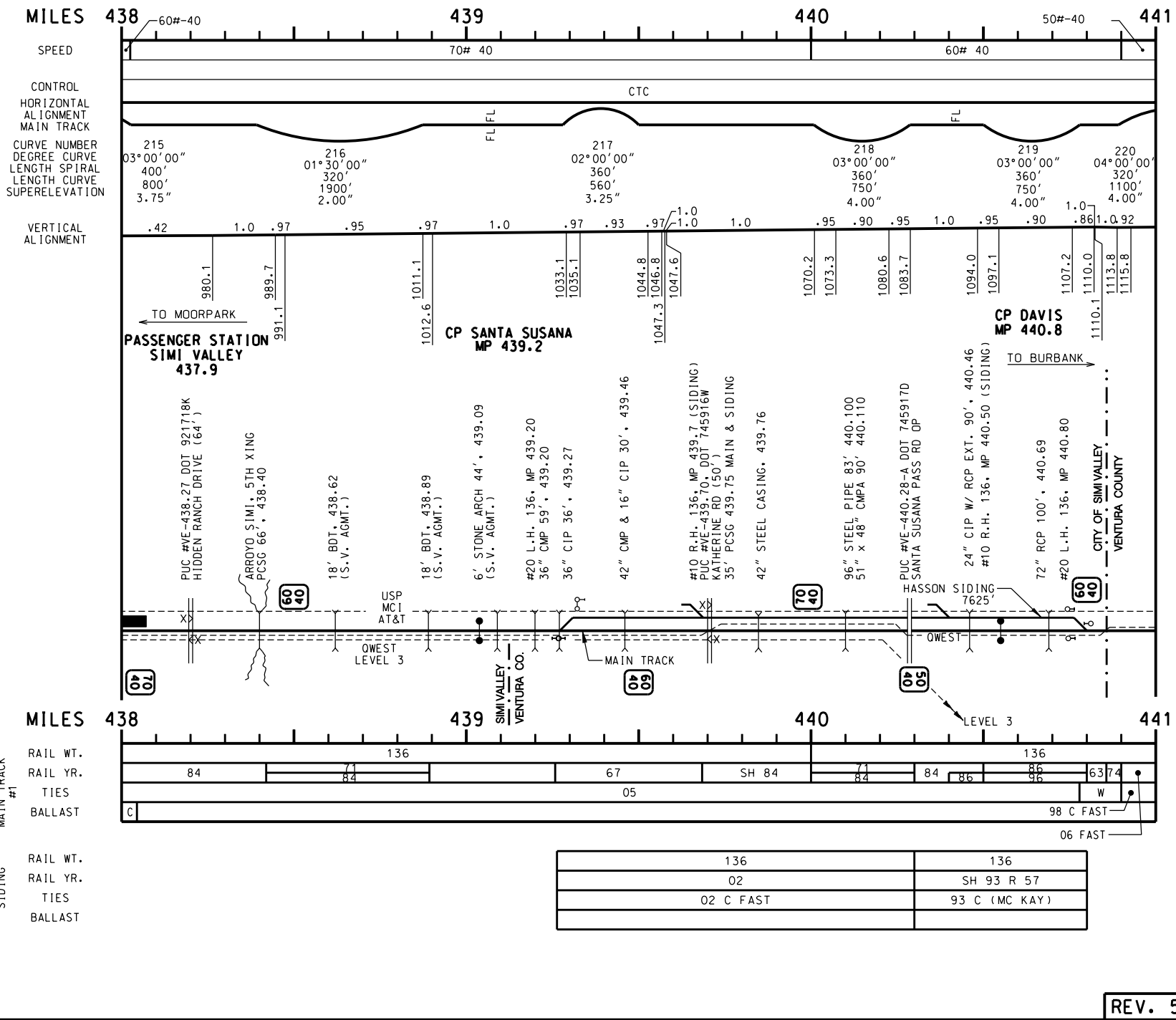

SIDING
MAIN TRACK #1

MILES	438	439	440	441
RAIL WT.	136		136	
RAIL YR.	84	84	84	86
TIES	05		W	
BALLAST	C		98 C FAST	
RAIL WT.	136		136	
RAIL YR.	02		SH 93 R 57	
TIES	02 C FAST		93 C (MC KAY)	
BALLAST	C		06 FAST	



MILES 441 442 443 444

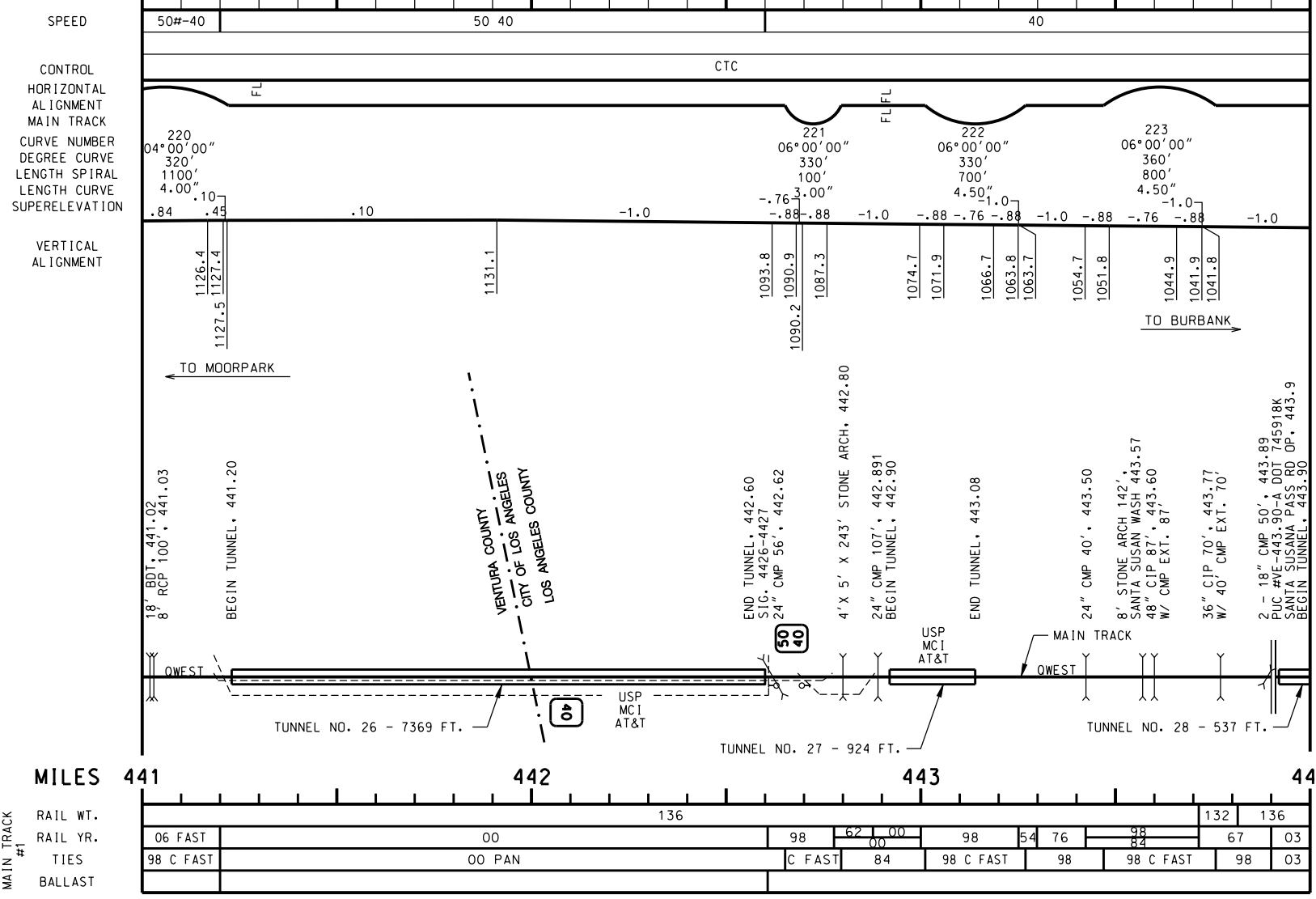



MILES 444 445 446 447

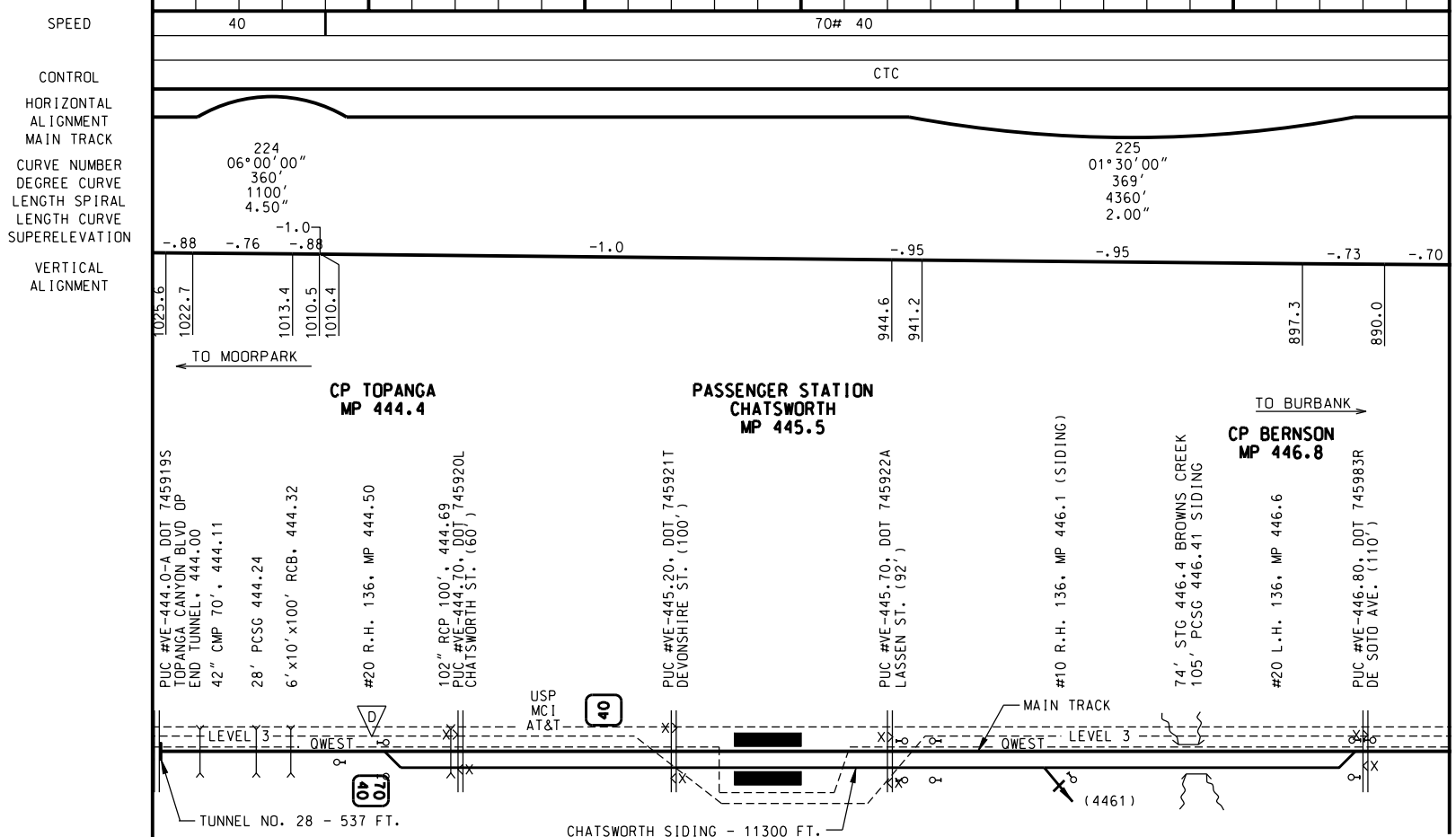

MILES 444 445 446 447

RAIL WT.	02	98	84	84	84	73	94	84
RAIL YR.	04	84	84	84	84	73	94	SH 72
TIES	02	98 C FAST	98	98	98	05	94	SH 72
BALLAST								

RAIL WT.	136	132/136
RAIL YR.	02	SH 94 R 52-54
TIES	02 C FAST	94 CONC (MC KAY)
BALLAST		



MILES 447 448 449 450

SPEED	70-40			
CONTROL	CTC			
HORIZONTAL ALIGNMENT	NO CURVES			
MAIN TRACK				
CURVE NUMBER				
DEGREE				
CURVE				
LENGTH				
SPIRAL				
LENGTH				
CURVE				
SUPERELEVATION				
VERTICAL ALIGNMENT	-0.75	-0.90	-0.70	-0.10 0.0

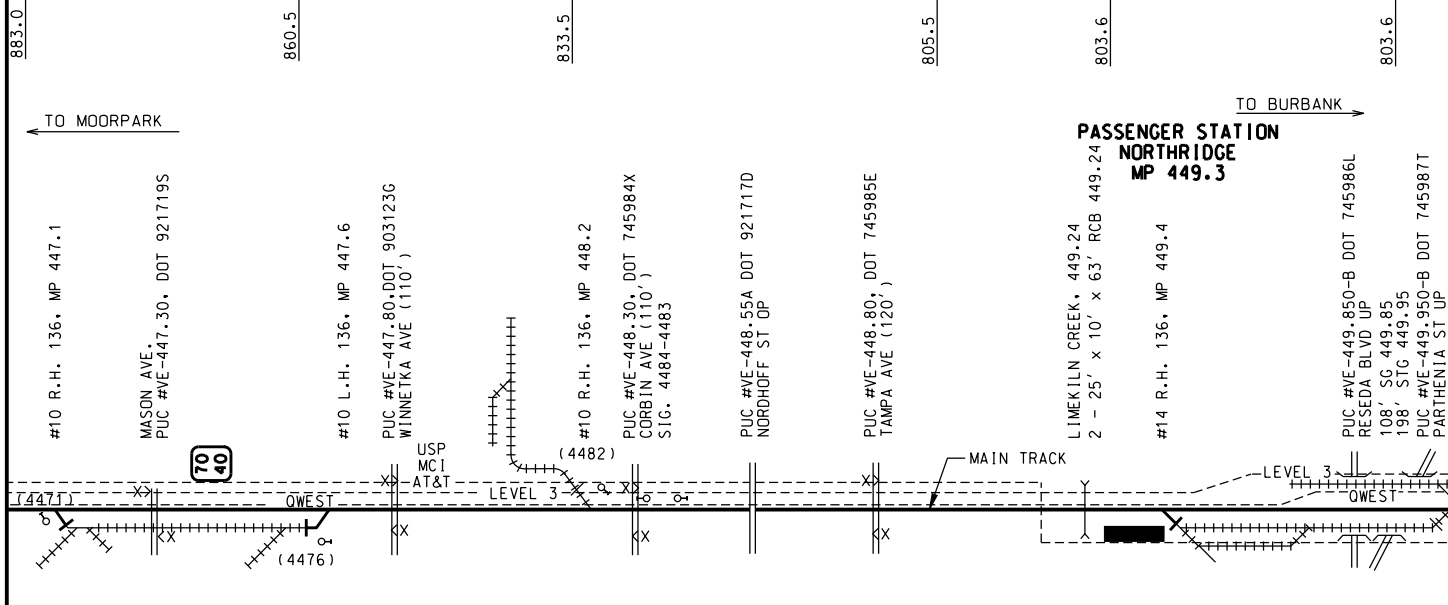

MILES 447 448 449 450

RAIL WT.	136				136			
RAIL YR.	84	84	84	84	84	84	84	84
TIES	05							
BALLAST	05							

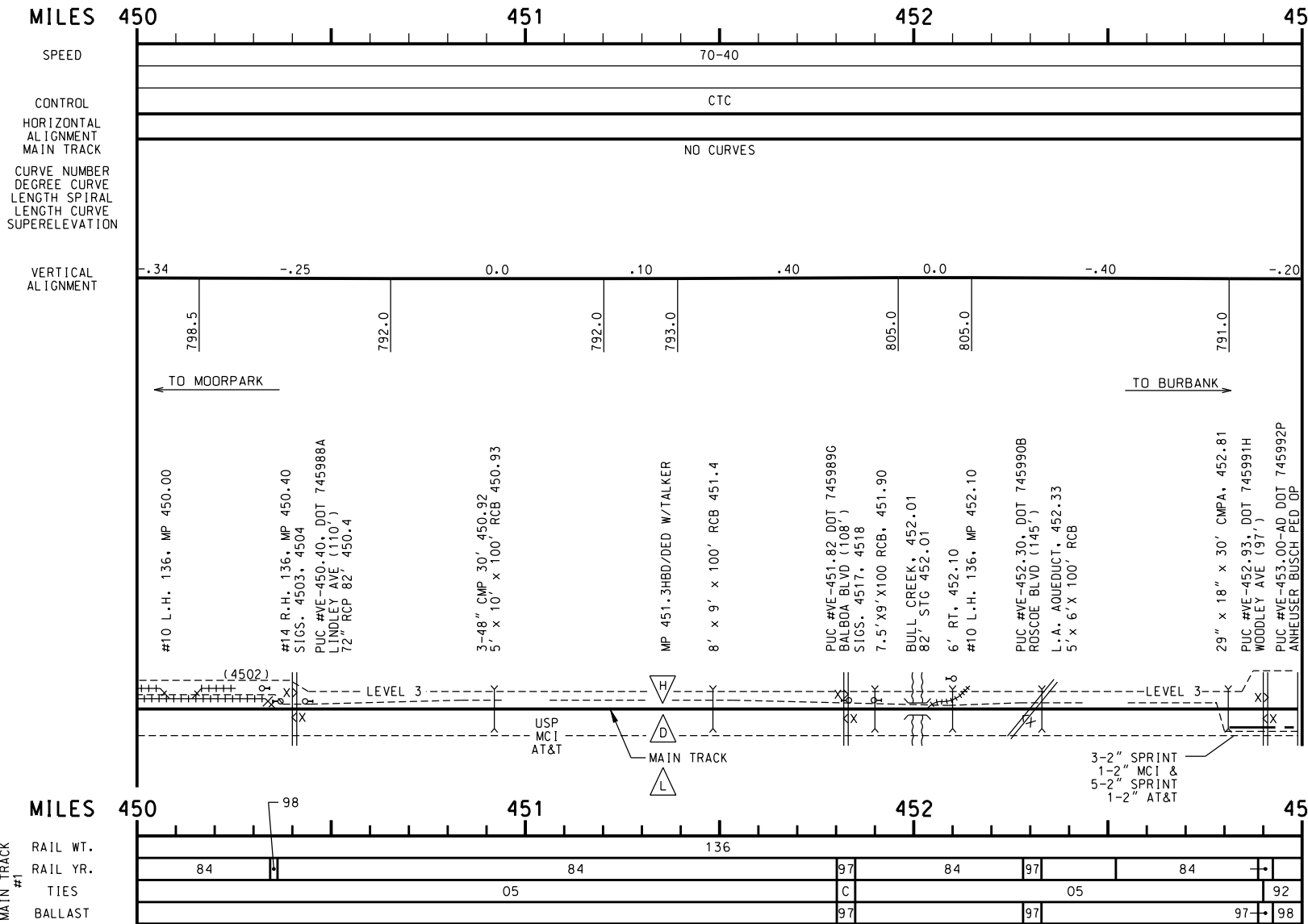



MILES 456 457 458 459

SPEED	79-40												70-40																									
CONTROL	2MT-CTC																																					
HORIZONTAL ALIGNMENT MAIN TRACK																																						
CURVE NUMBER	116	117	118	119	120	121	122	123	124	125	126																											
DEGREE CURVE	00°30'00"	00°03'43"	00°06'57"	00°04'13"	00°04'13"	00°04'13"	00°04'13"	00°03'32"	00°03'32"	00°03'37"	00°03'37"																											
LENGTH SPIRAL	158.76' 3/4	400'	122.93'	200'	200'	200'	200'	0"	200'	200'	199.94'																											
LENGTH CURVE																																						
SUPERELEVATION		83	83																																			
VERTICAL ALIGNMENT	<table border="1"> <tr> <td>456.0</td><td>456.5</td><td>457.0</td><td>457.5</td><td>458.0</td><td>458.5</td><td>459.0</td> </tr> <tr> <td>-0.40</td><td>0.0</td><td>-0.50</td><td>0.0</td><td>-0.40</td><td>-0.20</td><td></td> </tr> </table>																								456.0	456.5	457.0	457.5	458.0	458.5	459.0	-0.40	0.0	-0.50	0.0	-0.40	-0.20	
456.0	456.5	457.0	457.5	458.0	458.5	459.0																																
-0.40	0.0	-0.50	0.0	-0.40	-0.20																																	

CP WOODMAN 456.1

NOTE:
CURVES 116 THRU 126 ARE FOR TRACK #1.
CURVE 116 IS FOR TRACK #2.

TO BURBANK →

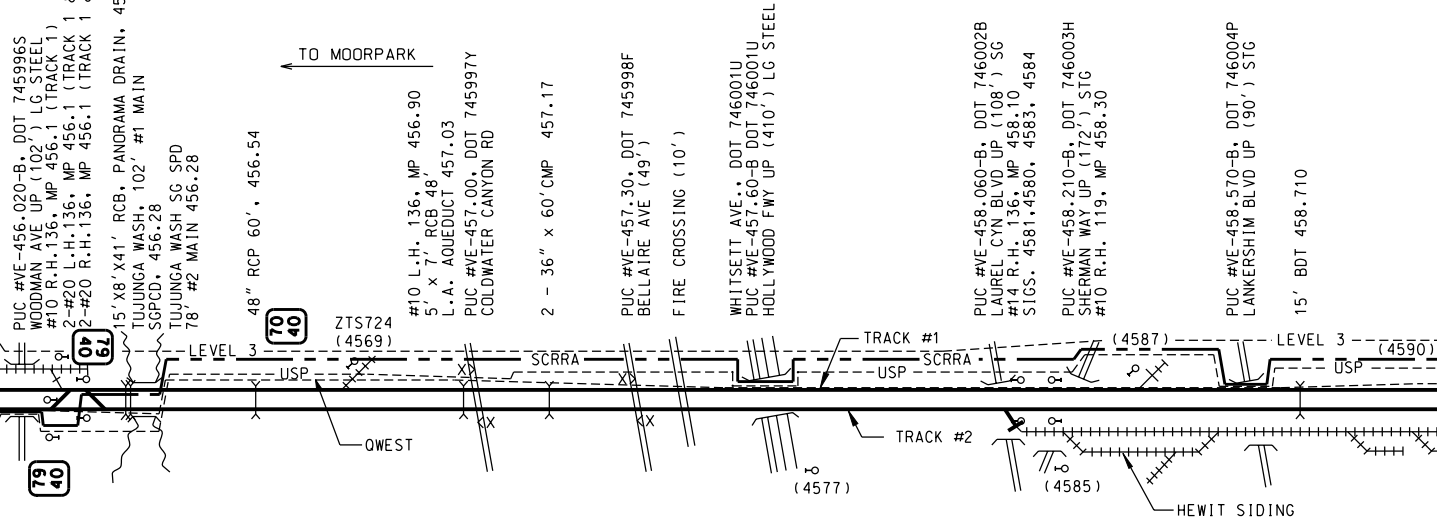

MILES 456 457 458 459

MAIN TRACK #1	RAIL WT.	136											
	RAIL YR.	92											
	TIES	05	92										
	BALLAST	CR ROCK											
MAIN TRACK #2	RAIL WT.	136	119	136	119	136	119	136	119	136	119	136	
	RAIL YR.	62	92	62	92	62	92	62	63	62	SH 74		
	TIES	84	05										
	BALLAST	92 CR ROCK	98 CR ROCK	92 CR ROCK	98 CR ROCK	92 CR ROCK	98 CR ROCK	92 CR ROCK	98 CR ROCK				

98 CR ROCK



MILES	459	460	461	462
SPEED	79-40			
CONTROL	70-40			
HORIZONTAL ALIGNMENT	2MT-CTC			
MAIN TRACK	<p>127 00°01'12" 0' 69.59' 0"</p>			
CURVE NUMBER				
DEGREE CURVE				
LENGTH SPIRAL				
LENGTH CURVE				
SUPERELEVATION				

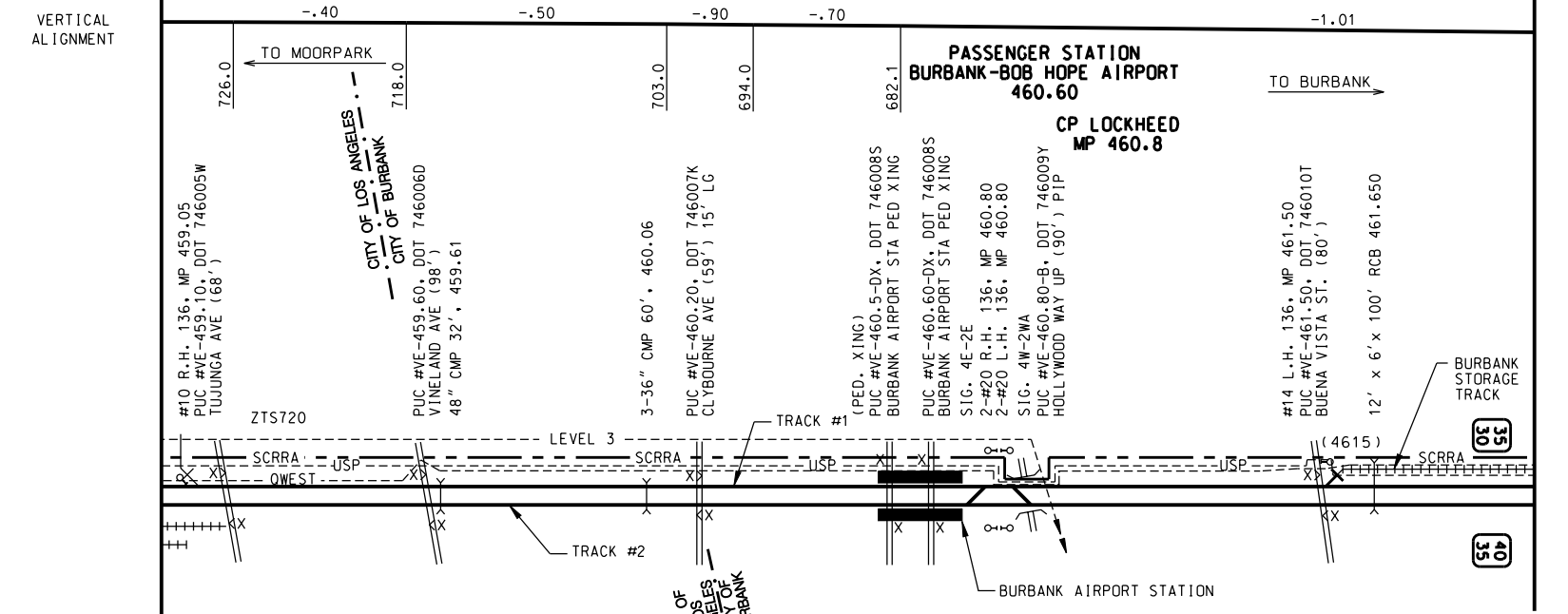

MILES	459	460	461	462
RAIL WT.	136			
RAIL YR.	92			
TIES	92 WOOD			
BALLAST	CR ROCK			
RAIL WT.	136			
RAIL YR.	SH 74 92	SH 74 92	SH 74 92	SH 74 R63-64 98
TIES	05			
BALLAST	92 82 CR ROCK	92 98 CR ROCK	92 98 CR ROCK	92 98 CR ROCK



MILES 462

SPEED	79-40	35# 30	MT-1
	70-40	40# 35	MT-2
CONTROL	2MT-CTC		
HORIZONTAL ALIGNMENT			
MAIN TRACK			
CURVE NUMBER	128	129	130
DEGREE CURVE	NO.1	NO.1	NO.1
LENGTH SPIRAL	00°10'15"	00°23'00"	06°15'00"
LENGTH CURVE	0'	0'	150-130'
SUPERELEVATION	201.56'	61'	650'
	0"	0"	2-1/4"
			342'
			190'
			3"
			0"

VERTICAL ALIGNMENT

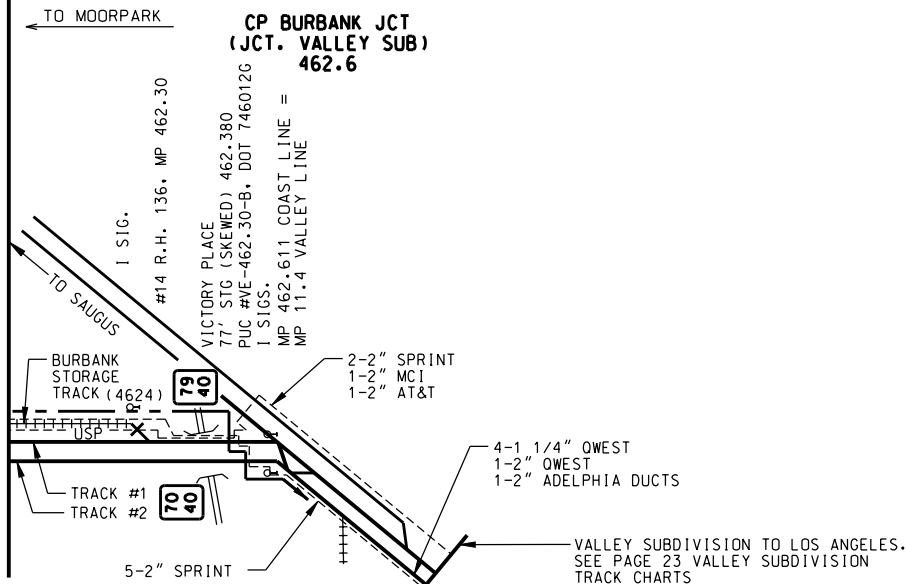

MILES 462

MAIN TRACK #1	RAIL WT.	136	
	RAIL YR.	92	
	TIES	92 WOOD	00 CONC FAST
	BALLAST	CR ROCK	
MAIN TRACK #2	RAIL WT.	136	
	RAIL YR.	SH 74	67
	TIES	05 98 WOOD	00 CONC FAST
	BALLAST	98 CR ROCK	