

Attachment 8

Oxygen System – Maintenance Documents

DATE 7/08/08
TIME 12:35:26

ABX AIR INC.
AIRCRAFT LOGS INQUIRY

PGM: PO71D
WKST: ABX16115A1
USER: MARFS

A/C: 799AX

A/C Hours Logged to Date: 06/21/2007

Hours: 45060:11

Cycles: 38064

Brake Cycles: 1434

F3=Exit

ABX AIR INC.

MECHANIC

W/O: 

CHECK SUPERNUMERARY\CREW OXYGEN SYSTEM (SF)



J/C: 

J/C CNTL: 0001023

A/C	TYPE/SERS	W/O	JOB CARD	TASK	PAGE
799AX	B767 281S	600271161	35-001-02	CHK31248	1/ 8

LABOR	EST.M/HRS	CARD ISS	REV DATE	W/O DATE	STATION	SITE	SDR
M	NO PRINT	A	08/21/2006	06/21/2007	ILN	H3	

AREA FUSELAGE

SEQ: 3349

SCHD 50 WORK

M/M REF

MM 012 15 08		MM 024 22 00		MM 035 00 00	
MP 035 00 00	A	MP 035 10 00	A	MP 035 11 00	A
MP 035 11 00	C	MP 035 11 00	5A	MP 035 11 00	5B

ZONE 10/113 20/212

ACCESS 119AL

WARNING: DO NOT WORK ON THE PRESSURIZED OXYGEN SYSTEM WHEN THERE IS OIL, GREASE, FLAMMABLE SOLVENTS, DUST, LINT, METAL FILINGS, OR OTHER COMBUSTIBLE MATERIALS IN THE AREA. THESE MATERIALS CAN CAUSE A FIRE OR AN EXPLOSION WHEN THEY ARE NEAR PRESSURIZED OXYGEN.

WARNING: OBEY THE DATA IN THE CREW OXYGEN SYSTEM-MAINTENANCE PRACTICES PROCEDURES. IF YOU DO NOT OBEY THIS DATA, A FIRE OR EXPLOSION CAN EASILY OCCUR. (AMM 35-00-00/912).

1. Service 2 each crew/supernumerary oxygen bottle pressure, 1750 psi minimum.

A. Remove crew/supernumerary oxygen bottles (AMM 12-15-08, AMM 35-00-00).

Date 7-16-07 Emp #  Mech:  XXX

B. Check the hydrostatic test placards for date of expiration.

(1) If a bottle has less than sixty (60) days until expiration date, replace the bottle. If there is not an adequate supply of bottles in stock and time remains on the bottle, make Log Book entry with expiration date, place on Deferred Item and notify Maintenance Control.

C. Service both oxygen bottles per AMM 12-15-08/603.

Date 7-16-07 Emp #  Mech:  XXX

***** FOR INTERNAL USE ONLY *****

START

DEFER

QUIT

JOIN

POUIT

END



ABX AIR INC.

W/O: 

MECHANIC

CHECK SUPERNUMERARY\CREW OXYGEN SYSTEM (SF)



J/C: 

J/C CNTL: 0001023

A/C 799AX	TYPE/SERS B767 281S	W/O 600271161	JOB CARD 35-001-02	TASK CHK31248	PAGE 2/ 8
LABOR M	EST.M/HRS NO PRINT	CARD ISS A	REV DATE 08/21/2006	W/O DATE 06/21/2007	STATION ILN
AREA FUSELAGE SCHD 50	WORK				SEQ: 3350

D. Provide OK to reinstall oxygen bottles.

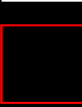

(1) Ensure area is clean and free of debris.

Date 7-16-07 Emp #  Insp: XXX 

WARNING: OBEY THE DATA IN THE CREW OXYGEN SYSTEM-MAINTENANCE PRACTICES PROCEDURES.
IF YOU DO NOT OBEY THIS DATA, A FIRE OR EXPLOSION CAN EASILY OCCUR. (AMM
35-00-00/912).

D. Install crew\supernumerary oxygen bottles (AMM 12-15-08, AMM 35-00-00).

Date 7-16-07 Emp #  Mech:  XXX 

Date 7-16-07 Emp #  Insp: XXX 

E. Compare Crew\supernumerary OXYGEN cylinder pressure gauges with flight deck
indication. (Should agree within 50 PSI).

Date 7-16-07 Emp #  Mech:  XXX 

2. Check the crew\supernumerary oxygen discharge indicator disc for presence.

NOTE: Green disc is located on forward right of fuselage, (exterior).

Date 7-16-07 Emp #  Mech:  XXX 

3. Check Portable oxygen bottles (2 ea. installed in galley and near weight and
balance computer).

A. Check condition/security and hydrostatic test/inspection due dates.

(1) FULL 1850 (+/-50) PSI; MIN. 1400 PSI

***** FOR INTERNAL USE ONLY *****

START

DEFER

QUIT

JOIN

POUIT

END



ABX AIR INC.

MECHANIC

W/O: 

CHECK SUPERNUMERARY\CREW OXYGEN SYSTEM (SF)



J/C: 

J/C CNTL: 0001023

A/C	TYPE/SERS	W/O	JOB CARD	TASK	PAGE
799AX	B767 281S	600271161	35-001-02	CHK31248	3/ 8

LABOR	EST.M/HRS	CARD	ISS	REV DATE	W/O DATE	STATION	SITE	SDR
M	NO PRINT	A		08/21/2006	06/21/2007	ILN	H3	
AREA FUSELAGE							SEQ: 3351	
SCHD 50 WORK								

NOTE: Check the hydrostatic test placard for date of expiration. If there are less than sixty (60) days until the expiration date, replace the bottle.

NOTE: Depending on aircraft configuration, one of the O2 bottles may be located to the right of the main entry door near galley.

Date 7-16-07 Emp #  Mech:  XXX

4. Check 2 ea. Crew\supernumerary Oxygen Bottle Pressure - 1750 psi MINIMUM, (ABX Diagram A36709).

(a) Compare Crew\supernumerary OXYGEN cylinder pressure gauges with flight deck indication (Should agree within 50 PSI).

(b) Check the hydrostatic test placards for date of expiration. If a

(1) If a bottle has less than sixty (60) days until expiration date, replace the bottle. If there is not an adequate supply of bottles in stock and time remains on the bottle, make Log Book entry with expiration date, place on Deferred Item and notify Maintenance Control.

NOTE: Cylinders are located in right tunnel area below and outboard of cockpit.

Date 7-16-07 Emp #  Mech:  XXX

5. Check Crew\supernumerary Oxygen System Pressure Indication Test.

CAUTION: DO NOT USE GREASE OR OIL, OR A COMPOUND OR FLUID THAT CONTAINS HYDROCARBONS WHEN YOU DO THIS TEST. THESE PRODUCTS CAN IGNITE OR EXPLODE WHEN THEY MIX WITH OXYGEN.

NOTE: Complete masks with regulators and hose assemblies must be installed at all locations when you do the operational test.

***** FOR INTERNAL USE ONLY *****

START

DEFER

QUIT

JOIN

POUIT

END



ABX AIR INC.

MECHANIC

W/O: 

CHECK SUPERNUMERARY\CREW OXYGEN SYSTEM (SF)



J/C: 

J/C CNTL: 0001023

A/C	TYPE/SERS	W/O	JOB CARD	TASK	PAGE
799AX	B767 281S	600271161	35-001-02	CHK31248	4/ 8

LABOR	EST.M/HRS	CARD	ISS	REV	DATE	W/O	DATE	STATION	SITE	SDR
M	NO PRINT	A			08/21/2006		06/21/2007	ILN	H3	
AREA FUSELAGE									SEQ: 3352	
SCHED 50 WORK										

MCH INS

NOTE: Obey the safety precautions and general maintenance instructions for the oxygen system (AMM 35-00-00).

A. Supply electrical power (AMM 24-22-00).

B. Make sure this circuit breaker on the overhead circuit breaker panel, P11, is closed:

- (1) 11U29, OXYGEN PRESS #1
- (2) 11U28, OXYGEN PRESS #2

C. Make sure the six EICAS circuit breakers on the overhead circuit breaker panel, P11, are closed.

D. Put the EICAS COMPUTER select switch on the select panel for the EICAS display in the L position.

NOTE: The switch is on the forward aisle stand.

E. Make sure the difference between the oxygen pressure shown on the EICAS and on the #1 crew\supernumerary oxygen cylinder is less than 100 psi.

F. Press and hold the OXYGEN PRES IND SELT switch on the P5 panel.

G. Make sure the difference between the oxygen pressure shown on the EICAS and on the #2 crew\supernumerary oxygen cylinder is less than 100 psi.

H. Release the OXYGEN PRES IND SELT switch.

I. Put the select switch EICAS COMPUTER to the R position.

J. Make sure the difference between the oxygen pressure shown on the EICAS and on the #1 crew\supernumerary oxygen cylinder is less than 100 psi.

K. Press and hold the OXYGEN PRES IND SELT switch on the P5 panel.

***** FOR INTERNAL USE ONLY *****

START

DEFER

QUIT

JOIN

POUIT

END



ABX AIR INC.

W/O: 

MECHANIC

CHECK SUPERNUMERARY\CREW OXYGEN SYSTEM. (SF)



J/C: 

J/C CNTL: 0001023

A/C 799AX	TYPE/SERS B767 281S	W/O 600271161	JOB CARD 35-001-02	TASK CHK31248	PAGE 5/ 8
--------------	------------------------	------------------	-----------------------	------------------	--------------

LABOR M	EST.M/HRS NO PRINT	CARD ISS REV DATE A 08/21/2006	W/O DATE 06/21/2007	STATION ILN	SITE H3	SDR
AREA FUSELAGE SCHD 50 WORK					SEQ: 3353	

MCH INS

- L. Make sure the difference between the oxygen pressure shown on the EICAS and on the #2 crew\supernumerary oxygen cylinder is less than 100 psi.
- M. Release the OXYGEN PRES IND SELT switch.
- N. In-box check of crew oxygen system at Captain's station.
 - (1) Fully push RESET-TEST lever at captain's station to TEST. Do not release.
 - (2) Check that oxygen flow indicator blinks on, and then goes out.
 - (3) Move lever on audio-select panel to OXY and push PA switch.
 - (4) Push regulator TEST button for about one second and release. Check that oxygen flow indicator blinks on, and then goes out when TEST button is released.
 - (5) Press regulator TEST switch and hold.
 - (6) PRESS PTT switch on audio-select panel, and check that oxygen flow can be heard on the PA system.
 - (7) Squeeze oxygen mask harness inflation ears while mask is stowed in box. Check that flow indicator comes on (2 seconds maximum) while harness inflates, and then goes off. Release the inflation ears.
 - (8) Release RESET-TEST lever. Check that lever returns to closed position. A flow can be heard while the hose and tube in the box is being bled.
 - (9) Push the N-100 percent control lever on mask regulator to ensure that it operates.
 - (10) Reset N-100 percent control lever to 100 percent position.
 - (11) Return audio-select panel to NORMAL.

***** FOR INTERNAL USE ONLY *****

START

DEFER

QUIT

JOIN

POUIT

END



ABX AIR INC.

MECHANIC

W/O: 

CHECK SUPERNUMERARY\CREW OXYGEN SYSTEM (SF)



J/C: 

J/C CNTL: 0001023

A/C 799AX	TYPE/SERS B767 281S	W/O 600271161	JOB CARD 35-001-02	TASK CHK31248	PAGE 6/ 8
LABOR M	EST.M/HRS NO PRINT	CARD ISS REV DATE A 08/21/2006	W/O DATE 06/21/2007	STATION ILN	SITE H3
AREA FUSELAGE SCHD 50 WORK					SEQ: 3354

MCH INS

O. Repeat Step 5.H., in-box crew oxygen system test at all other flight crew and supernumerary stations.

P. Complete Test and Operational Check of the Crew Oxygen Mask/Regulator.

NOTE: This test confirms that there is sufficient pressure in the crew low line to properly inflate the crew oxygen mask harness.

(1) Turn off No. 1 oxygen bottle.

NOTE: The oxygen for this test should come from No. 2 bottle.

(2) Take mask/regulator out of stowage box.

(3) Hold mask. Depress harness inflation control. Do not release.

(4) Ensure that mask harness inflates rapidly

(5) Check that flow blinker turns yellow when button is depressed and turns black again indicating that pneumatic harness is free of leaks. Release inflation control.

(6) Raise mask/regulator unit and place it on head.

NOTE: The pneumatic harness fits all head sizes.

(7) Breath through mask/regulator unit with regulator turned to dilution, then to "100 percent" position. Check breathing in each position on flow blinker.

(8) With lever set to "100 percent" position, rotate the EMERGENCY control knob. After a few breaths, cancel the emergency pressure.

(9) Test oxygen mask microphone.

(a) Move lever on audio-select panel to OXY.

***** FOR INTERNAL USE ONLY *****

START

DEFER

QUIT

JOIN

POUIT

END



ABX AIR INC.

W/O: 

MECHANIC

CHECK SUPERNUMERARY\CREW OXYGEN SYSTEM. (SF)



J/C: 

J/C CNTL: 0001023

A/C 799AX	TYPE/SERS B767 281S	W/O 600271161	JOB CARD 35-001-02	TASK CHK31248	PAGE 7/ 8
LABOR M	EST.M/HRS NO PRINT	CARD ISS REV DATE A 08/21/2006	W/O DATE 06/21/2007	STATION ILN	SITE H3
AREA FUSELAGE SCHD 50 WORK					SEQ: 3355

MCH INS

- (b) Press PA or INT switch on audio-select panel and verify operation of mask microphone by listening over aircraft speakers.
- (c) Press PRESS TO TEST button and the PTT switch on the audio-select panel at the same time, and verify operation of mask microphone.
- (10) Store the oxygen mask/regulator unit box (AMM 35-11-51).
 - (a) Check that oxygen mask harness and oxygen supply hose are not twisted.
 - (b) Check that oxygen supply hose is secure in clips in bottom of mask stowage box.
 - (c) Grasp mask and coil hose into stowage box. Gently push hose down to obtain uniform coiling.
 - (e) When most of supply hose is coiled, grasp two large spacers at back of harness and gently pack them down onto coiled hose.
 - (f) Guide mask harness into stowage box while tilting mask fwd. Harness should rest on top of coiled supply hose. Check that tab on front of mask rests on horizontal plastic ledge inside stowage box.
 - (g) Check that the first two spacers of harness are resting on top of mask face piece. Check that harness will not interfere with on/off valve or flow blinker when stowage lids are closed. Place supply hose in far enough so that hose disconnects are not in contact with mask face seal.
 - (h) Check that dilution control is 100% and safety pressure is on normal.
 - (i) Close left lid of stowage box.
 - (j) Set reset lever on left lid and check that flag disappears.

***** FOR INTERNAL USE ONLY *****

START

DEFER

QUIT

JOIN

POUIT

END



ABX AIR INC.

W/O: 

MECHANIC

CHECK SUPERNUMERARY\CREW OXYGEN SYSTEM. (SF)



J/C: 

J/C CNTL: 0001023

A/C 799AX	TYPE/SERS B767 281S	W/O 600271161	JOB CARD 35-001-02	TASK CHK31248	PAGE 8/ 8
LABOR M	EST.M/HRS NO PRINT	CARD ISS REV DATE A 08/21/2006	W/O DATE 06/21/2007	STATION ILN	SITE H3
AREA FUSELAGE SCHD 50 WORK					SEQ: 3356

MCH INS

(k) Engage pin on left lid in hole of left side of mask regulator.

(l) Close right lid of stowage box.

(11) Turn on the No. 1 oxygen bottle.

Q. Repeat Step 5.P, Test and Operational Check of the Crew Oxygen Mask/Regulator for supernumerary stations, using #1 bottle.

Date 7-16-07 Emp #  Mech:  XXX

6. Put the Airplane Back to its Usual Condition

(1) Remove the electrical power if it is not necessary (AMM 24-22-00).

7. Ensure all job card sign off's are completed.

Date 7-16-7 Emp #  Mech:  XXX

***** FOR INTERNAL USE ONLY *****

START

DEFER

QUIT

JOIN

POUIT

END



ABX AIR INC.

Predraw

W/O: 

MECHANIC

REPLACE CREW OXYGEN MASK/REGULATORS (SF)



J/C: 

J/C CNTL: 0001024

A/C	TYPE/SERS	W/O	JOB CARD	TASK	PAGE
799AX	B767 281S	600271161	35-014-02	CHK31248	1/ 4

LABOR	EST.M/HRS	CARD ISS	REV DATE	W/O DATE	STATION	SITE	SDR
M	NO PRINT	\$	03/29/2004	06/21/2007	ILN	H3	

AREA CREW CABIN
SCHD 50 WORK

SEQ: 3357

M/M REF
MP 035 11 00 B

ZONE 20/211 20/212

ACCESS

MCH INS

1. Remove the Crew Oxygen Mask/Regulators.

A. Remove Captain's oxygen mask/regulator in accordance with AMM 35-11-51.

Date 7-16-07 Emp # 

Mech:  XXX

B. Remove FO's oxygen mask/regulator in accordance with AMM 35-11-51.

Date 7-16-07 Emp # 

Mech:  XXX

C. Remove Observer 1 oxygen mask/regulator in accordance with AMM 35-11-51.

Date 7-16-07 Emp # 

Mech:  XXX

D. Remove Observer 2 oxygen mask/regulator in accordance with AMM 35-11-51.

Date 7-16-07 Emp # 

Mech:  XXX

2. Remove the Supernumerary Oxygen Mask/Regulators.

A. Remove Supernumerary 1 oxygen mask/regulator in accordance with AMM 35-11-51.

Date 7-16-07 Emp # 

Mech:  XXX

B. Remove Supernumerary 2 oxygen mask/regulator in accordance with AMM 35-11-51.

Date 7-16-07 Emp # 

Mech:  XXX

***** FOR INTERNAL USE ONLY *****

START

DEFER

QUIT

JOIN

POUIT

END



ABX AIR INC.

W/O:



MECHANIC

REPLACE CREW OXYGEN MASK/REGULATORS (SF)



J/C:



J/C CNTL: 0001024

A/C 799AX	TYPE/SERS B767 281S	W/O 600271161	JOB CARD 35-014-02	TASK CHK31248	PAGE 2/ 4
LABOR M	EST.M/HRS NO PRINT	CARD ISS REV DATE \$ 03/29/2004	W/O DATE 06/21/2007	STATION ILN	SITE H3
AREA CREW CABIN SCHED 50 WORK					SDR SEQ: 3358

- | | MCH | INS |
|--|-----|-----|
| C. Remove Supernumerary 3 oxygen mask/regulator in accordance with AMM 35-11-51.
Date <u>7-16-07</u> Emp # <u>[REDACTED]</u> Mech: <u>[REDACTED]</u> (XXX) | | |
| 3. Route the Crew and Supernumerary Oxygen Mask/Regulators to Stores.
Date <u>7-16-07</u> Emp # <u>[REDACTED]</u> Mech: <u>[REDACTED]</u> XXX | | |
| 4. Install Serviceable Crew Oxygen Mask/Regulators.
A. Install Captain's oxygen mask/regulator in accordance with AMM 35-11-51.
Date <u>7-16-07</u> Emp # <u>[REDACTED]</u> Mech: <u>[REDACTED]</u> (XXX)
B. Install FO's oxygen mask/regulator in accordance with AMM 35-11-51.
Date <u>7-16-07</u> Emp # <u>[REDACTED]</u> Mech: <u>[REDACTED]</u> XXX
C. Install Observer 1 oxygen mask/regulator in accordance with AMM 35-11-51.
Date <u>7-16-07</u> Emp # <u>[REDACTED]</u> Mech: <u>[REDACTED]</u> XXX
D. Install Observer 2 oxygen mask/regulator in accordance with AMM 35-11-51.
Date <u>7-16-07</u> Emp # <u>[REDACTED]</u> Mech: <u>[REDACTED]</u> XXX | | |
| 5. Install Serviceable Crew Oxygen Mask/Regulators.
A. Install Supernumerary 1 oxygen mask/regulator in accordance with AMM 35-11-51.
Date <u>7-16-07</u> Emp # <u>[REDACTED]</u> Mech: <u>[REDACTED]</u> XXX | | |

***** FOR INTERNAL USE ONLY *****

START

DEFER

QUIT

JOIN

POUIT

END



ABX AIR INC.

W/O:



MECHANIC

REPLACE CREW OXYGEN MASK/REGULATORS (SF)



J/C:



J/C CNTL: 0001024

A/C 799AX	TYPE/SERS B767 281S	W/O 600271161	JOB CARD 35-014-02	TASK CHK31248	PAGE 3/ 4
LABOR M	EST.M/HRS NO PRINT	CARD ISS REV DATE \$ 03/29/2004	W/O DATE 06/21/2007	STATION ILN	SITE H3
AREA CREW CABIN SCHED 50 WORK					SDR SEQ: 3359

B. Install Supernumerary 2 oxygen mask/regulator in accordance with AMM
35-11-51.

Date 7-16-07 Emp # [REDACTED] Mech: [REDACTED] XXX

C. Install Supernumerary 3 oxygen mask/regulator in accordance with AMM
35-11-51.

Date [REDACTED] 7-16-07 Emp # [REDACTED] Mech: [REDACTED] XXX

6. Ensure All Job Card Sign Off's Are Completed.

Date 7-16-7 Emp # [REDACTED] Mech: [REDACTED] XXX

***** FOR INTERNAL USE ONLY *****

START

DEFER

QUIT

JOIN

POUIT

END



ABX AIR INC.
PARTS/TOOLING REQUIREMENT

A/C	W/O	JOB CARD	PAGE	SEQ
799AX	600271161	35-014-02	4/ 4	3360

MASK ASSY, OXYGEN MC10-25-101	35 10 213	QTY	GRN
		6	

767
AIRCRAFT ILLUSTRATED
PARTS CATALOG

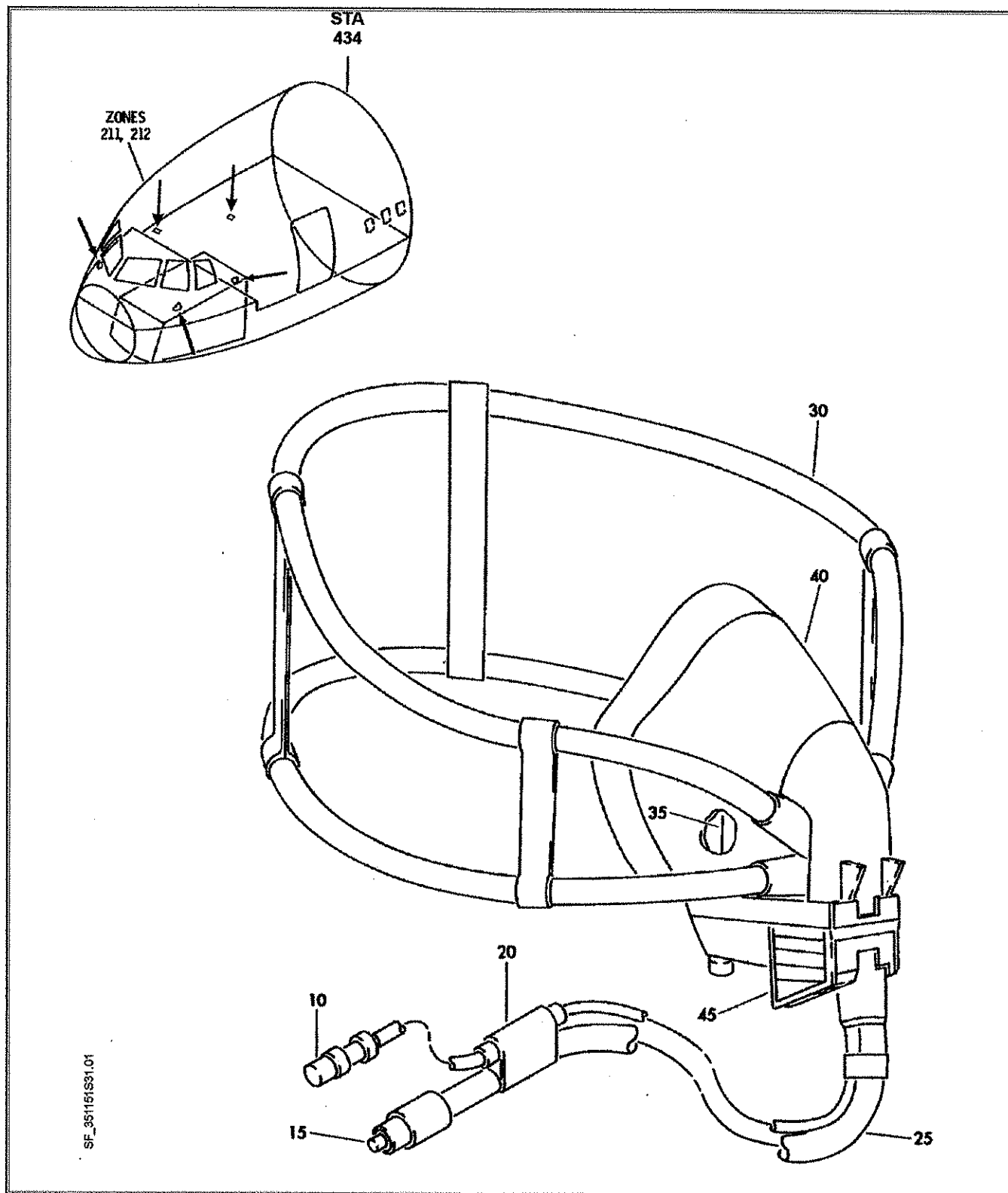

EFFECTIVITY: 016, 021-023, 025-201, 308

35-11-51-31
CONFIG -
Page 1
2004/04/23

This page must not be retained for reference

767

AIRCRAFT MAINTENANCE MANUAL

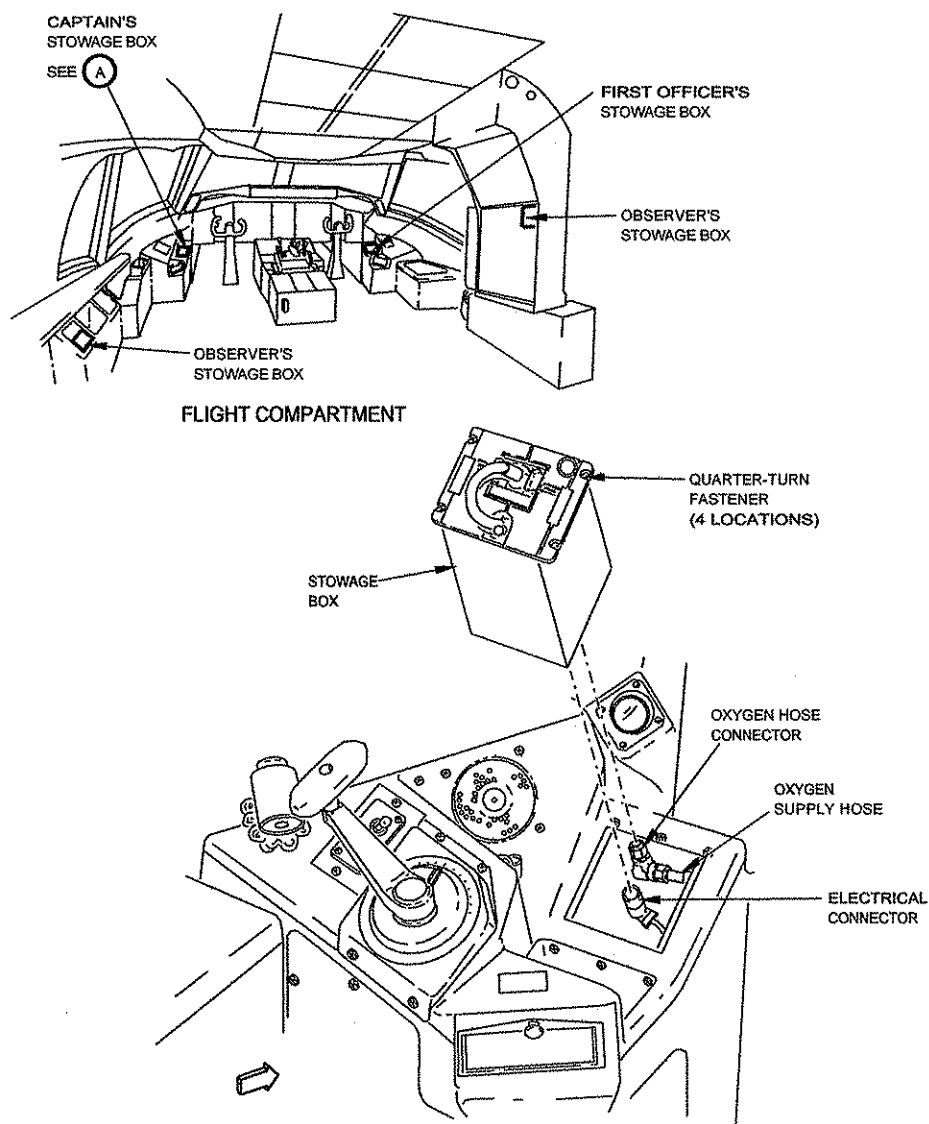

▷ 2ND OBSERVER STOWAGE BOX DOES NOT HAVE A MICROPHONE CONNECTOR

EFFECTIVITY: ALL

35-11-51-4
 CONFIG 10
 Page 1
 2006/04/22

This page must not be retained for reference

ATA 35
OXYGEN

Defect Log PMI 799AX JANUARY 2007 - JUNE 2008
ATA35 - OXYGEN

YRMO	A/C	LOGDAT	CHP	SEC	LOG_PAGE	STA	TYP	DESCRIPTION
						TRN		
07/01 07/01	799AX	01/04/2007	35	10	033822/47-002 033822/47-002	SFO SFO	M	#2 OXYGEN BOTTLE LOW PRESSURE 1290 PSI. SERVICED #2 BOTTLE TO 1500 IAW MM 12-15-08-3. NO LEAKS NOTED.
07/01 07/01	799AX	01/12/2007	35	10	034081/71-002 034081/71-002	BFI BFI	M	AIRCRAFT OXYGEN REQUIRES SERVICE SERVICED AIRCRAFT OXYGEN AS REQUIRED
07/01 07/01	799AX	01/24/2007	35	10	033850/01-001 033850/01-001	ILN ILN	M	O2 BOTTLE NEEDS CHANGED. REMOVED AND REPLACED TOP CREW O2 BOTTLE IAW 767 MM 35-10-00.
07/02 07/02	799AX	02/21/2007	35	10	034040/83-001 034040/83-001	BFI BFI	M	CREW O2 AT 1280 PSI. SERVICED CREW O2 TO 1800 PSI IAW B767MM 12-15-08, NO LEAKS NOTED.
07/03 07/03	799AX	03/10/2007	35	10	033931/25-002 033931/25-002	BFI BFI	M	CREW O2 BOTTLE #2 BELOW SVC CHK LIMITS. SERVICED BOTTLE #2 TO FULL IAW B767 M/M 12-15-08.
07/03 07/03 07/03	799AX	03/29/2007	35	10	034150/17-001 034150/17-001 034150/17-001	SFO SFO SFO	P	NOTE: O2 SYSTEM USED BY FLIGHT CREW NOTD BY MTC O2 PRESS WITHIN DISPATCH LIMITS 1690 PSI BOTTLE 1 1310 BOTTLE 2
07/03 07/03	799AX	03/31/2007	35	10	034150/23-001 034150/23-001	JFK JFK	P	NOTE O2 SYSTEM USED BY FLT CREW. NOTED O2 BOTTLE PRESS WITHIN LIMITS PER DAILY CHK B767-40.
07/04 07/04 07/04	799AX	04/28/2007	35	10	034351/89-002 034351/89-002 034351/89-002	IAH IAH IAH	M	CREW O2 UPPER BOTTLE AT 1100 PSI. SERVICED CREW O2 UPPER BOTTLE TO 1500 PSI IAW B767 AMM 12-15-08 NO LEAKS NOTED.
07/05 07/05	799AX	05/03/2007	35	10	034308/02-002 034308/02-002	ILN ILN	M	CREW O2 BOTTLE AT 1300 PSI. SERVICED CREW O2 BOTTLE TO 1800 PSI.
07/08 07/08	799AX	08/13/2007	35	10	034097/06-002 034097/06-002	SFO SFO	M	UPPER CREW O2 BOTTLE REQ SERVICE (1290 PSI) SERVICED UPPER CREW O2 BOTTLE TO 1650 PSI IAW B767 MM 12-15-08
07/08 07/08 07/08 07/08 07/08	799AX	08/14/2007	35	10	034097/06-001 034097/06-001 034097/06-001 034097/06-001 034097/06-001	JFK JFK JFK JFK JFK	P	35-11-01-02 ABNORMAL OXYGEN REGULATOR OPERATION OXYGEN FLOW INDICATOR (CATS EYE) DOES NOT COME INTO VIEW WHEN USING MASK. EXHALE FUNCTION SEEMS WRONG REPLACED MASK/REGULATOR ASSY WITH SERVICEABLE UNIT IAW 767 AMM 35-11-51-4 OPS CHECKS GOOD
07/08 07/08 07/08	799AX	08/14/2007	35	10	034097/06-002 034097/06-002 034097/06-002	JFK JFK JFK	M	SECOND OBSERVERS O2 MASK NOT WORKING PROPERLY DEFER #56574 DEFERRED 2ND OBSERVERS SEAT IAW 767 MEL 35-11-2-2 CAT D CODE 14

RRLIB/EJS_LOGBK1, EJS_LOGBK2, EJS_LOGBK3

Defect Log PMI 799AX JANUARY 2007 - JUNE 2008
ATA35 - OXYGEN

YRMO	A/C	LOGDAT	CHP	SEC	LOG_PAGE	STA	TYP	DESCRIPTION
						TRN		
07/08	799AX	08/14/2007	35	10	034097/06-002	JFK	M	MBCB 12/12/07 MUST BER REPAIRED REPLACED BY 12/12/07 PLACARDED
07/08	799AX	08/15/2007	35	10	034097/10-002	ILN	M	WORKING DI #56574 OBSERVERS O2 MASK
07/08					034097/10-002	ILN		CLEAR #56574 REMOVED & REPLACED OBSERVERS O2 REG BOX ASSY IAW B767 MM
07/08					034097/10-002	ILN		35-11-51-4. LK & OPS CK GOOD PLACARD REMOVED
07/08	799AX	08/23/2007	35	10	034097/27-002	JFK	M	UPPER O2 BOTTLE PRESSURE IS 1090. NEEDS TO BE SERVICED
07/08					034097/27-002	JFK		SERVICED BOTTLE TO 1560 PSI IAW ABX PROCESS STANDARDS MANUAL 900-9-10
07/09	799AX	09/02/2007	35	10	034293/50-002	SFO	M	UPPER CREW O2 BOTTLE REG SERVICE 1000 PSI.
07/09					034293/50-002	SFO		SERVICED UPPER CREW O2 BOTTLE TO 1600 PSI IAW B767 M/M 12-15-08.
07/09	799AX	09/03/2007	35	10	034293/51-002	SFO	M	CREW O2 BOTTLES TURNED "OFF"
07/09					034293/51-002	SFO		CREW O2 BOTTLES TURNED "ON" IAW SERVICE CHECK B767-2B
07/09	799AX	09/07/2007	35	10	034293/59-003	JFK	M	UPPER O2 BOTTLE PRESSURE LOW (1010 PSI)
07/09					034293/59-003	JFK		SERVICED. O2 CYLINDER IAW ABX PROCESS STANDARDS MANUAL 900-9-10 TO
07/09					034293/59-003	JFK		1500 PSI.
07/09	799AX	09/09/2007	35	10	034293/68-002	SFO	M	UPPER CREW O2 BOTTLE REQ SERVICING (1000 PSI)
07/09					034293/68-002	SFO		SERVICED UPPER CREW O2 BOTTLE TO 1550 PSI B767 MM 12-15-08
07/09	799AX	09/19/2007	35	10	034293/89-003	ILN	M	UPPER OXYGEN BOTTLE REQUIRES SERVICE
07/09					034293/89-003	ILN		SERVICED UPPER O2 BOTTLE AS REQD IAW B767 AMM 35-00
07/09	799AX	09/23/2007	35	10	034162/02-001	ILN	M	UPPER OXYGEN BOTTLE NEEDS TO BE SERVICED
07/09					034162/02-001	ILN		SERVICED BOTTLE FROM 950 TO 1600 PSI
07/09	799AX	09/27/2007	35	10	034162/15-002	BFI	M	COMPLY WITH A/N #799REL005-2007
07/09					034162/15-002	BFI		FIYBD CREW #2 BOTTLE TRANSDUCER REGULATOR LEAKING. REPLACED REQ. OPS
07/09					034162/15-002	BFI		AND LKS CKS GOOD PER B767 AMM 35-11-04 LEAK CHECKS ALL O2 REG. NO
07/09					034162/15-002	BFI		LEAKS FOUND SERVICED BOTTLE #2 1840 PSI PER B767 AMM 12-15-08 NO
07/09					034162/15-002	BFI		LEAKS FOUND
07/10	799AX	10/04/2007	35	10	034162/32-002	ILN	M	PASS OXY BOTTLE LOW (900 PSI)
07/10					034162/32-002	ILN		SERVICED O2 TO 1800PSI
07/10	799AX	10/27/2007	35	10	034584/45-002	ILN	M	CREW O2 READS 950 PSI
07/10					034584/45-002	ILN		SERVICED CREW O2 BOTTLE TO 1650 PSI AS REQUIRED. LEAK CHECKED O2
07/10					034584/45-002	ILN		BOTTLE NO LEAKS NOTED

RRLIB/EJS_LOGBK1, EJS_LOGBK2, EJS_LOGBK3

Defect Log PMI 799AX JANUARY 2007 - JUNE 2008
ATA35 - OXYGEN

YRMO	A/C	LOGDAT	CHP	SEC	LOG_PAGE	STA	TYP	DESCRIPTION
						TRN		
07/10	799AX	10/30/2007	35	10	034584/49-002	ANC	M	#2 O2 CYLINDER READS LOW. 1120 PSI
07/10					034584/49-002	ANC		REMOVED AND SERVICED #2 O2 CYLINDER TO 1750 PSI AS PER BOEING 767
07/10					034584/49-002	ANC		MM 12-15-00
07/11	799AX	11/02/2007	35	10	034527/56-002	ANC	M	UPPER CREW O2 BOTTLE READS 1160 PSI.
07/11					034527/56-002	ANC		SERVICED UPPER CREW O2 BOTTLE PER AMM 12-15-08. OPS CKS NORMAL
07/11					034527/56-002	ANC		OK FOR SERVICE BOTTLE READS 1690 PSI.
07/11	799AX	11/08/2007	35	10	034527/68-002	JFK	M	NO 2 O2 BOTTLE PRESS 900 PSI ON ARRIVAL.
07/11					034527/68-002	JFK		PERFORMANCE SYSTEM LEAK CHEKC PER AMM 35-11-00 AND FOUND R/H PAX
07/11					034527/68-002	JFK		SEAT O2 MARK QUICK DISCON LEAKING, RESEATED CONN. SERVICE
07/11					034527/68-002	JFK		BOTTLE TO 1650 PSI PRESS LEAK CHK OK.
07/11	799AX	11/11/2007	35	10	034527/78-002	SFO	M	UPPER CREW O2 BOTTLE REQ. SERVICING (1000 PSI)
07/11					034527/78-002	SFO		SERVICED UPPER CREW O2 BOTTLE TO 1450 PSI IAW B767 MM 12-15-08
07/11	799AX	11/15/2007	35	10	034527/90-001	ILN	M	#2 BOTTLE (OXYGEN) READS 840 PSI.
07/11					034527/90-001	ILN		SERVICED #2 OXYGEN BOTTLE TO 1610 PSI.
07/11	799AX	11/18/2007	35	10	034527/98-002	SFO	M	UPPER CREW O2 BOTTLE REQ. SERVICING (1100 PSI)
07/11					034527/98-002	SFO		UPPER CREW O2 BOTTLE SERVICED TO 1620 PSI IAW B767 MM 12-15-08
07/11	799AX	11/20/2007	35	10	034011/01-003	JFK	M	C/W A/N 799 REL 007-2007 (FREQ SERV OF O2 BOTTLES)
07/11					034011/01-003	JFK		PERFORMED LEAK CHECK PER AMM 35-11-00 FOUND PRIMARY OBSERVER'S QUICK
07/11					034011/01-003	JFK		DISCONNET LEAKING RESEATED, LEAK CHECK OK ACCOMPLISHED AN 799
07/11					034011/01-003	JFK		REL 007-2007
07/11	799AX	11/21/2007	35	10	034011/05-002	JFK	M	O2 BOTTLE #2 READS 1120PSI.
07/11					034011/05-002	JFK		VERIFIED DURING O2 SYSTEM LEAK CHECK PER AMM 35-11-00 THAT SUPER-
07/11					034011/05-002	JFK		NUMERARY CENTER SEAT O2 MASK CAUSING RAPID DROP IN PRESSURE WHEN
07/11					034011/05-002	JFK		CONNECTED. DISCONNECTED MASK AND SYSTEM PRESS WAS HOLDING NORMAL.
07/11					034011/05-002	JFK		RESEATED/RECONN CENTER SEAT MASK AGAIN AND NOW PRESS HOLDING NORMAL
07/11					034011/05-002	JFK		SERVICE #2 O2 BOTTLE TO 1600 PSI IAW AMM 12-15-08- PRESS & SEAL CK OK
07/11	799AX	11/22/2007	35	10	034011/09-002	JFK	M	DUE TO PREVIOUS HISTORY AND PER MAINT CONTROL REQUEST REMOVE & REPLACE
07/11					034011/09-002	JFK		CENTER PAX SEAT O2 MASK
07/11					034011/09-002	JFK		REMOVED & REPLACED SUPERNUMERARY CENTER SEAT O2 MASK/REGULATOR PER AMM
07/11					034011/09-002	JFK		35-11-57. PRESS, LEAK & OPS TEST OK
07/11	799AX	11/24/2007	35	10	034011/14-002	SFO	M	CREW O2 REQUIRES SERVICE.
07/11					034011/14-002	SFO		SERVICED CREW O2 PER 767 AMM 12-15-08-3 NO LEAKS NOTED.

RRLIB/EJS_LOGBK1, EJS_LOGBK2, EJS_LOGBK3

Defect Log PMI 799AX JANUARY 2007 - JUNE 2008
ATA35 - OXYGEN

YRMO	A/C	LOGDAT	CHP	SEC	LOG_PAGE	STA	TYP	DESCRIPTION
						TRN		
07/12 07/12	799AX	12/01/2007	35	10	034011/37-002 034011/37-002	ILN ILN	M	#2 CREW O2 BOTTLE LOW @ 870 PSI SERVICED #2 CREW O2 BOTTLE IAW B767 AMM 12-15-08
07/12 07/12	799AX	12/08/2007	35	10	033945/50-001 033945/50-001	ILN ILN	M	UPPER CREW O2 BOTTLE PRESSURE LOW AT 970 PSI. SERVICED UPPER CREW O2 BOTTLE IAW B767 AMM 36-11-00. LK CK GOOD.
07/12 07/12 07/12	799AX	12/18/2007	35	10	033945/75-002 033945/75-002 033945/75-002	ILN ILN ILN	M	UPPER O2 BOTTLE REQ'S SERVICE SERVICED THE UPPER OXYGEN BOTTLE TO WITHIN SERVICE CHECK LIMITS BOTTLE READS 1380
07/12 07/12	799AX	12/21/2007	35	10	033945/86-003 033945/86-003	JFK JFK	M	UPPER O2 BOTTLE LOW (850 PSI) SERVICED O2 BOTTLE I/A/W ABX PSM 9000-0-10 TO 1500 PSI.
08/01 08/01	799AX	01/08/2008	35	10	034885/72-002 034885/72-002	ILN ILN	P	PAX O2 PRESS LESS THAN 900. SERVICED O2 AS REQUIRED.
08/02 08/02 08/02 08/02 08/02 08/02	799AX	02/01/2008	35	10	034542/48-002 034542/48-002 034542/48-002 034542/48-003 034542/48-003 034542/48-003	ILN ILN ILN ILN ILN ILN	M	O2 BOTTLE #2 LOW PRESS @ 840 PSI. SERVICED O2 BOTTLE TO 1640 IAW B767 AMM 35-00 SEE ITEM 3 FOR LEAK CHECK. O2 BOTTLE #2 SERVICED FROM 840 PSI TO 1640 REQUEST LEAK CHECK. PERFORMED LEAK CHECK OF LINES AND AT BOTTLES. NO LEAKS NOTED O2 STILL READS SAME 1640.
08/02 08/02	799AX	02/05/2008	35	10	034472/04-002 034472/04-002	BFI BFI	M	UPPER O2 BOTTLE (CREW) BOLT STRIPPED REPLACED "T" BOLT
08/02 08/02	799AX	02/07/2008	35	10	034472/12-002 034472/12-002	SFO SFO	M	#2 CREW O2 BOTTLE LOW. SERVICED #2 CREW O2 BOTTLE TO 1860 PSI PER AMM 12-15-08.
08/02 08/02	799AX	02/13/2008	35	10	034472/32-001 034472/32-001	ILN ILN	M	UPPER CREW O2 BOTTLE REQS SERVICE. SERVICED UPPER CREW O2 BOTTLE TO 1580 PSI IAW B767 AMM.
08/02 08/02	799AX	02/15/2008	35	30	034472/37-001 034472/37-001	ILN ILN	M	PBE BAG HS LOST ITS SEAL AND IS SOFT. REMOVED & REPLACED PBE AS PER B767 AMM CHAPT 35.
08/02 08/02	799AX	02/16/2008	35	10	034472/41-001 034472/41-001	ILN ILN	M	PASS O2 1000 PSI. SERVICED PASS O2 BOTTLE TO 1610 PSI AS REQUIRED.
08/02 08/02 08/02	799AX	02/20/2008	35	10	034472/47-002 034472/47-002 034472/47-002	ANC ANC ANC	M	UPPER O2 BOTTLE READS 1200 PSI. SERVICED UPPER O2 BOTTLE TO 1700 PSI IAW B767 AMM CHAPTER 12. LEAK CHECK GOOD.

RRLIB/EJS_LOGBK1, EJS_LOGBK2, EJS_LOGBK3

Defect Log PMI 799AX JANUARY 2007 - JUNE 2008
ATA35 - OXYGEN

YRMO	A/C	LOGDAT	CHP	SEC	LOG_PAGE	STA	TYP	DESCRIPTION
						TRN		
08/02	799AX	02/22/2008	35	10	033947/52-002	ANC	M	UPPER O2 CYLINDER LOW PRESSURE AT 1100 PSI.
08/02					033947/52-002	ANC		SERVICED UPPER O2 CYLINDER AS PER BOEING 767 AMM REF 12-15-09.
08/02					033947/52-002	ANC		LEAK & OPS CHECK OK.
08/02	799AX	02/27/2008	35	10	033947/64-001	ILN	M	35 11 03 00 #2 O2 BOTTLE PRESSURE LOW
08/02					033947/64-001	ILN		SERVICED #2 O2 BOTTLE TO 1240 PSI IAW B767 AMM 12-15-08-3.
08/02	799AX	02/28/2008	35	10	033947/68-002	ILN	M	UPPER CREW O2 BOTTLE AT 1050PSI
08/02					033947/68-002	ILN		SERVICED UPPER CREW O2 BOTTLE TO 1700 PSI IAW 767 MM 35
08/03	799AX	03/03/2008	35	10	033947/74-002	BFI	M	CREW O2 BOTTLE #2 900 PSI
08/03					033947/74-002	BFI		SERVICED TO 1800 PSI PER B767 AMM 35-00 NO LEAKS NOTED
08/03	799AX	03/22/2008	35	10	034671/19-002	ANC	M	UPPER O2 BOTTLE REQUIRES SERVICE
08/03					034671/19-002	ANC		SERVICED UPPER O2 BOTTLE TO 1700 PSI IAW B767 AMM CHAPTER 12-15-08
08/03					034671/19-002	ANC		LEAK CHECK GOOD
08/03	799AX	03/27/2008	35	10	034671/29-002	ILN	M	#2 CREW O2 BOTTLE READS 1250 PSI
08/03					034671/29-002	ILN		SERVICED #2 CREW O2 BOTTLE TO 1500 PSI.
08/04	799AX	04/03/2008	35	10	034671/40-003	ANC	M	UPPER CREW O2 CYLINDER LOW, READS 1100 PSI
08/04					034671/40-003	ANC		SERVICED UPPER CREW O2 CYLINDER IAW BOEING 767 AMM REF 12-15-08.
08/04					034671/40-003	ANC		SERVICED TO 1600 PSI
08/04	799AX	04/05/2008	35	10	034671/44-002	ANC	M	CREW UPPER O2 CYLINDER LOW 1125 PSI.
08/04					034671/44-002	ANC		SERVICED UPPER CREW O2 CYLINDER IAW BOEING 767 AMM REF 12-15-08. OPS &
08/04					034671/44-002	ANC		LEAK CHECK OK SERVICED TO 1700 PSI.
08/04	799AX	04/09/2008	35	10	034977/01-003	ANC	M	UPPER CREW O2 CYLINDER PRESSURE BELOW MINIMUM PRESSURE AT 1150 PSI.
08/04					034977/01-003	ANC		SERVICED UPPER CREW O2 CYLINDER IAW BOEING 767 AMM REF 12-15-08. LEAK
08/04					034977/01-003	ANC		& OPS CHECK OK.
08/04	799AX	04/12/2008	35	10	034977/09-002	ANC	M	UPPER CREW O2 PRESSURE AT 1200 PSI.
08/04					034977/09-002	ANC		SERVICED UPPER CREW O2 CYLINDER AS PER BOEING 767 AMM REF 12-15-04.
08/04					034977/09-002	ANC		LEAK CHECKED LINES & CREW O2 MASKS. OPS CHECKS OK.
08/04					034977/09-002	ANC		SERVICED CYL TO PSI.
08/04					034977/10-002	ANC		REF: REL 003-2008 UPPER CREW O2 CYLINDER.
08/04					034977/10-002	ANC		LEAK CHECKED O2 LINES & B NUTS LOWER E4E. LEAK CHECKED CAPT & 1ST
08/04					034977/10-002	ANC		OFF O2 MASKS. LEAK CHECKS OK. C/W REL 003-2008.
08/04	799AX	04/22/2008	35	10	034977/28-003	ANC	M	UPPER O2 BOTTLE LOW PSI.

RRLIB/EJS_LOGBK1, EJS_LOGBK2, EJS_LOGBK3

Defect Log PMI 799AX JANUARY 2007 - JUNE 2008
ATA35 - OXYGEN

YRMO	A/C	LOGDAT	CHP	SEC	LOG_PAGE	STA	TYP	DESCRIPTION
						TRN		
08/04	799AX	04/22/2008	35	10	034977/28-003	ANC	M	SERVICED UPPER O2 BOTTLE TO 1750 PSI IAW B767 AMM CHAPTER 12.
08/04	799AX	04/29/2008	35	10	034977/40-003	ANC	M	UPPER O2 BOTTLE NEEDS SERVICED
08/04					034977/40-003	ANC		SERVICED UPPER O2 BOTTLE TO 1750 PSI IAW B767 AMM CHAPTER 12
08/05	799AX	05/07/2008	35	10	034906/56-001	ANC	M	UPPER & LOWER CREW O2 BOTTLES REQUIRE NORMAL SERVICING
08/05					034906/56-001	ANC		SERVICED UPPER & LOWER O2 CYLINDERS TO 1750 PSI IAW BOEING 767 AMM REF
08/05					034906/56-001	ANC		12-15-08 LEAK & OPS CHECKS OK
08/05	799AX	05/14/2008	35	10	034906/68-003	ANC	M	UPPER O2 BOTTLE REQUIRES SERVICING
08/05					034906/68-003	ANC		SERVICED UPPER O2 CYLINDER IAW BOEING 767 AMM REF 12-15-02 LEAK & OPS
08/05					034906/68-003	ANC		CHECKS OK
08/05	799AX	05/18/2008	35	10	034906/79-003	ILN	M	UPPER CREW O2 BOTTLE LOW
08/05					034906/79-003	ILN		SERVICED UPPER O2 BOTTLE (CREW) AS REQUIRED (READ 1100 PSI SERVICED
08/05					034906/79-003	ILN		TO 1700 PSI)
08/05	799AX	05/20/2008	35	30	034906/85-001	ILN	M	PBE VACUUM SEAL COMPRISED
08/05					034906/85-001	ILN		DEFR#60429 GMM CODE 27
08/05					034906/85-001	ILN		DEFERRED PER B767 -2A FOR TRACKING PER GMM 07.04 REPLACEMENT DUE IN 36
08/05					034906/85-001	ILN		HOURS PLACARD INSTALLED
08/05					034906/86-002	SFO		WORKING DI 60429 PBE VACUUM SEAL COMPROMISED.
08/05					034906/86-002	SFO		CLEAR DI 60429 R & R PBE PER MM 25-60-00. PLACARD REMOVED &
08/05					034906/86-002	SFO		MX CONTROL NOTIFIED.
08/06	799AX	06/10/2008	35	10	034946/37-002	ILN	M	PASS O2 BOTTLE REQ SERVICING
08/06					034946/37-002	ILN		SERVICED PASS O2 BOTTLE TO 1520 PSI. NO LEAKS NOTED PER B767 AMM
08/06					034946/37-002	ILN		CHAPT 35
08/06	799AX	06/25/2008	35	10	034887/71-002	BFI	M	CREW O2 BOTTLE #2 @ 1140 PSI.
08/06					034887/71-002	BFI		FOUND ADAPTOR FROM BOTTLE TO REGULATOR LOOSE @ REGULATOR. TIGHTENED
08/06					034887/71-002	BFI		FITTING AND SERVICED O2 BOTTLE TO 1700 PSI IAW B767 M/M 12-15-08. NO
08/06					034887/71-002	BFI		LEAKS NOTED.

* * * E N D O F R E P O R T * * *

RRLIB/EJS_LOGBK1, EJS_LOGBK2, EJS_LOGBK3

A/C	Service	Bottle Replacement	Total events	PAX	Upper	#2	Pass	Lower
✓ 739AX	5	21	26					
✓ 799AX	23	0	23	1	14	6	2	1
✓ 744AX	2	8	10					
✓ 797AX	8	1	9					
✓ 747AX	7	0	7					
✓ 742AX	1	5	6					
✓ 740AX	4	1	5					
✓ 748AX	4	0	4					
✓ 798AX	4	0	4					
✓ 746AX	3	0	3					
✓ 792AX	2	1	3					
✓ 743AX	1	0	1					
✓ 745AX	1	0	1					
✓ 749AX	0	0	0					
750AX	0	0	0					
752AX	0	0	0					
		Note for 799AX One disc. Serviced both Upper & lower bottle making the count 1 higher than total events						

SEL	A/C	A/N#	ATA	OPENED	CLOSED	OCUR
..	799AX	REL 001-2007	077 32	01/19/2007	01/29/2007	1
		SUMMARY: LT ENG VIB INDICATION				
..	799AX	REL 002-2007	029 23	02/15/2007	02/20/2007	
		SUMMARY: C ADP LOW PRESS.				
..	799AX	REL 003-2007	031 40	03/13/2007	03/19/2007	
		SUMMARY: RT EICAS COMPUTER.				
..	799AX	REL 004-2007	078 30	08/16/2007	08/28/2007	
		SUMMARY: RT T/R UNLOCK LIGHT.				
..	799AX	REL 005-2007	035 10	09/25/2007	09/27/2007	
		SUMMARY: FREQ SERV OF UPPER CREW 02.				
..	799AX	REL 006-2007	031 40	10/10/2007	10/22/2007	
		SUMMARY: EICAS STATUS MSG: EICAS DISAGREE.				
..	799AX	REL 007-2007	035 10	11/16/2007	11/29/2007	1
		SUMMARY: FREQ SERV OF UPPER & LOWER CREW 02.				
..	799AX	REL 008-2007	021 30	11/27/2007	11/29/2007	
		SUMMARY: CABIN ALT AUTO 1 & 2.				

F3=Exit

DATE 6/30/08
TIME 08:07:37

ABX AIR, INC.
ADVISORY NOTICE INQUIRY

PGM: XTR069
WKST: ABX15441A1
USER: MAEJS

SEL	A/C	A/N#	ATA	OPENED	CLOSED	OCUR
..	799AX	REL 001-2008	021 40	01/21/2008	01/25/2008	
		SUMMARY: SUPPLEMENTAL HEATER IN SUPERNUMERARY COMPT INOP.				
..	799AX	REL 002-2008	035 10	02/27/2008	03/06/2008	
		SUMMARY: FREQ SERV OF UPPER CREW 02 BOTTLE.				
..	799AX	REL 003-2008	035 10	04/11/2008	04/21/2008	1
		SUMMARY: FREQ SERV OF UPPER CREW 02 SYS.				
..	799AX	REL 004-2008	027 51	04/21/2008	04/30/2008	
		SUMMARY: T/E FLAP/SLAT DISAGREE MSG.				

F3=Exit

DATE 6/30/08
TIME 08:10:37

ABX AIR, INC.
ADVISORY NOTICE INQUIRY

PGM: XTR069
WKST: ABX16038B1
USER: MAMCH

A/N: 799AX REL 002-2008 Created: 02/27/2008 Updated:
By: MASMU By:
ATA CHP/SEC: 35 10 SUSAN UTLEY

Etops A/C: N
Generated by: 3 or more occurrences in 15 days
Summary: FREQ SERV OF UPPER CREW O2 BOTTLE.
Reason:

DISCREPANCIES INVOLVING FREQUENT SERVICING OF UPPER CREW O2 BOTTLE.

Recommendation:

Action Taken:

Log Page	Date C/W	Emp #	STA
33947 76	03/04/2008	XXXXXX	SFO

Action INTAIL PRESS BEFORE INSPEC. 1570 PSI. LEAK CK DOWNSTREAM B-NUT FITTING
ALONG O2 SUPPLY LINE THRU SUPERNUMERARY O2 MASK. FOUND B-NUT DONSTREAM
OF PRESS REG LEAKING. TIGHTENED LEAK CKS GOOD. FOUND LEAK ALONG THE
PRESS XDCR CYLINDER COUPLING. TIGHTENED LEAK CHS GOOD.

Closed: 03/06/2008 By: MCSEV STEVE E. VENESS
F3=Exit F6=Attachments F24=Print/Fax

DATE 6/30/08
TIME 08:10:49

ABX AIR, INC.
ADVISORY NOTICE INQUIRY

PGM: XTR069
WKST: ABX16038B1
USER: MAMCH

A/N: 799AX REL 003-2008 Created: 04/11/2008 Updated:
By: MASMU By:
ATA CHP/SEC: 35 10 SUSAN UTLEY

Etops A/C: N

Generated by: 3 or more occurrences in 15 days

Summary: FREQ SERV OF UPPER CREW 02 SYS.

Reason:

DISCREPANCIES INVOLVING PROBLEMS WITH FREQUENT SERVICING OF THE UPPER
CREW 02 SYSTEM. 2ND A.N. ISSUED IN THE PAST 60 DAYS.

Recommendation:

Action Taken:

Log Page	Date C/W	Emp #	STA
34977 100	04/12/2008	138770	ANC

Action LEAK CHECKED 02 LINES & B NUTS LOWER E&E . LEAK CHECKED CAPT AND
F/O 02 MASKS . LEAK CHECKS OK . <JCC>

Closed: 04/21/2008 By: MCSEV STEVE E. VENESS
F3=Exit F6=Attachments F24=Print/Fax

AIRCRAFT	CHP	SEC	Opn Date	TYPE	AHLINE DESCRIPTION	ACTION TAKEN		
			Cls Date	ADV		AALOG	AAPAGE	AASEQ
799AX	35	10	2007/09/25	REL	5	FREQ SERV OF UPPER CREW 02.		
			2007/09/27		34,162	15	1	
FOUND CREW #2 BOTTLE REGULATOR LEAKING ...						REPLACED	02	REGULATOR
					5			
IAW AMM 35-11-04.						34,162	15	2
					5			
INSTLD P/N 803127-01 S/N 4595						34,162	15	3
					5			
RMVD P/N 803127-01 S/N 5052						34,162	15	4
799AX	35	10	2007/11/16	REL	7	FREQ SERV OF UPPER & LOWER CREW 02.		
			2007/11/29		34,011	9	1	
DUE TO PREVIOUS HISTORY AND PER MAINT CONTROL REQUEST						7		
REMOVE & REPLACE CENTER PAX SEAT 02 MASK						34,011	9	2
					7			
REMOVED & REPLACED SUPERNUMERARY CENTER SEAT 02						34,011	9	3
					7			
MASK/REGULATOR PER AMM 35-11-57. PRESS. LEAK & OPS TEST OK						34,011	9	4
FINAL TOTALS								
*** END OF REPORT ***								

To: Distribution

From: -----

SUBJECT: 11-20-07 ADVISORY NOTICE MEETING - AGENDA & MINUTES (wk 47)

[illegible]

W

[illegible]

[illegible]

NEW FTRP ITEMS/RESPONSIBILITY:

OLD BOEING EMERGING ISSUES:

NEW BOEING EMERGING ISSUES:

B767 ITEMS/RESPONSIBILITY TO IMPROVE RELIABILITY:

[illegible]

ADDITIONAL ITEMS:

[illegible]

[illegible][illegible]

=====

[illegible]

.....

.....

-

—

From: -----

[illegible]

799AX REL 007-2007 11/16/2007 11/23/2007 **OVERDUE** **ADDITIONAL SQUAWKS**
ATA: 035/10 Etops A/C: N
Summary: FREQ SERV OF UPPER & LOWER CREW 02.
Reason:
DISCREPANCIES INVOLVING PROBLEMS WITH FREQUENT SERVICING OF THE UPPER
& LOWER CREW 02 BOTTLES.
History:
A/N_#_____ Opened_____ Closed_____
REL 005-2007 9/25/2007 9/27/2007
Summary: FREQ SERV OF UPPER CREW 02.

Open Advisory Notices were discussed.

Previous week was discussed.

OLD FTRP ITEMS/RESPONSIBILITY:

No old FTRP Items/Responsibilities at this time.

NEW FTRP ITEMS/RESPONSIBILITY:

No new FTRP Items/Responsibilities at this time.

OLD BOEING EMERGING ISSUES:

No old Boeing Emerging Issues at this time.

NEW BOEING EMERGING ISSUES:

No new Boeing Emerging Issues at this time.

B767 ITEMS/RESPONSIBILITY TO IMPROVE RELIABILITY:

[illegible]

- -----

- -----

- -----

- -----

ADDITIONAL ITEMS:

No additional items at this time.

From: -----

[illegible]

1

ADDITIONAL SQUAWKS

Summary: FREQ SERV OF UPPER CREW O2 BOTTLE.

DISCREPANCIES INVOLVING FREQUENT SERVICING OF UPPER CREW O2 BOTTLE.

—

Open Advisory Notices were discussed.

Previous week was discussed.

No old FTRP Items/Responsibilities at this time.

No new FTRP Items/Responsibilities at this time.

No old Boeing Emerging Issues at this time.

NEW BOEING EMERGING ISSUES:

No new Boeing Emerging Issues at this time.

B767 ITEMS/RESPONSIBILITY TO IMPROVE RELIABILITY:

- -----

- -----

●- -----

●- -----

●- -----

●- -----

●- -----

●- -----

●- -----

From:

[illegible]

[illegible]

ADVISORY NOTICES:

Open Advisory Notices were discussed.

B767 WEEKLY DELAY/CANCELLATION REVIEW:

Previous week was discussed.

OLD FTRP ITEMS/RESPONSIBILITY:

1. Introduction	
2. Background	
3. Methodology	
4. Results	
5. Discussion	
6. Conclusion	
7. References	
8. Appendix	
9. Index	
10. Summary	

=====

•-----

● -----

[illegible]

•-----

-

•-----

-

•-----

-

•-----

•-----

•-----

•-----

•-----

•-----

•-----

•-----

- -

.....
..... -

..... -

-
.....

..... -

•
.....

-
.....
.....

.....

- -