

**MP 608 – Marshall, Michigan Incident
NTSB/PHMSA Information Request No. 24**

24.9 Reference: Field Request

Preamble:

Request: Provide a list of all leaks discovered on the pipeline including when they were detected, their severity and when they were repaired.

Response: Repair/Leak Records: MP 671.96.pdf, MP 722.81, MP 716.32.pdf, MP 749.93.pdf, MP 751.07.pdf, MP 512.27.pdf, MP 714.93.pdf, MP 475.30.pdf, MP 682.77.pdf, MP 468a.pdf, MP 468b.pdf

Enbridge Energy Company Permanent Repair Report

EEC Report Number: FA1970-001 Report Date: 03/22/2010 Report Type: Pipe Repair/Replacement

Location

Reporting Office Ft Atkinson	Date Discovered 06/17/70	Date Repaired 06/18/70	Report Date 03/22/2010
Pipe Line Location - Pump Station or Milepost 468	Line No. 6B	Line Size 30	Special Cost Number
Specific Location - Location from a known stationing on a Route Sheet 154+45 - 390' West of PI 134+56			Route Sheet Number C-376
Quarter	Section 01	Township 35N	Range 9W
Tract No. N-603-3			
Meridian/County 68	Province/State IN	Lat & Long Location Lat. Long.	GPS Location
Property Owner's Name and Address Chesapeake & Ohio Railro Chesapeake & Ohio Railroad Co 500 Water Street J 910 500 Water Street J 910 (410) 237-3401		Property Tenant's Name and Address	
Full Description of Property Damage and any communications with owner or tenant (Attach a sketch if necessary)			

Leak

Describe Specific Nature and Cause of Break or Leak Pin point leak in seam, 40" from downstream end of joint. Permanent repair at a later date will consist of sleeving the entire joint.			
Oil Out of Line - Barrels 3	Oil Recovered - Barrels 0	Net Loss - Barrels 3	Crude Type
Batch Number			
Disposition of Lost Oil Oil soaked soil removed and buried			
Name and Address of Person Reporting Leak Buckeye Pipe Line Co. Partol Pilot			Was a Report Fee Paid? No

Repair

Nature of Repair & Fitting added to Mainline (Attach sketch - Identify upstream & Pipe Orientation) Temporary repair by 14" Plidco clamp, not welded
Welding Procedure or Procedures with Welder Name(s)
Welding Inspector Name
NDE Personnel

General Condition of Line (See Corrosion Inspection Report) No Corrosion	Type of Existing Coating	Type and Length of Repair Coating -
Condition of Trench (dry, wet, etc.)	Cathodic Protection Potential (See Corrosion Inspection Report)	Type of Sleeve Plidco/Split
LPL Personnel must also complete a Corrosion Inspection Report		

Other

Was there any Stock Pipe Installed? (If yes, attach hydrotest records)		Hydrotest Number	
Remarks:			
Government Agency Notified	Individual contacted	Date	Time
Report Completed by and Signature Julia Rask		Date Entered on System Drawings By Tech. Services 03/22/2010	

**Enbridge Energy Company
Corrosion Inspection Report**

EEC Report Number: FA1970-001 Report Date: 03/22/2010

Part A - General Information Concerning Excavation

Line Number and Size 6B - (30)	MilePost/Station 468	Tract No. N-603-3	Stationing 154+45
-----------------------------------	-------------------------	----------------------	----------------------

Purpose of Excavation Pipe Repair/Replacement	Soil Type Sand	Terrain Type
--	-------------------	--------------

Complete These Lines if Excavation is for Instrument Pig Investigation

Type of Pig	Indication No.	Log Footage	Reported Grade Depth or RPR
-------------	----------------	-------------	-----------------------------

Corrosion Type	Max Depth	Anomaly Size
----------------	-----------	--------------

Part B - Inspection Results

Condition of Outside of Pipe
No Corrosion
Comments

Existing Coating is :
Condition of Coating : Satisfactory
Comments :
New Coating is : _____ Coating Length is : _____

Pipe to Soil Potential :
Comments :

Condition of Inside of Pipe :
Comments :

Inspected By : _____ Date Inspected: _____

Part C - Signatures

Pipe Line Foreman Julia Rask	Date 03/22/2010
---------------------------------	--------------------

Engr.

INTERPROVINCIAL PIPE LINE COMPANY
LAKEHEAD PIPE LINE COMPANY, INC.

Permanent Repair/Break or Leak Report

<input type="checkbox"/> PERMANENT REPAIR	<input checked="" type="checkbox"/> BREAK OR LEAK	REPORTING OFFICE Fort Atkinson	DATE OF REPAIR June 17, 1970	DATE OF REPORT June 18, 1970	
NO. LOCATION—FIELD, STATION, OR BETWEEN STATIONS MP 468		LINE SIZE 30"	DATE AND TIME (MST) OF BREAK Unknown		
SPECIFIC LOCATION — FROM A MILE POST, AIR MARKER, TELEGRAPH POLE OR SOME KNOWN POINT ON COMPANY MAP MP 468 : 390' West of P1 134 + 56.					
QUARTER SW	SECTION SEC. 1	TOWNSHIP 35N	RANGE 9W	MERIDIAN — COUNTY Lake	PROVINCE — STATE Indiana

PROPERTY OWNER'S NAME AND ADDRESS
Chesapeake and Ohio R.R. 14th & Madison Ave. Covington, Kentucky

PROPERTY TENANT'S NAME AND ADDRESS

NATURE AND CAUSE OF BREAK OR LEAK
Pin point leak in seam, 40" from downstream end of joint.

NATURE OF REPAIR
Temporary repair by 14" Plidco clamp, not welded.

DISPOSITION OF LOST OIL
Oil soaked soil removed and buried.

FULL DESCRIPTION OF PROPERTY DAMAGE
A film of oil was carried by water and deposited over an area of approximately 80' X 6". This was removed. The area is scrub land not under cultivation. Little if any property damage.

NAME AND ADDRESS OF PERSON REPORTING LEAK
Buckeye Pipe Line Co. Patrol Pilot

WAS REPORT FEE PAID? AMOUNT
 NO YES \$

EXPLAIN BRIEFLY BELOW, ANY REQUEST OR DISCUSSION WITH OWNER OR TENANT CONCERNING DAMAGES TO PROPERTY WHICH MAY HAVE ARISEN VOLUNTARILY WITHOUT INVESTIGATION ON YOUR PART.

None

COATING, PATCHES, PIPE, ETC., TO BE SHOWN ON SUPPORTING DIAGRAM		BARRELS OF OIL OUT OF LINE	3
NUMBER OF CLAMPS REMOVED	NATURE AND KIND OF SOIL Sand - silt	BARRELS OF OIL RECOVERED	Nil
NUMBER OF SPOT WELDS	GENERAL CONDITION OF LINE Good	NET LOSS-BBLS.	3
NUMBER OF ANODES ADDED	GENERAL CONDITION OF COATING Good	CRUDE TYPE	BATCH NO.

REMARKS
Permanent repair at a later date will consist of sleeving the entire joint.

APPROVED DIV. MGR.	PERMANENT REPAIR—REFERENCE DATA DIAGRAM NUMBER	NUMBER OF THIS REPORT PERMANENT REPAIR
	BREAK OR LEAK REPORT NO. Central No. 131	BREAK OR LEAK Leak

DISTRIBUTION

- 1. WHITE COPY — MANAGER, OIL MOVEMENTS
- 2. PINK COPY — DIVISION MANAGER
- 3. GREEN COPY — DISTRICT SUPERINTENDENT
- 4. YELLOW COPY — RETAIN IN BOOK

Leak AT MP 448-1 50 30" Line

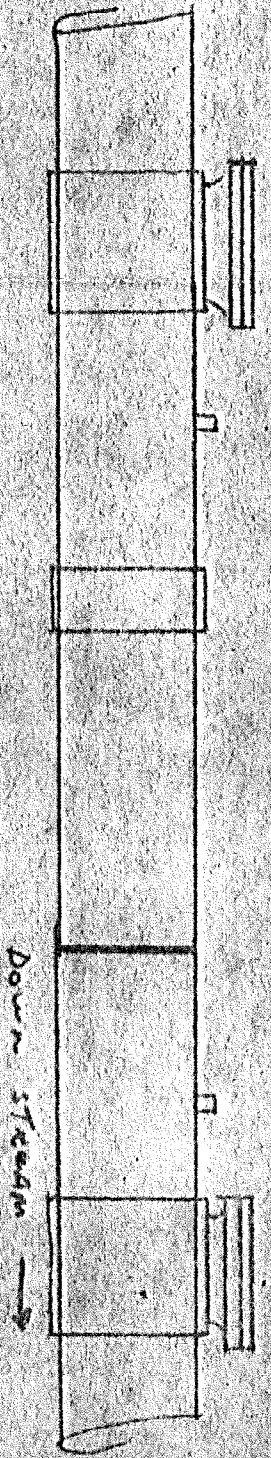

Down Steam Stopple Fee	155+72
Down Steam 2" Vent	155+66
Down Steam Weld	154+99
PLDco Shovel	154+95
Up Steam 2" Vent	154+15
Up Steam Stopple Fee	154+09

TRACT N 603-3 MP. 448-1
 Sec 1 SW 1/4 T 35N R 9W
 LAKE COUNTY IND.

Enbridge Energy Company Permanent Repair Report

EEC Report Number: BC1970-001
Report Date: 03/22/2010

Report Type: Pipe Repair/Replacement

Location

Reporting Office Bay City	Date Discovered 08/17/70	Date Repaired 09/21/70	Report Date 03/22/2010
Pipe Line Location - Pump Station or Milepost 468.51	Line No. 6B	Line Size 30	Special Cost Number
Specific Location - Location from a known stationing on a Route Sheet 154+45 -			Route Sheet Number c-376
Quarter	Section 01	Township 35N	Range 9W
Meridian/County 68	Province/State IN	Lat & Long Location Lat. Long.	Tract No. N-603-3
Property Owner's Name and Address Chesapeake & Ohio Railro Chesapeake & Ohio Railroad Co 500 Water Street J 910 500 Water Street J 910 (410) 237-3401		Property Tenant's Name and Address	
Full Description of Property Damage and any communications with owner or tenant (Attach a sketch if necessary)			

Leak

Describe Specific Nature and Cause of Break or Leak Pin point leak in seam, 40" from end of joint			
Oil Out of Line - Barrels 3	Oil Recovered - Barrels 0	Net Loss - Barrels 3	Crude Type
Batch Number			
Disposition of Lost Oil Oil soaked in the soil, was removed and buried			
Name and Address of Person Reporting Leak Buckeye Pipe Line Partol Pilot			Was a Report Fee Paid? No

Repair

Nature of Repair & Fitting added to Mainline (Attach sketch - Identify upstream & Pipe Orientation) Joint of pipe was removed and new joint installed. A 30" x 15" plidco sleeve was used on final tie-in. Permanent repairs were made on Aug 8, 1970 with the last 30" completion plug to be installed Sept 22, 1970.	
Welding Procedure or Procedures with Welder Name(s)	
Welding Inspector Name	
NDE Personnel	

General Condition of Line (See Corrosion Inspection Report) Steel Not Exposed	Type of Existing Coating	Type and Length of Repair Coating -
Condition of Trench (dry, wet, etc.)	Cathodic Protection Potential (See Corrosion Inspection Report)	Type of Sleeve Plidco/Split
LPL Personnel must also complete a Corrosion Inspection Report		

Other

Was there any Stock Pipe Installed? (If yes, attach hydrotest records) No		Hydrotest Number	
Remarks:			
Government Agency Notified	Individual contacted	Date	Time
Report Completed by and Signature Julia Rask		Date Entered on System Drawings By Tech. Services 03/22/2010	

Enbridge Energy Company Permanent Repair Report

EEC Report Number: FA1970-001
Report Date: 03/22/2010

Report Type: Pipe Repair/Replacement

Location

Reporting Office Ft Atkinson	Date Discovered 06/17/70	Date Repaired 06/18/70	Report Date 03/22/2010
Pipe Line Location - Pump Station or Milepost 468	Line No. 6B	Line Size 30	Special Cost Number
Specific Location - Location from a known stationing on a Route Sheet 154+45 - 390' West of PI 134+56			Route Sheet Number C-376
Quarter	Section 01	Township 35N	Range 9W
Tract No. N-603-3			
Meridian/County 68	Province/State IN	Lat & Long Location Lat. Long.	GPS Location
Property Owner's Name and Address Chesapeake & Ohio Railro Chesapeake & Ohio Railroad Co 500 Water Street J 910 500 Water Street J 910 (410) 237-3401		Property Tenant's Name and Address	
Full Description of Property Damage and any communications with owner or tenant (Attach a sketch if necessary)			

Leak

Describe Specific Nature and Cause of Break or Leak Pin point leak in seam, 40" from downstream end of joint. Permanent repair at a later date will consist of sleeving the entire joint.			
Oil Out of Line - Barrels 3	Oil Recovered - Barrels 0	Net Loss - Barrels 3	Crude Type
Batch Number			
Disposition of Lost Oil Oil soaked soil removed and buried			
Name and Address of Person Reporting Leak Buckeye Pipe Line Co. Partol Pilot			Was a Report Fee Paid? No

Repair

Nature of Repair & Fitting added to Mainline (Attach sketch - Identify upstream & Pipe Orientation) Temporary repair by 14" Pliedco clamp, not welded	
Welding Procedure or Procedures with Welder Name(s)	
Welding Inspector Name	
NDE Personnel	

General Condition of Line (See Corrosion Inspection Report) No Corrosion	Type of Existing Coating	Type and Length of Repair Coating -
Condition of Trench (dry, wet, etc.)	Cathodic Protection Potential (See Corrosion Inspection Report)	Type of Sleeve Plidco/Split

LPL Personnel must also complete a Corrosion Inspection Report

Other

Was there any Stock Pipe Installed? (If yes, attach hydrotest records)	Hydrotest Number
--	------------------

Remarks:

Government Agency Notified	Individual contacted	Date	Time
----------------------------	----------------------	------	------

Report Completed by and Signature Julia Rask	Date Entered on System Drawings By Tech. Services 03/22/2010
---	---

Enbridge Energy Company Permanent Repair Report

EEC Report Number: GT1978-001
Report Date: 03/23/2010

Report Type: Pipe Repair/Replacement

Location

Reporting Office Griffith	Date Discovered 11/14/78	Date Repaired 11/15/78	Report Date 03/23/2010	
Pipe Line Location - Pump Station or Milepost 475.30	Line No. 6B	Line Size 30	Special Cost Number	
Specific Location - Location from a known stationing on a Route Sheet 513+10 - 145 feet d/s of valve at 511+65.			Route Sheet Number c-377	
Quarter	Section 07	Township 35N	Range 7W	Tract No. N-610-2
Meridian/County 68	Province/State IN	Lat & Long Location Lat. Long.	GPS Location	GPS Reading N. W. E.
Property Owner's Name and Address Nayak Raghuvveer P & Anita R LLC SE Raghuvveer P & Anita R Nayak LLC SE 124 Covington Ct 124 Covington Ct			Property Tenant's Name and Address	
Full Description of Property Damage and any communications with owner or tenant (Attach a sketch if necessary)				

Leak

Describe Specific Nature and Cause of Break or Leak Pipe damaged by three intersecting gouges about 3 ft 3 in long at 3 o'clock position looking downstream. 2" crack at gouge intersection.			
Oil Out of Line - Barrels 70	Oil Recovered - Barrels 15	Net Loss - Barrels 55	Crude Type UHG 38-39 Grav
Batch Number UHG-508			
Disposition of Lost Oil 15 barrels picked up and hauled to Griffith. The rest was hauled to an approved landfill.			
Name and Address of Person Reporting Leak Mr. Nick Rombotis 5307 E 61st Ave, Hobart IN, 46342			Was a Report Fee Paid? No

Repair

Nature of Repair & Fitting added to Mainline (Attach sketch - Identify upstream & Pipe Orientation) Installed 30" x 60" Plidco repair sleeve. Repair sleeve supported by three Sakrete supports on pipe and sleeve. No sketch made.
Welding Procedure or Procedures with Welder Name(s)
Welding Inspector Name
NDE Personnel

General Condition of Line (See Corrosion Inspection Report) No Corrosion	Type of Existing Coating	Type and Length of Repair Coating -
Condition of Trench (dry, wet, etc.)	Cathodic Protection Potential (See Corrosion Inspection Report)	Type of Sleeve Plidco/Split
LPL Personnel must also complete a Corrosion Inspection Report		

Other

Was there any Stock Pipe Installed? (If yes, attach hydrotest records) No	Hydrotest Number		
Remarks:			
Government Agency Notified	Individual contacted	Date	Time
Report Completed by and Signature Steve G Booth	Date Entered on System Drawings By Tech. Services 03/23/2010		

**Enbridge Energy Company
Corrosion Inspection Report**

EEC Report Number: GT1978-001 Report Date: 03/23/2010

Part A - General Information Concerning Excavation

Line Number and Size	MilePost/Station	Tract No.	Stationing
6B - (30)	475.30	N-610-2	513+10

Purpose of Excavation	Soil Type	Terrain Type
Pipe Repair/Replacement		

Complete These Lines if Excavation is for Instrument Pig Investigation

Type of Pig	Indication No.	Log Footage	Reported Grade Depth or RPR
-------------	----------------	-------------	-----------------------------

Corrosion Type	Max Depth	Anomaly Size
----------------	-----------	--------------

Part B - Inspection Results

Condition of Outside of Pipe

No Corrosion

Comments

Existing Coating is :

Condition of Coating : Unsatisfactory

Comments : Oil soaked coating replaced. Pipe damage looking like gouging from backhoe teeth. Slight leak may have been present for some time before reported.

New Coating is :

Coating Length is :

Pipe to Soil Potential :

Comments :

Condition of Inside of Pipe :

Comments :

Inspected By :

Date Inspected:

Part C - Signatures

Pipe Line Foreman

Steve G Booth

Date

03/23/2010

**Enbridge Energy Company
PLM Activity Report**

General Information

Report Number: GT1978-001 Report Date: 03/23/2010
Reporter's Name: Julia Rask
Inspector's Name: _____
Type of Work Performed: Pipe Repair/Replacement
Where Was Work Performed: Mainline

Mainline Information

Line Number: 6B
Line Size: 30
Wall Thickness: 0.250
Milepost: 475.30
Stationing: 513+10

Report Information

The following reports may need to be completed for each type of work listed below:

Pipe Repair/Replacement	Shorted Casing	Fitting Installation	Line Lowering
Valve Installation	Casing Extension	Pump Installation	

- Pipe Repair/Replacement
- R-O-W Information Report
- Corrosion Inspection

Kaliper Tool Anomaly	Corrosion Tool Anomaly
----------------------	------------------------

- R-O-W Information Report
- Corrosion Inspection
- If you install a repair sleeve or a cutout:
 Pipe Repair/Replacement

Foreign Crossing

- Foreign Crossing
- If pipe was exposed:
 Corrosion Inspection
- If pipe was damaged:
 R-O-W Information Report
 Pipe Repair/Replacement

**INTERPROVINCIAL PIPE LINE COMPANY
LAKEHEAD PIPE LINE COMPANY, INC.**

Permanent Repair/Break or Leak Report

PERMANENT REPAIR	<input checked="" type="checkbox"/> BREAK OR LEAK	REPORTING OFFICE District 5	DATE OF REPAIR November 15, 1978	DATE OF REPORT November 17, 1978	
PIPE LINE LOCATION—FIELD, STATION, OR BETWEEN STATIONS Field - MP 475.21		LINE SIZE 30-inch	DATE AND TIME (MST) OF BREAK November 14, 1978		
SPECIFIC LOCATION — FROM A MILE POST, AIR MARKER, TELEGRAPH POLE OR SOME KNOWN POINT ON COMPANY MAP 145' downstream of valve at stationing 511+65 (513+10)					
QUARTER NW	SECTION 7	TOWNSHIP 35N	RANGE 7W	MERIDIAN — COUNTY Lake County	PROVINCE — STATE Indiana
PROPERTY OWNER'S NAME AND ADDRESS Jarvis R. Petticord Tract N-610-2					
PROPERTY TENANT'S NAME AND ADDRESS					

NATURE AND CAUSE OF BREAK OR LEAK Pipe damaged by three intersecting gouges about 3 ft. 3 inches long at 3 o'clock position looking downstream. 2" crack at gouge intersection.

NATURE OF REPAIR
Installed 30" X 60" Plidco repair sleeve. Repair sleeve supported by three

Sakrete supports on pipe and sleeve.

DISPOSITION OF LOST OIL Fifteen barrels picked up and hauled to Griffith. The rest was hauled to an approved landfill.

FULL DESCRIPTION OF PROPERTY DAMAGE

Oil soaked topsoil, grass and brush. No crop damage. Material picked up and hauled to approved landfill.

NAME AND ADDRESS OF PERSON REPORTING LEAK Mr. Nick Rombotis 5307 E. 61st Ave. Hobart, Indiana 46342	WAS REPORT FEE PAID? AMOUNT <input checked="" type="checkbox"/> NO <input type="checkbox"/> YES \$
EXPLAIN BRIEFLY BELOW, ANY REQUEST OR DISCUSSION WITH OWNER OR TENANT CONCERNING DAMAGES TO PROPERTY WHICH MAY HAVE ARISEN VOLUNTARILY WITHOUT INVESTIGATION ON YOUR PART.	

None

COATING, PATCHES, PIPE, ETC., TO BE SHOWN ON SUPPORTING DIAGRAM	BARRELS OF OIL OUT OF LINE	70
NUMBER OF CLAMPS REMOVED	NATURE AND KIND OF SOIL	BARRELS OF OIL RECOVERED
NUMBER OF SPOT WELDS	GENERAL CONDITION OF LINE	NET LOSS-BBLS.
NUMBER OF ANODES ADDED	GENERAL CONDITION OF COATING	CRUDE UHG TYPE 38-39 Grav. BATCH NO. UHG-508

REMARKS
Oil soaked coating replaced. Pipe damage looks like gouging from backhoe teeth. Slight leak may have been present for some time before reported.

APPROVED [Signature]	PERMANENT REPAIR—REFERENCE DATA DIAGRAM NUMBER	NUMBER OF THIS REPORT PERMANENT REPAIR	Central No. 795
DIV. MGR.	BREAK OR LEAK REPORT No.	BREAK OR LEAK	Central No.

DISTRIBUTION

1. WHITE COPY — MANAGER, OIL MOVEMENTS

3. GREEN COPY — DISTRICT SUPERINTENDENT

Lakehead Pipe Line Company, Inc.



W. G. COCHRANE
 Vice-President & Manager
 D. D. BURLEY
 Asst. Manager

3025 Tower Avenue
 P. O. Box 388
 Superior, Wisconsin 54880

November 21, 1978

GCD-2917

Office of Pipeline Safety
 U.S. Department of Transportation
 Washington, D.C. 20590

Gentlemen:

Enclosed are two copies of Pipeline Carrier Accident Report (Form 7000-1) reporting on an accident which occurred on this company's pipeline system on November 14, 1978. The accident occurred in Section 7, Township 35 North, Range 7 West, Lake County, Indiana.

Very truly yours,

W. C. Cochran

JES:sb
 Enclosures - 2

bcc: Mr. G. A. Cole w/att. ✓
 Mr. R. D. Piper " ✓

NAME	NOTE	ACT	RECEIVED	ACT	NOTE	NAME
RDP			LPL			WML
HMJ			DISTRICT 8			LJO
CLH			NOV 22 1978			FILE
RAW						Elect.
OBA						Mech.

DEPARTMENT OF TRANSPORTATION
FEDERAL RAILROAD ADMINISTRATION
PIPELINE CARRIER ACCIDENT REPORT

FORM APPROVED
BUDGET BUREAU NO.
004R5501

Instructions

Complete in duplicate. If the space provided for any question is not adequate, attach an additional sheet. Definition of a reportable accident is stated in the Code of Federal Regulations, Title 49, Chapter 1, Part 195. File both copies of this report within 15 days after discovery of the accident with the Administrator, Federal Railroad Administration, Department of Transportation, Washington, D. C. 20591 (Re: Sec. 195.54). Detailed instructions for preparing this form are found in Part 195. Specimen copies of this form will be supplied upon request without charge. Additional copies may be reproduced using the same format and size.

A Carrier Information

1. NAME OF CARRIER
Lakehead Pipe Line Company, Inc.
2. PRINCIPAL BUSINESS ADDRESS
3025 Tower Avenue, Superior, Wisconsin 54880

B Time and Location of Accident

1. DATE (MONTH, DAY, YEAR) 11-14-78
2. HOUR 3:05 CST AM PM
4. PART OF CARRIER'S SYSTEM INVOLVED
 LINE PIPE PUMPING STATION DELIVERY POINT
3. LOCATION (STATE, COUNTY, CITY)
Indiana, Lake, near Hobart TANK FARM OTHER (SPECIFY)
5. PHYSICAL LOCATION (IF LOCATION IS NEAR PUBLIC OR PRIVATE BUILDINGS, OR OTHER SIGNIFICANT LANDMARKS SUCH AS HIGHWAYS OR RAILROADS, ATTACH A SKETCH OR DRAWING SHOWING RELATIONSHIP OF ACCIDENT LOCATION TO THESE LANDMARKS)
NW Quarter, Sec. 7, T35N, R7W (Pipeline M.P. 475.21)

C Origin of Liquid or Vapor Release

PIPE GIRTH WELD LONGITUDINAL WELD PUMP VALVE SCRAPER TRAP
 METER OR PROVER TANK WELDED FITTING BOLTED FITTINGS
 SAMPLE HOUSE HAY TANK STRAINER OR FILTER OTHER (SPECIFY)

D Cause of Accident

CORROSION DEFECTIVE WELD INCORRECT OPERATION BY CARRIER PERSONNEL
 DEFECTIVE PIPE EQUIPMENT RUPTURING LINE OTHER (SPECIFY) Equipment had gouged line.

E Death or Injury

1. NUMBER OF PERSONS KILLED		2. NUMBER OF PERSONS INJURED	
CARRIER EMPLOYEES	NON-EMPLOYEES	CARRIER EMPLOYEES	NON-EMPLOYEES
0	0	0	0

F Property Damage

1. CARRIER'S DAMAGE (PHYSICAL PROPERTY DAMAGED)	2. ITEMS DAMAGED
\$ 3,400	Damage to side of pipe.
3. OTHER PROPERTY DAMAGE	4. ITEMS DAMAGED
\$ 500	Immediate ground area was saturated with oil.

G General Information

1. COMMODITY BEING TRANSPORTED AT TIME OF ACCIDENT	2. ESTIMATED LOSS DUE TO ACCIDENT	3. YEAR FACILITY INSTALLED (EXCLUDING PIPE)	4. WAS THERE A FIRE?	5. WAS THERE AN EXPLOSION?
Crude Oil	70 BARRELS	n/a	<input type="checkbox"/> YES <input checked="" type="checkbox"/> NO	<input type="checkbox"/> YES <input checked="" type="checkbox"/> NO

Instructions

Answer sections H, I or J only if they apply to the particular accident being reported.

H Occurred in Line Pipe

1. NOMINAL DIAMETER	2. WALL THICKNESS	3. GRADE	4. YEAR OF INSTALLATION	5. CONDITION WHEN INSTALLED	6. TYPE OF JOINT
30 IN.	.250 IN.	5LX52	<input type="checkbox"/> BEFORE 1920 <input type="checkbox"/> 1920-30 <input type="checkbox"/> 1930-5 <input checked="" type="checkbox"/> AFTER 1935 (SPECIFY YR.) 1969	<input checked="" type="checkbox"/> NEW <input type="checkbox"/> RECONDITIONED	<input checked="" type="checkbox"/> WELD <input type="checkbox"/> COUPLED <input type="checkbox"/> THREADED
7. CONFIGURATION AT POINT OF ACCIDENT			8. PIPE WAS	9. PIPE WAS	
<input checked="" type="checkbox"/> STRAIGHT <input type="checkbox"/> SAG <input type="checkbox"/> OVERBEND <input type="checkbox"/> SIDEBEND			<input checked="" type="checkbox"/> COATED <input type="checkbox"/> NOT COATED	<input type="checkbox"/> ABOVE GROUND <input checked="" type="checkbox"/> BELOW GROUND	
10. COVER, IF BELOW		11. DESIGN PRESSURE	12. PRESSURE AT TIME & LOCATION OF ACCIDENT		13. HAD THERE BEEN A PRESSURE TEST ON SYSTEM?
60 IN.		624 PSIG	397 PSIG		<input checked="" type="checkbox"/> YES <input type="checkbox"/> NO
14. IF 13 IS YES, MEDIUM USED			15. DURATION OF TEST	16. MAXIMUM TEST PRESS.	17. DATE OF LATEST TEST
<input checked="" type="checkbox"/> WATER <input type="checkbox"/> PETROLEUM <input type="checkbox"/> AIR			24 HRS	866 PSIG	7-29-69

Enbridge Energy Company Permanent Repair Report

EEC Report Number: FA1984-001
Report Date: 03/29/2010

Report Type: Pipe Repair/Replacement

Location

Reporting Office Ft Atkinson	Date Discovered 01/11/84	Date Repaired 01/11/84	Report Date 03/29/2010
Pipe Line Location - Pump Station or Milepost 512.27	Line No. 6B	Line Size 30	Special Cost Number D5-97-84
Specific Location - Location from a known stationing on a Route Sheet 2464+98 - 240' E of Cty Rd 350 E			Route Sheet Number C-385
Quarter	Section 03	Township 37N	Range 2W
Tract No. N-643-3			
Meridian/County 70	Province/State IN	Lat & Long Location Lat. Long.	GPS Location
Property Owner's Name and Address Johnson Thomas M & Kelly M Moody Thomas M Johnson & Kelly M Moody 5841 North County Road 350 East		Property Tenant's Name and Address	
Full Description of Property Damage and any communications with owner or tenant (Attach a sketch if necessary)			

Leak

Describe Specific Nature and Cause of Break or Leak Corrosion caused by cathodic protection interference with another pipe line in area (Wolverine Pipe Line)			
Oil Out of Line - Barrels 5	Oil Recovered - Barrels 0	Net Loss - Barrels 5	Crude Type SW
Batch Number SWX 897			
Disposition of Lost Oil Oil dispensed into surrounding soil. Unable to pick up.			
Name and Address of Person Reporting Leak Dale Nelson - Employee			Was a Report Fee Paid? No

Repair

Nature of Repair & Fitting added to Mainline (Attach sketch - Identify upstream & Pipe Orientation) Standard 14" long 30" diameter Plidco repair sleeve installed over leak. Split repair sleeve will not be put over other corroded areas.		
Welding Procedure or Procedures with Welder Name(s)		
Welding Inspector Name		
NDE Personnel		

General Condition of Line (See Corrosion Inspection Report)	Type of Existing Coating	Type and Length of Repair Coating -
--	--------------------------	--

Condition of Trench (dry, wet, etc.)	Cathodic Protection Potential (See Corrosion Inspection Report)	Type of Sleeve Plidco/Split
--------------------------------------	--	--------------------------------

LPL Personnel must also complete a Corrosion Inspection Report

Other

Was there any Stock Pipe Installed? (If yes, attach hydrotest records)	Hydrotest Number
--	------------------

Remarks:

Government Agency Notified Yes	Individual contacted Bruce Frost (Ind. St. Board of Health)	Date 01/16/84	Time 12/30/1899 11:30:00 AM
-----------------------------------	---	------------------	-----------------------------------

Report Completed by and Signature Julia Rask	Date Entered on System Drawings By Tech. Services 03/29/2010
---	---

**Enbridge Energy Company
Corrosion Inspection Report**

EEC Report Number: FA1984-001 Report Date: 03/29/2010

Part A - General Information Concerning Excavation

Line Number and Size	MilePost/Station	Tract No.	Stationing
6B - (30)	512.27	N-643-3	2464+98

Purpose of Excavation	Soil Type	Terrain Type
Pipe Repair/Replacement	Sand & Clay	

Complete These Lines if Excavation is for Instrument Pig Investigation

Type of Pig	Indication No.	Log Footage	Reported Grade Depth or RPR
-------------	----------------	-------------	-----------------------------

Corrosion Type	Max Depth	Anomaly Size
----------------	-----------	--------------

Part B - Inspection Results

Condition of Outside of Pipe

Comments

Existing Coating is :

Condition of Coating : **Satisfactory**

Comments :

New Coating is :

Coating Length is :

Pipe to Soil Potential :

Comments :

Condition of Inside of Pipe :

Comments :

Inspected By :

Date Inspected:

Part C - Signatures

Pipe Line Foreman

Date

Julia Rask

03/29/2010

**Enbridge Energy Company
PLM Activity Report**

General Information

Report Number: FA1984-001 Report Date: 03/29/2010
Reporter's Name: Julia Rask
Inspector's Name: _____
Type of Work Performed: Pipe Repair/Replacement
Where Was Work Performed: Mainline

Mainline Information

Line Number: 6B
Line Size: 30
Wall Thickness: 0.250
Milepost: 512.27
Stationing: 2464+98

Report Information

The following reports may need to be completed for each type of work listed below:

Pipe Repair/Replacement	Shorted Casing	Fitting Installation	Line Lowering
Valve Installation	Casing Extension	Pump Installation	

- Pipe Repair/Replacement
- R-O-W Information Report
- Corrosion Inspection

Kaliper Tool Anomaly	Corrosion Tool Anomaly
----------------------	------------------------

- R-O-W Information Report
- Corrosion Inspection
- If you install a repair sleeve or a cutout:
 Pipe Repair/Replacement

Foreign Crossing

- Foreign Crossing
- If pipe was exposed:
 Corrosion Inspection
- If pipe was damaged:
 R-O-W Information Report
 Pipe Repair/Replacement

PROVINCIAL PIPE LINE LIMITED / LAKEHEAD PIPE LINE COMPANY, INC.

BREAK OR LEAK REPORT
 PERMANENT REPAIR REPORT

REPORTING OFFICE - Dale Atkinson	DATE AND TIME (MST) OF BREAK Unknown	DATE OF REPAIR January 11, 1984	DATE OF REPORT January 13, 1984
-------------------------------------	---	------------------------------------	------------------------------------

LINE LOCATION - PUMPING STATION OR MILEAGE MARKER MP-512 SO + 30" line 012.27 2404 + 98	LINE SIZE 30"	ATLAS SHT. NO. C-305	SPECIAL COST NO. 05-07-84
--	------------------	-------------------------	------------------------------

SPECIFIC LOCATION - FOOTAGE FROM A KNOWN STATIONING ON THE ATLAS DRAWING (SPECIFY)
 240' E. of City Road 350 E - Tract N-643-3

REPORTER N/E	SECTION 3	TOWNSHIP 37N	RANGE 2W	TRACT NO. N-643-3	MERIDIAN - COUNTY LaPorte	PROVINCE - STATE Indiana
-----------------	--------------	-----------------	-------------	----------------------	------------------------------	-----------------------------

NAME AND ADDRESS OF PERSON REPORTING LEAK
 Dale Nelson - Employee

WAS REPORT FEE PAID? AMOUNT
 NO YES \$

PROPERTY OWNER'S NAME AND ADDRESS
 Bernard J. Birchfield; 5767 N. City Rd. 350 E.; LaPorte City, IN

PROPERTY TENANT'S NAME AND ADDRESS

DESCRIPTION OF PROPERTY DAMAGE; SHOW BY APPROPRIATE SKETCH.
 Essentially none. Small area of contaminated soil.

PLAIN BRIEFLY BELOW, ANY REQUEST OR DISCUSSION WITH OWNER OR TENANT CONCERNING DAMAGES TO PROPERTY WHICH MAY HAVE BEEN VOLUNTARILY WITHOUT INVESTIGATION ON YOUR PART.

Property owner advised R/W dept. would be contacting him. This has been done by the Right of Way Dept. (E. Devore)

NATURE AND CAUSE OF BREAK OR LEAK
 Corrosion caused by cathodic protection interference with another pipe line in area. (Wolverine Pipe Line)

NATURE OF REPAIR & FITTINGS ADDED TO MAIN LINE; SHOW BY APPROPRIATE SKETCH.
 Standard 14" long 30" diameter Pliedco repair sleeve installed over leak. Split repair sleeve will be put over other corroded areas.

NATURE AND KIND OF SOIL Sandy - Clay	BARRELS OF OIL OUT OF LINE approx. 5	CRUDE TYPE oil	BATCH NO. 11
---	---	-------------------	-----------------

GENERAL CONDITION OF LINE Good	BARRELS OF OIL RECOVERED Nil	DISPOSITION OF LOST OIL Oil dispersed into surrounding
-----------------------------------	---------------------------------	---

GENERAL CONDITION OF PLANTING Good	NET LOSS - BBLS. 5	soil. Unable to pick up.
---------------------------------------	-----------------------	--------------------------

MARKS

REPORTED TO GOVERNMENTAL AGENCIES: FEDERAL, PROVINCE/STATE, COAST GUARD, ETC.

AGENCY	INDIVIDUAL CONTACTED	DATE	TIME	
Ind. St. Board of Health	Bruce Frost	1/11	11:30 AM	<input checked="" type="checkbox"/> TELEPHONE <input type="checkbox"/> LETTER
LaPorte Cty. Health Dept.	Eugene F. Dochara	1/11		<input checked="" type="checkbox"/> TELEPHONE <input type="checkbox"/> LETTER
				<input type="checkbox"/> TELEPHONE <input type="checkbox"/> LETTER

SIGNED

NUMBER OF THIS REPORT

PERMANENT REPAIR

BREAK OR LEAK
 CENTRAL NO. 1180

APPROVED

MANAGER

FORM F-17A (1976)

1. White - Division Office
 2. Green - District Office

Enbridge Energy Company Permanent Repair Report

EEC Report Number: MR95042
Report Date: 07/05/95

Report Type: Corrosion Tool Anomaly

Location

Reporting Office Marshall	Date Discovered 06/26/95	Date Repaired 06/26/95	Report Date 07/05/95	
Pipe Line Location - Pump Station or Milepost 671.96	Line No. 6B	Line Size 30"	Special Cost Number SCN-3497	
Specific Location - Location from a known stationing on a Route Sheet 10897+11 -			Route Sheet Number C-416	
Quarter NW	Section 17	Township T3N	Range R5E	Tract No. M-786-2
Meridian/County Livingston	Province/State MI	Lat & Long Location Lat. Long.	GPS Location	GPS Reading N. W. E.
Property Owner's Name and Address MI 48843			Property Tenant's Name and Address	

Full Description of Property Damage and any communications with owner or tenant (Attach a sketch if necessary)
 Damage Accessing: Few ruts and trampled grass, 3/4" water hose to horse pen.
 Damage to Work Area: 1 Excavation - 25' x 85'. Broke a few branches off a couple of White Pine Trees - Branches 1" dia. Mr. Baldwin requested switch grass be planted over excavation for rabbits and birds which we did and repaired fence.

Leak

Describe Specific Nature and Cause of Break or Leak 1 - external corrosion pit 2" long x 1-1/2" circ. 1/2 cup oil out.			
Oil Out of Line - Barrels 0	Oil Recovered - Barrels 0	Net Loss - Barrels 0	Crude Type
Batch Number			
Disposition of Lost Oil Rags and shirt.			
Name and Address of Person Reporting Leak Mick Collier			Was a Report Fee Paid? No

Repair

Nature of Repair & Fitting added to Mainline (Attach sketch - Identify upstream & Pipe Orientation) 1/2" x 30" x 30" long split repair sleeving file welded to pipe.
Welding Procedure or Procedures with Welder Name(s)
Welding Inspector Name
NDE Personnel

General Condition of Line (See Corrosion Inspection Report)	Type of Existing Coating Polyken Tape	Type and Length of Repair Coating Tapecoat 20 - 55
Condition of Trench (dry, wet, etc.) Wet	Cathodic Protection Potential (See Corrosion Inspection Report) -1.35	Type of Sleeve
LPL Personnel must also complete a Corrosion Inspection Report		

Other

Was there any Stock Pipe Installed? (If yes, attach hydrotest records) No		Hydrotest Number	
Remarks:			
Government Agency Notified	Individual contacted	Date	Time
Report Completed by and Signature		Date Entered on System Drawings By Tech. Services	

**Enbridge Energy Company
Corrosion Inspection Report**

EEC Report Number: MR95042 Report Date: 07/05/95

Part A - General Information Concerning Excavation

Line Number and Size 6B - (30")	MilePost/Station 671.96	Tract No. M-786-2	Stationing 10897+11
Purpose of Excavation Corrosion Tool Anomaly	Soil Type Clay	Terrain Type Wooded	

Complete These Lines if Excavation is for Instrument Pig Investigation

Type of Pig British Gas	Indication No. 23	Log Footage 1093074	Reported Grade Depth or RPR 90%
Corrosion Type External	Max Depth .244	Anomaly Size 2 x 1	

Part B - Inspection Results

Condition of Outside of Pipe

Comments

1 - external corrosion pit 2" long x 1-1/2" circ.

Weeper.

Existing Coating is : Polyken Tape

Condition of Coating :

Comments : Ultrasoniced at fillet weld locations.

New Coating is : Tapecoat 20

Coating Length is : 55

Pipe to Soil Potential : -1.35

Comments :

Condition of Inside of Pipe :

Comments :

Inspected By : Brian Whittaker

Date Inspected: 07/05/95

Part C - Signatures

Pipe Line Foreman

Date

07/05/95

Enbridge Energy Company Permanent Repair Report

EEC Report Number: MA1978-003
Report Date: 04/20/2010

Report Type: Pipe Repair/Replacement

Location

Reporting Office Marshall	Date Discovered 04/07/78	Date Repaired 04/08/78	Report Date 04/20/2010
Pipe Line Location - Pump Station or Milepost 682.77	Line No. 6B	Line Size 30	Special Cost Number D6-95-78
Specific Location - Location from a known stationing on a Route Sheet 11467+65 -			Route Sheet Number C-418
Quarter	Section 26	Township 4N	Range 6E
Meridian/County 40	Province/State MI	Lat & Long Location Lat. Long.	Tract No. M-795-5
Property Owner's Name and Address Hightower Larry & Eileen Larry & Eileen Hightower 12330 Rohn Road 12330 Rohn Road		Property Tenant's Name and Address	
Full Description of Property Damage and any communications with owner or tenant (Attach a sketch if necessary)			

Leak

Describe Specific Nature and Cause of Break or Leak Pipe was buckled at end of casing and 2 small pin hole leaks.			
Oil Out of Line - Barrels 4	Oil Recovered - Barrels 4	Net Loss - Barrels 0	Crude Type Sox
Batch Number Sox-308			
Disposition of Lost Oil Pumped back in line.			
Name and Address of Person Reporting Leak Mr. Richard Graham 7520 Denton Hill Rd Fenton MI 48430			Was a Report Fee Paid? No

Repair

Nature of Repair & Fitting added to Mainline (Attach sketch - Identify upstream & Pipe Orientation) Installed 30" x 30" Plidco Sleeve onto M/L		
Welding Procedure or Procedures with Welder Name(s)		
Welding Inspector Name		
NDE Personnel		

General Condition of Line (See Corrosion Inspection Report)	Type of Existing Coating	Type and Length of Repair Coating -
--	--------------------------	--

Dent Buckle or Gouge		
Condition of Trench (dry, wet, etc.)	Cathodic Protection Potential (See Corrosion Inspection Report)	Type of Sleeve Plidco/Split

LPL Personnel must also complete a Corrosion Inspection Report

Other

Was there any Stock Pipe Installed? (If yes, attach hydrotest records) No	Hydrotest Number
--	------------------

Remarks:

Government Agency Notified Yes	Individual contacted Mr. Ron Shaver and Mr. Mike Young	Date 04/07/78	Time
-----------------------------------	--	------------------	------

Report Completed by and Signature Julia Rask	Date Entered on System Drawings By Tech. Services 04/20/2010
---	---

**Enbridge Energy Company
Corrosion Inspection Report**

EEC Report Number: MA1978-003 Report Date: 04/20/2010

Part A - General Information Concerning Excavation

Line Number and Size 6B - (30)	MilePost/Station 682.77	Tract No. M-795-5	Stationing 11467+65
Purpose of Excavation Pipe Repair/Replacement	Soil Type Clay	Terrain Type	

Complete These Lines if Excavation is for Instrument Pig Investigation

Type of Pig	Indication No.	Log Footage	Reported Grade Depth or RPR
-------------	----------------	-------------	-----------------------------

Corrosion Type	Max Depth	Anomaly Size
----------------	-----------	--------------

Part B - Inspection Results

Condition of Outside of Pipe
Dent Buckle or Gouge
Comments
Buckle at end of casing.

Existing Coating is :
Condition of Coating : Satisfactory
Comments :
New Coating is : _____ Coating Length is : _____

Pipe to Soil Potential :
Comments :

Condition of Inside of Pipe :
Comments :

Inspected By : JE M Camey Date Inspected: 04/08/78

Part C - Signatures

Pipe Line Foreman Julia Rask	Date 04/20/2010
---------------------------------	--------------------

**Enbridge Energy Company
PLM Activity Report**

General Information

Report Number: MA1978-003 Report Date: 04/20/2010
Reporter's Name: Julia Rask
Inspector's Name:
Type of Work Performed: Pipe Repair/Replacement
Where Was Work Performed: Mainline

Mainline Information

Line Number: 6B
Line Size: 30
Wall Thickness: 0.250
Milepost: 682.77
Stationing: 11467+65

Report Information

The following reports may need to be completed for each type of work listed below:

Pipe Repair/Replacement	Shorted Casing	Fitting Installation	Line Lowering
Valve Installation	Casing Extension	Pump Installation	

- Pipe Repair/Replacement
- R-O-W Information Report
- Corrosion Inspection

Kaliper Tool Anomaly	Corrosion Tool Anomaly
----------------------	------------------------

- R-O-W Information Report
- Corrosion Inspection
- If you install a repair sleeve or a cutout:
Pipe Repair/Replacement

Foreign Crossing

- Foreign Crossing
- If pipe was exposed:
Corrosion Inspection
- If pipe was damaged:
R-O-W Information Report
Pipe Repair/Replacement

TERPROVINCIAL PIPE LINE LIMITED / LAKEHEAD PIPE LINE COMPANY, INC.

BREAK OR LEAK REPORT
 PERMANENT REPAIR REPORT

REPORTING OFFICE - Day City, Michigan	DATE AND TIME (MST) OF BREAK 4/7/78 1830 MST	DATE OF REPAIR April 8, 1978	DATE OF REPORT April 10, 1978
LINE LOCATION - PUMPING STATION OR MILEAGE MARKER M.P. 682.77	LINE SIZE 30"	ATLAS SHT. NO. C-418	SPECIAL COST NO. D6-95-78

SPECIFIC LOCATION - FOOTAGE FROM A KNOWN STATIONING ON THE ATLAS DRAWING (SPECIFY)

Sta. 11467 + 65

QUARTER W 1/4	SECTION 26	TOWNSHIP T4N	RANGE R6E	TRACT NO. M 795-5	MERIDIAN - COUNTY Livingston	PROVINCE - STATE Michigan
NAME AND ADDRESS OF PERSON REPORTING LEAK Mr. Richard Graham 7520 Denton Hill Road Fenton, MI 48430						WAS REPORT FEE PAID? AMOUNT <input checked="" type="checkbox"/> NO <input type="checkbox"/> YES \$
PROPERTY OWNER'S NAME AND ADDRESS Janet Lutz Mr. Carl Shumaker Jennings Road Flint, MI taking care of property for						
PROPERTY TENANT'S NAME AND ADDRESS Janet Lutz						

ALL DESCRIPTION OF PROPERTY DAMAGE : SHOW BY APPROPRIATE SKETCH.

Excavated 20' x 20' of mainline and welded a 30' x 30" Plidco Sleeve on line also dug a pit 6' x 10' for oil.

EXPLAIN BRIEFLY BELOW, ANY REQUEST OR DISCUSSION WITH OWNER OR TENANT CONCERNING DAMAGES TO PROPERTY WHICH MAY HAVE RISEN VOLUNTARILY WITHOUT INVESTIGATION ON YOUR PART.

None

NATURE AND CAUSE OF BREAK OR LEAK

Pipe was buckled at end of casing and 2 small pin hole leaks.

NATURE OF REPAIR & FITTINGS ADDED TO MAIN LINE: SHOW BY APPROPRIATE SKETCH.

30" x 30" Plidco Sleeve welded to mainline.

NATURE AND KIND OF SOIL Clay	BARRELS OF OIL OUT OF LINE 4 barrels	CRUDE TYPE SOX	BATCH NO. SOX-308
GENERAL CONDITION OF LINE Good	BARRELS OF OIL RECOVERED 4 barrels	DISPOSITION OF LOST OIL Pumped back in line	
GENERAL CONDITION OF COATING Fair	NET LOSS - BBLs. None		

REMARKS

REPORTED TO GOVERNMENTAL AGENCIES: FEDERAL, PROVINCE/STATE, COAST GUARD, ETC.

AGENCY	INDIVIDUAL CONTACTED	DATE	TIME	<input checked="" type="checkbox"/> TELEPHONE <input type="checkbox"/> LETTER
NR Mt. Pleasant, MI	Mr. Ron Shaver	4/7/78	2230 MST	<input checked="" type="checkbox"/> TELEPHONE <input type="checkbox"/> LETTER
CPA Washington	Mr. Mike Young	4/7/78	2255 MST	<input checked="" type="checkbox"/> TELEPHONE <input type="checkbox"/> LETTER
Miss Dig		4/7/78	2023 MST	<input checked="" type="checkbox"/> TELEPHONE <input type="checkbox"/> LETTER

SIGNED 	NUMBER OF THIS REPORT PERMANENT REPAIR Central No. 615
APPROVED 	BREAK OR LEAK Central No. 615
DIV. MGR. 	

Form F-17A (1976)

1. White - Division Office
2. Green - District Office
3. Yellow - Retain

*File
5.30" Ø
Dist # 6*

D.O.T. REGULATION COMPLIANCE

Lakehead Pipe Line Company, Inc.

CORROSION INSPECTION REPORT

RECEIVED			ACT	NOTE	NAME
RSB			L		TJG
WAB					BSM
DOB					CEN
WOC					DET
DRB					

APR 22 1978

PARTS A & B OF THIS REPORT MUST BE COMPLETED WHENEVER THE PIPE LINE IS EXPOSED FOR ANY REASON. PART C MUST ALSO BE COMPLETED WHEN ANY PORTION OF THE PIPE LINE IS REMOVED.

PART A - GENERAL INFORMATION CONCERNING EXCAVATION

Leak Report no. 615

1. ATLAS STATION C-418	4. PURPOSE Dig leak and weld 30" x 30" Plidco Sleeve
2. TRACT NO. M-795-5	5. TYPE OF SOIL AND TERRAIN Clay
3. MILE POST 682	

PART B - INSPECTION FOR EXTERNAL CORROSION

D.O.T. Regulation Sec. 195.416 (e)

1. CONDITION OF PIPE Good	2. CONDITION OF COATING Fair
----------------------------------	-------------------------------------

3. REMARKS - GIVE DESCRIPTION OF ANY ABNORMAL CONDITIONS

Buckle at end of casing

4. DATE INSPECTED

April 8, 1978

5. INSPECTED BY

PART C - INSPECTION FOR INTERNAL CORROSION

D.O.T. Regulation Sec. 195.418 (d)

1. CONDITION OF INSIDE OF PIPE

2. REMARKS - GIVE DESCRIPTION OF ANY ABNORMAL CONDITIONS

3. DATE INSPECTED

4. INSPECTED BY

PIPE LINE FOREMAN

DISTRICT SUPERINTENDENT

Copies to: Division Manager and District Superintendent - Originator makes copy as desired.

LINE SIZE 30"

Enbridge Energy Company Permanent Repair Report

EEC Report Number: MA1979-001
 Report Date: 04/26/2010

Report Type: Excavated for leak in 30" crude oil line. L6

Location

Reporting Office Marshall	Date Discovered 01/09/79	Date Repaired 01/09/79	Report Date 04/26/2010	
Pipe Line Location - Pump Station or Milepost 714.93	Line No. 6B	Line Size 30	Special Cost Number	
Specific Location - Location from a known stationing on a Route Sheet 13165+57 -			Route Sheet Number C-425	
Quarter	Section 15	Township 5N	Range 11E	Tract No. M-824-4
Meridian/County 41	Province/State MI	Lat & Long Location Lat. Long.	GPS Location	GPS Reading N. W. E.
Property Owner's Name and Address Old Joseph & Kathy Joseph & Kathy Old PO box 598 PO box 598			Property Tenant's Name and Address	
Full Description of Property Damage and any communications with owner or tenant (Attach a sketch if necessary)				

Leak

Describe Specific Nature and Cause of Break or Leak			
Oil Out of Line - Barrels	Oil Recovered - Barrels	Net Loss - Barrels 0	Crude Type
Batch Number			
Disposition of Lost Oil			
Name and Address of Person Reporting Leak			Was a Report Fee Paid? No

Repair

Nature of Repair & Fitting added to Mainline (Attach sketch - Identify upstream & Pipe Orientation) Excavation.
Welding Procedure or Procedures with Welder Name(s)
Welding Inspector Name
NDE Personnel

General Condition of Line	Type of Existing Coating	Type and Length of Repair Coating
---------------------------	--------------------------	-----------------------------------

(See Corrosion Inspection Report)		-
Condition of Trench (dry, wet, etc.)	Cathodic Protection Potential (See Corrosion Inspection Report)	Type of Sleeve
LPL Personnel must also complete a Corrosion Inspection Report		

Other

Was there any Stock Pipe Installed? (If yes, attach hydrotest records)		Hydrotest Number	
Remarks:			
Government Agency Notified	Individual contacted	Date	Time
Report Completed by and Signature Julia Rask		Date Entered on System Drawings By Tech. Services 04/26/2010	

**Enbridge Energy Company
Corrosion Inspection Report**

EEC Report Number: MA1979-001 Report Date: 04/26/2010

Part A - General Information Concerning Excavation

Line Number and Size 6B - (30)	MilePost/Station 714.93	Tract No. M-824-4	Stationing 13165+57
Purpose of Excavation Excavated for leak in 30" crude oil line. L6		Soil Type Clay	Terrain Type

Complete These Lines if Excavation is for Instrument Pig Investigation

Type of Pig	Indication No.	Log Footage	Reported Grade Depth or RPR
Corrosion Type	Max Depth	Anomaly Size	

Part B - Inspection Results

Condition of Outside of Pipe

Comments

Existing Coating is :

Condition of Coating :

Comments :

New Coating is :

Coating Length is :

Pipe to Soil Potential :

Comments :

Condition of Inside of Pipe :

Comments :

Inspected By :

Date Inspected: 01/09/79

Part C - Signatures

Pipe Line Foreman

Julia Rask

Date

04/26/2010

D.O.T. REGULATION COMPLIANCE

Lakehead Pipe Line Company, Inc.

~~DGT~~ ~~EAS~~

CORROSION INSPECTION REPORT

PARTS A & B OF THIS REPORT MUST BE COMPLETED WHENEVER THE PIPE LINE IS EXPOSED FOR ANY REASON. PART C MUST ALSO BE COMPLETED WHEN ANY PORTION OF THE PIPE LINE IS REMOVED.

PART A - GENERAL INFORMATION CONCERNING EXCAVATION

1. ATLAS STATION 13165 + 57	4. PURPOSE Excavated for leak in 30" crude oil line, Line6.
2. TRACT NO. M-824-4	
3. MILE POST 714.93	5. TYPE OF SOIL AND TERRAIN Clay Loam

PART B - INSPECTION FOR EXTERNAL CORROSION

D.O.T. Regulation Sec.
195.416 (e)

1. CONDITION OF PIPE Good	2. CONDITION OF COATING Good
------------------------------	---------------------------------

3. REMARKS - GIVE DESCRIPTION OF ANY ABNORMAL CONDITIONS

4. DATE INSPECTED January 9, 1979	5. INSPECTED BY
--------------------------------------	-----------------

PART C - INSPECTION FOR INTERNAL CORROSION

D.O.T. Regulation Sec.
195.418 (d)

1. CONDITION OF INSIDE OF PIPE
2. REMARKS - GIVE DESCRIPTION OF ANY ABNORMAL CONDITIONS

3. DATE INSPECTED	4. INSPECTED BY
PIPE LINE FOREMAN [Redacted]	DISTRICT SUPERINTENDENT [Redacted]

Enbridge Energy Company Permanent Repair Report

EEC Report Number: MA1987-001

Report Date: 04/26/2010

Report Type: Pipe Repair/Replacement

Location

Reporting Office Marshall	Date Discovered 07/30/87	Date Repaired 07/31/87	Report Date 04/26/2010
Pipe Line Location - Pump Station or Milepost 716.32	Line No. 6B	Line Size 30	Special Cost Number 3693
Specific Location - Location from a known stationing on a Route Sheet 13239+28 -			Route Sheet Number C-425
Quarter	Section 13	Township 5N	Range 11E
Tract No. M-826-1C			
Meridian/County 41	Province/State MI	Lat & Long Location Lat. Long.	GPS Location
		GPS Reading N. W. E.	
Property Owner's Name and Address Blough John P John P. Blough 76955 Dequindre Road 76955 Dequindre Road (248) 628-4840		Property Tenant's Name and Address	
Full Description of Property Damage and any communications with owner or tenant (Attach a sketch if necessary)			

Leak

Describe Specific Nature and Cause of Break or Leak			
Oil Out of Line - Barrels 1	Oil Recovered - Barrels 0	Net Loss - Barrels 1	Crude Type
Batch Number			
Disposition of Lost Oil Negligible amounts of oily rags and sail hauled to Marshall for disposal.			
Name and Address of Person Reporting Leak Aerial Partol Pilot			Was a Report Fee Paid? No

Repair

Nature of Repair & Fitting added to Mainline (Attach sketch - Identify upstream & Pipe Orientation) 30" x 14" Plidco Repair Sleeve was installed.
Welding Procedure or Procedures with Welder Name(s)
Welding Inspector Name
NDE Personnel
General Condition of Line
Type of Existing Coating
Type and Length of Repair Coating

(See Corrosion Inspection Report) Dent Buckle or Gouge		-
Condition of Trench (dry, wet, etc.)	Cathodic Protection Potential (See Corrosion Inspection Report)	Type of Sleeve Plidco/Split
LPL Personnel must also complete a Corrosion Inspection Report		

Other

Was there any Stock Pipe Installed? (If yes, attach hydrotest records)		Hydrotest Number	
Remarks:			
Government Agency Notified	Individual contacted	Date	Time
Report Completed by and Signature Julia Rask		Date Entered on System Drawings By Tech. Services 04/26/2010	

Enbridge Energy Company Corrosion Inspection Report

EEC Report Number: MA1987-001 Report Date: 04/26/2010

Part A - General Information Concerning Excavation

Line Number and Size 6B - (30)	MilePost/Station 716.32	Tract No. M-826-1C	Stationing 13239+28
-----------------------------------	----------------------------	-----------------------	------------------------

Purpose of Excavation Pipe Repair/Replacement	Soil Type Clay, Rocky	Terrain Type Wooded
--	--------------------------	------------------------

Complete These Lines if Excavation is for Instrument Pig Investigation

Type of Pig	Indication No.	Log Footage	Reported Grade Depth or RPR
-------------	----------------	-------------	-----------------------------

Corrosion Type	Max Depth	Anomaly Size
----------------	-----------	--------------

Part B - Inspection Results

Condition of Outside of Pipe

Dent Buckle or Gouge

Comments

A rock was uncovered at approx 6:30 position which dented the 30" line. At caused approx 3 1/2" diameter dent which created a small leak. A 14" Plido sleeve was installed. After it was installed it was ultrasoniced with company equipment around the circumference ends for internal corrosion.

Existing Coating is :

Condition of Coating :

Comments : Good but poor where oil had leaked.

New Coating is :

Coating Length is :

Pipe to Soil Potential :

Comments :

Condition of Inside of Pipe :

Comments :

Inspected By : DL Fritz

Date Inspected: 07/30/87

Part C - Signatures

Pipe Line Foreman

Julia Rask

Date

04/26/2010

**Enbridge Energy Company
PLM Activity Report**

General Information

Report Number: MA1987-001 Report Date: 04/26/2010
Reporter's Name: Julia Rask
Inspector's Name:
Type of Work Performed: Pipe Repair/Replacement
Where Was Work Performed: Mainline

Mainline Information

Line Number: 6B
Line Size: 30
Wall Thickness: 0.250
Milepost: 716.32
Stationing: 13239+28

Report Information

The following reports may need to be completed for each type of work listed below:

Pipe Repair/Replacement	Shorted Casing	Fitting Installation	Line Lowering
Valve Installation	Casing Extension	Pump Installation	

- Pipe Repair/Replacement
- R-O-W Information Report
- Corrosion Inspection

Kaliper Tool Anomaly	Corrosion Tool Anomaly
----------------------	------------------------

- R-O-W Information Report
- Corrosion Inspection
- If you install a repair sleeve or a cutout:
Pipe Repair/Replacement

Foreign Crossing

- Foreign Crossing
- If pipe was exposed:
Corrosion Inspection
- If pipe was damaged:
R-O-W Information Report
Pipe Repair/Replacement

INTERPROVINCIAL PIPE LINE LIMITED / LAKEHEAD PIPE LINE COMPANY, INC.

BREAK OR LEAK REPORT
 PERMANENT REPAIR REPORT

REPORTING OFFICE - Bay City, Michigan	DATE AND TIME (MST) OF BREAK July 29, 1987 0900 MST	DATE OF REPAIR July 31, 1987	DATE OF REPORT August 7, 1987
--	--	---------------------------------	----------------------------------

LINE LOCATION - PUMPING STATION OR MILEAGE MARKER M.P. 716.5 <i>716.32</i>	LINE SIZE 30"	ATLAS SHT. NO. C-425	SPECIAL COST NO. SCN-3693
---	------------------	-------------------------	------------------------------

SPECIFIC LOCATION - FOOTAGE FROM A KNOWN STATIONING ON THE ATLAS DRAWING (SPECIFY)
 13239 + 28

QUARTER NE of NENW	SECTION 13	TOWNSHIP T5N	RANGE R11E	TRACT NO. M-826-1C	MERIDIAN - COUNTY Oakland	PROVINCE - STATE Michigan
-----------------------	---------------	-----------------	---------------	-----------------------	------------------------------	------------------------------

NAME AND ADDRESS OF PERSON REPORTING LEAK
 Aerial Patrol Pilot

WAS REPORT FEE PAID? AMOUNT
 NO YES \$

PROPERTY OWNER'S NAME AND ADDRESS
 Mr. Pier Marino Grassi 903 River Bend Drive Rochester Hills, MI 48063-4144

PROPERTY TENANT'S NAME AND ADDRESS

FULL DESCRIPTION OF PROPERTY DAMAGE : SHOW BY APPROPRIATE SKETCH.
 INgress and Egress 400' x 12'
 320' x 60' Excavation and Working Area.

EXPLAIN BRIEFLY BELOW, ANY REQUEST OR DISCUSSION WITH OWNER OR TENANT CONCERNING DAMAGES TO PROPERTY WHICH MAY HAVE ARISEN VOLUNTARILY WITHOUT INVESTIGATION ON YOUR PART.
 Referred to Right-of-Way Department.

NATURE AND CAUSE OF BREAK OR LEAK
 Small dent caused by rock.

NATURE OF REPAIR & FITTINGS ADDED TO MAIN LINE: SHOW BY APPROPRIATE SKETCH.
 30" x 14" Plidco Repair Sleeve was installed.

NATURE AND KIND OF SOIL Clay Rock Loam	BARRELS OF OIL OUT OF LINE 1 Barrel	CRUDE TYPE	BATCH NO.
GENERAL CONDITION OF LINE Good	BARRELS OF OIL RECOVERED None	DISPOSITION OF LOST OIL Negligible amount of oily rags and soil hauled to Marshall for disposal.	
GENERAL CONDITION OF COATING POOR/Good	NET LOSS - BBLS. 1 Barrel		

REMARKS

REPORTED TO GOVERNMENTAL AGENCIES: FEDERAL, PROVINCE/STATE, COAST GUARD, ETC.			
AGENCY	INDIVIDUAL CONTACTED	DATE	TIME
DNR	Operator 22	7/29/87	1500 EDT
State Fire Marshall		7/29/87	1505 EDT
State Police		7/29/87	1510 EDT

SIGNED <i>[Signature]</i>	NUMBER OF THIS REPORT PERMANENT REPAIR
APPROVED <i>[Signature]</i>	BREAK OR LEAK Central No. 1206 Leak

D. O. T. REGULATION COMPLIANCE

Lakehead Pipe Line Company, Inc.

CORROSION INSPECTION REPORT

PARTS A & B OF THIS REPORT MUST BE COMPLETED WHENEVER THE PIPE LINE IS EXPOSED FOR ANY REASON.
PART C MUST ALSO BE COMPLETED WHEN ANY PORTION OF THE PIPE LINE IS REMOVED.

PART A - GENERAL INFORMATION CONCERNING EXCAVATION

1. LINE SIZE AND NO. 30" line 6	2. MILE POST 716.5	3. TRACT NO. M-826-1C	4. ATLAS STATION 13239 + 28
5. PURPOSE OF EXCAVATION Leak at M.P. 716.5		6. SOIL <input type="checkbox"/> SAND <input type="checkbox"/> LOAM <input checked="" type="checkbox"/> CLAY <input checked="" type="checkbox"/> ROCKY	7. TERRAIN <input checked="" type="checkbox"/> WOODED <input type="checkbox"/> CULTIVATED <input type="checkbox"/> SWAMPY <input type="checkbox"/>
COMPLETE THIS LINE IF EXCAVATION IS FOR INSTRUMENT PIG INVESTIGATION			
8. TYPE OF PIG	9. INDICATION NO.	10. LOG FOOTAGE	11. GRADE OF INDICATION

PART B - INSPECTION FOR EXTERNAL CORROSION

D.O.T. Regulation Sec.
195.416 (e)

1. CONDITION OF PIPE Good	2. CONDITION OF COATING Good Poor - where oil had leaked.
3. REMARKS - GIVE DESCRIPTION OF ANY ABNORMAL CONDITIONS A rock was uncovered at approximately 6:30 position which dented the 30" line. It caused approximately 3½" diameter dent which created a small leak. A 14" Plidco REpair Sleeve was installed. After the 14" Plidco was installed over the dent, it was ultrasoniced with Company Equipment around the circumference ends for internal corrosion.	
4. DATE INSPECTED July 30, 1987	5. INSPECTED BY D. L. Fritz, D. H. LaVoy and L. H. DeBriyn

PART C - INSPECTION FOR INTERNAL CORROSION

D.O.T. Regulation Sec.
195.418 (d)

1. CONDITION OF INSIDE OF PIPE	
2. REMARKS - GIVE DESCRIPTION OF ANY ABNORMAL CONDITIONS	
3. DATE INSPECTED	4. INSPECTED BY
PIPE LINE FOREMAN D. H. LaVoy	DISTRICT SUPERINTENDENT 

Enbridge Energy Company Permanent Repair Report

EEC Report Number: MA1988-002
Report Date: 04/26/2010

Report Type: Spill Cleanup

Location

Reporting Office Marshall	Date Discovered 06/16/88	Date Repaired 08/12/88	Report Date 04/26/2010	
Pipe Line Location - Pump Station or Milepost 722.81	Line No. 6B	Line Size 30	Special Cost Number D6-99-88	
Specific Location - Location from a known stationing on a Route Sheet 13581+76 -			Route Sheet Number C-427	
Quarter	Section 12	Township 5N	Range 12E	Tract No. M-832-1L
Meridian/County 34	Province/State MI	Lat & Long Location Lat. Long.	GPS Location	GPS Reading N. W. E.
Property Owner's Name and Address Enbridge Energy Limited Partnership Enbridge Energy Limited Partnership 119 N. 25th Street East 119 N. 25th Street East			Property Tenant's Name and Address	
Full Description of Property Damage and any communications with owner or tenant (Attach a sketch if necessary)				

Leak

Describe Specific Nature and Cause of Break or Leak Repair not due to a leak.			
Oil Out of Line - Barrels 8500	Oil Recovered - Barrels 7300	Net Loss - Barrels 1200	Crude Type Bowrifer
Batch Number			
Disposition of Lost Oil Burned and soaked into soil			
Name and Address of Person Reporting Leak John Ferguson 15203 Reid Rd Romeo, MI 48065			Was a Report Fee Paid? No

Repair

Nature of Repair & Fitting added to Mainline (Attach sketch - Identify upstream & Pipe Orientation) Cleanup from an idle crossover line that ruptured due to pressure build up due to thermal expansion.
Welding Procedure or Procedures with Welder Name(s)
Welding Inspector Name
NDE Personnel

General Condition of Line (See Corrosion Inspection Report)	Type of Existing Coating	Type and Length of Repair Coating -
--	--------------------------	--

Condition of Trench (dry, wet, etc.)	Cathodic Protection Potential (See Corrosion Inspection Report)	Type of Sleeve
--------------------------------------	--	----------------

LPL Personnel must also complete a Corrosion Inspection Report

Other

Was there any Stock Pipe Installed? (If yes, attach hydrotest records)	Hydrotest Number
--	------------------

Remarks:

Government Agency Notified Yes	Individual contacted Michigan State Police9	Date 06/16/88	Time 12/30/1899 09:15:00 AM
-----------------------------------	--	------------------	-----------------------------------

Report Completed by and Signature Julia Rask	Date Entered on System Drawings By Tech. Services 04/26/2010
---	---

Enbridge Energy Company Corrosion Inspection Report

EEC Report Number: MA1988-002 Report Date: 04/26/2010

Part A - General Information Concerning Excavation

Line Number and Size 6B - (30)	MilePost/Station 722.81	Tract No. M-832-1L	Stationing 13581+76
-----------------------------------	----------------------------	-----------------------	------------------------

Purpose of Excavation Spill Cleanup	Soil Type Clay	Terrain Type
--	-------------------	--------------

Complete These Lines if Excavation is for Instrument Pig Investigation

Type of Pig	Indication No.	Log Footage	Reported Grade Depth or RPR
-------------	----------------	-------------	-----------------------------

Corrosion Type	Max Depth	Anomaly Size
----------------	-----------	--------------

Part B - Inspection Results

Condition of Outside of Pipe

Comments

Existing Coating is :

Condition of Coating :

Comments :

New Coating is :

Coating Length is :

Pipe to Soil Potential :

Comments :

Condition of Inside of Pipe :

Comments :

Inspected By :

Date Inspected:

Part C - Signatures

Pipe Line Foreman

Julia Rask

Date

04/26/2010

INTERPROVINCIAL PIPE LINE LIMITED / LAKEHEAD PIPE LINE COMPANY, INC.

BREAK OR LEAK REPORT
 PERMANENT REPAIR REPORT

REPORTING OFFICE - Bay City, Michigan	DATE AND TIME (MST) OF BREAK 1450 MST 6/16/88	DATE OF REPAIR August 12, 1988	DATE OF REPORT October 13, 1988
LINE LOCATION - PUMPING STATION OR MILEAGE MARKER M.P. 722.75 722.81	LINE SIZE 30"	ATLAS SHT. NO. C-427	SPECIAL COST NO. D6-99-88

SPECIFIC LOCATION - FOOTAGE FROM A KNOWN STATIONING ON THE ATLAS DRAWING (SPECIFY)

Crossover line at Station 13581 + 76

QUARTER SE NW	SECTION 12	TOWNSHIP T5N	RANGE R12E	TRACT NO. M-832-1L	MERIDIAN - COUNTY Macomb	PROVINCE - STATE Michigan
NAME AND ADDRESS OF PERSON REPORTING LEAK John Ferguson 15203 Reid Road, Romeo, MI 48065						WAS REPORT FEE PAID? AMOUNT <input type="checkbox"/> NO <input checked="" type="checkbox"/> YES \$
PROPERTY OWNER'S NAME AND ADDRESS Lakehead Pipe Line Company, Inc.						
PROPERTY TENANT'S NAME AND ADDRESS						

FULL DESCRIPTION OF PROPERTY DAMAGE : SHOW BY APPROPRIATE SKETCH.

The oil contaminated soil on two adjacent parcels and ran into the North Branch of the Clinton River. See attached drawing.

EXPLAIN BRIEFLY BELOW, ANY REQUEST OR DISCUSSION WITH OWNER OR TENANT CONCERNING DAMAGES TO PROPERTY WHICH MAY HAVE ARISEN VOLUNTARILY WITHOUT INVESTIGATION ON YOUR PART.

None

NATURE AND CAUSE OF BREAK OR LEAK

An idle crossover line ruptured due to pressure build up due to thermal expansion.



NATURE OF REPAIR & FITTINGS ADDED TO MAIN LINE: SHOW BY APPROPRIATE SKETCH.

See attached Drawing.

NATURE AND KIND OF SOIL Clay	BARRELS OF OIL OUT OF LINE 8,500	CRUDE TYPE Bowriver	BATCH NO.
GENERAL CONDITION OF LINE Good	BARRELS OF OIL RECOVERED 7,300	DISPOSITION OF LOST OIL Burned and soaked into soil.	
GENERAL CONDITION OF COATING Good	NET LOSS - BBLs. 1,200		
REMARKS			

REPORTED TO GOVERNMENTAL AGENCIES: FEDERAL, PROVINCE/STATE, COAST GUARD, ETC.

AGENCY	INDIVIDUAL CONTACTED	DATE	TIME	
Michigan State Police	Lt. Allaire	6/16/88	1915 EDT	<input checked="" type="checkbox"/> TELEPHONE <input type="checkbox"/> LETTER
DNR	Sandy McGlew	6/16/88	2040 EDT	<input checked="" type="checkbox"/> TELEPHONE <input type="checkbox"/> LETTER
National Response Center	Mr. Obrian	6/16/88	2050 EDT	<input checked="" type="checkbox"/> TELEPHONE <input type="checkbox"/> LETTER

SIGNED 	NUMBER OF THIS REPORT PERMANENT REPAIR Central No. 1218-R
APPROVED DIV. MGR. 	BREAK OR LEAK

Brown Rd. - M.P. 722.75
 REMOVAL OF CROSSOVER
 DG-99-88R

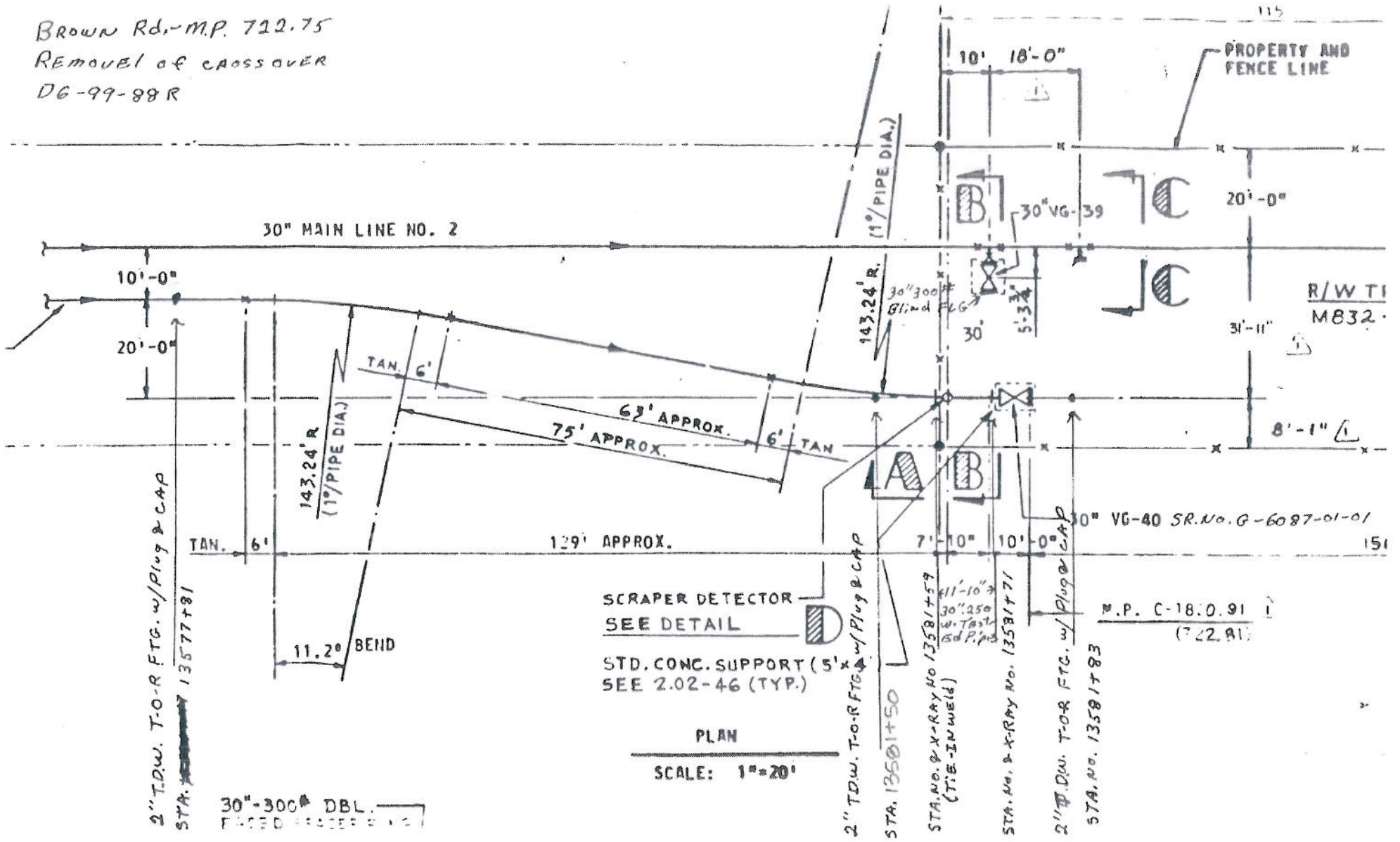

SCRAPER DETECTOR
 SEE DETAIL

STD. CONC. SUPPORT (5' x 5')
 SEE 2.02-46 (TYP.)

PLAN
 SCALE: 1" = 20'

2" T.D.W. T-O-R FTG. w/ Plug & CAP
 STA. 13577+81

2" T.D.W. T-O-R FTG. w/ Plug & CAP
 STA. 13581+50

STA. NO. G-X-RAY No. 13581+59
 (TIE-IN WELD)

STA. No. X-RAY No. 13581+71

2" T.D.W. T-O-R FTG. w/ Plug & CAP
 STA. No. 13581+83

30" - 300# DBL.
 FACED

R/W T1
 M832

30" VG-40 SR. No. G-6087-01-01

M.P. C-18.0.91
 (722.81)

Brown Rd. - MP 722.5
 Removal of Crossover
 D6-99-88 R

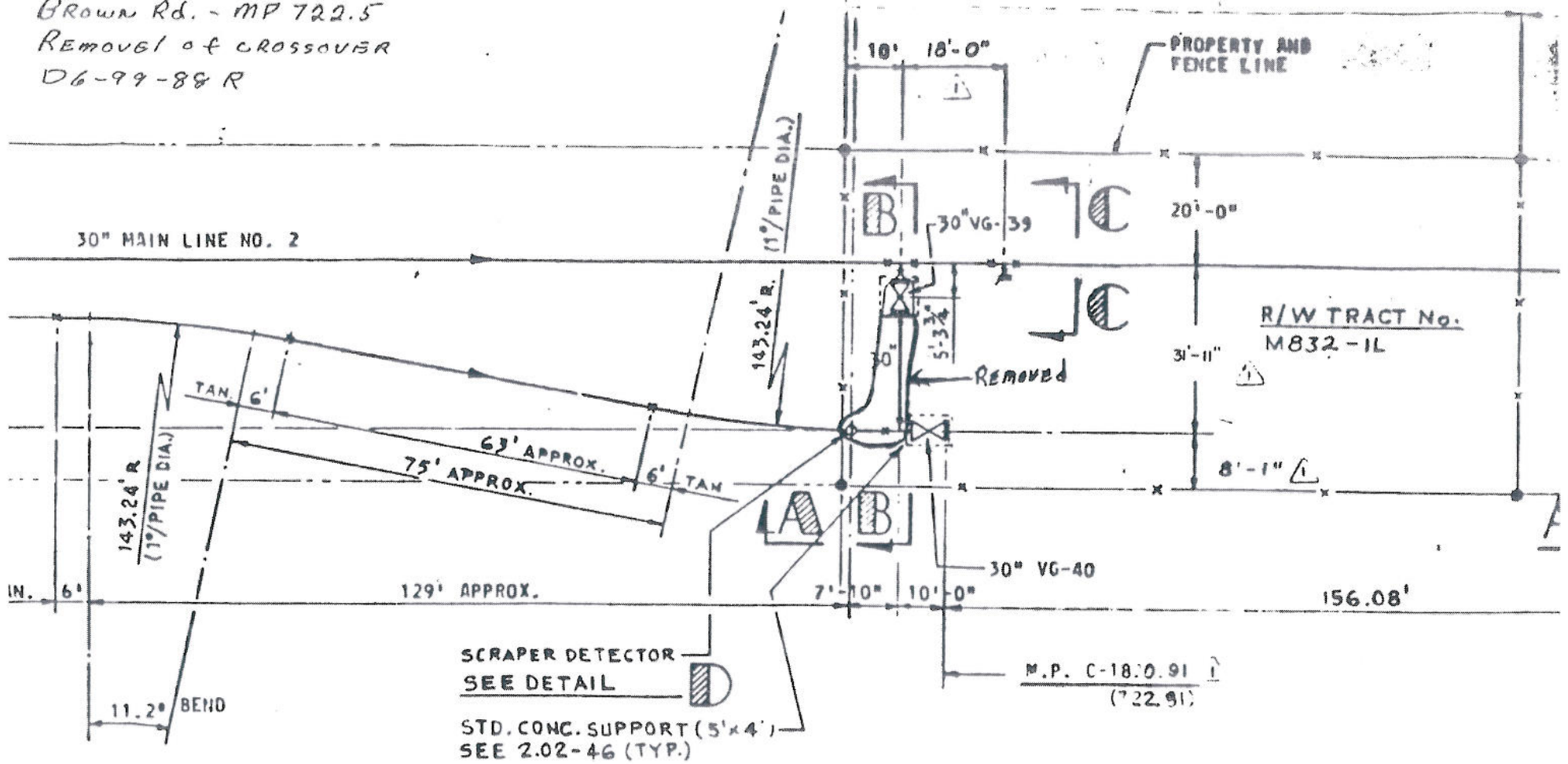

PLAN

SCALE: 1"=20'

30"-300# DBL. []
 []

CROOKED CREEK FARM

ROAD BLOCK

ESPERLING ROAD

LOCKY RD.

AMBULANCES BEFORE FIRE STARTED

FARM

FARM BUILDINGS & DWELLING

LEAK SITE
NEAR
ROMEO HIGH.
MILE POST 722.01
JUNE 16th, 1988

AREA DAMAGED BY
OIL & FIRE

BROWN ROAD

CLINTON RIVER

UTILITY POLES
W/ OVERHEAD WIRES



LADDER TRUCK
& SHERIFF
FARMERS & EQUIPMENT
BOUR GAS LINE
AMBULANCES AFTER
FIRE STARTED

ROAD ENDS
R.O.W. MARKER

HOUSE 2

LARSHEAD VEHICLES
DIESEL

FIRE
Rou SKROCKI

PACER HOS
BACKED UP

S FARMLAND 2

FB 6212865

ATTACHMENT 4

LINE NO. 6 DIA. 30" X .250"
 LOCATION MP 722.75
 CHAINAGE 13577+81
 TYPE OF SLEEVE FITTING 2" TDW
 WELD UPSTREAM OR DOWNSTREAM N/A
 INSPECTION DATE(S) 8/10/88 19 88

NON DESTRUCTIVE TESTING
INSPECTION OF CIRCUMFERENTIAL FILLET WELD

Complete one form for each in place weld and for each weld on repairs over defective welds

INSPECTION CONTRACTOR CONSUMERS POWER CO.
 INSPECTOR'S NAME(S) THOMAS J STUMP
 INSPECTOR'S CERTIFICATION(S) LEVEL II
 ULTRASONIC INSTRUMENT N/A COUPLANT N/A
 ULTRASONIC PROBE(S) N/A
 ULTRASONIC CALIBRATION BLOCKS N/A
 ULTRASONIC CALIBRATION PROCEDURE(S) WIC/MT
 ULTRASONIC FREQUENCY N/A SENSITIVITY N/A TRANSFER CORR'M N/A
 MAGNETIC PARTICLE YOKE PARKER PROBE 3743-00581 POWER A.C.
 MAGNETIC PARTICLE TYPE DRY/REX PSA03 BACKGROUND LACQUER N/A

Location measured around from top centre	Sketch of defects with circumferential limits. Long seam and other features noted.	Defect characteristics and measures. Orientation clockwise looking downstream.
--	--	--

Orientation	Sleeve	Weld	Pipe	Item or Defect Description	Max Depth	Length
12 O'Clock	N/A	N/A	N/A	N/A	N/A	N/A
3 O'Clock	N/A	N/A	N/A	N/A	N/A	N/A
6 O'Clock						
9 O'Clock						
12 O'Clock						

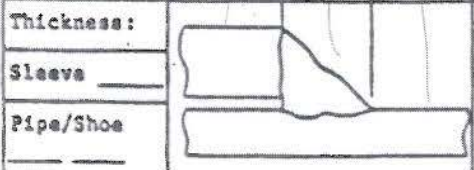

LABORATORY AND FIELD
TECHNICAL SERVICES
DEPARTMENT
NONDESTRUCTIVE
TESTING SERVICES
DIVISION
135 W. TRAIL ST.
JACKSONVILLE, FLORIDA 32202

Inspector's Signature _____

DISTRIBUTION: Division Manager
 District Manager
 Engineering Dept.
 IPL Mgr. Operations Serv.

IPL/LPL Representative Signature _____

INTERPROVINCIAL PIPE LINE LIMITED
LAKEHEAD PIPE LINE COMPANY, INC.

NON DESTRUCTIVE TESTING
INSPECTION OF CIRCUMFERENTIAL FILLET WELD

LINE NO. 6" DIA. 30" X 250"
LOCATION MP 722.75
CHAINAGE 13581+47
FITTING
TYPE OF SLEEVE 2" TDW
WELD UPSTREAM OR DOWNSTREAM N/A
INSPECTION DATE(S) 8/10/88 19 88

Complete one form for each in place weld and for each weld on repairs over defective welds

INSPECTION CONTRACTOR CONSUMERS POWER CO.
INSPECTOR'S NAME(S) THOMAS J STUMP
INSPECTOR'S CERTIFICATION(S) LEVEL II
ULTRASONIC INSTRUMENT N/A COUPLANT N/A
ULTRASONIC PROBE(S) N/A
ULTRASONIC CALIBRATION BLOCKS N/A
ULTRASONIC CALIBRATION PROCEDURE(S) WIC/MT
ULTRASONIC FREQUENCY N/A SENSITIVITY N/A TRANSFER CORR'N N/A
MAGNETIC PARTICLE YOKER PARKER PROBE 3743-00581 POWER A.C.
MAGNETIC PARTICLE TYPE DRY/GRY 85A03 BACKGROUND LACQUER N/A

Location measured around from top centre	Sketch of defects with circumferential limits. Long seam and other features noted.			Defect characteristics and measures. Orientation clockwise looking downstream.		
Orientation	Sleeve	Weld	Pipe	Item or Defect Description	Max Depth	Length
12 O'Clock	<u>N/A</u>	<u>N/A</u>	<u>N/A</u>	<u>N/A</u>	<u>N/A</u>	<u>N/A</u>
3 O'Clock	<u>N/A</u>	<u>N/A</u>	<u>N/A</u>			
6 O'Clock						
9 O'Clock						
12 O'Clock						
Thickness:				<p>CPCO/ICS LABORATORY AND FIELD TECHNICAL SERVICES DEPARTMENT NONDESTRUCTIVE TESTING SERVICES DIVISION 135 W. TRAIL ST. JACKSON, MICHIGAN</p>		
Sleeve						
Pipe/Shoe						

DISTRIBUTION: Division Manager
District Manager
Engineering Dept.
IPL Mgr. Operations Serv.

Inspector's Stamp

Inspector's Signature

IPL/LPL Representative
Signature

INTERPROVINCIAL PIPE LINE LIMITED
LAKEHEAD PIPE LINE COMPANY, INC.

NON DESTRUCTIVE TESTING
INSPECTION OF CIRCUMFERENTIAL FILLET WELD

LINE NO. 6" DIA. 30" X 250"
LOCATION MP 722.75
CHAINAGE 13581+83
TYPE OF SLEEVE FITTING 2" TDW
WELD UPSTREAM OR DOWNSTREAM N/A
INSPECTION DATE(S) 8/10/88 19 88

Complete one form for each in place weld and for each weld on repairs over defective welds

INSPECTION CONTRACTOR CONSUMERS POWER CO.
INSPECTOR'S NAME(S) THOMAS J STUMP
INSPECTOR'S CERTIFICATION(S) LEVEL II
ULTRASONIC INSTRUMENT N/A COUPLANT N/A
ULTRASONIC PROBE(S) N/A
ULTRASONIC CALIBRATION BLOCKS N/A
ULTRASONIC CALIBRATION PROCEDURE(S) WIC/MT
ULTRASONIC FREQUENCY N/A SENSITIVITY N/A TRANSFER CORR'N N/A
MAGNETIC PARTICLE YOKE PARKER PROBE 3743-00581 POWER A.C.
MAGNETIC PARTICLE TYPE DRY/REY BSA03 BACKGROUND LACQUER N/A

Location measured around from top centre	Sketch of defects with circumferential limits. Long seam and other features noted.			Defect characteristics and measures. Orientation clockwise looking downstream.		
Orientation	Sleeve	Weld	Pipe	Item or Defect Description	Max Depth	Length
12 O'Clock	N/A	N/A	N/A	N/A	N/A	N/A
3 O'Clock	N/A	N/A	N/A			
6 O'Clock						
9 O'Clock						
12 O'Clock						

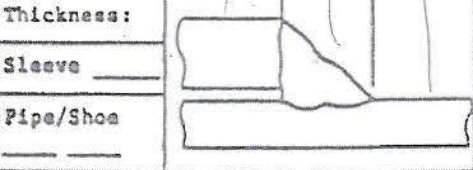

EPCO/LCS
LABORATORY AND FIELD
TECHNICAL SERVICES
DEPARTMENT
NONDESTRUCTIVE
TESTING SERVICES
DIVISION
135 W. TRAIL ST.
JACKSON, MICHIGAN
Inspector's Stamp

[Signature]
Inspector's Signature
IPL/LPL Representative
Signature

DISTRIBUTION: Division Manager
District Manager
Engineering Dept.
IPL Mgr. Operations Serv.

Enbridge Energy Company Permanent Repair Report

EEC Report Number: MA1987-003

Report Date: 04/27/2010

Report Type: Pipe Repair/Replacement

Location

Reporting Office Marshall	Date Discovered 05/12/87	Date Repaired 05/19/87	Report Date 04/27/2010
Pipe Line Location - Pump Station or Milepost 749.93	Line No. 6B	Line Size 30	Special Cost Number D6-98-87
Specific Location - Location from a known stationing on a Route Sheet 15013+78 -			Route Sheet Number C-432
Quarter	Section 06	Township 5N	Range 17E
Tract No. M7-29-A			
Meridian/County 32	Province/State MI	Lat & Long Location Lat. Long.	GPS Location
		GPS Reading N. W. E.	
Property Owner's Name and Address Moeller Ronald Ronald Moeller 3334 Mclain Road 3334 Mclain Road (810) 982-6875		Property Tenant's Name and Address	
Full Description of Property Damage and any communications with owner or tenant (Attach a sketch if necessary)			

Leak

Describe Specific Nature and Cause of Break or Leak Small Corrosion Leak.			
Oil Out of Line - Barrels 2	Oil Recovered - Barrels 0	Net Loss - Barrels 2	Crude Type Sweet
Batch Number SW-589			
Disposition of Lost Oil Held pending disposal permit for land fill.			
Name and Address of Person Reporting Leak Ariel Partol Pilot			Was a Report Fee Paid? No

Repair

Nature of Repair & Fitting added to Mainline (Attach sketch - Identify upstream & Pipe Orientation) Installed a 30" x 30" Plidco Repair Sleeve.		
Welding Procedure or Procedures with Welder Name(s)		
Welding Inspector Name		
NDE Personnel		

General Condition of Line	Type of Existing Coating	Type and Length of Repair Coating
---------------------------	--------------------------	-----------------------------------

(See Corrosion Inspection Report) Extensive Corrosion		-
Condition of Trench (dry, wet, etc.)	Cathodic Protection Potential (See Corrosion Inspection Report)	Type of Sleeve Plidco/Split
LPL Personnel must also complete a Corrosion Inspection Report		

Other

Was there any Stock Pipe Installed? (If yes, attach hydrotest records)		Hydrotest Number	
Remarks:			
Government Agency Notified Yes	Individual contacted Michigan DNR/Mike Czuprenski/Tom Turnbull	Date 05/12/87	Time 12/30/1899 07:45:00 PM
Report Completed by and Signature Julia Rask		Date Entered on System Drawings By Tech. Services 04/27/2010	

Enbridge Energy Company PLM Activity Report
--

General Information

Report Number:	MA1987-003	Report Date:	04/27/2010
Reporter's Name:	Julia Rask		
Inspector's Name:			
Type of Work Performed:	Pipe Repair/Replacement		
Where Was Work Performed:	Mainline		

Mainline Information

Line Number:	6B
Line Size:	30
Wall Thickness:	0.250
Milepost:	749.93
Stationing:	15013+78

Report Information

The following reports may need to be completed for each type of work listed below:

Pipe Repair/Replacement	Shorted Casing	Fitting Installation	Line Lowering
Valve Installation	Casing Extension	Pump Installation	

- Pipe Repair/Replacement
- R-O-W Information Report
- Corrosion Inspection

Kaliper Tool Anomaly	Corrosion Tool Anomaly
----------------------	------------------------

- R-O-W Information Report
- Corrosion Inspection
- If you install a repair sleeve or a cutout:
 Pipe Repair/Replacement

Foreign Crossing

- Foreign Crossing
- If pipe was exposed:
 Corrosion Inspection
- If pipe was damaged:
 R-O-W Information Report
 Pipe Repair/Replacement

Enbridge Energy Company Corrosion Inspection Report

EEC Report Number: MA1987-003 Report Date: 04/27/2010

Part A - General Information Concerning Excavation

Line Number and Size 6B - (30)	MilePost/Station 749.93	Tract No. M7-29-A	Stationing 15013+78
-----------------------------------	----------------------------	----------------------	------------------------

Purpose of Excavation Pipe Repair/Replacement	Soil Type Peat & Clay	Terrain Type Grass R/W
--	--------------------------	---------------------------

Complete These Lines if Excavation is for Instrument Pig Investigation

Type of Pig	Indication No.	Log Footage	Reported Grade Depth or RPR
-------------	----------------	-------------	-----------------------------

Corrosion Type	Max Depth	Anomaly Size
----------------	-----------	--------------

Part B - Inspection Results

Condition of Outside of Pipe

Extensive Corrosion

Comments

Leak occurred in an area of external corrosion. A 30" plidco repair sleeve was installed over the leak and other pits in close proximity. Numerous other pits exist on the bottom quadrant u/s and d/s of the leak.

Existing Coating is :

Condition of Coating : Unsatisfactory

Comments :

New Coating is :

Coating Length is :

Pipe to Soil Potential :

Comments :

Condition of Inside of Pipe :

Comments :

Inspected By : DH LaVoy

Date Inspected: 05/12/87

Part C - Signatures

Pipe Line Foreman

Julia Rask

Date

04/27/2010

INTERPROVINCIAL PIPE LINE LIMITED / LAKEHEAD PIPE LINE COMPANY, INC.

BREAK OR LEAK REPORT
 PERMANENT REPAIR REPORT

REPORTING OFFICE Bay City, Michigan	DATE AND TIME (MST) OF BREAK 5/12/87 1330 MST	DATE OF REPAIR Sleeve Installed 5/12/87 Welds made 5/19/87	DATE OF REPORT 5/20/87
LINE LOCATION - PUMPING STATION OR MILEAGE MARKER M.P. 749.93	LINE SIZE 30"	ATLAS SHT. NO. C432	SPECIAL COST NO. D6-98-87

SPECIFIC LOCATION - FOOTAGE FROM A KNOWN STATIONING ON THE ATLAS DRAWING (SPECIFY)

15013 + 78 Center of Plidco

QUARTER	SECTION 6	TOWNSHIP T5N	RANGE R17E	TRACT NO. M7-29A	MERIDIAN - COUNTY St. Clair	PROVINCE - STATE Michigan
---------	---------------------	------------------------	----------------------	----------------------------	---------------------------------------	-------------------------------------

NAME AND ADDRESS OF PERSON REPORTING LEAK Aerial Patrol Pilot	WAS REPORT FEE PAID? AMOUNT <input type="checkbox"/> NO <input type="checkbox"/> YES \$
---	--

PROPERTY OWNER'S NAME AND ADDRESS
Max Thompson 2500 River Road #45 Marysville, MI 48040

PROPERTY TENANT'S NAME AND ADDRESS

FULL DESCRIPTION OF PROPERTY DAMAGE : SHOW BY APPROPRIATE SKETCH.
373' Downstream of M-29

Excavation 26' Wide by 75' Long.

EXPLAIN BRIEFLY BELOW, ANY REQUEST OR DISCUSSION WITH OWNER OR TENANT CONCERNING DAMAGES TO PROPERTY WHICH MAY HAVE ARISEN VOLUNTARILY WITHOUT INVESTIGATION ON YOUR PART.

All contacts with owner were through Right-of-Way Department.

NATURE AND CAUSE OF BREAK OR LEAK
Small corrosion leak.



NATURE OF REPAIR & FITTINGS ADDED TO MAIN LINE: SHOW BY APPROPRIATE SKETCH.
Installed 30" x 30" Plidco Repair Sleeve.

NATURE AND KIND OF SOIL Clay/Loam	BARRELS OF OIL OUT OF LINE 2	CRUDE TYPE Sweet	BATCH NO. SW-589
GENERAL CONDITION OF LINE Fair	BARRELS OF OIL RECOVERED Negligible	DISPOSITION OF LOST OIL Held pending disposal permit for land fill.	
GENERAL CONDITION OF COATING Poor	NET LOSS - BBLs. 2		

REMARKS

REPORTED TO GOVERNMENTAL AGENCIES: FEDERAL, PROVINCE/STATE, COAST GUARD, ETC.

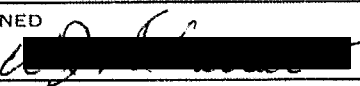
AGENCY	INDIVIDUAL CONTACTED	DATE	TIME	
Michigan DNR	Mike Czuprenski/Tom Turnbull	5/12/87	7:40 p.m.	<input checked="" type="checkbox"/> TELEPHONE <input type="checkbox"/> LETTER
National Response Center	Petty Officer Pavilonis	5/13/87	12:30 p.m.	<input checked="" type="checkbox"/> TELEPHONE <input type="checkbox"/> LETTER <input type="checkbox"/> TELEPHONE <input type="checkbox"/> LETTER

SIGNED 	NUMBER OF THIS REPORT PERMANENT REPAIR
APPROVED 	BREAK OR LEAK Central No. 1204
DIV. MGR.	

D. O. T. REGULATION COMPLIANCE

Lakehead Pipe Line Company, Inc.

CORROSION INSPECTION REPORT

NAME	NOTE	ACT	ACT	NOTE	NAME
DDB					GIM
WCC					CEN
DEC					BJP
GAS					CWS
GWM					JES
					DGI

RECEIVED
LAKEHEAD
PIPELINE CO. INC
MAY 26 1987

PARTS A & B OF THIS REPORT MUST BE COMPLETED WHENEVER THE PIPE LINE IS EXPOSED FOR ANY REASON.
PART C MUST ALSO BE COMPLETED WHEN ANY PORTION OF THE PIPE LINE IS REMOVED.

PART A - GENERAL INFORMATION CONCERNING EXCAVATION

1. LINE SIZE AND NO. 30" 6	2. MILE POST 749.9	3. TRACT NO. M7-29A	4. ATLAS STATION 15013 + 78
5. PURPOSE OF EXCAVATION Leak at M.P. 749.9 ³		6. SOIL <input type="checkbox"/> SAND <input checked="" type="checkbox"/> LOAM <input checked="" type="checkbox"/> CLAY <input type="checkbox"/> ROCKY	7. TERRAIN <input type="checkbox"/> WOODED <input type="checkbox"/> CULTIVATED <input type="checkbox"/> SWAMPY <input checked="" type="checkbox"/> Grass R/W
COMPLETE THIS LINE IF EXCAVATION IS FOR INSTRUMENT PIG INVESTIGATION			
8. TYPE OF PIG	9. INDICATION NO.	10. LOG FOOTAGE	11. GRADE OF INDICATION

D.O.T. Regulation Sec.
195.416 (e)

PART B - INSPECTION FOR EXTERNAL CORROSION

1. CONDITION OF PIPE Poor	2. CONDITION OF COATING Poor
3. REMARKS - GIVE DESCRIPTION OF ANY ABNORMAL CONDITIONS Leak occurred in an area of external corrosion. A 30" plidco repair sleeve was installed over the leak and other pits in close proximity. Numerous other pits exist on the bottom quadrant upstream and downstream of the leak.	
4. DATE INSPECTED May 12th and 19th, 1987	5. INSPECTED BY D. H. LaVoy

D.O.T. Regulation Sec.
195.418 (d)

PART C - INSPECTION FOR INTERNAL CORROSION

1. CONDITION OF INSIDE OF PIPE	
2. REMARKS - GIVE DESCRIPTION OF ANY ABNORMAL CONDITIONS	
3. DATE INSPECTED	4. INSPECTED BY
PIPE LINE FOREMAN D. H. LaVoy	DISTRICT SUPERINTENDENT 



CONSUMERS POWER COMPANY
LABORATORY AND
FIELD TECHNICAL SERVICES DEPT
NONDESTRUCTIVE TESTING SERVICES
THICKNESS MEASUREMENT
EXAMINATION REPORT

Examiner DAN HAUCH Level II Date 11-17-88 Sheet No. 24-01
 Examiner N/A Level N/A NDT Company CPCO
 Project No. 24885285121 Requesting Dept LAKEHEAD PIPE LINE
BAY CITY
 Job Location MARYSVILLE (SCN 3604) Total Hours Worked 8

NDT Procedure NDI-UT-02 Rev 3

Reference Documents INFORMATION ONLY

Material Type C/S Joint Design N/A

Nominal Diameter 30" Nominal Thickness .250"

Item Type OIL PIPE LINE

Ultrasonic Equipment K-METER Serial Number 3743-00187

Search Unit Size/Frequency .5" PITCH CATCH Serial Number 3743-00187

Ultrasonic Couplant ULTRAGEL Batch Number 8662

Mechanical Equipment N/A Serial Number N/A

N/A N/A N/A

Item ID Number N/A System Name N/A Sub Project Number N/A

Line Number # 6 MILE POST 749.9 CHAINAGE 15018+96 ISO/Drawing No. N/A

Item	Thickness Measurements									
	1	2	3	4	5	6	7	8	9	10
AREA 1 LOW .255" HIGH .260"	NO INTERNAL PITTING NOTED									
AREA 2 LOW .250" HIGH .260"	NO INTERNAL PITTING NOTED									
AREA 3 LOW .245" HIGH .260"	NO INTERNAL PITTING NOTED									

Sketch/Remarks

MILE POST
749.9
CHAINAGE
15018+96

NORTH SIDE
UPSTREAM →
SEAM WELD
← 16" → 1" 22" 1" T₁₆ L₁₆

SOUTH SIDE
← UPSTREAM
1" 18" 1" T₁₆ L₁₆
1" 28" 1" CIRC WELD

MECHANICAL READINGS OF EXTERNAL PITTING
TAKEN BY LAKEHEAD PERSONNEL.

Examiner [Redacted]

Reviewed by: _____

Enbridge Energy Company Permanent Repair Report

EEC Report Number: MA1985-004
Report Date: 04/30/2010

Report Type: Pipe Repair/Replacement

Location

Reporting Office Marshall	Date Discovered 10/14/85	Date Repaired 10/14/85	Report Date 04/30/2010
Pipe Line Location - Pump Station or Milepost 751.07	Line No. 6B	Line Size 30	Special Cost Number D6-97-85
Specific Location - Location from a known stationing on a Route Sheet 15073+99 -			Route Sheet Number C-432
Quarter	Section 32	Township 6N	Range 17E
Meridian/County 32	Province/State MI	Lat & Long Location Lat. Long.	Tract No. M-858-10
Property Owner's Name and Address Marysville City Of		Property Tenant's Name and Address	
Full Description of Property Damage and any communications with owner or tenant (Attach a sketch if necessary)			

Leak

Describe Specific Nature and Cause of Break or Leak Corrosion at 6:00 approx 2-1/2" diameter was leaking. Also found numerous multiple corrosion pits.			
Oil Out of Line - Barrels 10	Oil Recovered - Barrels 3	Net Loss - Barrels 7	Crude Type
Batch Number			
Disposition of Lost Oil			
Name and Address of Person Reporting Leak Debra J. Robert 18900 Oxford, Grosse Point, MI 48236			Was a Report Fee Paid? No

Repair

Nature of Repair & Fitting added to Mainline (Attach sketch - Identify upstream & Pipe Orientation) Installed 30" x 30" Plidco repair sleeve and 12.5 ft o f30" x .500 WT full encirclement repair sleeve.	
Welding Procedure or Procedures with Welder Name(s)	
Welding Inspector Name	
NDE Personnel	

General Condition of Line (See Corrosion Inspection Report) Extensive Corrosion	Type of Existing Coating	Type and Length of Repair Coating -
Condition of Trench (dry, wet, etc.)	Cathodic Protection Potential (See Corrosion Inspection Report)	Type of Sleeve

		Plidco/Split
LPL Personnel must also complete a Corrosion Inspection Report		

Other

Was there any Stock Pipe Installed? (If yes, attach hydrotest records)		Hydrotest Number	
Remarks:			
Government Agency Notified	Individual contacted	Date	Time
Report Completed by and Signature Julia Rask		Date Entered on System Drawings By Tech. Services 04/30/2010	

Enbridge Energy Company Corrosion Inspection Report

EEC Report Number: MA1985-004 Report Date: 04/30/2010

Part A - General Information Concerning Excavation

Line Number and Size 6B - (30)	MilePost/Station 751.07	Tract No. M-858-10	Stationing 15073+99
Purpose of Excavation Pipe Repair/Replacement	Soil Type Clay	Terrain Type Wooded	

Complete These Lines if Excavation is for Instrument Pig Investigation

Type of Pig	Indication No.	Log Footage	Reported Grade Depth or RPR
-------------	----------------	-------------	-----------------------------

Corrosion Type	Max Depth	Anomaly Size
----------------	-----------	--------------

Part B - Inspection Results

Condition of Outside of Pipe

Extensive Corrosion

Comments

Leak occurred in an area of external corrosion, approx 4" in diameter. There are other pitted areas around the leak in addition to numerous pits upstream of the leak. A 30" plico repair sleeve was installed over the leak and 12.5 ft of repair sleeve over the pitted areas upstream.

Existing Coating is :

Condition of Coating : Unsatisfactory

Comments :

New Coating is :

Coating Length is :

Pipe to Soil Potential :

Comments :

Condition of Inside of Pipe :

Comments :

Inspected By : DH LaVoy

Date Inspected: 10/15/85

Part C - Signatures

Pipe Line Foreman

Julia Rask

Date

04/30/2010

**Enbridge Energy Company
PLM Activity Report**

General Information

Report Number: MA1985-004 Report Date: 04/30/2010
Reporter's Name: Julia Rask
Inspector's Name:
Type of Work Performed: Pipe Repair/Replacement
Where Was Work Performed: Mainline

Mainline Information

Line Number: 6B
Line Size: 30
Wall Thickness: 0.250
Milepost: 751.07
Stationing: 15073+99

Report Information

The following reports may need to be completed for each type of work listed below:

Pipe Repair/Replacement	Shorted Casing	Fitting Installation	Line Lowering
Valve Installation	Casing Extension	Pump Installation	

- Pipe Repair/Replacement
- R-O-W Information Report
- Corrosion Inspection

Kaliper Tool Anomaly	Corrosion Tool Anomaly
----------------------	------------------------

- R-O-W Information Report
- Corrosion Inspection
- If you install a repair sleeve or a cutout:
Pipe Repair/Replacement

Foreign Crossing

- Foreign Crossing
- If pipe was exposed:
Corrosion Inspection
- If pipe was damaged:
R-O-W Information Report
Pipe Repair/Replacement

INTERPROVINCIAL PIPE LINE LIMITED / LAKEHEAD PIPE LINE COMPANY, INC.

BREAK OR LEAK REPORT
 PERMANENT REPAIR REPORT

REPORTING OFFICE - Bay City, Michigan	DATE AND TIME (MST) OF BREAK 10-14-85 1057 MST	DATE OF REPAIR 10-14-85	DATE OF REPORT October 21, 1985
PIPE LINE LOCATION - PUMPING STATION OR MILEAGE MARKER Line 6 M.P. 751.07	LINE SIZE 30"	ATLAS SHT. NO. C-432	SPECIAL COST NO. D6-97-85

SPECIFIC LOCATION - FOOTAGE FROM A KNOWN STATIONING ON THE ATLAS DRAWING (SPECIFY)
 Atlas Station No. 15073 + 99

QUARTER SE $\frac{1}{4}$	SECTION 30	TOWNSHIP 6 North	RANGE 17 East	TRACT NO. M-858-10	MERIDIAN - COUNTY St. Clair	PROVINCE - STATE Michigan
-----------------------------	---------------	---------------------	------------------	-----------------------	--------------------------------	------------------------------

NAME AND ADDRESS OF PERSON REPORTING LEAK Debra J. Robert 18900 Oxford, Grosse Pointe, MI 48236	WAS REPORT FEE PAID? AMOUNT <input type="checkbox"/> NO <input checked="" type="checkbox"/> YES \$ 50.00
--	---

PROPERTY OWNER'S NAME AND ADDRESS
 Burnell T. Weston 5373 Lapeer Road, Port Huron, MI 48060

PROPERTY TENANT'S NAME AND ADDRESS
 None.

FULL DESCRIPTION OF PROPERTY DAMAGE : SHOW BY APPROPRIATE SKETCH.
 Ingress & Egress 30 ft. x 400 ft. excavation and working 140 ft. x 150 ft. in uncultivated field.

EXPLAIN BRIEFLY BELOW ANY REQUEST OR DISCUSSION WITH OWNER OR TENANT CONCERNING DAMAGES TO PROPERTY WHICH MAY HAVE ARISEN VOLUNTARILY WITHOUT INVESTIGATION ON YOUR PART.
 None.

NATURE AND CAUSE OF BREAK OR LEAK
 Corrosion at 6:00 approximately 2- $\frac{1}{2}$ " diameter was leaking. Also found numerous multiple corrosion pits.

NATURE OF REPAIR & FITTINGS ADDED TO MAIN LINE: SHOW BY APPROPRIATE SKETCH.
 Installed 30" x 30" Plidco repair sleeve and 12.5 ft. of 30" x .500 W.T. full encirclement repair sleeve.

NATURE AND KIND OF SOIL Blue clay	BARRELS OF OIL OUT OF LINE 10	CRUDE TYPE Unknown	BATCH NO. Unknown
GENERAL CONDITION OF LINE Poor	BARRELS OF OIL RECOVERED 3	DISPOSITION OF LOST OIL	
GENERAL CONDITION OF COATING Poor	NET LOSS - BBLS. 7		

REMARKS

REPORTED TO GOVERNMENTAL AGENCIES: FEDERAL, PROVINCE/STATE, COAST GUARD, ETC.

AGENCY	INDIVIDUAL CONTACTED	DATE	TIME	
Michigan D.N.R.	Mike Czuprenski	10-14-85	1:30 MST	<input checked="" type="checkbox"/> TELEPHONE <input type="checkbox"/> LETTER
Michigan State Fire Marshall	Sergeant Smith	10-14-85	1:45 MST	<input checked="" type="checkbox"/> TELEPHONE <input type="checkbox"/> LETTER
National Response Center	Ensign Paradis	10-14-85	3:30 MST	<input checked="" type="checkbox"/> TELEPHONE <input type="checkbox"/> LETTER

APPROVED [Signature]	NUMBER OF THIS REPORT PERMANENT REPAIR
DIV. MGR. [Signature]	BREAK OR LEAK Central No. 1192

D. O. T. REGULATION COMPLIANCE

Lakehead Pipe Line Company, Inc.

CORROSION INSPECTION REPORT

NAME	NOTE	ACT	RECEIVED	ACT	NOTE	NAME
WAB			LAKEHEAD OCT 28 1985			GHA
DDB						GWA
WCC						CEN
DEC						BJP
TJG						CWS
						JFS
						DOT

PARTS A & B OF THIS REPORT MUST BE COMPLETED WHENEVER THE PIPE LINE IS EXPOSED FOR ANY REASON.
PART C MUST ALSO BE COMPLETED WHEN ANY PORTION OF THE PIPE LINE IS REMOVED.

PART A - GENERAL INFORMATION CONCERNING EXCAVATION

1. LINE SIZE AND NO. 30" Diameter Line 6	2. MILE POST M.P. 751.07	3. TRACT NO. M858-10	4. ATLAS STATION Route Index C-43 15073 + 99
5. PURPOSE OF EXCAVATION Leak at M.P. 751 Installed 30" x 30" Plidco at this location.		6. SOIL <input type="checkbox"/> SAND <input type="checkbox"/> LOAM <input checked="" type="checkbox"/> CLAY (blue) <input type="checkbox"/> ROCKY	7. TERRAIN <input checked="" type="checkbox"/> WOODED <input type="checkbox"/> CULTIVATED <input type="checkbox"/> SWAMPY <input type="checkbox"/>

COMPLETE THIS LINE IF EXCAVATION IS FOR INSTRUMENT PIG INVESTIGATION

8. TYPE OF PIG	9. INDICATION NO.	10. LOG FOOTAGE	11. GRADE OF INDICATION
----------------	-------------------	-----------------	-------------------------

PART B - INSPECTION FOR EXTERNAL CORROSION

D.O.T. Regulation Sec. 195.416 (e)

1. CONDITION OF PIPE Poor	2. CONDITION OF COATING Poor
------------------------------	---------------------------------

3. REMARKS - GIVE DESCRIPTION OF ANY ABNORMAL CONDITIONS See Attached Drawing.
Info: Leak occurred in an area of external corrosion, approximately 4" in diameter. There are other pitted areas around the leak in addition to numerous pits upstream of the leak. A 30" Plidco repair sleeve was installed over the leak and 12.5 ft. of repair sleeve over the pitted areas upstream.

4. DATE INSPECTED October 15, 1985	5. INSPECTED BY
---------------------------------------	-----------------

PART C - INSPECTION FOR INTERNAL CORROSION

D.O.T. Regulation Sec. 195.418 (d)

1. CONDITION OF INSIDE OF PIPE

2. REMARKS - GIVE DESCRIPTION OF ANY ABNORMAL CONDITIONS

3. DATE INSPECTED	4. INSPECTED BY
PIPE LINE FOREMAN D. H. LaVoy	DISTRICT SUPERINTENDENT 

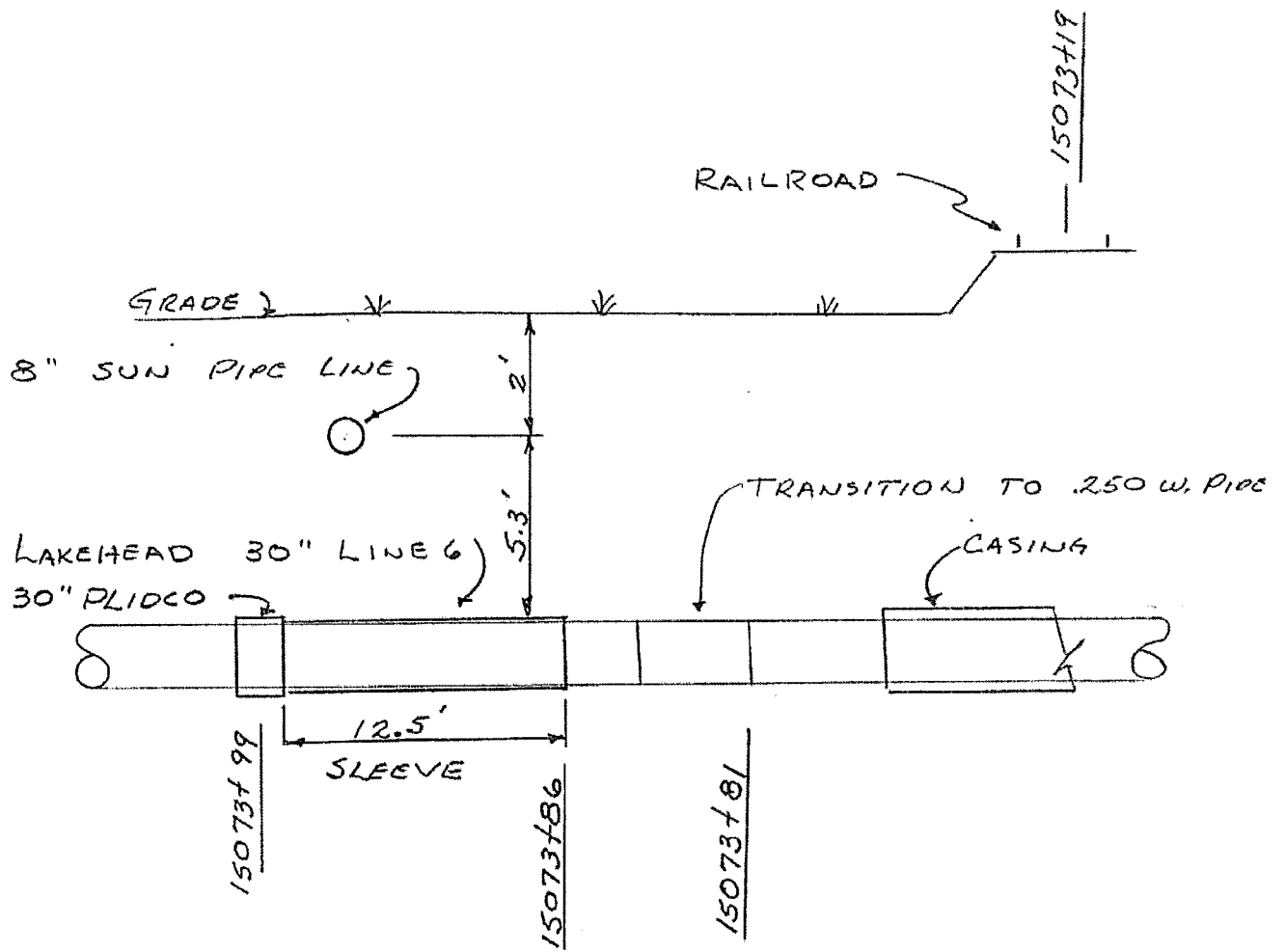

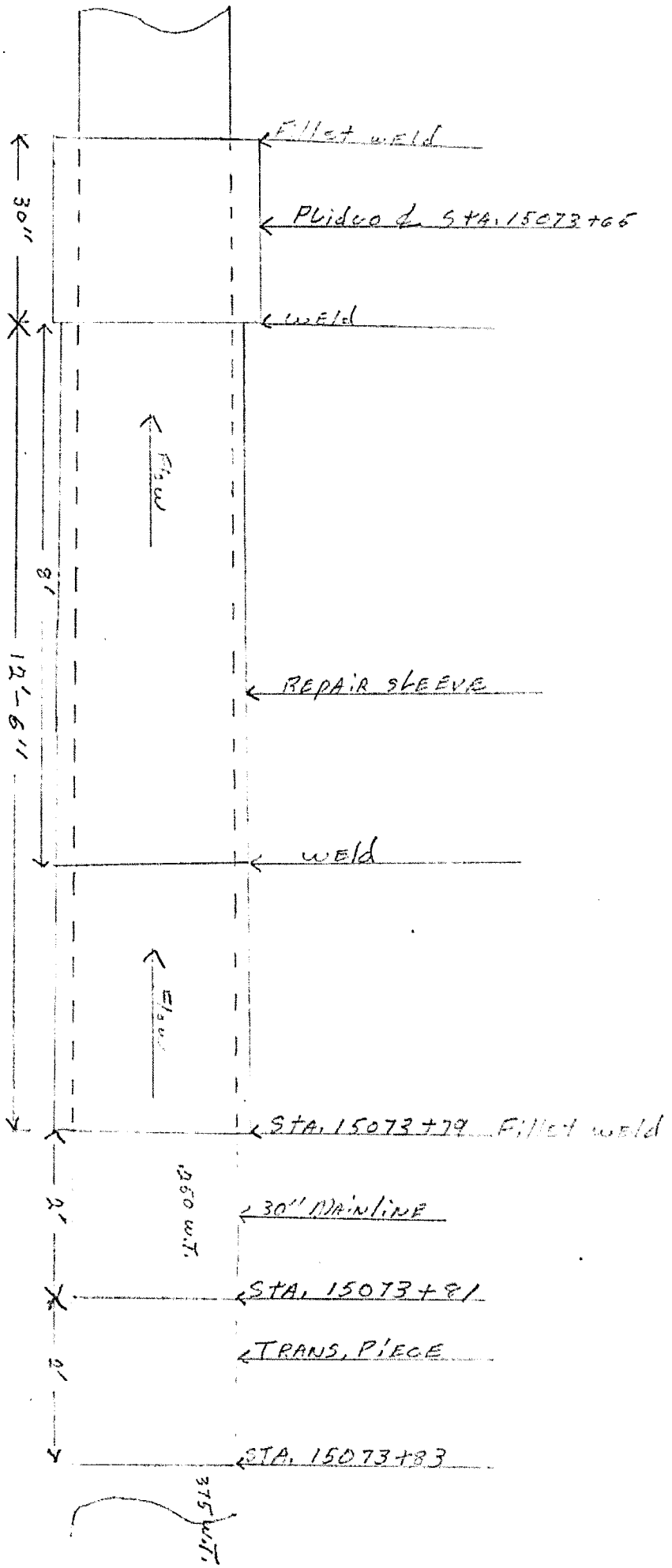

LINE 6, MR 751
 ATLAS SHEET C-432
 30" DIA. PIPE
 TOL. 116, D6-47-85