



Highway Factors Group Attachment – Highway Plan Sheets

Ft Lauderdale, FL

HWY18FH013

(36 pages)

STATE OF FLORIDA
DEPARTMENT OF TRANSPORTATION
FINAL "AS-BUILT" PLANS
~~CONTRACT PLANS~~

FINANCIAL PROJECT ID 430601-1-52-01

BROWARD COUNTY (86180/86050/86005)

STATE ROAD NO. A1A

RESURFACING, RESTORATION & REHABILITATION
SR A1A EAST OF MERCEDES RIVER SMALL BRIDGE
TO SUNRISE BOULEVARD (SR 838)

COMPONENTS OF CONTRACT PLANS SET

- Index of Shop Drawings
- Drainage Structures - EDMS # 1172655
- Tr-Roadways, Lightings - EDMS # 1172656
- Misc. Drainage - EDMS # 1172657
- Misc. Drainage - EDMS # 1172658
- Misc. Drainage - EDMS # 1172659
- Misc. Signalization - EDMS # 1172660
- Misc. Signalization - EDMS # 1172661
- Misc. Signalization - EDMS # 1172662
- Misc. Signalization - EDMS # 1172663
- Misc. Signalization - EDMS # 1172664
- Misc. Signalization - EDMS # 1172665
- Misc. Signalization - EDMS # 1172666
- Misc. Signalization - EDMS # 1172667
- Misc. Signalization - EDMS # 1172668
- Misc. Signalization - EDMS # 1172669
- Misc. Signalization - EDMS # 1172670
- Misc. Signalization - EDMS # 1172671
- Misc. Signalization - EDMS # 1172672
- Misc. Signalization - EDMS # 1172673
- Misc. Signalization - EDMS # 1172674
- Misc. Signalization - EDMS # 1172675
- Misc. Signalization - EDMS # 1172676
- Misc. Signalization - EDMS # 1172677
- Misc. Signalization - EDMS # 1172678
- Misc. Signalization - EDMS # 1172679
- Misc. Signalization - EDMS # 1172680
- Misc. Signalization - EDMS # 1172681
- Misc. Signalization - EDMS # 1172682
- Misc. Signalization - EDMS # 1172683
- Misc. Signalization - EDMS # 1172684
- Misc. Signalization - EDMS # 1172685
- Misc. Signalization - EDMS # 1172686
- Misc. Signalization - EDMS # 1172687
- Misc. Signalization - EDMS # 1172688
- Misc. Signalization - EDMS # 1172689
- Misc. Signalization - EDMS # 1172690
- Misc. Signalization - EDMS # 1172691
- Misc. Signalization - EDMS # 1172692
- Misc. Signalization - EDMS # 1172693
- Misc. Signalization - EDMS # 1172694
- Misc. Signalization - EDMS # 1172695
- Misc. Signalization - EDMS # 1172696
- Misc. Signalization - EDMS # 1172697
- Misc. Signalization - EDMS # 1172698
- Misc. Signalization - EDMS # 1172699
- Misc. Signalization - EDMS # 1172700
- Misc. Signalization - EDMS # 1172701
- Misc. Signalization - EDMS # 1172702
- Misc. Signalization - EDMS # 1172703
- Misc. Signalization - EDMS # 1172704
- Misc. Signalization - EDMS # 1172705
- Misc. Signalization - EDMS # 1172706
- Misc. Signalization - EDMS # 1172707
- Misc. Signalization - EDMS # 1172708
- Misc. Signalization - EDMS # 1172709
- Misc. Signalization - EDMS # 1172710
- Misc. Signalization - EDMS # 1172711
- Misc. Signalization - EDMS # 1172712
- Misc. Signalization - EDMS # 1172713
- Misc. Signalization - EDMS # 1172714
- Misc. Signalization - EDMS # 1172715
- Misc. Signalization - EDMS # 1172716
- Misc. Signalization - EDMS # 1172717
- Misc. Signalization - EDMS # 1172718
- Misc. Signalization - EDMS # 1172719
- Misc. Signalization - EDMS # 1172720
- Misc. Signalization - EDMS # 1172721
- Misc. Signalization - EDMS # 1172722
- Misc. Signalization - EDMS # 1172723
- Misc. Signalization - EDMS # 1172724
- Misc. Signalization - EDMS # 1172725
- Misc. Signalization - EDMS # 1172726
- Misc. Signalization - EDMS # 1172727
- Misc. Signalization - EDMS # 1172728
- Misc. Signalization - EDMS # 1172729
- Misc. Signalization - EDMS # 1172730
- Misc. Signalization - EDMS # 1172731
- Misc. Signalization - EDMS # 1172732
- Misc. Signalization - EDMS # 1172733
- Misc. Signalization - EDMS # 1172734
- Misc. Signalization - EDMS # 1172735
- Misc. Signalization - EDMS # 1172736
- Misc. Signalization - EDMS # 1172737
- Misc. Signalization - EDMS # 1172738
- Misc. Signalization - EDMS # 1172739
- Misc. Signalization - EDMS # 1172740
- Misc. Signalization - EDMS # 1172741
- Misc. Signalization - EDMS # 1172742
- Misc. Signalization - EDMS # 1172743
- Misc. Signalization - EDMS # 1172744
- Misc. Signalization - EDMS # 1172745
- Misc. Signalization - EDMS # 1172746
- Misc. Signalization - EDMS # 1172747
- Misc. Signalization - EDMS # 1172748
- Misc. Signalization - EDMS # 1172749
- Misc. Signalization - EDMS # 1172750
- Misc. Signalization - EDMS # 1172751
- Misc. Signalization - EDMS # 1172752
- Misc. Signalization - EDMS # 1172753
- Misc. Signalization - EDMS # 1172754
- Misc. Signalization - EDMS # 1172755
- Misc. Signalization - EDMS # 1172756
- Misc. Signalization - EDMS # 1172757
- Misc. Signalization - EDMS # 1172758
- Misc. Signalization - EDMS # 1172759
- Misc. Signalization - EDMS # 1172760
- Misc. Signalization - EDMS # 1172761
- Misc. Signalization - EDMS # 1172762
- Misc. Signalization - EDMS # 1172763
- Misc. Signalization - EDMS # 1172764
- Misc. Signalization - EDMS # 1172765
- Misc. Signalization - EDMS # 1172766
- Misc. Signalization - EDMS # 1172767
- Misc. Signalization - EDMS # 1172768
- Misc. Signalization - EDMS # 1172769
- Misc. Signalization - EDMS # 1172770
- Misc. Signalization - EDMS # 1172771
- Misc. Signalization - EDMS # 1172772
- Misc. Signalization - EDMS # 1172773
- Misc. Signalization - EDMS # 1172774
- Misc. Signalization - EDMS # 1172775
- Misc. Signalization - EDMS # 1172776
- Misc. Signalization - EDMS # 1172777
- Misc. Signalization - EDMS # 1172778
- Misc. Signalization - EDMS # 1172779
- Misc. Signalization - EDMS # 1172780
- Misc. Signalization - EDMS # 1172781
- Misc. Signalization - EDMS # 1172782
- Misc. Signalization - EDMS # 1172783
- Misc. Signalization - EDMS # 1172784
- Misc. Signalization - EDMS # 1172785
- Misc. Signalization - EDMS # 1172786
- Misc. Signalization - EDMS # 1172787
- Misc. Signalization - EDMS # 1172788
- Misc. Signalization - EDMS # 1172789
- Misc. Signalization - EDMS # 1172790
- Misc. Signalization - EDMS # 1172791
- Misc. Signalization - EDMS # 1172792
- Misc. Signalization - EDMS # 1172793
- Misc. Signalization - EDMS # 1172794
- Misc. Signalization - EDMS # 1172795
- Misc. Signalization - EDMS # 1172796
- Misc. Signalization - EDMS # 1172797
- Misc. Signalization - EDMS # 1172798
- Misc. Signalization - EDMS # 1172799
- Misc. Signalization - EDMS # 1172800
- Misc. Signalization - EDMS # 1172801
- Misc. Signalization - EDMS # 1172802
- Misc. Signalization - EDMS # 1172803
- Misc. Signalization - EDMS # 1172804
- Misc. Signalization - EDMS # 1172805
- Misc. Signalization - EDMS # 1172806
- Misc. Signalization - EDMS # 1172807
- Misc. Signalization - EDMS # 1172808
- Misc. Signalization - EDMS # 1172809
- Misc. Signalization - EDMS # 1172810
- Misc. Signalization - EDMS # 1172811
- Misc. Signalization - EDMS # 1172812
- Misc. Signalization - EDMS # 1172813
- Misc. Signalization - EDMS # 1172814
- Misc. Signalization - EDMS # 1172815
- Misc. Signalization - EDMS # 1172816
- Misc. Signalization - EDMS # 1172817
- Misc. Signalization - EDMS # 1172818
- Misc. Signalization - EDMS # 1172819
- Misc. Signalization - EDMS # 1172820
- Misc. Signalization - EDMS # 1172821
- Misc. Signalization - EDMS # 1172822
- Misc. Signalization - EDMS # 1172823
- Misc. Signalization - EDMS # 1172824
- Misc. Signalization - EDMS # 1172825
- Misc. Signalization - EDMS # 1172826
- Misc. Signalization - EDMS # 1172827
- Misc. Signalization - EDMS # 1172828
- Misc. Signalization - EDMS # 1172829
- Misc. Signalization - EDMS # 1172830
- Misc. Signalization - EDMS # 1172831
- Misc. Signalization - EDMS # 1172832
- Misc. Signalization - EDMS # 1172833
- Misc. Signalization - EDMS # 1172834
- Misc. Signalization - EDMS # 1172835
- Misc. Signalization - EDMS # 1172836
- Misc. Signalization - EDMS # 1172837
- Misc. Signalization - EDMS # 1172838
- Misc. Signalization - EDMS # 1172839
- Misc. Signalization - EDMS # 1172840
- Misc. Signalization - EDMS # 1172841
- Misc. Signalization - EDMS # 1172842
- Misc. Signalization - EDMS # 1172843
- Misc. Signalization - EDMS # 1172844
- Misc. Signalization - EDMS # 1172845
- Misc. Signalization - EDMS # 1172846
- Misc. Signalization - EDMS # 1172847
- Misc. Signalization - EDMS # 1172848
- Misc. Signalization - EDMS # 1172849
- Misc. Signalization - EDMS # 1172850
- Misc. Signalization - EDMS # 1172851
- Misc. Signalization - EDMS # 1172852
- Misc. Signalization - EDMS # 1172853
- Misc. Signalization - EDMS # 1172854
- Misc. Signalization - EDMS # 1172855
- Misc. Signalization - EDMS # 1172856
- Misc. Signalization - EDMS # 1172857
- Misc. Signalization - EDMS # 1172858
- Misc. Signalization - EDMS # 1172859
- Misc. Signalization - EDMS # 1172860
- Misc. Signalization - EDMS # 1172861
- Misc. Signalization - EDMS # 1172862
- Misc. Signalization - EDMS # 1172863
- Misc. Signalization - EDMS # 1172864
- Misc. Signalization - EDMS # 1172865
- Misc. Signalization - EDMS # 1172866
- Misc. Signalization - EDMS # 1172867
- Misc. Signalization - EDMS # 1172868
- Misc. Signalization - EDMS # 1172869
- Misc. Signalization - EDMS # 1172870
- Misc. Signalization - EDMS # 1172871
- Misc. Signalization - EDMS # 1172872
- Misc. Signalization - EDMS # 1172873
- Misc. Signalization - EDMS # 1172874
- Misc. Signalization - EDMS # 1172875
- Misc. Signalization - EDMS # 1172876
- Misc. Signalization - EDMS # 1172877
- Misc. Signalization - EDMS # 1172878
- Misc. Signalization - EDMS # 1172879
- Misc. Signalization - EDMS # 1172880
- Misc. Signalization - EDMS # 1172881
- Misc. Signalization - EDMS # 1172882
- Misc. Signalization - EDMS # 1172883
- Misc. Signalization - EDMS # 1172884
- Misc. Signalization - EDMS # 1172885
- Misc. Signalization - EDMS # 1172886
- Misc. Signalization - EDMS # 1172887
- Misc. Signalization - EDMS # 1172888
- Misc. Signalization - EDMS # 1172889
- Misc. Signalization - EDMS # 1172890
- Misc. Signalization - EDMS # 1172891
- Misc. Signalization - EDMS # 1172892
- Misc. Signalization - EDMS # 1172893
- Misc. Signalization - EDMS # 1172894
- Misc. Signalization - EDMS # 1172895
- Misc. Signalization - EDMS # 1172896
- Misc. Signalization - EDMS # 1172897
- Misc. Signalization - EDMS # 1172898
- Misc. Signalization - EDMS # 1172899
- Misc. Signalization - EDMS # 1172900
- Misc. Signalization - EDMS # 1172901
- Misc. Signalization - EDMS # 1172902
- Misc. Signalization - EDMS # 1172903
- Misc. Signalization - EDMS # 1172904
- Misc. Signalization - EDMS # 1172905
- Misc. Signalization - EDMS # 1172906
- Misc. Signalization - EDMS # 1172907
- Misc. Signalization - EDMS # 1172908
- Misc. Signalization - EDMS # 1172909
- Misc. Signalization - EDMS # 1172910
- Misc. Signalization - EDMS # 1172911
- Misc. Signalization - EDMS # 1172912
- Misc. Signalization - EDMS # 1172913
- Misc. Signalization - EDMS # 1172914
- Misc. Signalization - EDMS # 1172915
- Misc. Signalization - EDMS # 1172916
- Misc. Signalization - EDMS # 1172917
- Misc. Signalization - EDMS # 1172918
- Misc. Signalization - EDMS # 1172919
- Misc. Signalization - EDMS # 1172920
- Misc. Signalization - EDMS # 1172921
- Misc. Signalization - EDMS # 1172922
- Misc. Signalization - EDMS # 1172923
- Misc. Signalization - EDMS # 1172924
- Misc. Signalization - EDMS # 1172925
- Misc. Signalization - EDMS # 1172926
- Misc. Signalization - EDMS # 1172927
- Misc. Signalization - EDMS # 1172928
- Misc. Signalization - EDMS # 1172929
- Misc. Signalization - EDMS # 1172930
- Misc. Signalization - EDMS # 1172931
- Misc. Signalization - EDMS # 1172932
- Misc. Signalization - EDMS # 1172933
- Misc. Signalization - EDMS # 1172934
- Misc. Signalization - EDMS # 1172935
- Misc. Signalization - EDMS # 1172936
- Misc. Signalization - EDMS # 1172937
- Misc. Signalization - EDMS # 1172938
- Misc. Signalization - EDMS # 1172939
- Misc. Signalization - EDMS # 1172940
- Misc. Signalization - EDMS # 1172941
- Misc. Signalization - EDMS # 1172942
- Misc. Signalization - EDMS # 1172943
- Misc. Signalization - EDMS # 1172944
- Misc. Signalization - EDMS # 1172945
- Misc. Signalization - EDMS # 1172946
- Misc. Signalization - EDMS # 1172947
- Misc. Signalization - EDMS # 1172948
- Misc. Signalization - EDMS # 1172949
- Misc. Signalization - EDMS # 1172950
- Misc. Signalization - EDMS # 1172951
- Misc. Signalization - EDMS # 1172952
- Misc. Signalization - EDMS # 1172953
- Misc. Signalization - EDMS # 1172954
- Misc. Signalization - EDMS # 1172955
- Misc. Signalization - EDMS # 1172956
- Misc. Signalization - EDMS # 1172957
- Misc. Signalization - EDMS # 1172958
- Misc. Signalization - EDMS # 1172959
- Misc. Signalization - EDMS # 1172960
- Misc. Signalization - EDMS # 1172961
- Misc. Signalization - EDMS # 1172962
- Misc. Signalization - EDMS # 1172963
- Misc. Signalization - EDMS # 1172964
- Misc. Signalization - EDMS # 1172965
- Misc. Signalization - EDMS # 1172966
- Misc. Signalization - EDMS # 1172967
- Misc. Signalization - EDMS # 1172968
- Misc. Signalization - EDMS # 1172969
- Misc. Signalization - EDMS # 1172970
- Misc. Signalization - EDMS # 1172971
- Misc. Signalization - EDMS # 1172972
- Misc. Signalization - EDMS # 1172973
- Misc. Signalization - EDMS # 1172974
- Misc. Signalization - EDMS # 1172975
- Misc. Signalization - EDMS # 1172976
- Misc. Signalization - EDMS # 1172977
- Misc. Signalization - EDMS # 1172978
- Misc. Signalization - EDMS # 1172979
- Misc. Signalization - EDMS # 1172980
- Misc. Signalization - EDMS # 1172981
- Misc. Signalization - EDMS # 1172982
- Misc. Signalization - EDMS # 1172983
- Misc. Signalization - EDMS # 1172984
- Misc. Signalization - EDMS # 1172985
- Misc. Signalization - EDMS # 1172986
- Misc. Signalization - EDMS # 1172987
- Misc. Signalization - EDMS # 1172988
- Misc. Signalization - EDMS # 1172989
- Misc. Signalization - EDMS # 1172990
- Misc. Signalization - EDMS # 1172991
- Misc. Signalization - EDMS # 1172992
- Misc. Signalization - EDMS # 1172993
- Misc. Signalization - EDMS # 1172994
- Misc. Signalization - EDMS # 1172995
- Misc. Signalization - EDMS # 1172996
- Misc. Signalization - EDMS # 1172997
- Misc. Signalization - EDMS # 1172998
- Misc. Signalization - EDMS # 1172999
- Misc. Signalization - EDMS # 1173000

INDEX OF ROADWAY PLANS

- 1 SHEET NO.
- 2 KEY SHEET
- 3 SIGNATURE SHEET
- 4 SIGNATURE SHEET
- 5 SUMMARY OF PAY ITEMS
- 6 TYPICAL SECTION
- 7 TYPICAL SECTION DETAILS
- 8 SUMMARY OF QUANTITIES
- 9 SUMMARY OF DRAINAGE STRUCTURES
- 10 OPTIONAL MATERIALS TABULATION
- 11 PROJECT LAYOUT
- 12 PROJECT NOTES
- 13 ROADWAY PLAN
- 14-51 DRAINAGE STRUCTURES
- 52-56 SPECIAL DETAILS
- 57 STORMWATER POLLUTION PREVENTION
- 58-59 TEMPORARY TRAFFIC CONTROL PLAN
- 60-72 TREE DISPOSITION PLAN
- 73 SUMMARY OF VERIFIED UTILITIES
- 74 PROJECT SURVEY CONTROL
- CTL-1 - CTL-6

LIST OF REVISED INDEX DRAWINGS

- INDEX NO.
- 412 1 of 5
- 600 ALL
- 603 ALL
- 607 ALL
- 619 ALL
- 11200 3 of 3
- 11860 4 of 8
- 11862 ALL
- 17302 ALL
- 17346 1-2 of 14
- 17347 ALL

GOVERNING STANDARDS AND SPECIFICATIONS:

Florida Department of Transportation, 2015 Design Standards and Revised Index Drawings as appended herein, and July 2015 Standard Specifications for Road and Bridge Construction, as amended by Contract Documents.

For Design Standards click on the "Design Standards" link at the following web site:

<http://www.dot.state.fl.us/design/>

For the Standard Specifications for Road and Bridge Construction click on the "Specifications" link at the following web site:

<http://www.dot.state.fl.us/specifications/draft/>

REVISED:

- 1. 2A, 3, 4, 50-1, 50-5, 50-7, 50-13, 50-14, 50-15, 50-23, 50-28, 9, 40, 43, 44, 54
- 2. 5-2, 5-3, 5-4, 5-5, 5-33, 5-34, 5-35, 5-36

- 1. 2B, 3, 4, 50-16, 50-23, 50-26, 50-29, 50-30, 50-33, 14, 17-40, 43-51
- 2. 5-4, 5-5, 5-29

- 1. 2C, 4
- 2. 5-2, 5-8, 5-10, 5-12, 5-13, 5-15

- 1. 2D, 4, 5, 6
- 2. 5-2, 5-5, 5-7, 5-8, 5-9, 5-10, 5-11, 5-12, 5-13, 5-14

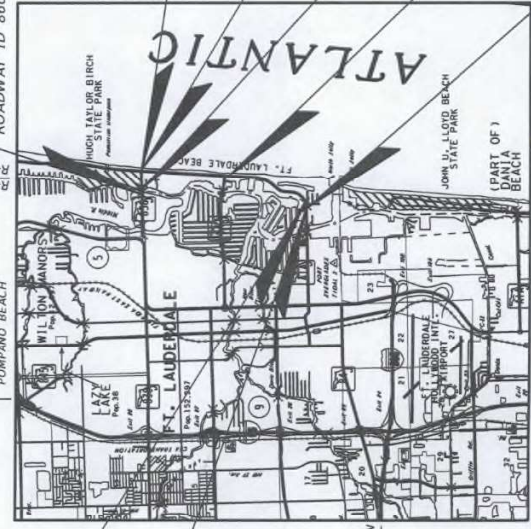

ROADWAY SHOP DRAWINGS TO BE SUBMITTED TO: KIMLEY-HORN AND ASSOCIATES, INC. 1690 SOUTH CONGRESS AVENUE DELRAY BEACH, FLORIDA 33445

PLANS PREPARED BY: KIMLEY-HORN AND ASSOCIATES, INC. CONSULTING ENGINEERS AND PLANNERS 1690 SOUTH CONGRESS AVENUE DELRAY BEACH, FLORIDA 33445

PHONE (561) 330-2345 FAX (561) 330-2346 VENDOR NUMBER 0885615-001 CERTIFICATE OF AUTHORIZATION NO. 696

NOTE: THIS PROJECT TO BE LET TO CONTRACT FOR FINANCIAL PURPOSES ONLY

NOTE: THE SCALE OF THESE PLANS MAY HAVE CHANGED DUE TO REPRODUCTION.

Contractor: Weckley Asphalt Paving, Inc.
Consultant: AE Engineering, Inc.
District Secretary: Gerry O'Reilly, P.E.
Resident Engineer: Rodrick Myrick, P.E.
Project Administrator: David Schwager, P.E.
Date Work Started: 4/20/2016
Date Final Accepted: 6/2/2017

DATE	DESCRIPTION
4/20/2016	ADDED SIGNATURE SHEET 2A
5/9/2016	ADDED SIGNATURE SHEET 2B
5/9/2016	ADDED SIGNATURE SHEET 2C
10/17/2016	ADDED SIGNATURE SHEET 2D

ROADWAY	LINEAR FEET	MILES
ROADWAY	20,613.60	3.904
BRIDGES	522.24	0.099
NET LENGTH OF PROJECT	20,136.06	4.003
EXCEPTIONS		
GROSS LENGTH OF PROJECT	20,136.06	4.003

FDOT PROJECT MANAGER: ANSON SONNETT, P.E.

ROADWAY PLANS ENGINEER OF RECORD: MARWAN MUELEH, P.E.
P.E. NO.: 45329

FISCAL YEAR	SHEET NO.
16	1

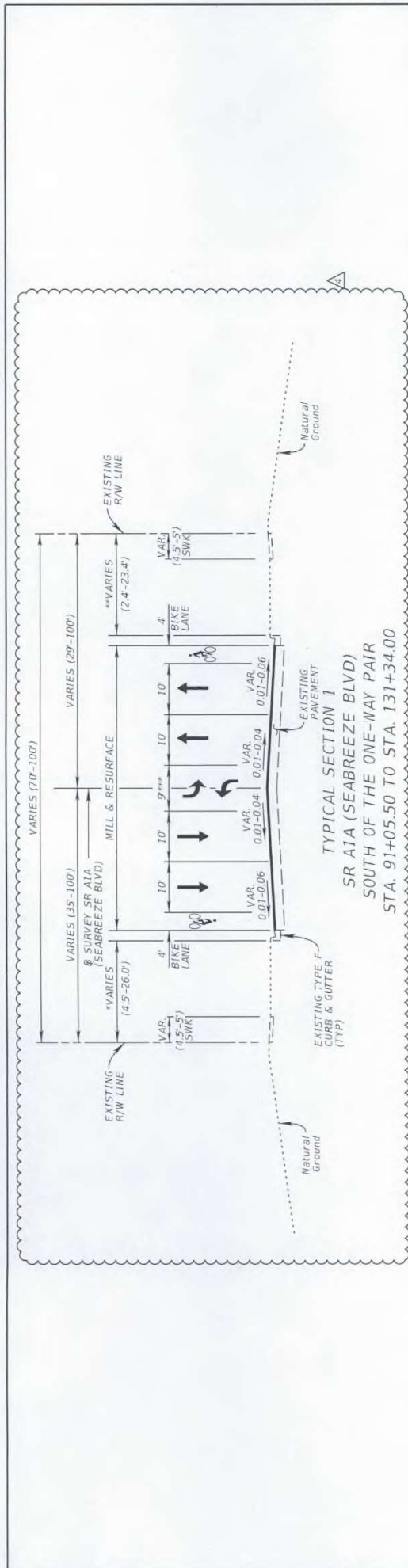

TYPICAL SECTION I
SR A1A (SEABREEZE BLVD)
SOUTH OF THE ONE-WAY PAIR
STA. 91+05.50 TO STA. 131+34.00

PAVEMENT DESIGN

- ****MILLING (MAINLINE)
- MILL EXISTING ASPHALT PAVEMENT (2.0 IN. AVG DEPTH)
- ****RESURFACING (MAINLINE)
- TYPE SP STRUCTURAL COURSE (TRAFFIC C) (1.0")
- FRICITION COURSE, TRAFFIC C, FC-9.5 (1.0") PG 76-22, ARB
- WIDENING
- OPTIONAL BASE GROUP 15 (B - 12.5 ONLY)
- TYPE SP STRUCTURAL COURSE (TRAFFIC C) (2.5")
- FRICITION COURSE, TRAFFIC C, FC-9.5 (1.0") PG 76-22, ARB

TRAFFIC DATA
 = 2014 ADOT = 30,600
 = 2016 ADOT = 30,700
 ESTIMATED OPENING YEAR = 2035 ADOT = 28,200
 K = 9.0%, D = 55.0%, T = 3.5% (24 HOUR)
 DESIGN SPEED = 35 MPH
 POSTED SPEED = 35 MPH

**** = BRIDGE BEHINDS EAST APPROACH SIARS
 MILL EXISTING ASPHALT PAVEMENT (1.0 IN. AVG DEPTH)
 RESURFACING FRICITION COURSE, TRAFFIC C, FC-9.5 (1.0") PG 76-22, ARB

- *: 4.5' From Sta. 96+38.78 to Sta. 122+10.14
- 21.5' From Sta. 122+10.14 to Sta. 134+35.10
- ** 2.4' at Sta. 129+33.50
- 4.5' From Sta. 96+38.78 to Sta. 118+77.50
- 21.5' From Sta. 118+77.50 to Sta. 134+35.10
- ***: 10' From Sta. 131+34.00 to Sta. 134+35.10
- 5' From Sta. 134+35.10 to Sta. 143+94.98 to Sta. 148+87.10

Notes: Concrete sidewalk unless noted otherwise in the plan.

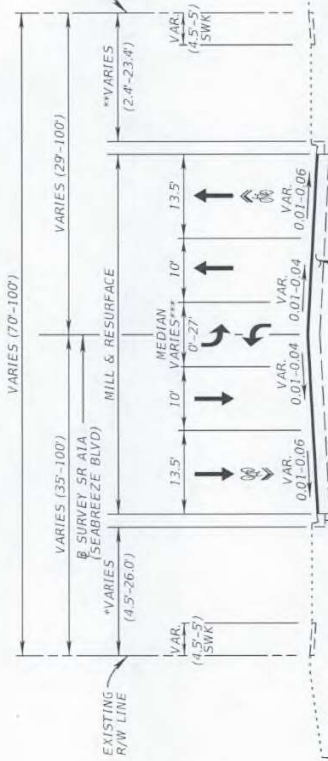

TYPICAL SECTION 1A
SR A1A (SEABREEZE BLVD)
SOUTH OF THE ONE-WAY PAIR
STA. 131+34.00 TO STA. 149+15.38



SR A1A WIDENING DETAIL (STA. 92+27 TO 94+66)
(N.T.S.)

DATE	DESCRIPTION	REVISIONS	DATE	DESCRIPTION
10/12/16	ADDED TYPICAL SECTION 1A, REMOVED PREVIOUS TYPICAL SECTION 1A AND REVISED BOTH TO DEPICT FROM MAYAN DRIVE TO HARBOR DRIVE FROM MAYAN DRIVE TO HARBOR DRIVE MOVED TYPICAL SECTION 2 TO SHEET 6			

KIMLEY-HORN AND ASSOCIATES, INC. Certificate of Authorization No. 086 BARBARA W. MCLENN, P.E. P.E. License No. 45329 1690 South Congress Avenue Delray Beach, Florida 33445		STATE OF FLORIDA DEPARTMENT OF TRANSPORTATION FINANCIAL PROJECT ID	430601-1-52-01
RD NO.	COUNTY	CITY	
A1A	BROWARD		

SHEET NO.	5
-----------	---

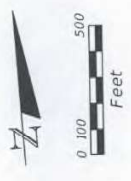
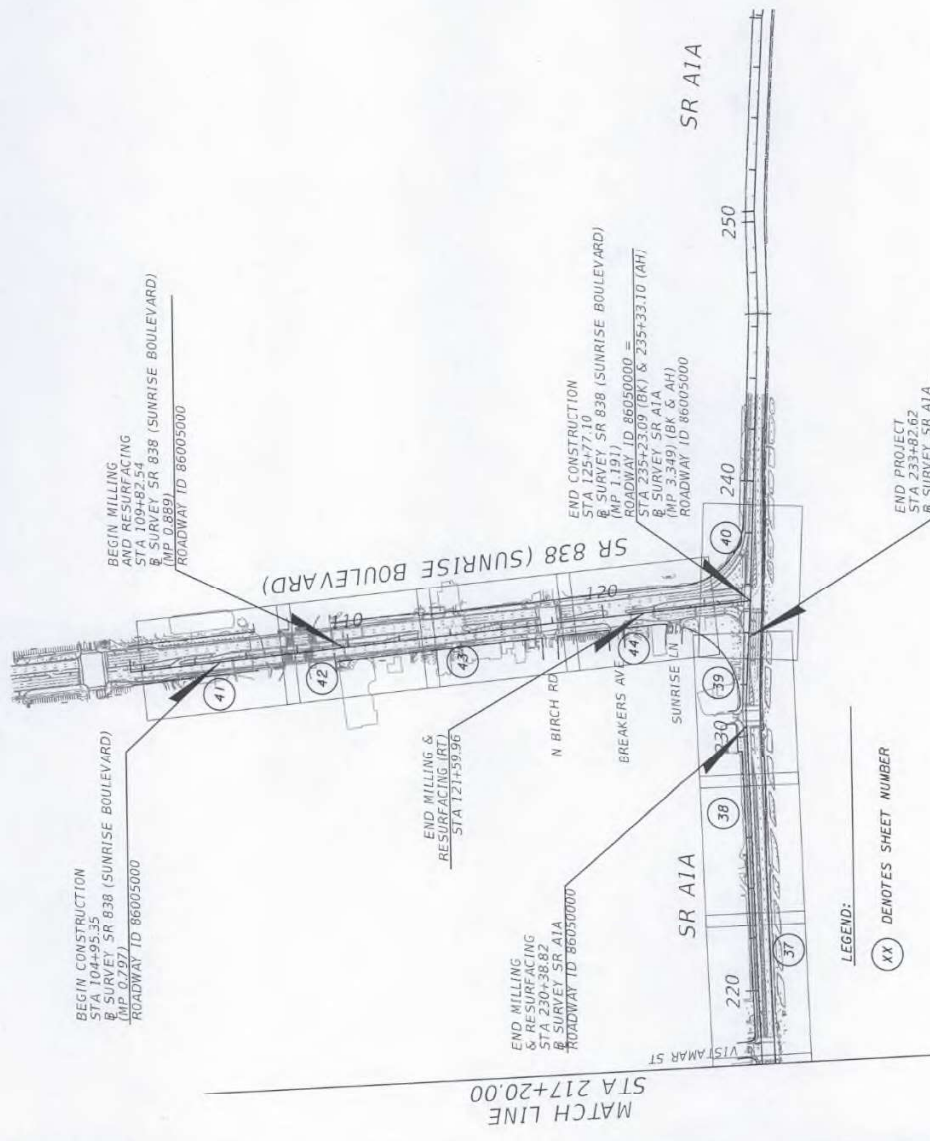

DATE	DESCRIPTION	REVISIONS	DATE	DESCRIPTION

STATE OF FLORIDA		DEPARTMENT OF TRANSPORTATION	
ROAD NO.	COUNTY	FINANCIAL PROJECT ID	
A1A	BROWARD	430601-1-52-01	

KIMLEY-HORN AND ASSOCIATES, INC.	
Certificate of Authorization No. 686	
MARWAN MUELEH, P.E.	
P.E. License No. 45329	
Suite 100	
6500 Cypress Avenue	
Delray Beach, Florida 33445	

7/15/2015	7:53:25 PM	E:\BCD_Roadway\040005003_SR\A1A_FTL_SR\04000115201\04000115201.dwg
-----------	------------	--

PROJECT LAYOUT

SHEET NO. 12

LEGEND:
 (XX) DENOTES SHEET NUMBER

MATCH LINE
 STA 217+20.00

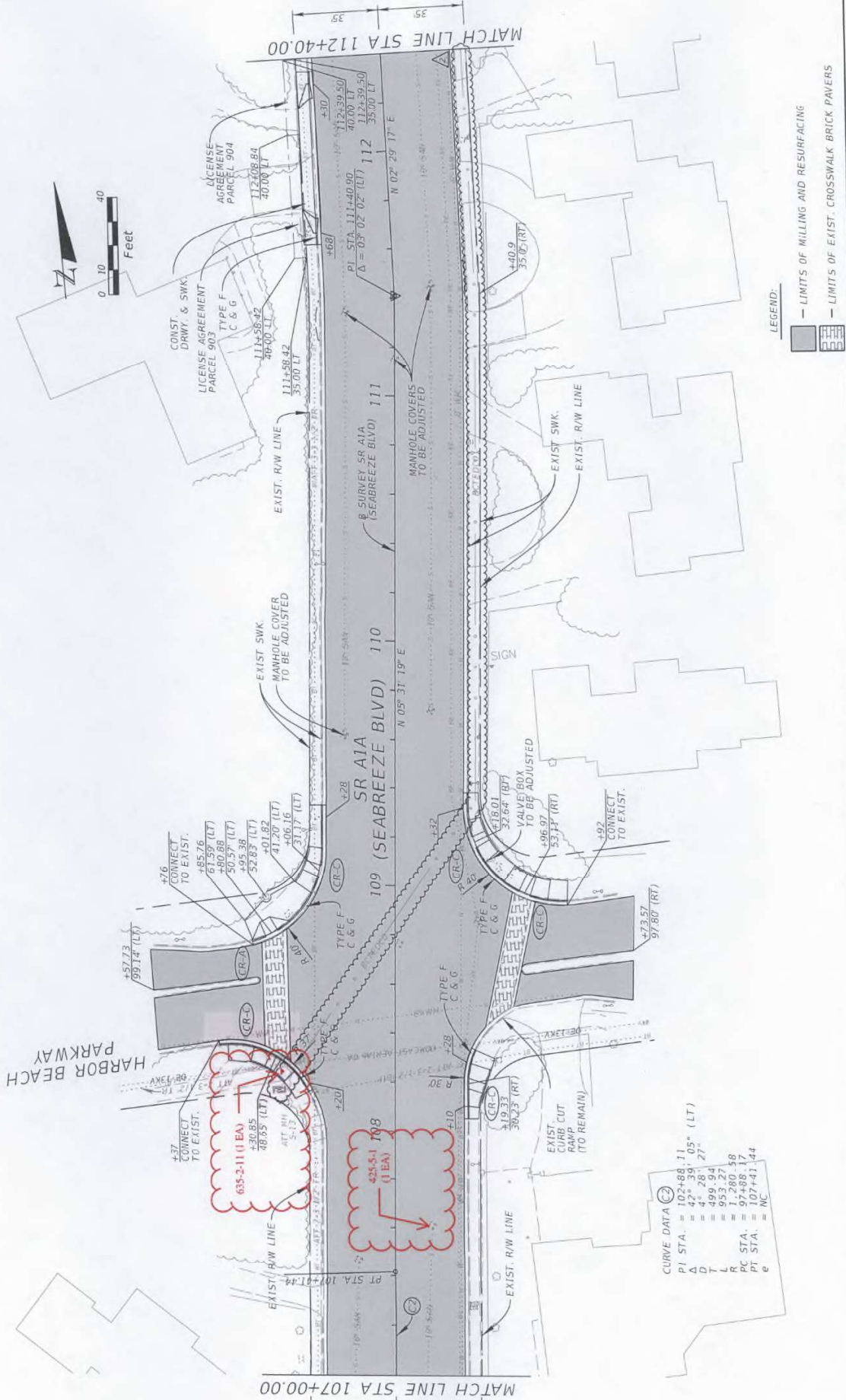

LEGEND:
 [Symbol] — LIMITS OF MILLING AND RESURFACING
 [Symbol] — LIMITS OF EXIST. CROSSWALK BRICK PAVERS

DATE	DESCRIPTION	DATE	DESCRIPTION
5/9/16	ADDED EXISTING BROWARD COUNTY INTERCONNECT CABLE		
	Final As-Built		

KIMLEY-HORN AND ASSOCIATES, INC. Certificate of Authorization No. 686 MARWAN M. FLETA, P.E. License No. 45325 Suite 100 8650 South Bay Blvd. Boca Raton, Florida 33445		STATE OF FLORIDA DEPARTMENT OF TRANSPORTATION	SHEET NO. 17
ROAD NO. A1A	COUNTY BROWARD	FINANCIAL PROJECT ID 430601-1-52-01	

CURVE DATA
 PI STA. = 102+88.11
 Δ = 42° 39' 05" (LT)
 D = 4° 28' 27"
 L = 499.94
 PC STA. = 95+32.78
 PT STA. = 107+41.44
 e = NC

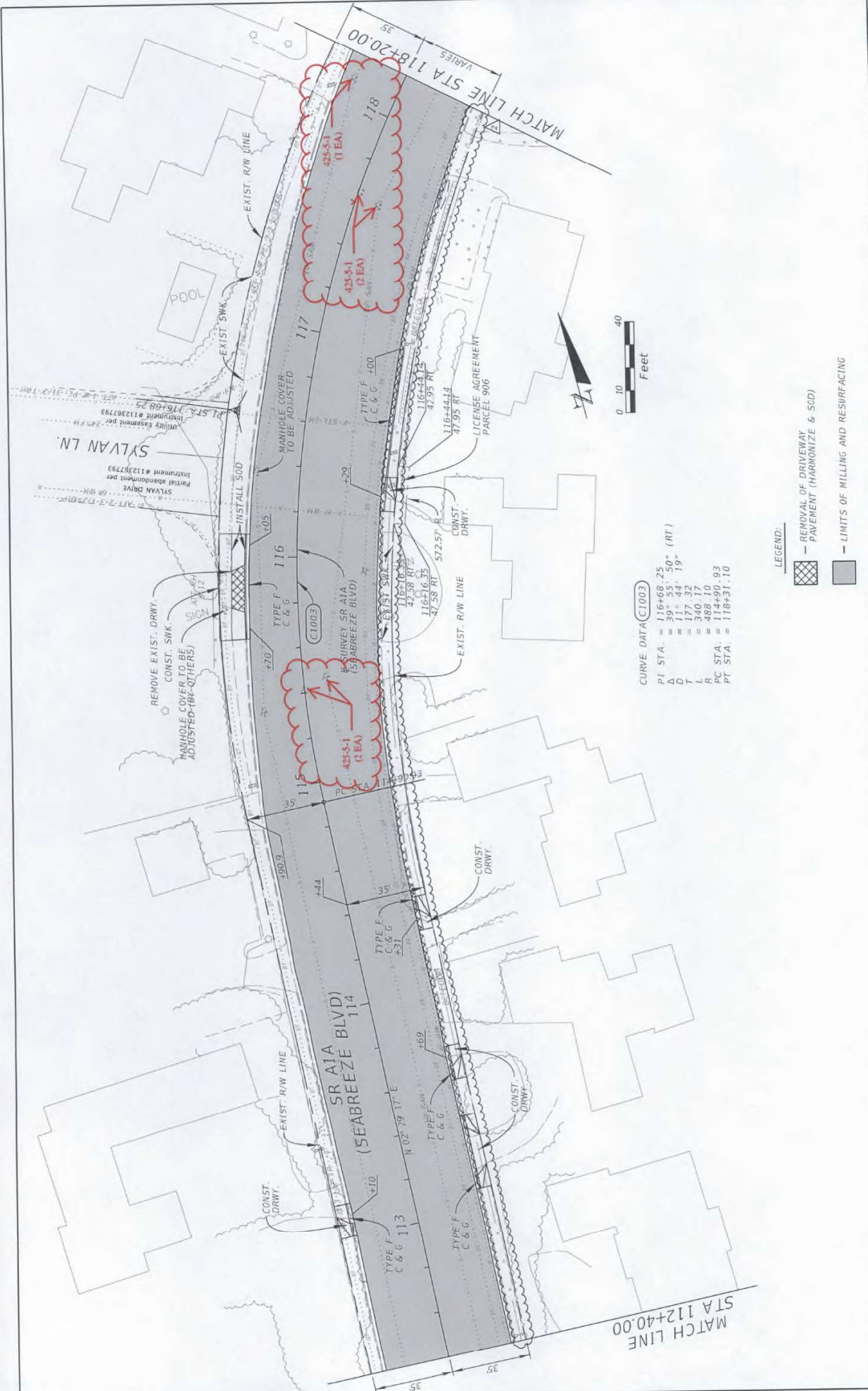

CURVE DATA (C1003)
 PI STA. = 116+68.25
 Δ = 39° 55' 50" (RT)
 D = 11° 44' 19"
 T = 177.32
 L = 388.10
 PC STA. = 114+90.93
 PT STA. = 118+31.10

- LEGEND:**
- REMOVAL OF DRIVEWAY PAVEMENT (HARMONIZE & S/D)
 - LIMITS OF MILLING AND RESURFACING

REVISIONS		DESCRIPTION
DATE	DESCRIPTION	DATE
5/9/16	ADDED EXISTING BROWARD COUNTY INTERCONNECT CABLE	
	A Final As-Built	

KIMLEY-HORN AND ASSOCIATES, INC. Certified by Registration No. 686 MARWAN M. FLEIN, P.E. P.E. License No. 45329 Suite 100 1650 South Andrews Avenue Fort Lauderdale, Florida 33445		STATE OF FLORIDA DEPARTMENT OF TRANSPORTATION
ROAD NO.	COUNTY	FINANCIAL PROJECT ID
A1A	BROWARD	430601-152-01

ROADWAY PLAN	
SHEET NO.	18

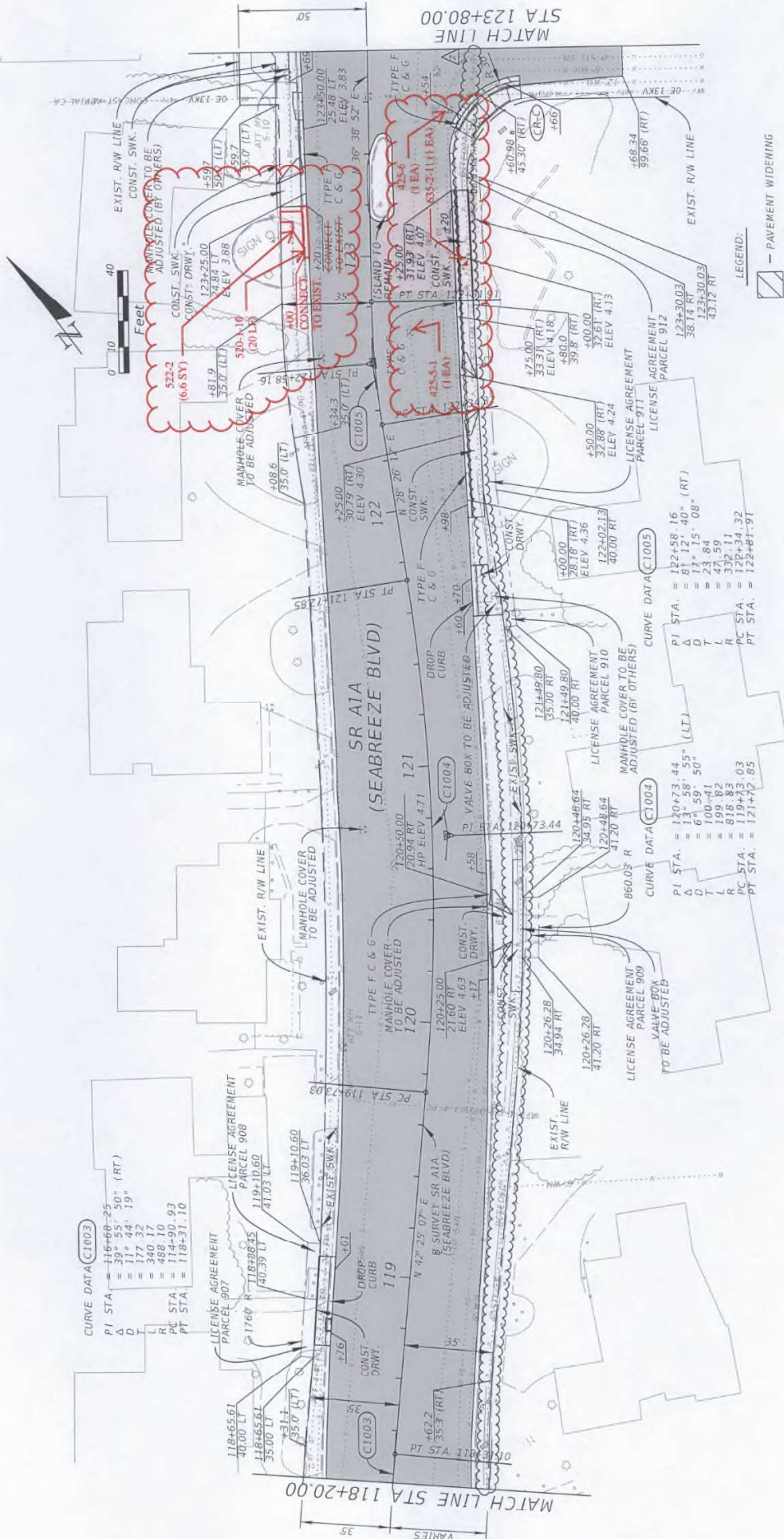

LEGEND:
 [Symbol] - PAVEMENT WIDENING
 [Symbol] - LIMITS OF MILLING AND RESURFACING

DATE		DESCRIPTION		REVISIONS		STATE OF FLORIDA	
DATE	DESCRIPTION	DATE	DESCRIPTION	ROAD NO.	COUNTY	FINANCIAL PROJECT ID	DEPARTMENT OF TRANSPORTATION
5/9/16	ADDED EXISTING BROWARD COUNTY INTERCONNECT CABLE			A1A	BROWARD	430601-1-52-01	
	Final As-Built						

KIMLEY-HORN AND ASSOCIATES, INC. Certificate of Authorization No. 686 P.E. License No. 45329 Suite 100 1650 South Congress Avenue Fort Lauderdale, Florida 33345	5/11/2016	Scan Submittal
---	-----------	----------------

ROADWAY PLAN

SHEET NO. 19

SPECIFIC PURPOSE SURVEY

SECTION 11, TOWNSHIP 50 SOUTH, RANGE 42 EAST
 SECTIONS 12 THROUGH 14, TOWNSHIP 50 SOUTH, RANGE 42 EAST
 SECTIONS 6 AND 7, TOWNSHIP 50 SOUTH, RANGE 43 EAST
 BROWARD COUNTY, FLORIDA

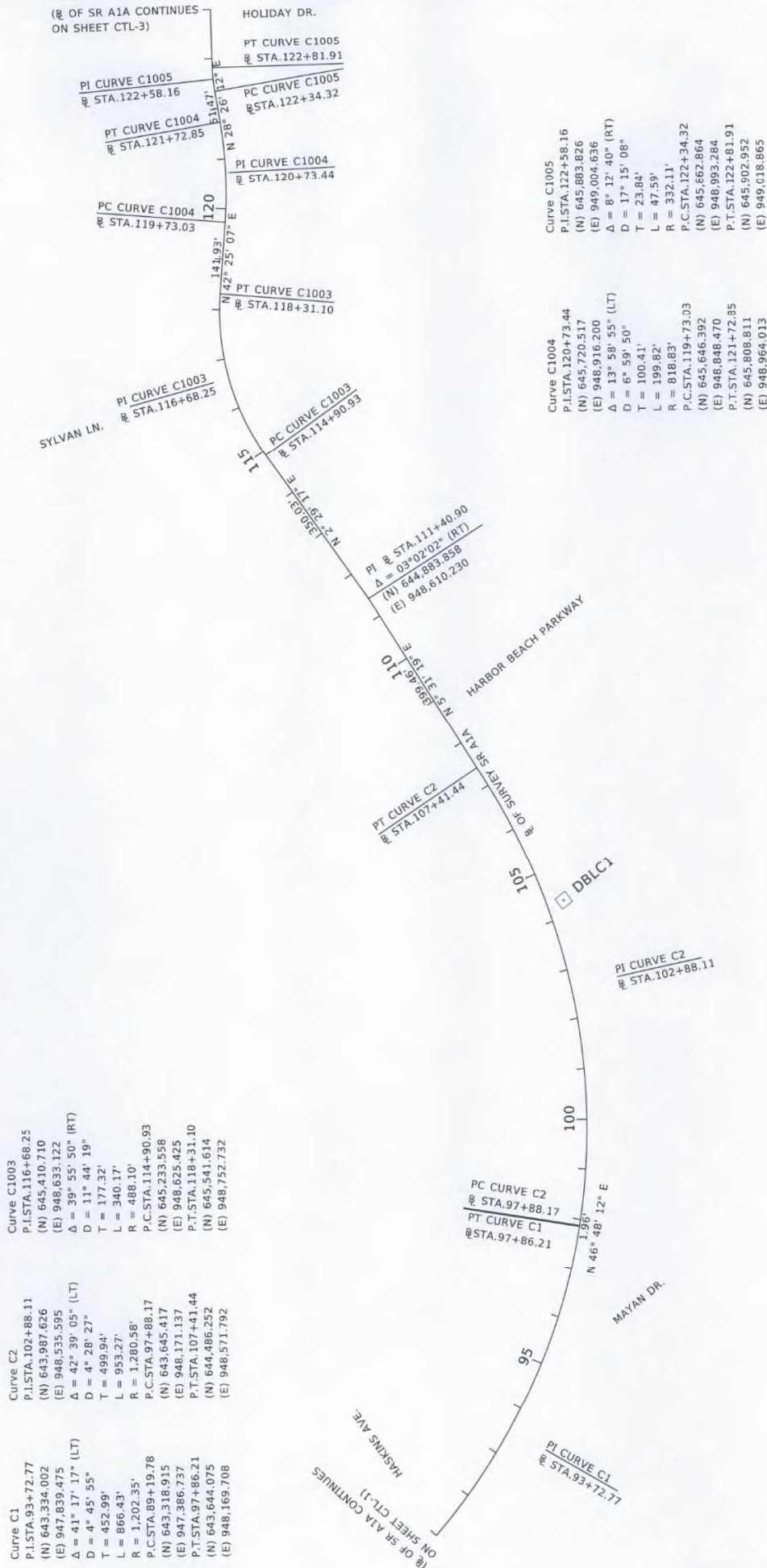

Curve C1	Curve C2	Curve C1003
P.I. STA. 93+72.77	P.I. STA. 102+88.11	P.I. STA. 116+68.25
(N) 643,334.002	(N) 643,897.626	(N) 645,410.710
(E) 947,839.475	(E) 948,535.595	(E) 948,633.122
$\Delta = 41^\circ 17' 17''$ (LT)	$\Delta = 42^\circ 39' 05''$ (LT)	$\Delta = 39^\circ 55' 50''$ (RT)
D = 4' 45' 55"	D = 4' 28' 27"	D = 11' 44' 19"
T = 452.99'	T = 499.94'	T = 177.32'
L = 866.43'	L = 953.27'	L = 340.17'
R = 1,202.35'	R = 1,280.58'	R = 488.10'
P.C. STA. 89+19.78	P.C. STA. 97+88.17	P.C. STA. 114+90.93
(N) 643,318.915	(N) 643,645.417	(N) 645,233.558
(E) 947,386.737	(E) 948,171.137	(E) 948,625.425
P.T. STA. 97+86.21	P.T. STA. 107+41.44	P.T. STA. 118+31.10
(N) 643,644.075	(N) 644,486.252	(N) 645,541.614
(E) 948,169.708	(E) 948,571.792	(E) 948,752.732

Curve C1004	Curve C1005
P.I. STA. 120+73.44	P.I. STA. 122+58.16
(N) 645,720.517	(N) 645,883.826
(E) 948,916.200	(E) 949,004.636
$\Delta = 13^\circ 58' 55''$ (LT)	$\Delta = 8^\circ 12' 40''$ (RT)
D = 6' 59' 50"	D = 17' 15' 08"
T = 100.41'	T = 23.84'
L = 199.82'	L = 47.59'
R = 818.83'	R = 332.11'
P.C. STA. 119+73.03	P.C. STA. 122+34.32
(N) 645,646.392	(N) 645,862.864
(E) 948,848.470	(E) 948,993.284
P.T. STA. 121+72.85	P.T. STA. 122+81.91
(N) 645,808.811	(N) 645,902.952
(E) 948,964.013	(E) 949,018.885

REVISIONS		REVISED		DESCRIPTION	
DATE	BY	DATE	BY	DESCRIPTION	DESCRIPTION

STATE OF FLORIDA		DEPARTMENT OF TRANSPORTATION	
ROAD NO.	A1A	COUNTY	BROWARD
FINANCIAL PROJECT ID		430601-1-52-01	

LEE POWERS, PSM	40174
SURVEYOR LICENSE NUMBER 6805	
KEITH AND ASSOCIATES, INC.	
301 E. ATLANTIC BOULEVARD	
POMPANO BEACH, FLORIDA 33060	
CERTIFICATE OF AUTHORIZATION NO. 6860	

PROJECT SURVEY CONTROL

SHEET NO. CTL-2

NOTICE: THE OFFICIAL RECORD OF THIS SHEET IS THE ELECTRONIC FILE SIGNED AND SEALED UNDER RULE 51-F-082, F.A.C.

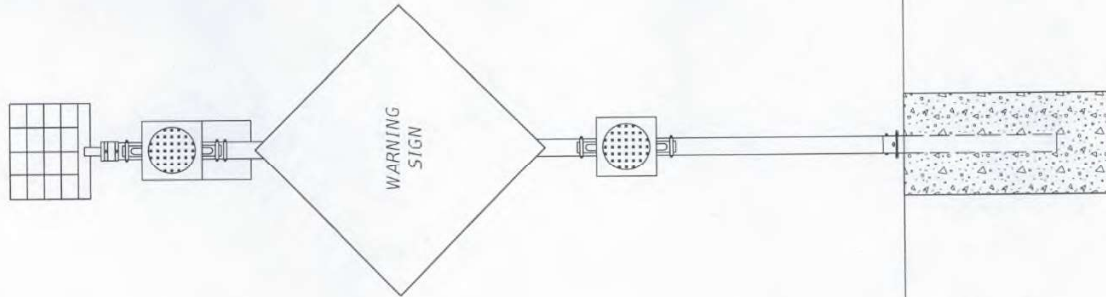
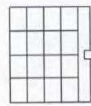

SOLAR POWERED BEACON

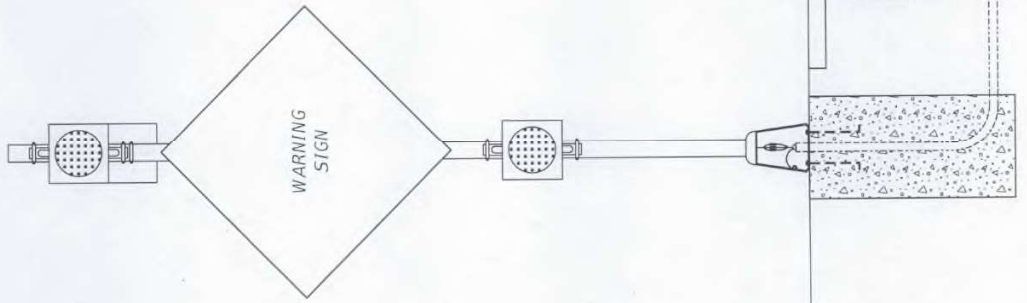

CONVENTIONAL POWERED BEACON

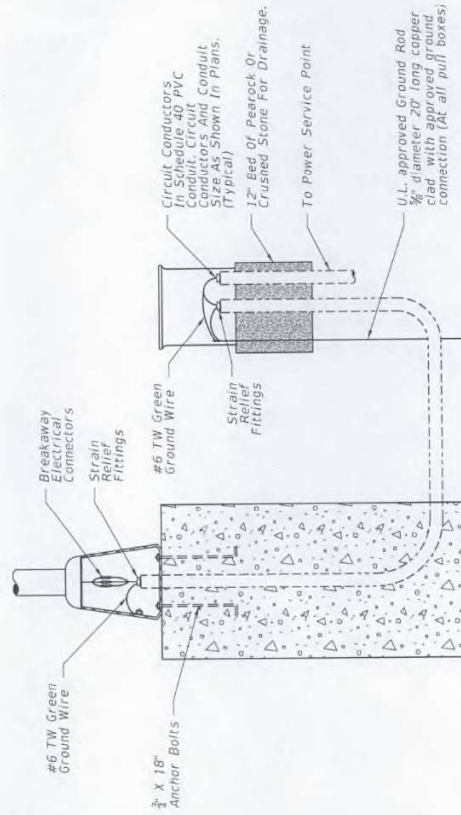

POLE WIRING DETAIL
CONVENTIONAL POWERED BEACON

GENERAL NOTES

1. ALUMINUM: Aluminum materials shall meet the requirements of Aluminum Association Alloy 6061-T6 (ASTM B209, B221, B308 or B429), except as noted.
2. Sign panel, wind beam and columns shall be installed in accordance with Index 11860 and Section 700 of the Specifications.
3. Height and offset to sign column shall be in accordance with Index 17302.
4. When aluminum column (posts) are installed with a frangible pedestal pole bases, engage all threads on the pedestal pole base and pipe unless the pipe is fully seated into base.
5. Pedestal bases shall meet the requirements of Section 646 of the Specifications.
6. A concrete slab shall be installed around all pull boxes. Minimum dimension of slab shall be 4'-0" by 4'-0". In urban areas where space is limited slab dimensions may be adjusted as shown in the plans.
7. A concrete slab shall be installed around all pull boxes. Minimum dimension of slab shall be 4'-0" by 4'-0". In urban areas where space is limited slab dimensions may be adjusted as shown in the plans.
8. For beacon assemblies connected to conventional power, provide single pole non-fused watertight breakaway electrical connectors in the frangible pedestal pole base.
9. Connection of controller, cabinet and solar panel to the column shall be in accordance with manufacturer's recommendations.
10. Holes drilled in sign column for wire entry shall use a bushing or rubber grommet to protect conductors.
11. Orient solar panel to face South for optimal exposure to sunlight.

LAST REVISION
12/15/14

DESCRIPTION:
Changed Anchor Bolt size to 1/8";
Changed Note #5 Specification reference.



2015
DESIGN STANDARDS

ROADSIDE FLASHING BEACON ASSEMBLY

INDEX NO.
11862

SHEET NO.
1 of 7

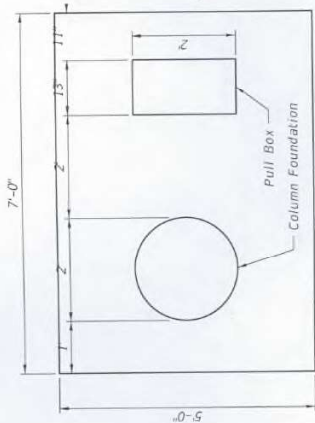

CONCRETE SLAB DETAIL

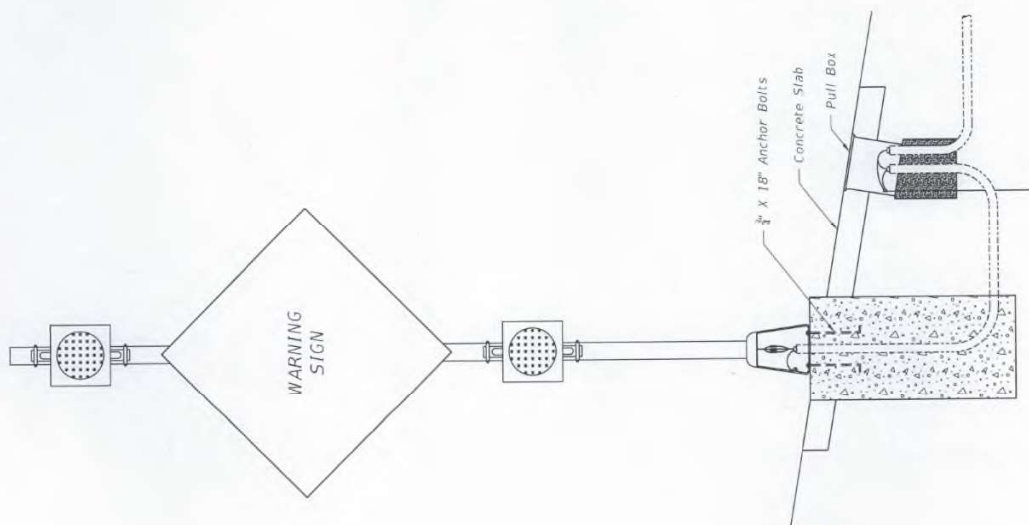
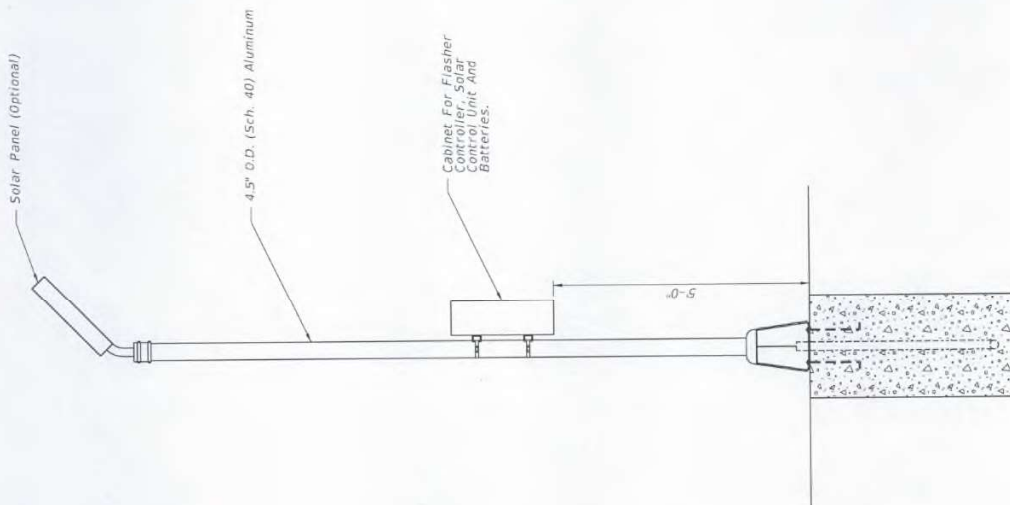

NOTES

1. All flashing beacon assemblies with solar panels, controllers and batteries weighing more than 170 lbs. shall utilize a separate pole for mounting the solar panel, controller and batteries.
2. The auxiliary pole shall be installed outside the recoverable terrain distance and as near the right of way as possible. The recoverable terrain distance shall comply with Design Standard Index 700.
3. Auxiliary pole shall be the same length as the column for the beacon assembly.
3. Payment for the separate pole, foundation, conduit and wiring shall be included in the cost of the electronic warning sign with flashing beacon.

SOLAR POWERED BEACON WITH AUXILIARY POLE FOR SOLAR PANEL, CONTROLLER AND BATTERIES

LAST REVISION 12/15/14	DESCRIPTION: Changed Anchor Bolt size to 18".	2015 DESIGN STANDARDS	ROADSIDE FLASHING BEACON ASSEMBLY	INDEX NO. 11862	SHEET NO. 2 of 7
---------------------------	--	--------------------------	-----------------------------------	--------------------	---------------------

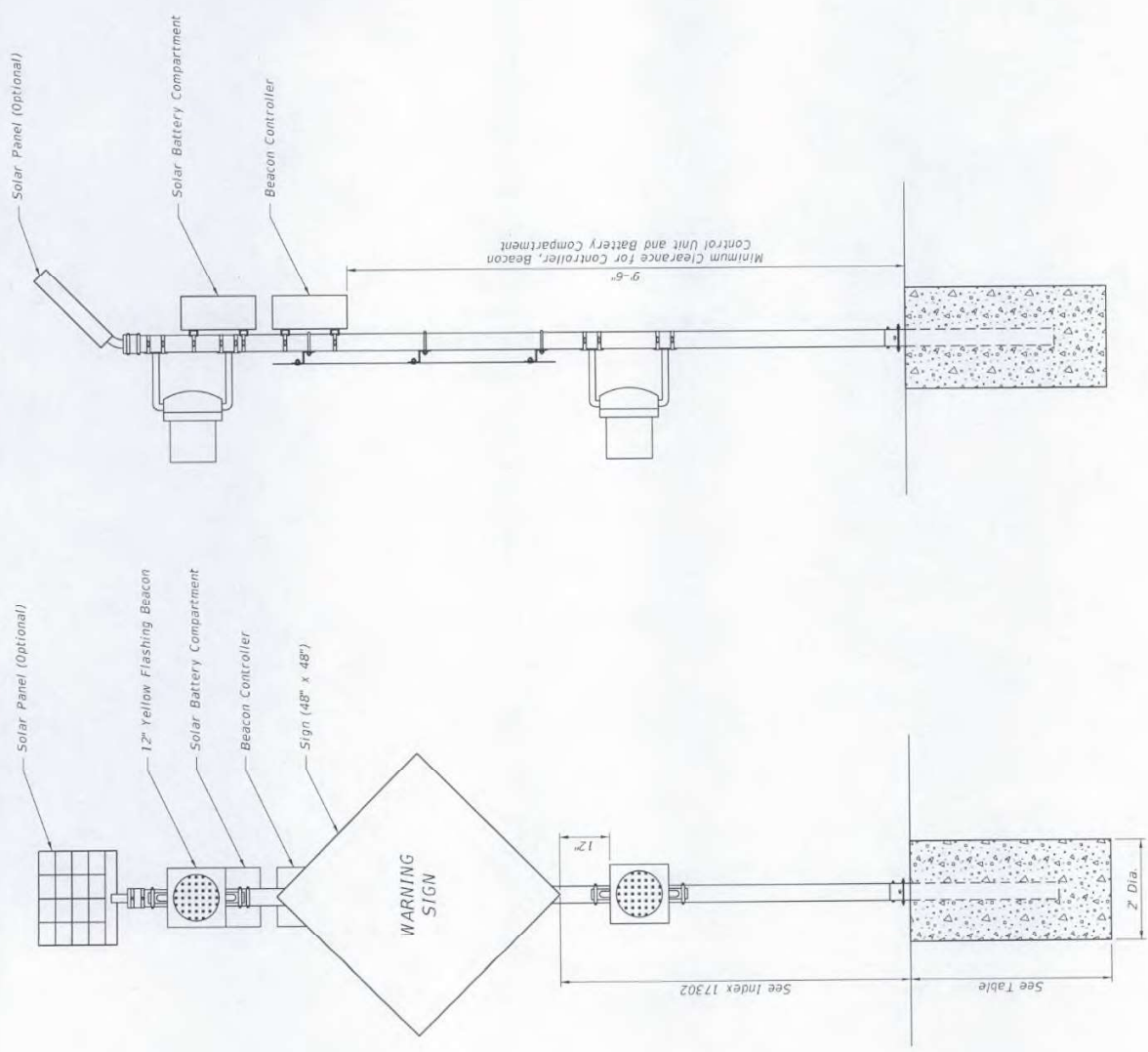

STANDARD WARNING SIGN COLUMN SIZE			
Wind Speed	Sign Height	Column Size	Footring Depth
110	7'	4"	4"
130	7'	4.5"	4"
150	7'	5"	4.5"
110	8.5'	4.5"	4"
130	8.5'	5"	4.5"
150	8.5'	6"	5"

NOTES

1. Details show a typical warning sign with two flashing beacon heads. When only one beacon is required, install upper beacon.
2. Sign column slip base shall be in accordance with Design Standard Index 11860.
3. Beacon and beacon controllers shall be listed on Approved Products List (APL).

SIDE VIEW

FRONT VIEW

<p>REVISION</p> <p>LAST REVISION 12/15/14</p>	<p>DESCRIPTION: Battery Compartment and Beacon Controller.</p>	<p>2015 DESIGN STANDARDS</p> <p>FDOT</p>	<p>ROADSIDE FLASHING BEACON ASSEMBLY</p> <p>SOLAR POWERED WARNING SIGN DETAILS</p>	<p>INDEX NO. 11862</p>	<p>SHEET NO. 3 of 7</p>
---	--	---	--	------------------------	-------------------------

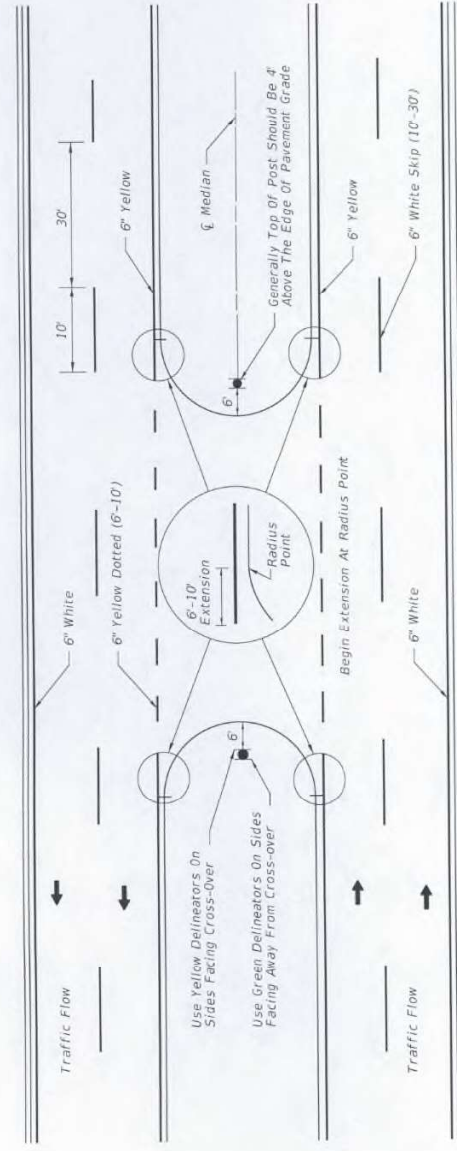

PAVEMENT MARKINGS AND DELINEATORS FOR MEDIAN CROSS-OVER

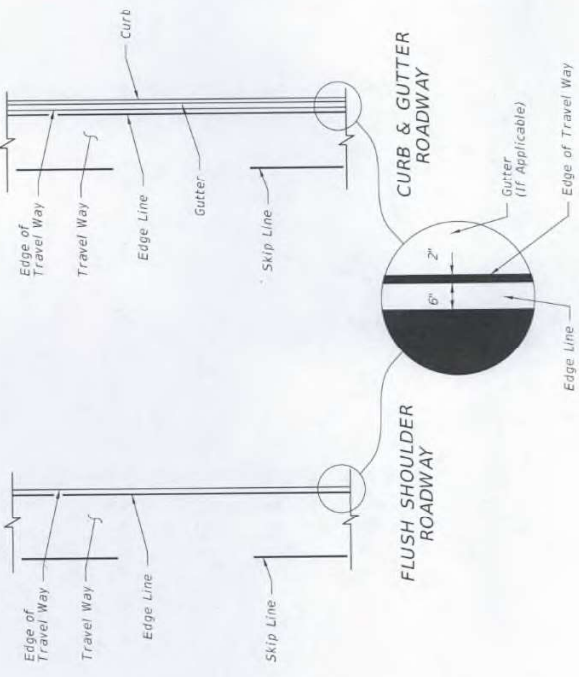

PLACEMENT OF EDGE LINES

NOTE: Markings applied to median noses shall be yellow in color.

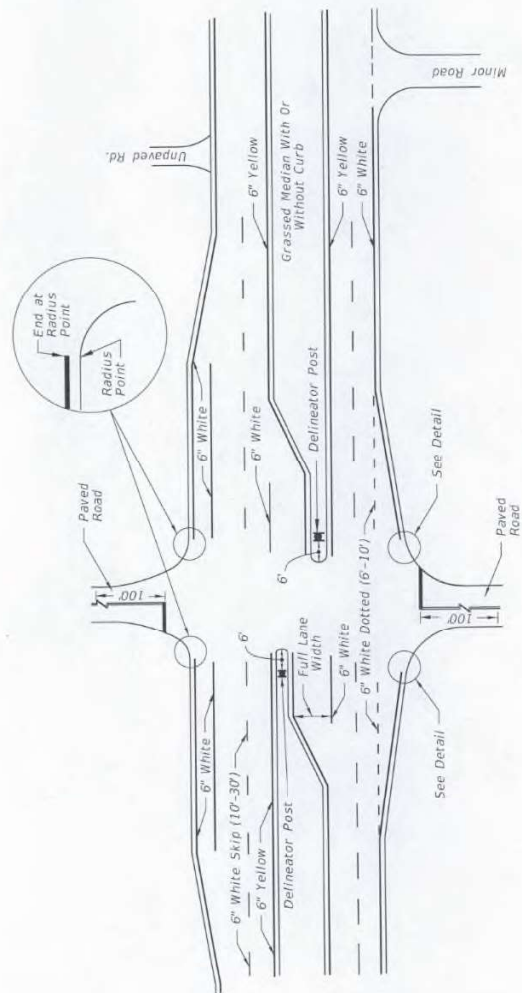

PAVEMENT MARKINGS FOR INTERSECTIONS WITH MAJOR AND MINOR ROADS



R3-4

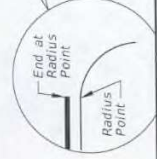

LAST REVISION 01/21/15	DESCRIPTION: Changed 6-10 Skip to 6-10 Dotted.	2015	INDEX NO. 17346	SHEET NO. 2 of 14
REVISION		DESIGN STANDARDS	SPECIAL MARKING AREAS	

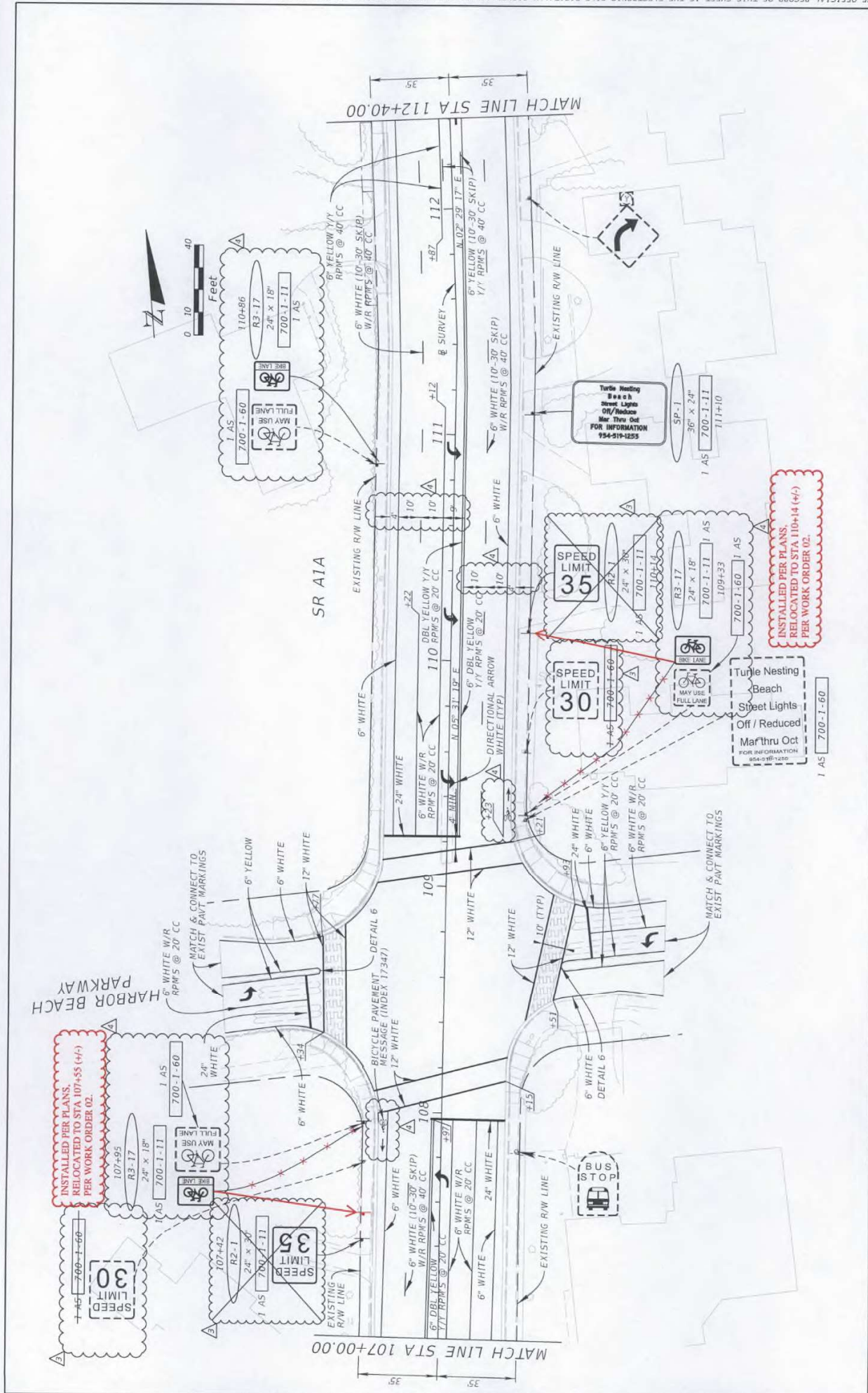

DATE	DESCRIPTION	REVISIONS	DESCRIPTION
6/27/16	REVISED SPEED LIMIT SIGNING	1	Final As-Built
10/12/16	ADDED DESIGNER PAVE LINES FROM MAYAN DRIVE TO HARBOR DRIVE	2	

STATE OF FLORIDA DEPARTMENT OF TRANSPORTATION		KIMLEY-HORN AND ASSOCIATES, INC. Certificate of Registration No. 686 MARWAN M. FLEH, P.E. P.E. License No. 45329 Suite 100 1690 South Beach Avenue Deer Beach, Florida 33445	
ROAD NO.	COUNTY	FINANCIAL PROJECT ID	
A1A	BROWARD	430601-1-52-01	

SHEET NO.	5-10
-----------	------

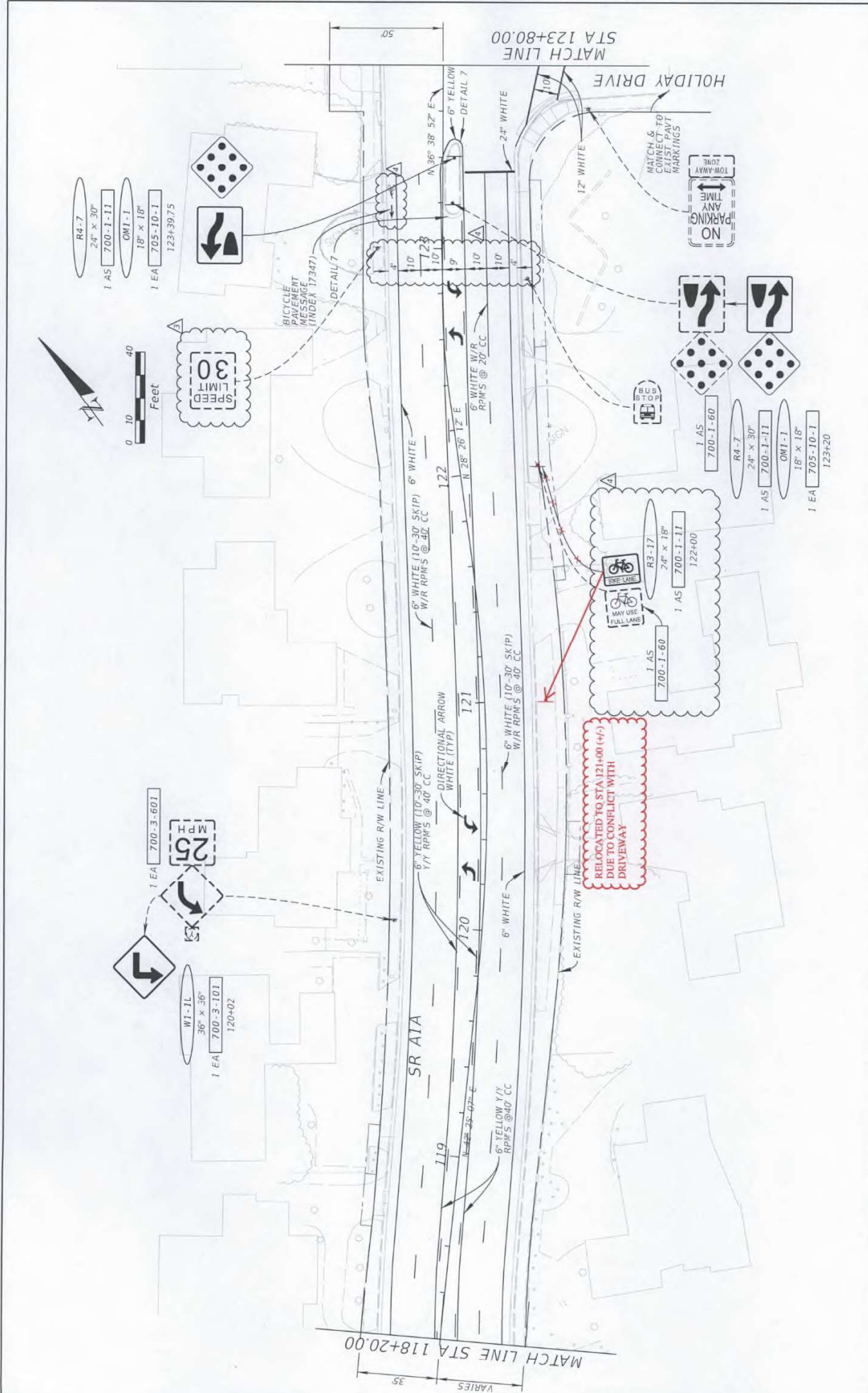

DATE	DESCRIPTION	REVISIONS	DATE	DESCRIPTION
6/27/16	REVISED SPEED LIMIT SIGNING			
10/12/16	ADDED DEDICATED BIKE LANES FROM MAPAN DRIVE TO HARBOR DRIVE			

KIMLEY-HORN AND ASSOCIATES, INC. Certificate of Authorization No. 656 P.E. License No. #5129 650 South Congress Avenue Delray Beach, Florida 33445		STATE OF FLORIDA DEPARTMENT OF TRANSPORTATION ROAD NO. A1A COUNTY BROWARD FINANCIAL PROJECT ID 430601-152-01
--	--	--

SIGNING AND PAVEMENT MARKING PLANS		SHEET NO. S-12
------------------------------------	--	----------------

10/20/2016 9:20:28 AM K:\E_Cad_Roadway\200005603_03R1A_7TC_03R200212502_rev3.dwg (plan) sheet1.dwg Scan Bureau

STATE OF FLORIDA
DEPARTMENT OF TRANSPORTATION
FINAL "AS-BUILT" PLANS
CONTRACT PLANS

FINANCIAL PROJECT ID 430601-1-52-01

BROWARD COUNTY (86180/86050/86005)

STATE ROAD NO. A1A
RESURFACING, RESTORATION & REHABILITATION
SR A1A EAST OF MERCEDES RIVER SMALL BRIDGE
TO SUNRISE BOULEVARD (SR 838)

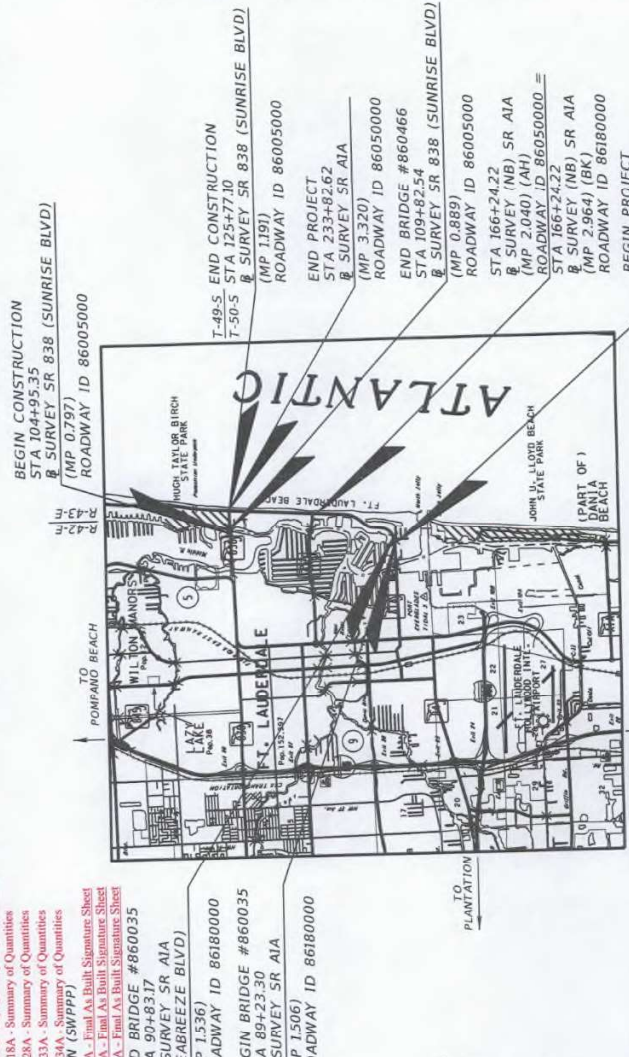
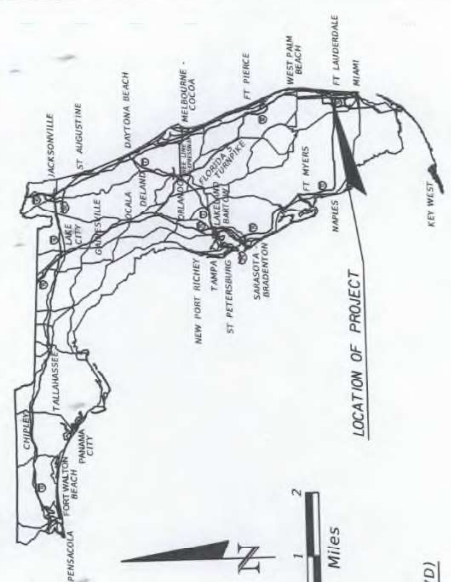

BEGIN CONSTRUCTION
STA 1044+95.35
SURVEY SR 838 (SUNRISE BLVD)
(MP 0.797)
ROADWAY ID 86005000

END PROJECT
STA 233+82.62
SURVEY SR A1A
(MP 3.320)
ROADWAY ID 86050000

END BRIDGE #860466
STA 109+82.54
SURVEY SR 838 (SUNRISE BLVD)
(MP 0.889)
ROADWAY ID 86005000

STA 166+24.22
SURVEY (NB) SR A1A
(MP 2.964) (BK)
ROADWAY ID 86180000

BEGIN PROJECT
STA 89+00.00
SURVEY SR A1A
(SEABREEZE BLVD)
(MP 1.501)
ROADWAY ID 86180000

NOTE: LENGTH OF PROJECT IS MEASURED USING CONSTRUCTION LIMITS DUE TO SIGNIFICANT AMOUNT OF ROADWAY WORK OUTSIDE PROJECT LIMITS.

LENGTH OF PROJECT	
LINEAR FEET	MILES
ROADWAY	20,613.60
BRIDGES	522.24
NET LENGTH OF PROJECT	4,003
EXCEPTIONS	20,136.06
GROSS LENGTH OF PROJECT	4,003

ANSON SONNETT, P.E.
FDOT PROJECT MANAGER:

COMPONENTS OF CONTRACT PLANS SET

- INDEX OF SHOP DRAWINGS:
- ROADWAY PLANS
- SIGNING AND PAVEMENT MARKING PLANS
- SIGNALIZATION PLANS
- LIGHTING
- UTILITIES
- STORMWATER POLLUTION PREVENTION PLAN
- TEMPORARY TRAFFIC CONTROL PLAN
- TREE DISPOSITION PLAN
- SUMMARY OF VERIFIED UTILITIES
- PROJECT SURVEY CONTROL
- CTL3 - CTL6

INDEX OF ROADWAY PLANS

- SHEET NO.
- KEY SHEET DESCRIPTION
- 1 KEY SHEET
- 2A, 2B, 2C, 2D SIGNATURE SHEET
- 3, 4 SIGNATURE OF PAY ITEMS
- 5, 6 TYPICAL SECTION
- 7 TYPICAL SECTION DETAILS
- 8 SUMMARY OF QUANTITIES
- 9 SUMMARY OF DRAINAGE STRUCTURES
- 10 OPTIONAL MATERIALS TABULATION
- 11 PROJECT LAYOUT
- 12 PROJECT NOTES
- 13 ROADWAY PLAN
- 14 DRAINAGE STRUCTURES
- 52-56 SPECIAL DETAILS
- 57 STORMWATER POLLUTION PREVENTION PLAN
- 58-59 TEMPORARY TRAFFIC CONTROL PLAN
- 60-72 TREE DISPOSITION PLAN
- 73 SUMMARY OF VERIFIED UTILITIES
- 74 PROJECT SURVEY CONTROL
- CTL3 - CTL6

LIST OF REVISED INDEX DRAWINGS

- INDEX NO.
- 412 1 of 5
- 600 ALL
- 603 ALL
- 607 ALL
- 619 ALL
- 11200 3 of 3
- 11860 4 of 8
- 11862 ALL
- 17302 ALL
- 17346 1-2 of 14
- 17347 ALL

GOVERNING STANDARDS AND SPECIFICATIONS:

Florida Department of Transportation, 2015 Design Standards and Revised Index Drawings as appended herein, and July 2015 Standard Specifications for Road and Bridge Construction, as amended by Contract Documents.

For Design Standards click on the "Design Standards" link at the following web site:
<http://www.dot.state.fl.us/rddesign/>

For the Standard Specifications for Road and Bridge Construction click on the "Specifications" link at the following web site:
<http://www.dot.state.fl.us/specifications/office/>

REVISIONS:
ROADWAY SHEETS (REVISED 4-20-16)
1, 2A, 3, 4, 50-1, 50-2, 50-3, 50-3A, 50-3B, 50-3C, 50-3D, 50-28, 9, 40, 43, 44, 54
SIGNING AND PAVEMENT MARKING SHEETS (REVISED 4-20-16)
5-2, 5-3, 5-4, 5-5, 5-6, 5-7, 5-8, 5-9, 5-10, 5-11, 5-12, 5-13, 5-14

ROADWAY SHEETS (REVISED 5-9-16)
1, 2B, 3, 4, 50-16, 50-23, 50-26, 50-29, 50-30, 50-33, 14, 17, 40, 43-51
SIGNING AND PAVEMENT MARKING SHEET (REVISED 5-9-16)
5-4, 5-5, 5-29
SIGNALIZATION SHEETS (REVISED 5-9-16)
1-6, 1-12, 1-13

ROADWAY SHEETS (REVISED 6-27-16)
1, 2C, 4
SIGNING AND PAVEMENT MARKING SHEET (REVISED 6-27-16)
5-2, 5-5, 5-8, 5-10, 5-12, 5-13, 5-15

ROADWAY SHEETS (REVISED 10-12-16)
1, 2D, 4, 5, 6
SIGNING AND PAVEMENT MARKING SHEET (REVISED 10-05-16)
5-2, 5-5, 5-7, 5-8, 5-9, 5-10, 5-11, 5-12, 5-13, 5-14

ROADWAY SHOP DRAWINGS TO BE SUBMITTED TO:
KIMLEY-HORN AND ASSOCIATES, INC.
MARWAN MUJIEH, P.E.
1050 SOUTH CONGRESS AVENUE
DELRAY BEACH, FLORIDA 33445

PLANS PREPARED BY:
KIMLEY-HORN AND ASSOCIATES, INC.
CONSULTING ENGINEERS AND PLANNERS
SUITE 100
1690 SOUTH CONGRESS AVENUE
DELRAY BEACH, FLORIDA 33445
PHONE (561) 330-2345
CONTRACT NO. C9990888501
VENDOR NUMBER: 0888501
CERTIFICATE OF AUTHORIZATION NO. 696

NOTE: THIS PROJECT TO BE LET TO CONTRACT WITH FINANCIAL PROJECT ID 30601-1-52-02 FOR FINANCIAL PURPOSES ONLY

NOTE: THE SCALE OF THESE PLANS MAY HAVE CHANGED DUE TO REPRODUCTION.

Contractor: **Weekley Asphalt Paving, Inc.**
Consultant: **AE Engineering, Inc.**
District Secretary: **Gerry O'Reilly, P.E.**
Resident Engineer: **Roderick Myrick, P.E.**
Project Manager: **David Schweiger, P.E.**
Project Administrator: **Eduardo Hernandez, P.E.**
Date Work Started: **4/20/2016**
Date Final Accepted: **6/22/2017**

ROADWAY PLANS ENGINEER OF RECORD: **MARWAN MUJIEH, P.E.**
P.E. NO.: **45329**

FISCAL YEAR	16	SHEET NO.	1
-------------	----	-----------	---

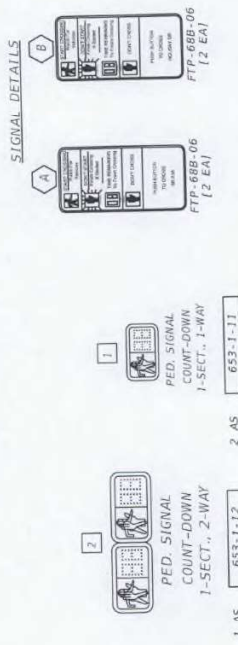
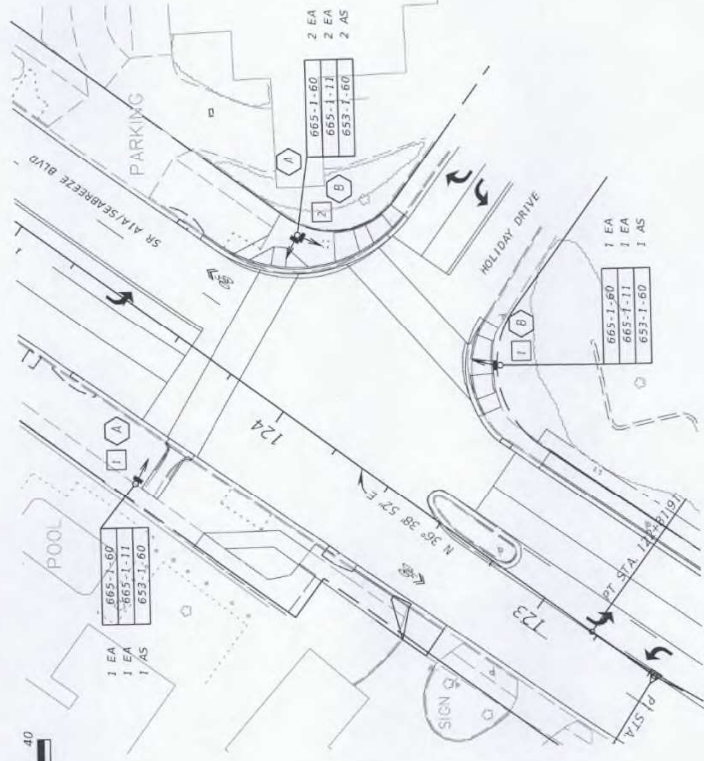
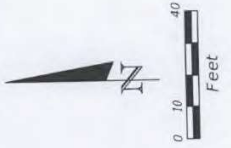
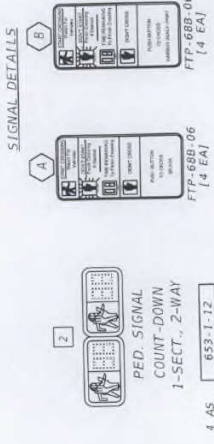
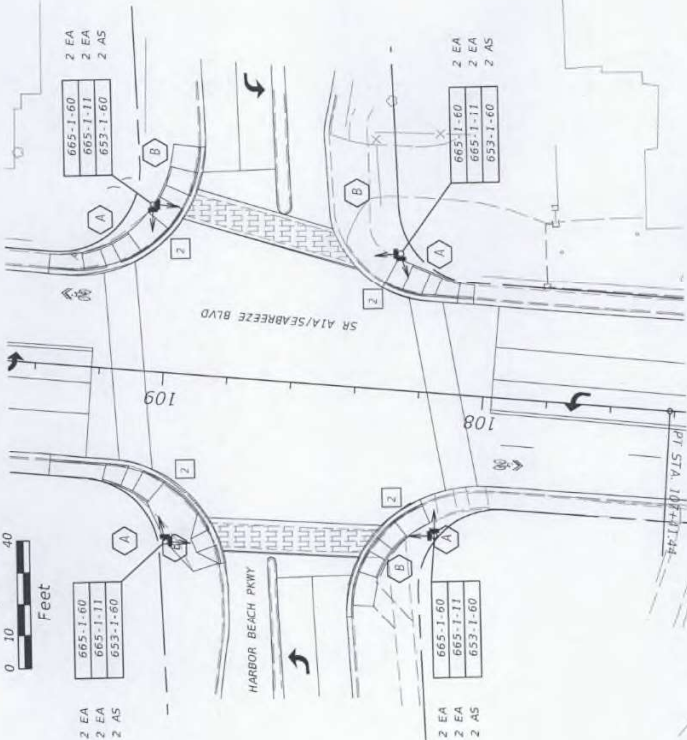
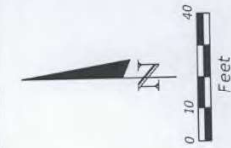

SR A1A / SEABREEZE BLVD & HARBOR BEACH PKWY

SR A1A / SEABREEZE BLVD & HOLIDAY DR

KIMLEY-HORN AND ASSOCIATES, INC.
 Certificate of Authorization No. 066
 P.E. License No. 45129
 1630 South Coastway, Suite 100
 Derry Beach, Florida 33495

DATE	DESCRIPTION	REVISIONS	DATE	DESCRIPTION

ROAD NO.	A1A	COUNTY	BROWARD
FINANCIAL PROJECT ID	430601-1-52-01		

SIGNALIZATION PLAN

SHEET NO. T-5

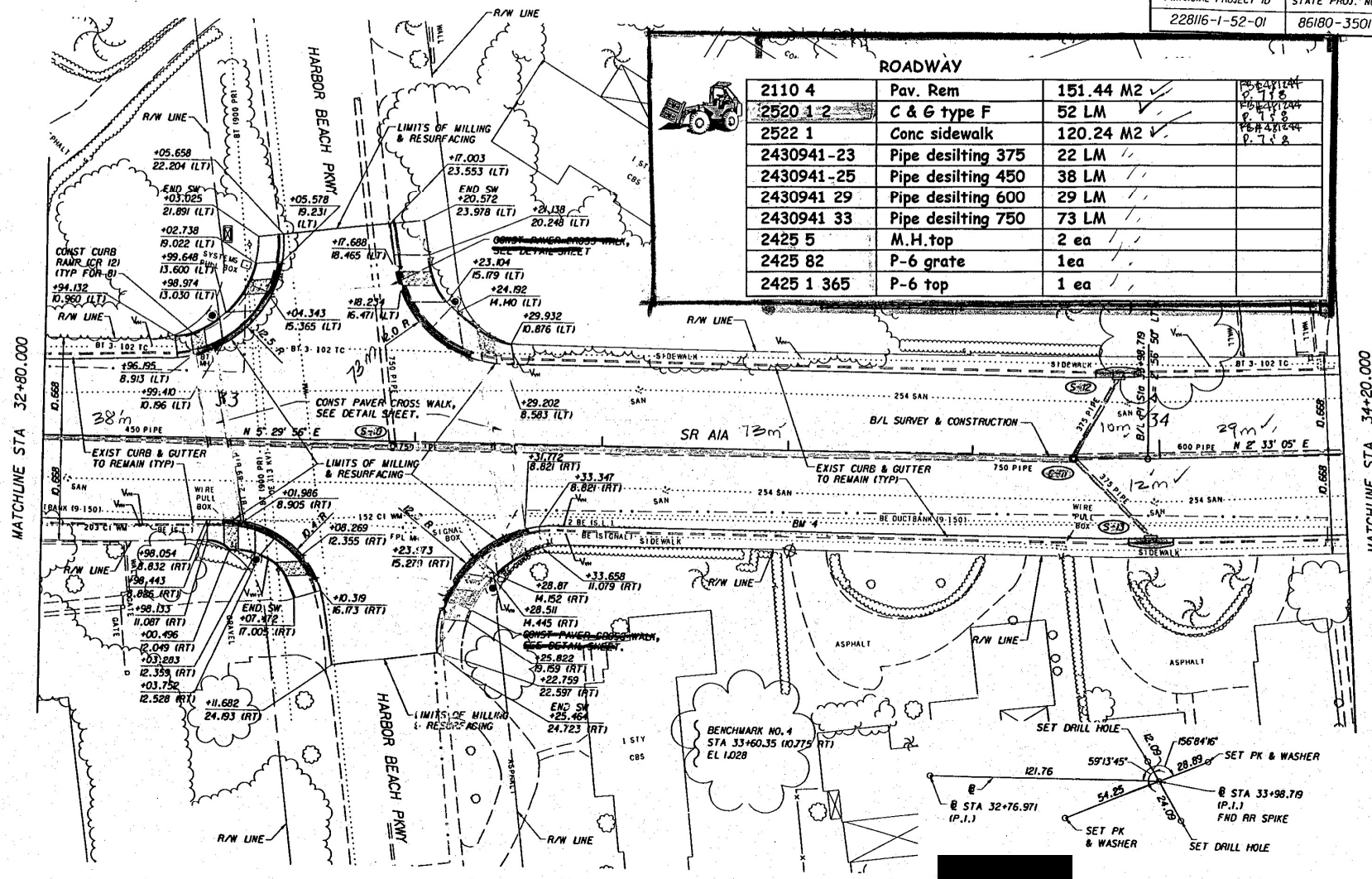

ROADWAY			
2110 4	Pav. Rem	151.44 M2	
2520 1 2	C & G type F	52 LM	
2522 1	Conc sidewalk	120.24 M2	
2430941-23	Pipe desilting 375	22 LM	
2430941-25	Pipe desilting 450	38 LM	
2430941 29	Pipe desilting 600	29 LM	
2430941 33	Pipe desilting 750	73 LM	
2425 5	M.H. top	2 ea	
2425 82	P-6 grate	1ea	
2425 1 365	P-6 top	1 ea	

MATCHLINE STA. 32+80.000

MATCHLINE STA. 34+20.000

NOTE: ALL PAVER CROSSWALKS AT THIS INTERSECTION ARE OF NEIGHBORHOOD PATTERN!

PROPOSED MAST ARM SIGNAL POLE LOCATION



REVISIONS					
DATE	BY	DESCRIPTION	DATE	BY	DESCRIPTION

Stanley Consultants INC.

STATE OF FLORIDA
DEPARTMENT OF TRANSPORTATION

ROADWAY PLAN SHEET

FINANCIAL PROJECT ID	STATE PROJ. NO.	SHEET NO.
228116-1-52-01	86180-3501	13

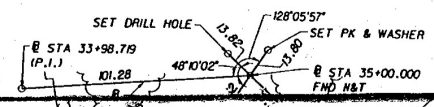

1:400

ROADWAY			REF.
2110 4	Pav. Rem	8.4 M2	FB 481244
2520 1 2	C & G type F	2.0 LMV	FB 481244
2520 2 3	Curb type D	0	FB 481244
2522 1	Conc sidewalk	7.2 M2	FB 481244
2430941-29	Pipe desilting 600	140 LM	P-9
2425 5	M.H. top	1 ea	

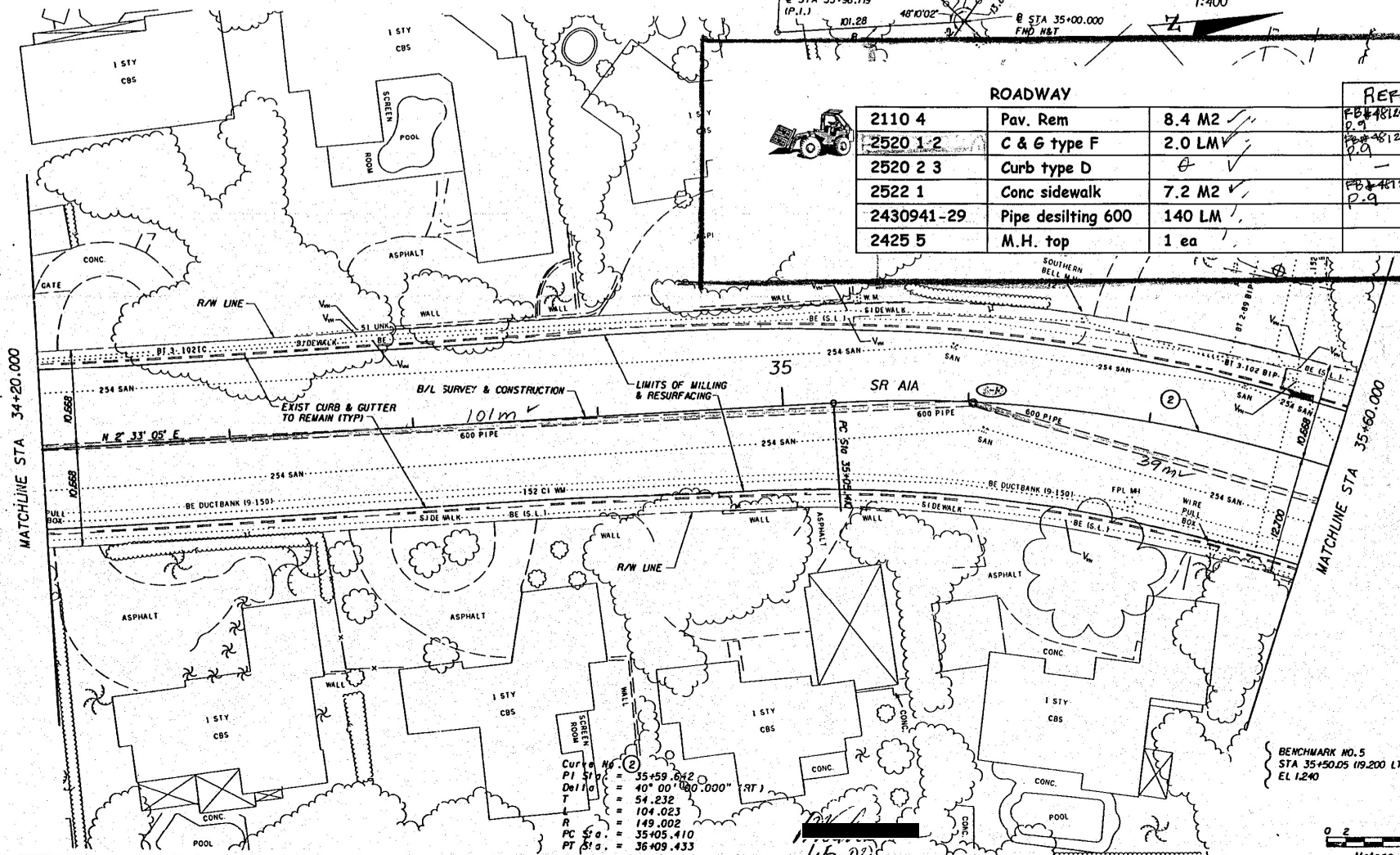

Curve No. 2
 PI Sta. = 35+59.812
 Delta = 40° 00' 00.000" (RT)
 T = 54.232
 L = 104.023
 R = 149.002
 PC Sta. = 35+05.410
 PT Sta. = 36+09.433

BENCHMARK NO. 5
 STA 35+50.25 (19.200 LT)
 EL. 1.240



REVISIONS							
DATE	BY	DESCRIPTION	DATE	BY	DESCRIPTION	DATE	BY

Stanley Consultants inc.

STATE OF FLORIDA
 DEPARTMENT OF TRANSPORTATION

ROADWAY PLAN SHEET

ROADWAY

2110 4	Pav. Rem	173.58 M2	✓	REF. PER 481244
2520 1 2	C & G type F	98 LM	✓	PER 481244 P. 10-12
2522 1	Conc sidewalk	114.78 M2	✓	PER 481244 P. 10-12
243094123	Pipe desilting 375	52 LM	✓	
2430941 25	Pipe desilting 450	38 LM	✓	
2430941-29	Pipe desilting 600	34 LM	✓	
2425 1 355	P-5 top	1 ea	✓	
2425 82	P-5 grate	1 ea	✓	
2425 5	M.H. top	3 ea	✓	
2519 76 2	Conc pavers	18.0 M2	✓	PER 481244 P. 20-31

FINANCIAL PROJECT ID	STATE PROJ. NO.	SHEET NO.
228116-1-52-01	86180-3501	15

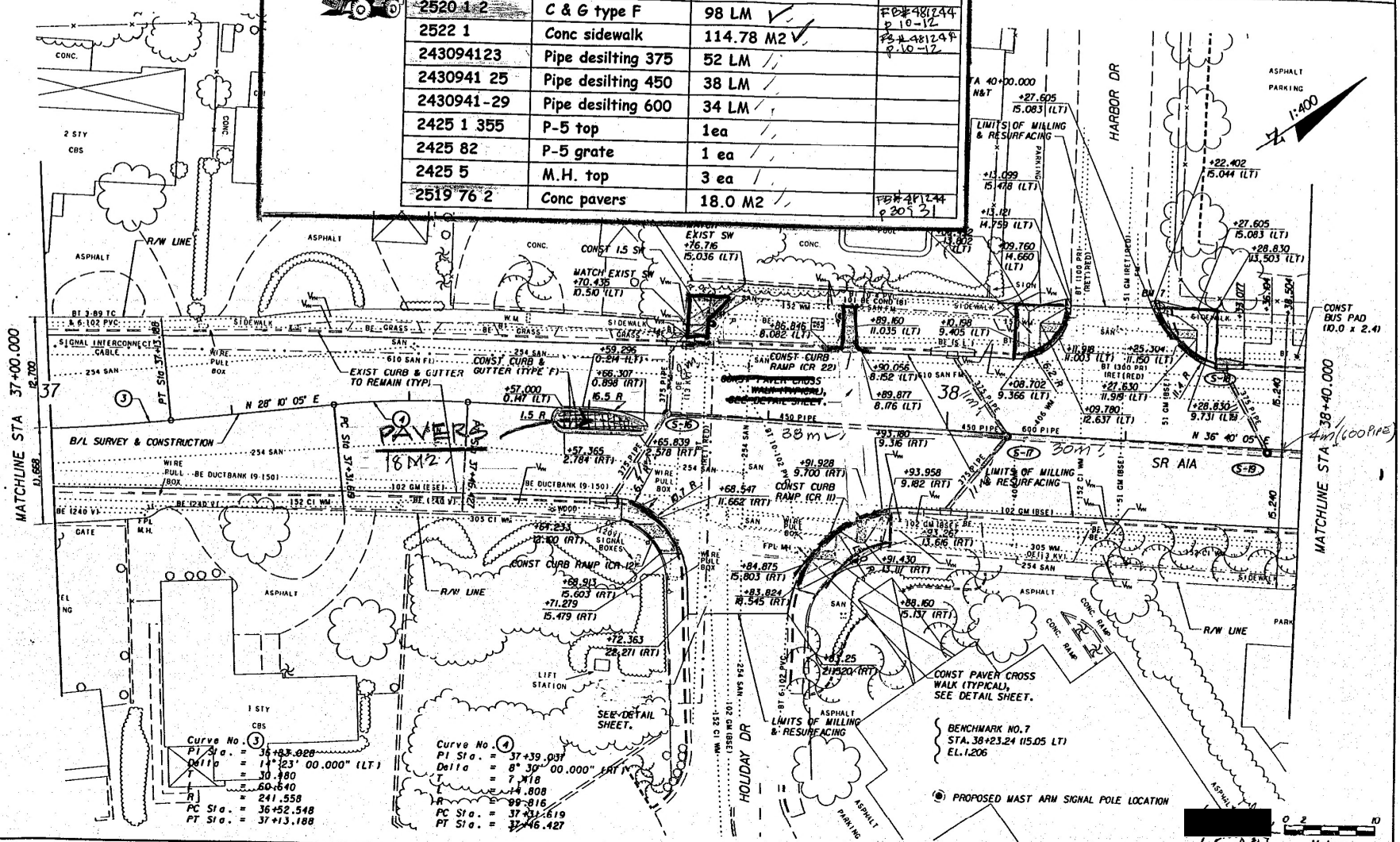

Curve No. 3
 PI Sta. = 36+53.028
 Delta = 14° 23' 00.000" (LT)
 R = 30.180
 E = 60.640
 PC Sta. = 241.558
 PT Sta. = 37+13.188

Curve No. 4
 PI Sta. = 37+39.031
 Delta = 8° 30' 00.000" (RT)
 R = 7.118
 E = 14.808
 PC Sta. = 37+41.619
 PT Sta. = 37+46.427

BENCHMARK NO. 7
 STA. 38+23.24 (15.05 LT)
 EL. 1.206

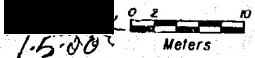

DATE	BY	DESCRIPTION	DATE	BY	DESCRIPTION



STATE OF FLORIDA
 DEPARTMENT OF TRANSPORTATION

ROADWAY PLAN SHEET

FINANCIAL PROJECT ID	STATE PROJ. NO.	SHEET NO.
228116-1-52-01	86180-3501	32

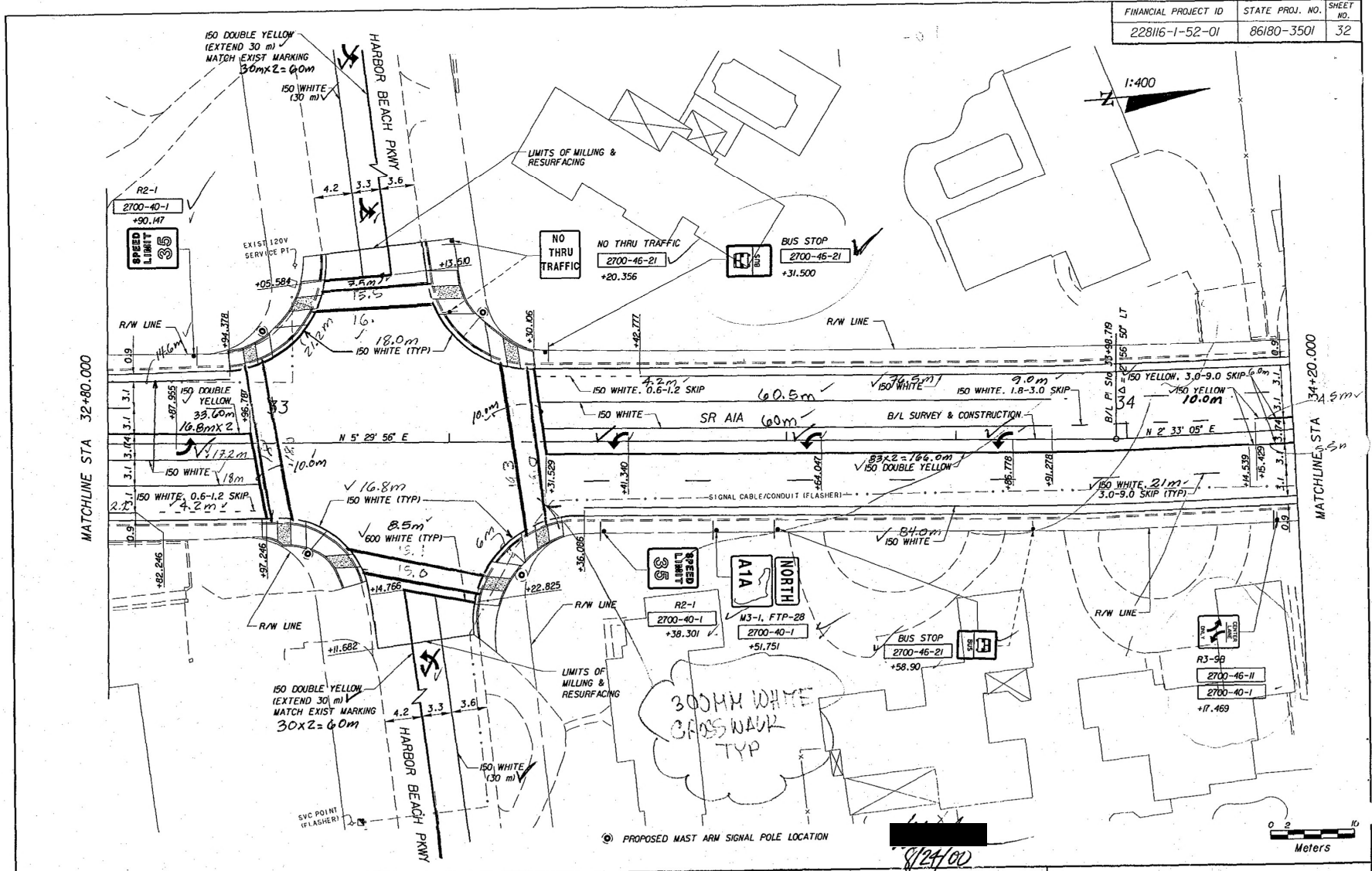

DATE		BY		DESCRIPTION		DATE		BY		DESCRIPTION	
8/11/00	AA			EXISTING CONDUIT CONNECTING FLASHING BEACON SIGN SHOWN							

 Stanley Consultants Inc.

SIGNING AND MARKING PLAN SHEET

FINANCIAL PROJECT ID	STATE PROJ. NO.	SHEET NO.
228116-1-52-01	86180-3501	33



NOTE: WI-8 SIGNS ARE TO BE AIMED AT ONCOMING TRAFFIC

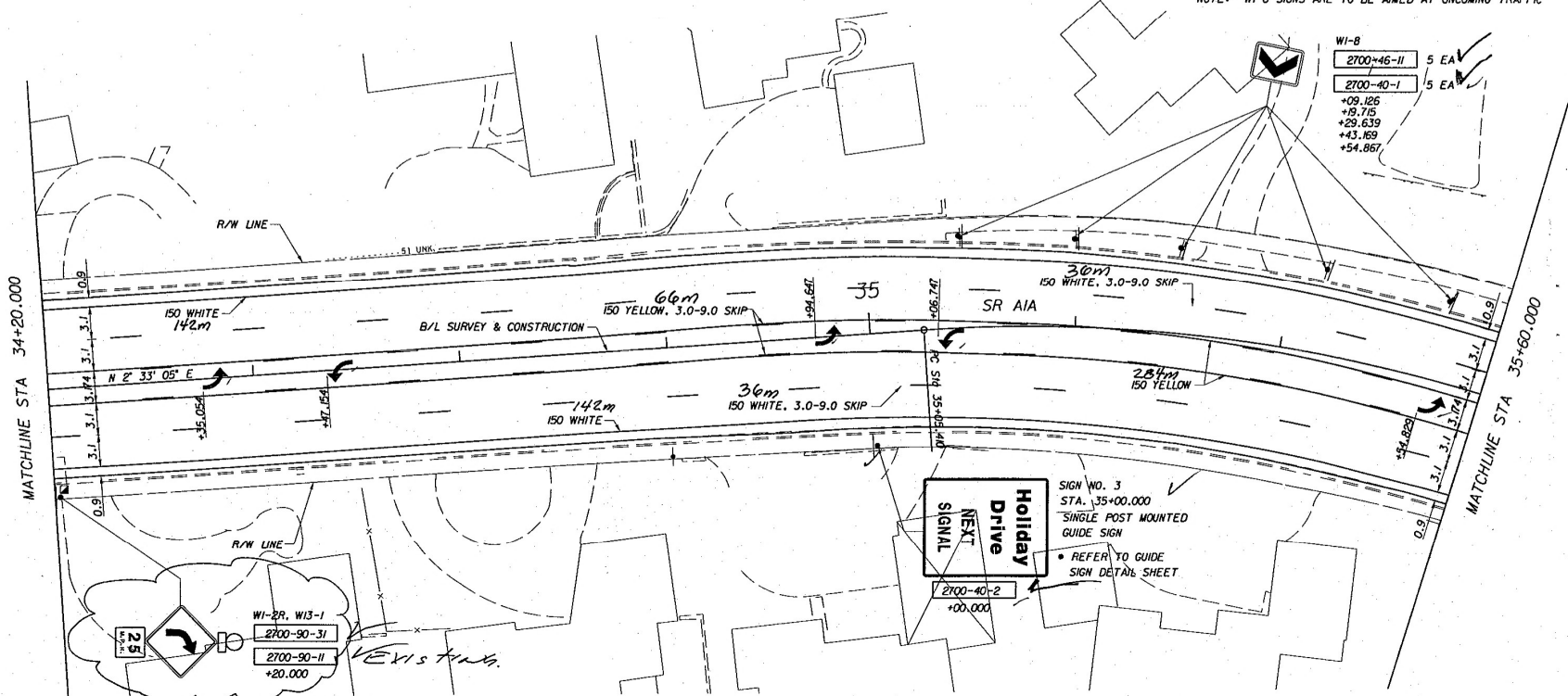

WI-8	2700-46-11	5 EA
	2700-40-1	5 EA
	+09.126	
	+19.715	
	+29.639	
	+43.169	
	+54.867	

2620-1	6.0 MI
2635-1-11	2 EA
2639-2-1	M3.0 MI
2639-3-11	1 EA

REPLACE FLASHING BEACON SIGN AT EXISTING LOCATION
 ALSO DISCONNECT/REPLACE EXIST SERVICE POINT AT SE CORNER OF SR AIA/HARBOR BEACH PKWY AND REPLACE EXIST ELECTRICAL WIRING
 * TABULATED UNDER TABULATION OF QUANTITIES TRAFFIC SIGNALS

SIGN NO. 3
 STA. 35+00.000
 SINGLE POST MOUNTED GUIDE SIGN
 • REFER TO GUIDE SIGN DETAIL SHEET



DATE		BY		DESCRIPTION		DATE		BY		DESCRIPTION	
07/17/00	AA			ADDED PIS FOR SVC POINT REPLACEMENT AT FLASHING BEACON SIGN LOCATION							



SIGNING AND MARKING PLAN SHEET

FINANCIAL PROJECT ID	STATE PROJ. NO.	SHEET NO.
228116-1-52-01	86180-3501	34

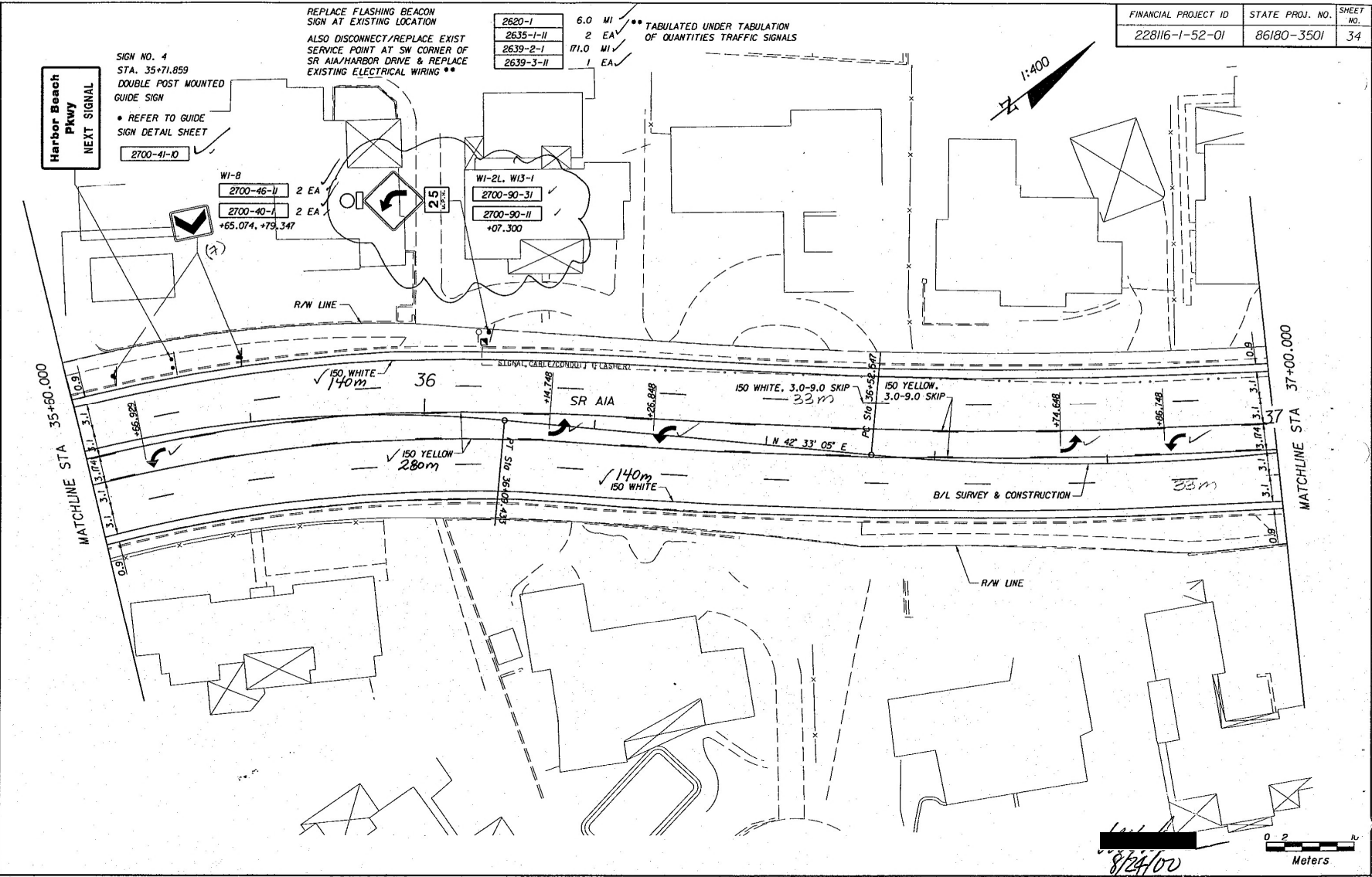

Harbor Beach Pkwy
 NEXT SIGNAL
 SIGN NO. 4
 STA. 35+71.859
 DOUBLE POST MOUNTED
 GUIDE SIGN
 • REFER TO GUIDE
 SIGN DETAIL SHEET
 2700-41-D

REPLACE FLASHING BEACON
 SIGN AT EXISTING LOCATION
 ALSO DISCONNECT/REPLACE EXIST
 SERVICE POINT AT SW CORNER OF
 SR AIA/HARBOR DRIVE & REPLACE
 EXISTING ELECTRICAL WIRING

2620-1	6.0 MI	** TABULATED UNDER TABULATION
2635-1-II	2 EA	OF QUANTITIES TRAFFIC SIGNALS
2639-2-1	71.0 MI	
2639-3-II	1 EA	

WI-B

2700-46-II	2 EA
2700-40-I	2 EA

+65.074, +79.347

WI-2L, WI3-1

2700-90-3I
2700-90-II

+07.300

REVISIONS											
DATE	BY	DESCRIPTION	DATE	BY	DESCRIPTION	DATE	BY	DESCRIPTION	DATE	BY	DESCRIPTION
8/11/00	AA	ADDED PIG FOR SVC POINT	8/11/00	AA	EXISTING CONDUIT CONNECTING						
		REPLACEMENT AT FLASHING			FLASHING BEACON SIGN SHOWN						
		BEACON SIGN LOCATION									



SIGNING AND MARKING PLAN SHEET

2-300MM WHITE LINE CROSSWALK

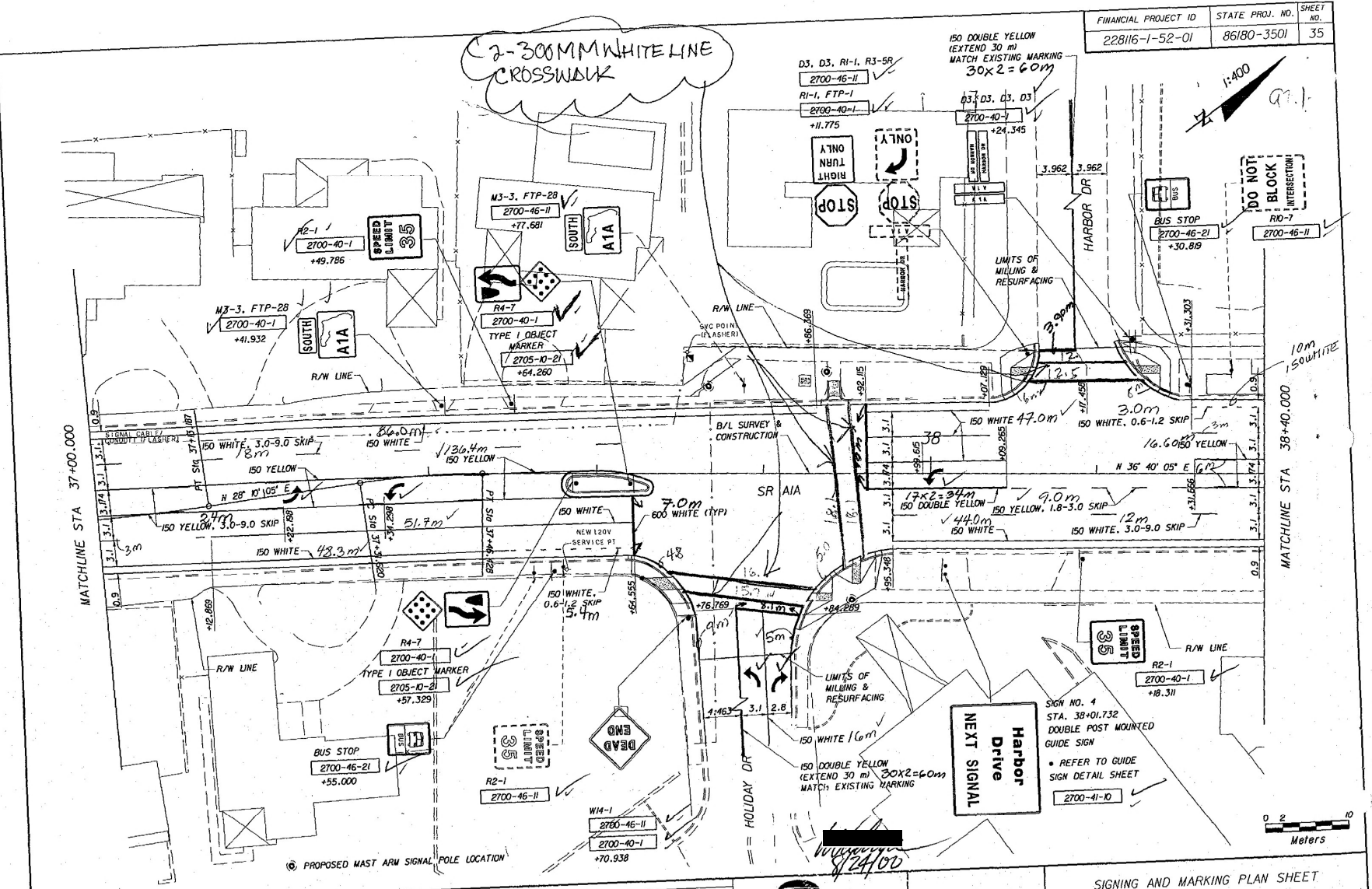

REVISIONS					
DATE	BY	DESCRIPTION	DATE	BY	DESCRIPTION
8/18/00	AA	EXISTING CONDUIT CONNECTING FLASHING BEACON SIGN SHOWN			

Stanley Consultants inc.

SIGNING AND MARKING PLAN SHEET

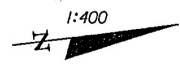

NOTE: WI-8 SIGNS ARE TO BE AIMED AT ONCOMING TRAFFIC

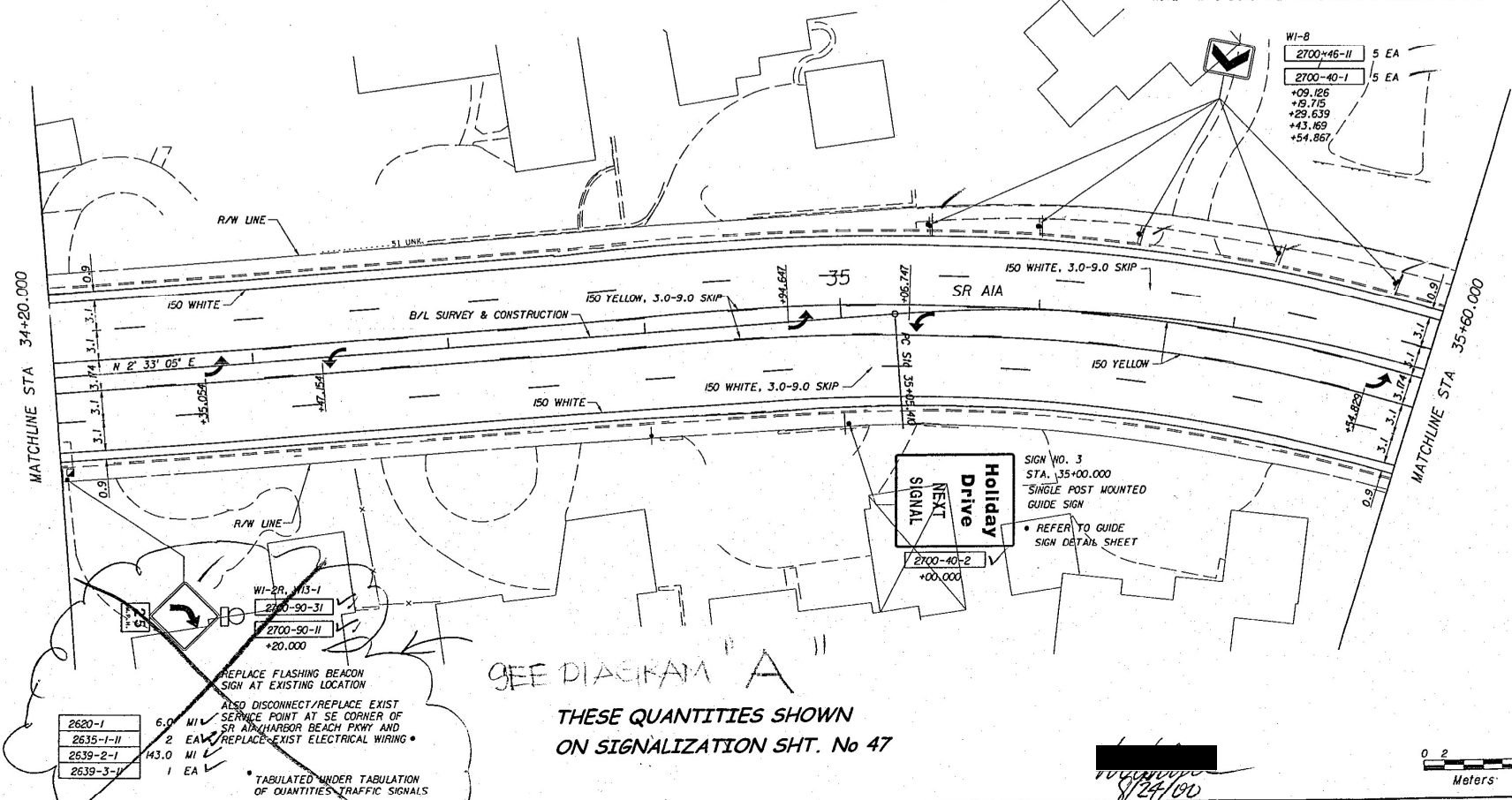

2620-1	6.0	MI
2635-1-11	2	EA
2639-2-1	143.0	MI
2639-3-1	1	EA

REPLACE FLASHING BEACON SIGN AT EXISTING LOCATION
 ALSO DISCONNECT/REPLACE EXIST SERVICE POINT AT SE CORNER OF SR AIA/HARBOR BEACH PKWY AND
 REPLACE EXIST ELECTRICAL WIRING
 * TABULATED UNDER TABULATION OF QUANTITIES TRAFFIC SIGNALS

SEE DIAGRAM "A"
 THESE QUANTITIES SHOWN ON SIGNALIZATION SHT. No 47



DATE	BY	DESCRIPTION	DATE	BY	DESCRIPTION	DATE	BY	DESCRIPTION
07/1/00	AA	ADDED PIS FOR SVS POINT REPLACEMENT AT FLASHING BEACON SIGN LOCATION						



SIGNING AND MARKING PLAN SHEET

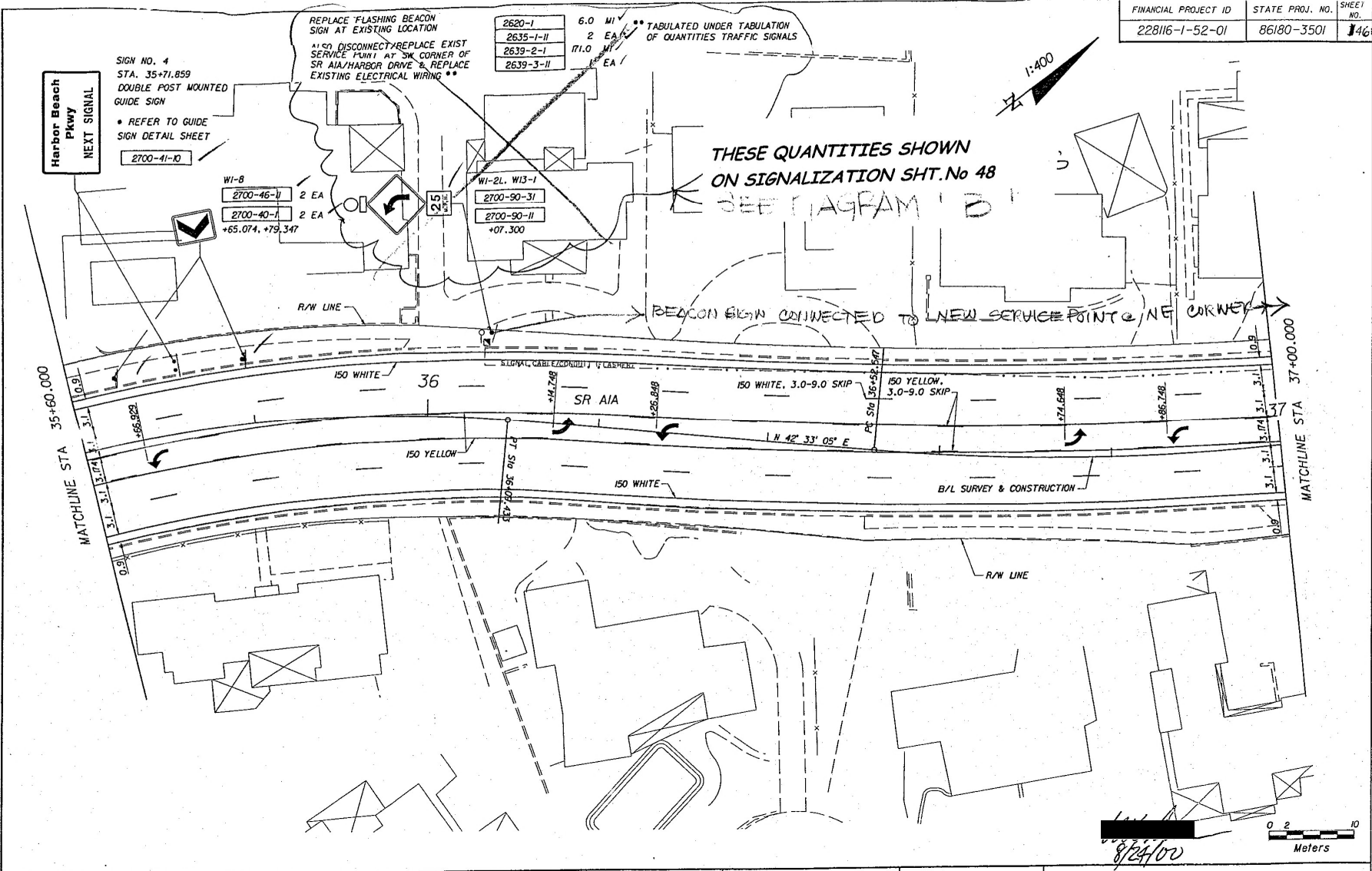

REVISIONS					
DATE	BY	DESCRIPTION	DATE	BY	DESCRIPTION
07/17/00	AA	ADDED PIS FOR SIG POINT	07/17/00	AA	EXISTING CONDUIT CONNECTING FLASHING BEACON SIGN SHOWN
		REPLACEMENT AT FLASHING BEACON SIGN LOCATION			

Stanley Consultants inc.

SIGNING AND MARKING PLAN SHEET

LIGHTING

2400 1 15	Conc. C-II	9.22
2415 1 6	Steel	32.12
2715 2 232	Rigid Cond.	272.1 MI
2715 2 112	PVC Cond.	27.3 MI
2522 1	Sidewalk	120.24 M2
2715 14 12 □	Pull Box □	100' EA
2715 512 306	L. Pole New	70 EA
2715 550 000	L. Pole Rem.	70 EA
2620-1	Gr. Rod	30.0 MI
2620-1	Gr. Rod Panel	18.0 MI

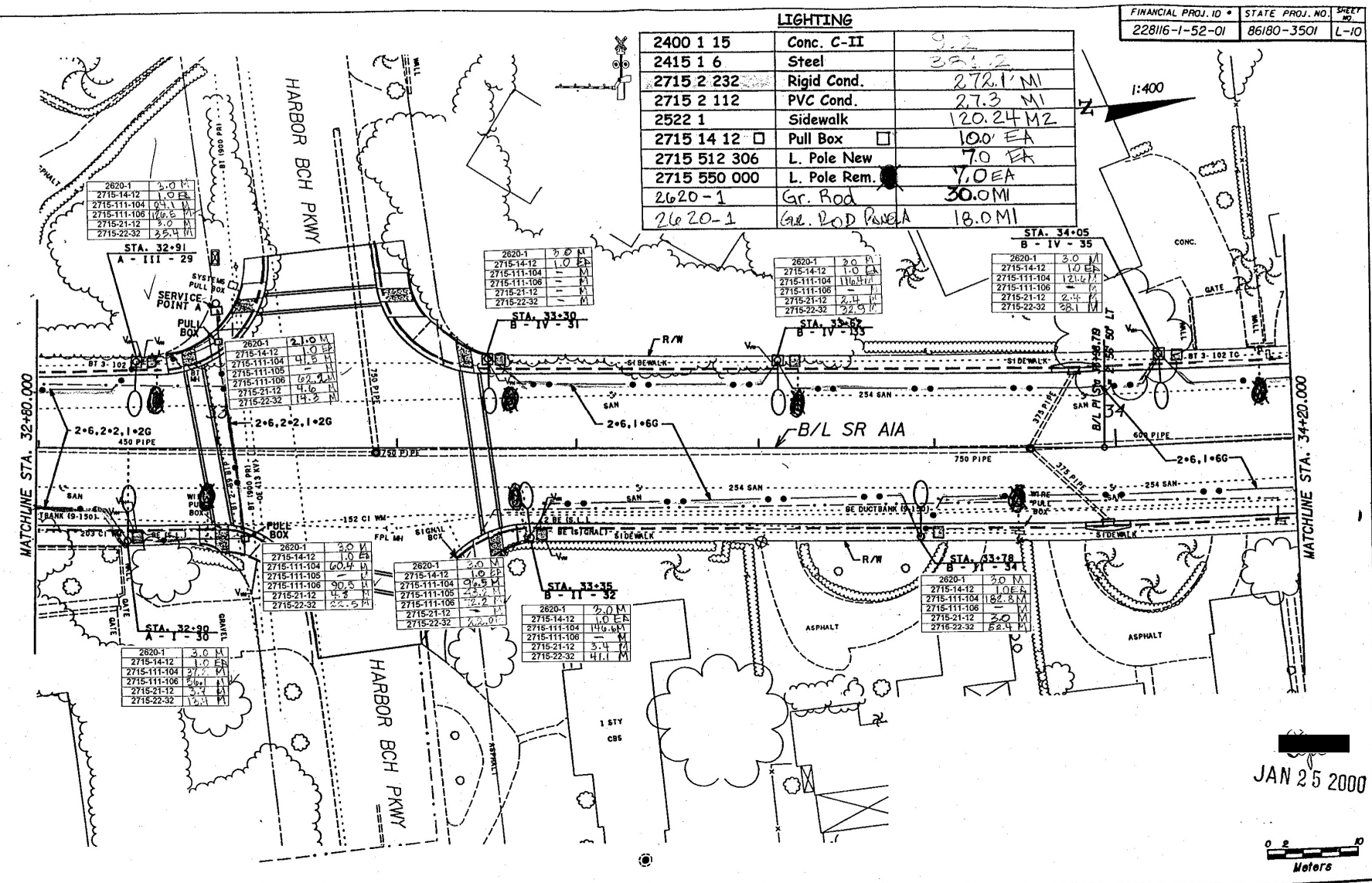

JAN 25 2000



REVISIONS

DATE	BY	DESCRIPTION	DATE	BY	DESCRIPTION



FLORIDA DEPARTMENT OF
TRANSPORTATION

LIGHTING PLAN SHEET

LIGHTING

2400 1 15	Conc. C-II	4.6
2415 1 6	Steel	190.6
2715 2 232	Rigid Cond.	290.1 LM
2715 2 112	PVC Cond.	23.3 M1
2522 1	Sidewalk	7.2 M2
2715 14 12	Pull Box	6.0 EA
2715 512 306	L. Pole New	6.0 EA
2715 550 000	L. Pole Rem.	5.0 EA
2620-1	Gr. ROD	18.0 M1

STA. 35+53
B - IV - 41

2620-1	3.0 M
2715-14-12	1.0 EA
2715-111-104	16.7 M
2715-111-106	1.1 M
2715-21-12	5.5 M
2715-22-32	11.6 M

STA. 35+07
B - IV - 39

2620-1	3.0 M
2715-14-12	1.0 EA
2715-111-104	92.5 M
2715-111-106	1.1 M
2715-21-12	4.3 M
2715-22-32	21.8 M

STA. 34+55
B - IV - 37

2620-1	3.0 M
2715-14-12	1.0 EA
2715-111-104	198.1 M
2715-111-106	1.1 M
2715-21-12	2.4 M
2715-22-32	27.2 M

STA. 34+78
B - II - 38

2620-1	3.0 M
2715-14-12	1.0 EA
2715-111-104	122.0 M
2715-111-106	1.1 M
2715-21-12	2.4 M
2715-22-32	53.1 M

STA. 35+32
B - II - 40

2620-1	3.0 M
2715-14-12	1.0 EA
2715-111-104	122.5 M
2715-111-106	1.1 M
2715-21-12	3.7 M
2715-22-32	26.2 M

STA. 34+29
B - II - 36

2620-1	3.0 M
2715-14-12	1.0 EA
2715-111-104	163.7 M
2715-111-106	1.1 M
2715-21-12	6.1 M
2715-22-32	16.2 M

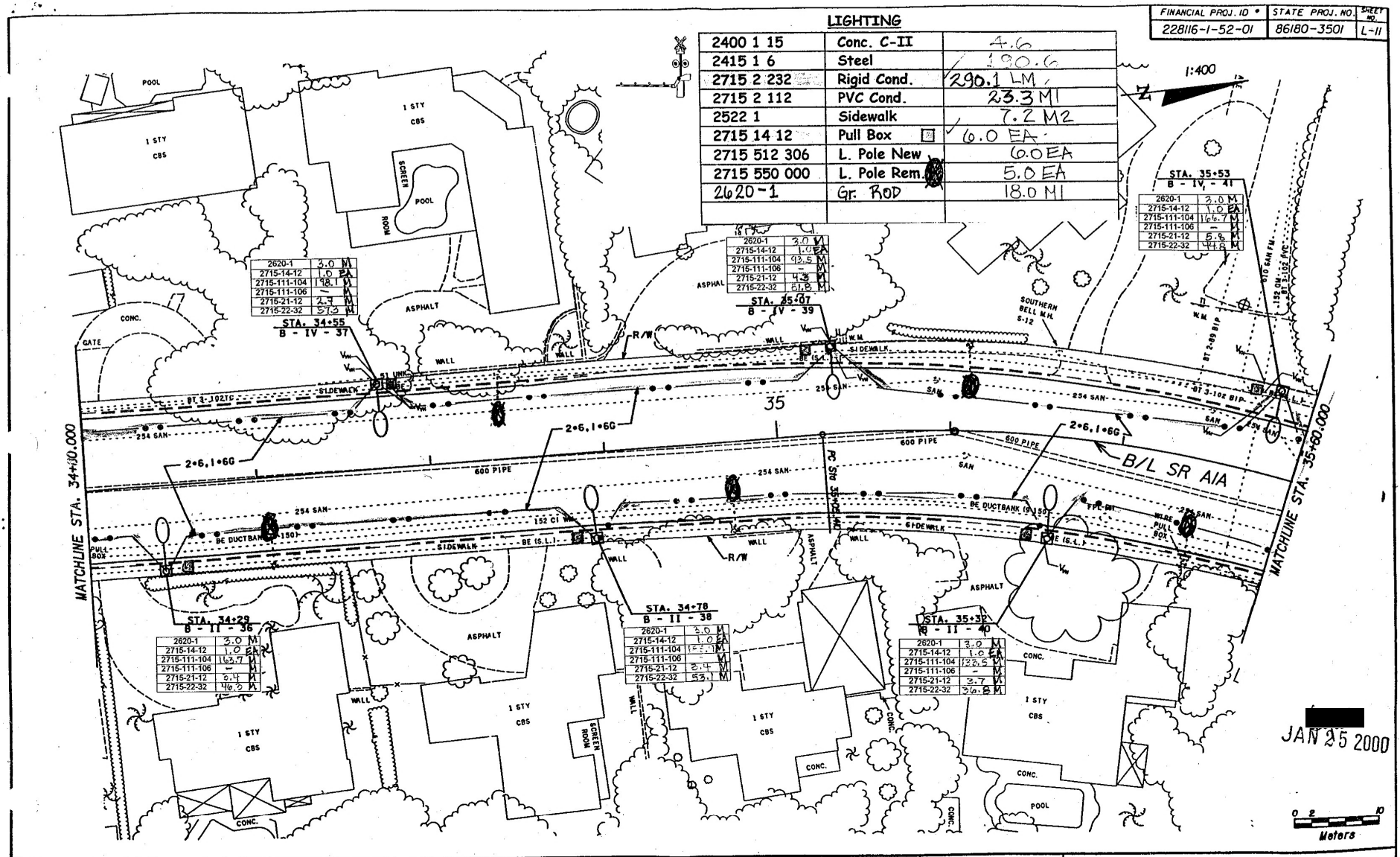

JAN 25 2000



DATE	BY	DESCRIPTION	DATE	BY	DESCRIPTION



FLORIDA DEPARTMENT OF TRANSPORTATION

LIGHTING PLAN SHEET

LIGHTING		
2400 1 15	Conc. C-II	15.0
2415 1 6	Steel	571.8
2715 2 232	Rigid Cond.	317.5 M
2715 2 112	PVC Cond.	32.8 M
2522 1	Sidewalk	114.78 M ²
2715 14 12	Pull Box	8.0 EA
2715 512 306	L. Pole New	7.0 EA
2715 550 000	L. Pole Rem.	5.0 EA
2620-1	Gr. ROD	42.0 M

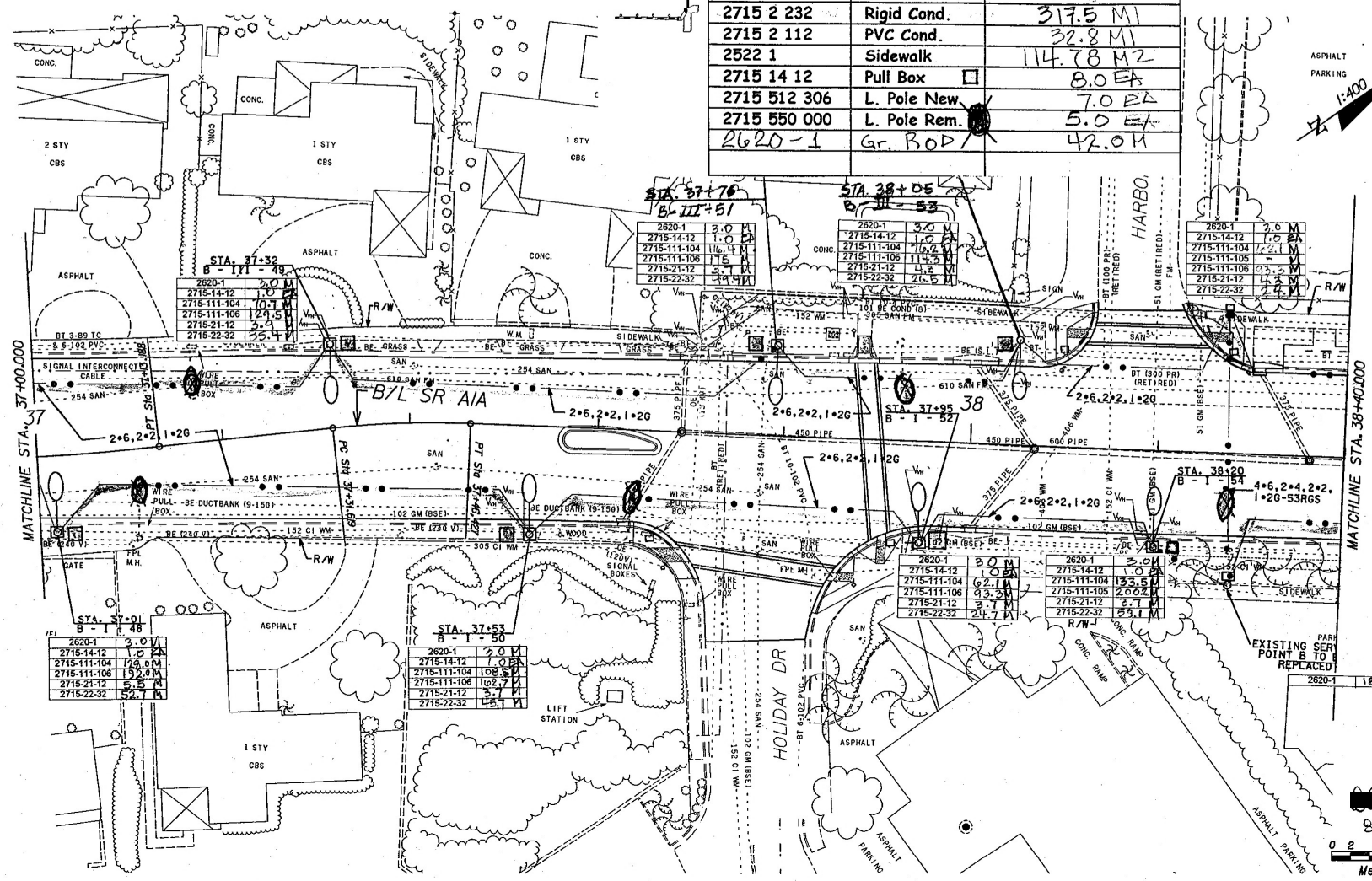

2620-1	3.0 M
2715-14-12	1.0 EA
2715-111-104	10.1 M
2715-111-108	12.4 M
2715-21-12	5.4 M
2715-22-32	2.4 M

2620-1	3.0 M
2715-14-12	1.0 EA
2715-111-104	16.4 M
2715-111-108	17.5 M
2715-21-12	5.7 M
2715-22-32	4.4 M

2620-1	3.0 M
2715-14-12	1.0 EA
2715-111-104	16.4 M
2715-111-108	11.4 M
2715-21-12	4.3 M
2715-22-32	2.4 M

2620-1	3.0 M
2715-14-12	1.0 EA
2715-111-104	12.2 M
2715-111-108	9.5 M
2715-21-12	11.5 M
2715-22-32	2.4 M

2620-1	3.0 M
2715-14-12	1.0 EA
2715-111-104	12.0 M
2715-111-108	13.0 M
2715-21-12	5.5 M
2715-22-32	2.4 M

2620-1	3.0 M
2715-14-12	1.0 EA
2715-111-104	10.8 M
2715-111-108	10.7 M
2715-21-12	5.7 M
2715-22-32	4.5 M

2620-1	3.0 M
2715-14-12	1.0 EA
2715-111-104	6.2 M
2715-111-108	9.3 M
2715-21-12	5.7 M
2715-22-32	2.4 M

2620-1	3.0 M
2715-14-12	1.0 EA
2715-111-104	13.5 M
2715-111-108	20.0 M
2715-21-12	5.7 M
2715-22-32	2.4 M

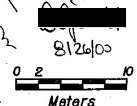

REVISIONS											
DATE	BY	DESCRIPTION	DATE	BY	DESCRIPTION	DATE	BY	DESCRIPTION	DATE	BY	DESCRIPTION
8/18/00	DG	CORRECT SERVICE POINT LOCATION									