



**Highway Factors Attachment 1 - Survey of Talley Road performed by the City of  
Chattanooga**

**Chattanooga, TN**

**HWY17MH009**

(3 pages)

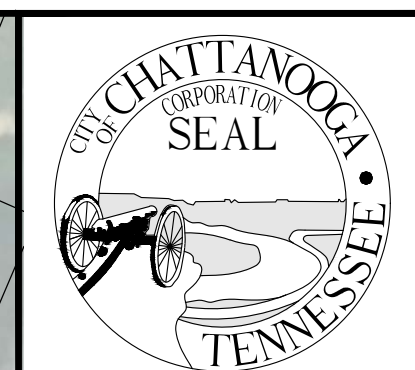

**CITY OF CHATTANOOGA**  
 CORPORATION  
 SEAL  
 TENNESSEE

**CITY OF CHATTANOOGA**  
 DEPARTMENT  
 OF  
 TRANSPORTATION

ADMINISTRATOR:  
 BLYTHE BAILEY

CITY TRANSPORTATION ENGINEER:  
 BERTRAN KUYRKENDALL, P.E.



Talley Rd from Rogers Rd to Midwoode Dr  
 Plan & Profile

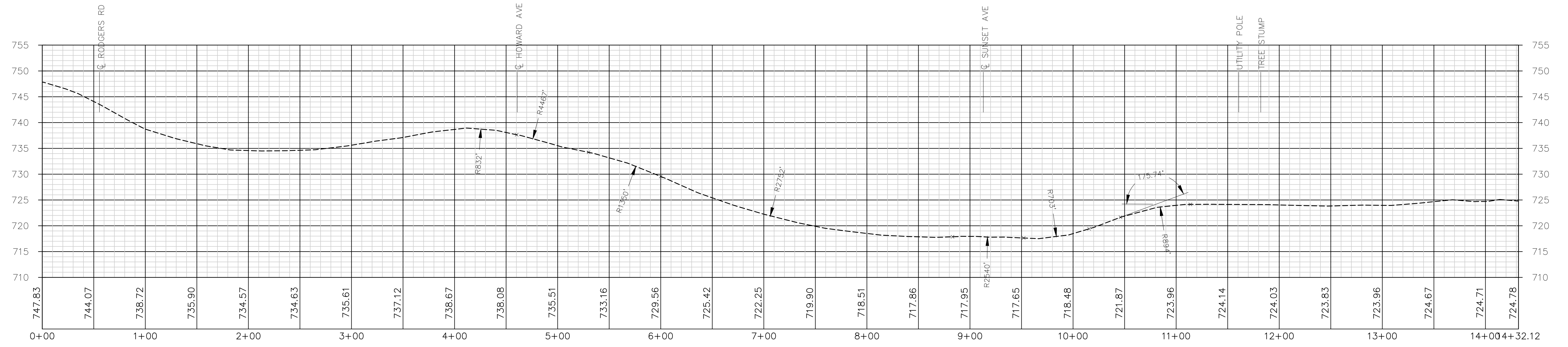

SCALE:  
 1"=50' HORZ.  
 1"=10' VERT.

NO.	DATE	REVISION	SIG.
0			

CONTRACT#	
SCALE:	AS SHOWN
DRAWN:	JDH
DESIGN:	JDH
CHECKED:	BCS

T:\Administration\Open Records (FOIA)\Talley Rd for Woodmore Elementary\Talley Rd profile and sections.dwg Dec 22,2016 - 2:11pm, Jowell

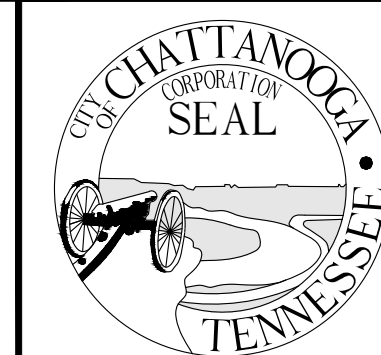

**CITY OF CHATTANOOGA**  
 CORPORATION  
**SEAL**  
**CITY OF CHATTANOOGA**  
 DEPARTMENT  
 OF  
 TRANSPORTATION  
 ADMINISTRATOR:  
 BLYTHE BAILEY  
 CITY TRANSPORTATION ENGINEER:  
 BERTRAN KUYRKENDALL, P.E.

Talley Rd from Rogers Rd to Midwoode Dr  
 Sections

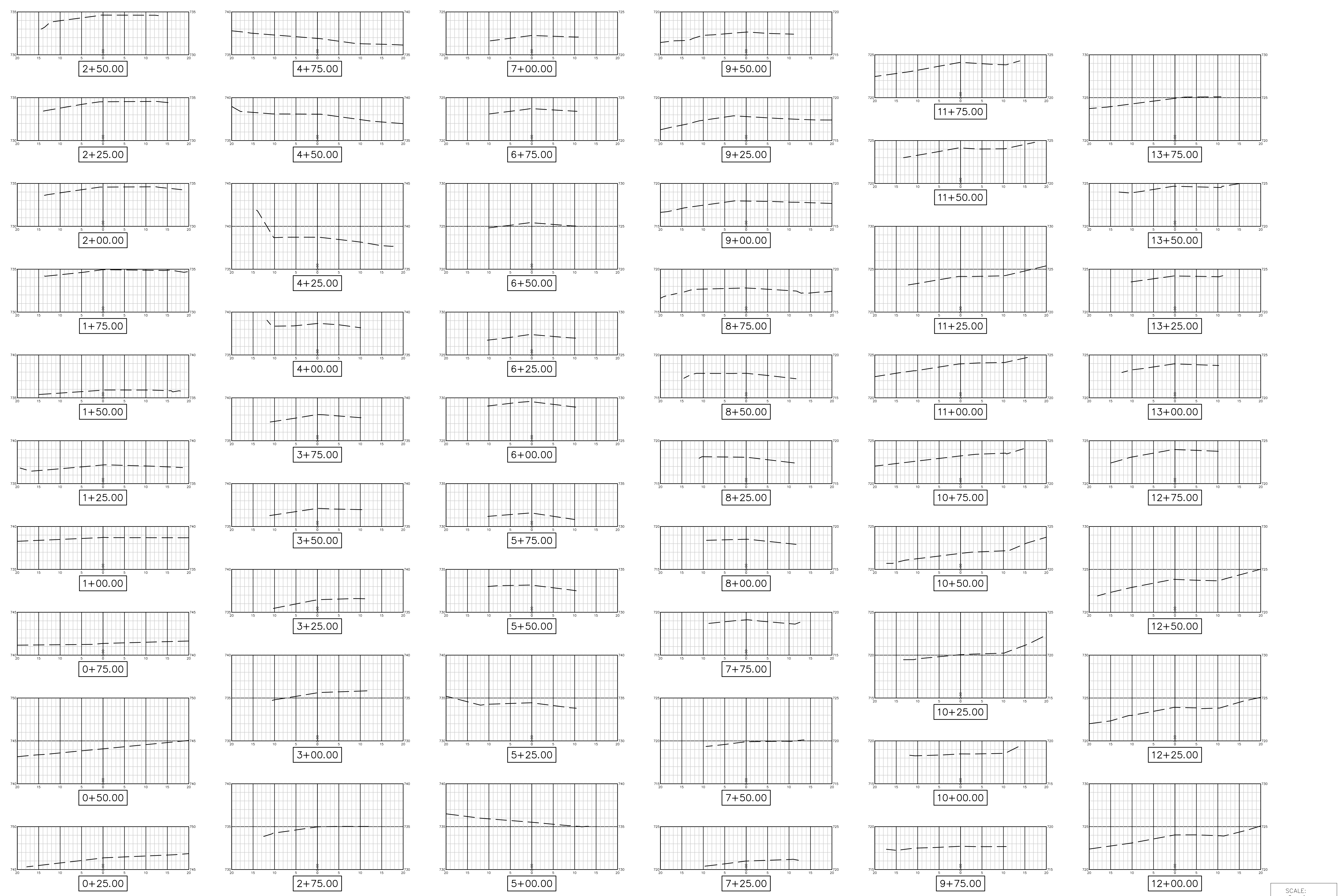

SCALE:  
 1"=10' HORZ.  
 1"=5' VERT.

NO.	DATE	REVISION	SIG.
0			

CONTRACT#	
SCALE:	AS SHOWN
DRAWN:	JDH
DESIGN:	JDH
CHECKED:	BCS

T:\Administration\Open Records (FOIA)\Talley Rd profile and sections.dwg Dec 22,2016 - 2:11pm, Jonell