



**HIGHWAY FACTORS GROUP CHAIRMAN'S
FACTUAL REPORT**

**Highway Attachment – Schematic of utility work performed by Southern California
Edison (SCE) Company on October 23, 2016**

Palm Springs, CA

HWY17MH005

(2 pages)

CAL TRANS ENCROACHMENT PERMIT APPLICATION



NO SCALE
SHEET 1 OF 1

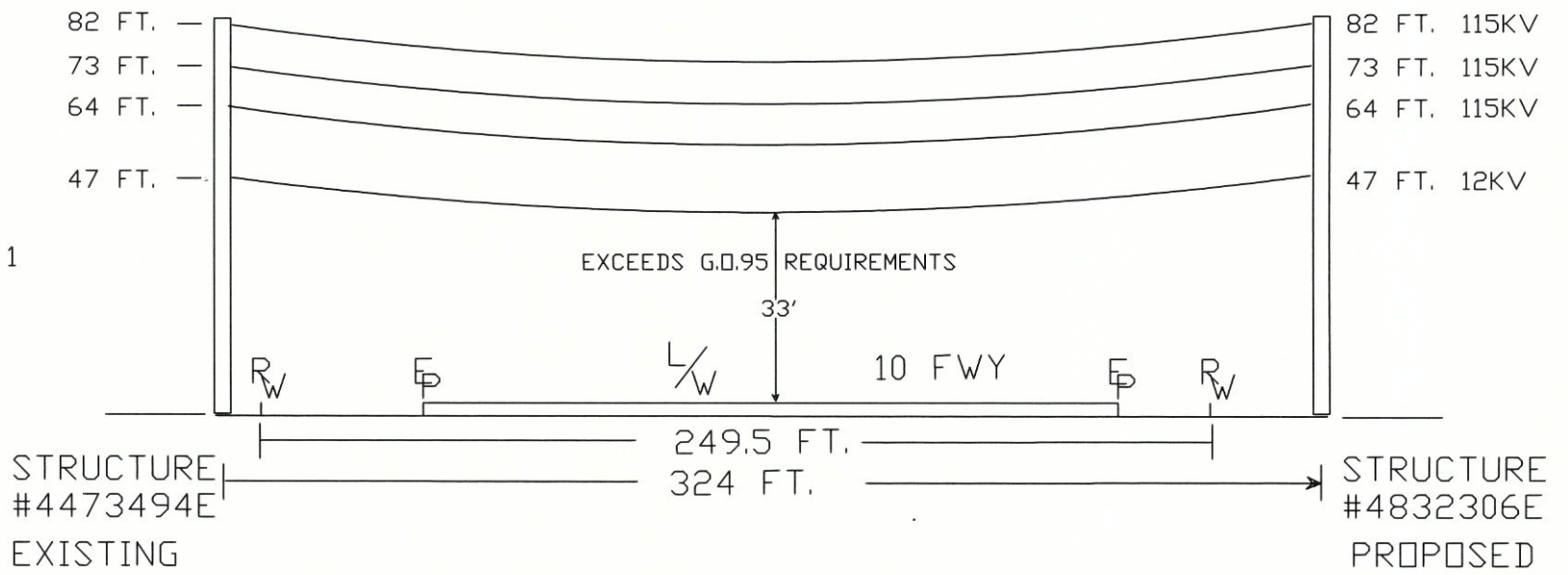

PERMIT 08-15-6-UF-0379 HAD TO BE POSTPONED DUE TO SCE OUTAGE ISSUES.
PLEASE RE-ISSUE NEW PERMIT. NO CHANGES FROM ORIGINAL PERMIT.

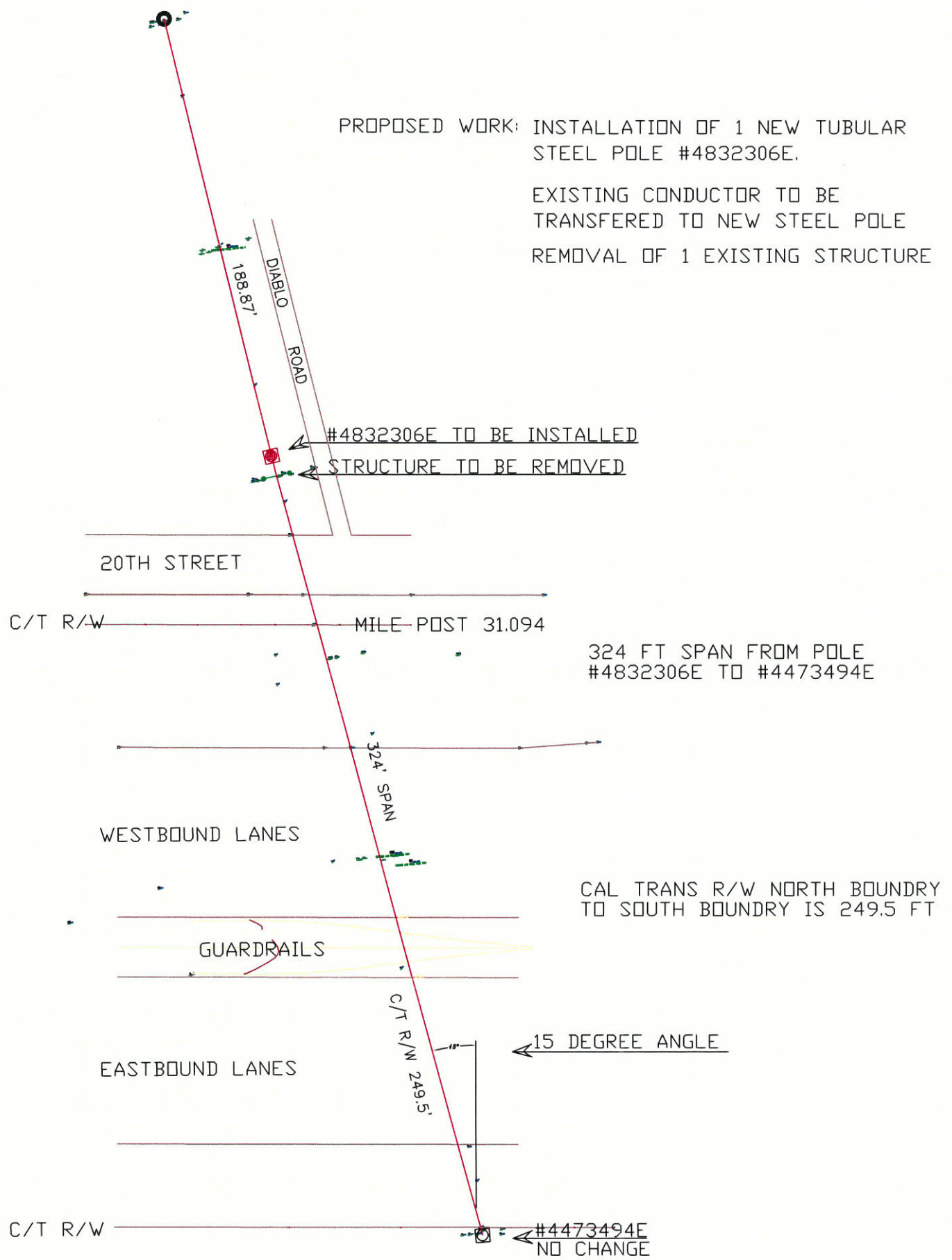

PROPOSED WORK: INSTALLATION OF 1 NEW TUBULAR STEEL POLE #4832306E.

EXISTING CONDUCTOR TO BE TRANSFERRED TO NEW STEEL POLE

REMOVAL OF 1 EXISTING STRUCTURE

RECEIVED
16 OCT -6 PM 4:04
DISTRICT 8
PERMIT OFFICE

Southern California Edison
Transmission Design

DRAWN BY: E.ESCAMILLA	OFFICE: 909 820-5439
LOCATION : 10 FWY-1,544 FT WEST OF WALL RD.	
THOMAS GUIDE: RIV. Pg.795 Gd.J-4	
W/O NO: TD722252	

