

7-10

FIGURE 7-11 COLLECTIVE CONTROL SYSTEM

REV MAR 2004

# ROBINSON ILLUSTRATED PARTS CATALOG

MODEL R22

FIGURE AND INDEX NUMBER	PART NUMBER	DESCRIPTION	PARTS AVAIL	USABLE ON CODE	QTY PER ASSY
<b>COLLECTIVE CONTROL SYSTEM</b>					
7-11-1	A758-6	Stick Assembly (RH [pilot] assembly. Incl items 36, 46, 50, 52, 55, 57 thru 59, 60 [1-8], 80, 81, and 83) . . . . .	X		1
2	A758-5	Stick Assembly (LH [co-pilot] removable assembly. Incl items 55, 56, and 82) . . . . .	X		1
	A758-7	Stick Sub-Assembly (RH [pilot] assembly, provision for governor. Incl items 36, 46, 50, 52, 55, 57 thru 59, 60, 80, and 81) . . . . .	X		1
3	A101-4	Rod End . . . . .	X		10
4	B330-16	Palnut . . . . .	X		10
5	AN316-5R	Nut . . . . .	X		10
6	A143-1	Sleeve (push-pull tube; install using part no. B270-3oz sealant) . . . . .	X		1
7	MS27039C0806	Screw . . . . .	X		13
8	A437-2	Tab . . . . .	X		1
9	AN960-8L	Washer . . . . .	X		9
10	MS21042L08	Nut . . . . .	X		9
11	A343-1	Strut . . . . .	X		2
12	B330-13	Palnut . . . . .	X		10
13	MS21042L4	Nut . . . . .	X		10
14	AN960-416L	Washer . . . . .	X		A/R
15	NAS8604-8	Bolt . . . . .	X		2
16	AN960-516L	Washer . . . . .	X		2
17	NAS6604-21	Bolt . . . . .	X		1
18	A214-3	Washer . . . . .	X		2
19	A347-5	Strut Assembly . . . . .	X		1
20	A115-1	Spacer . . . . .	X		4
21	NAS6604-17	Bolt . . . . .	X		3
22	A121-5	Push-Pull Tube Assembly (Incl items 3 thru 5, [two of each])	X		1
23	A121-7	Push-Pull Tube Assembly (Incl items 3 thru 6, [one of each])	X		2
24	A121-3	Push-Pull Tube Assembly (Incl items 3 thru 5, [one of each])	X		1
25	AN960-416	Washer . . . . .	X		3
26	A337-1	Jackshaft Assembly . . . . .	X		1
27	NAS6604-7	Bolt . . . . .	X		2
28	NAS6604-23	Bolt . . . . .	X		1
(Cont'd)					

X - Available as separate spares item  
 O - Available only as part of assembly

REV 31 DEC 98

7-11

# ROBINSON ILLUSTRATED PARTS CATALOG

MODEL R22

FIGURE AND INDEX NUMBER	PART NUMBER	DESCRIPTION	PARTS AVAIL	USABLE ON CODE	QTY PER ASSY
<b>COLLECTIVE CONTROL SYSTEM (Cont'd)</b>					
7-11-29	MS27039C0822	Screw . . . . .	X		2
30	MS27039C0812	Screw . . . . .	X		2
31	A329-1	Bearing Block Assembly . . . . .	X		1
32	NAS6604-30	Bolt . . . . .	X		1
33	A431-1	Knob . . . . .	X		1
34	A332-1	Lever . . . . .	X		1
35	NAS1362-08-12P	Screw . . . . .	X		1
36	A139-1	Bearing . . . . .	X		3
37	A105-6	Journal . . . . .	X		1
38	NAS6604-11	Bolt . . . . .	X		1
39	A141-3	Washer . . . . .	X		2
40	A105-3	Journal . . . . .	X		2
41	NAS6604-30	Bolt . . . . .	X		1
42	A141-20	Washer . . . . .	X		2
43	B0500-022-S	Belleville Washer . . . . .	X		2
44	NAS1352-4-24P	Screw . . . . .	X		1
45	NAS6603-5	Bolt . . . . .	X		1
46	AN960-10L	Washer . . . . .	X		2
47	AN960-416L	Washer (or AN960-416 as required) . . . . .	X		A/R
48	A333-1	Stop . . . . .	X		1
49	A130-4	Spacer . . . . .	X		1
50	MS21042L3	Nut . . . . .	X		1
51	B330-7	Palnut . . . . .	X		2
52	NAS6603-6	Bolt . . . . .	X		2
53	A678-1	Boot . . . . .	X		2
54	A680-1	Ring - Collective Boot (LH Stick) . . . . .	X		1
	A680-2	Ring - Collective Boot (RH Stick) . . . . .	X		1
55	A601-1	Grip (install using B270-15 adhesive) . . . . .	X		2
56	A959-1	End Cap (collective LH) . . . . .	X		1
57	A959-2	End Cap (Ref, see Figure 8-69) . . . . .	X		1
58	B328-1	Connecting Rod Assembly (Ref)			
(Cont'd)					

7-12 X - Available as separate spares item  
 0 - Available only as part of assembly

REV 31 DEC 98

# ROBINSON ILLUSTRATED PARTS CATALOG

MODEL R22

FIGURE AND INDEX NUMBER	PART NUMBER	DESCRIPTION	PARTS AVAIL	USABLE OR CODE	QTY PER ASSY
COLLECTIVE CONTROL SYSTEM (Cont'd)					
7-11-59	B263-12	Housing . . . . .	X		1
	B263-1	Pin . . . . .	X		2
60	A038-5*	Spring Assembly - Collective (weak; Incl items 51, 61 thru 68, and 71) . . . . .	X		1
	A038-6*	Spring Assembly - Collective (standard; Incl items 51, 61 thru 68, and 73) . . . . .	X		1
	A038-7	Spring Assembly - Collective (strong; Incl items 51, 61 thru 68, and 74) . . . . .	X		1
61	B292-3	Rod End (left-hand thread) . . . . .	X		1
62	MS21042L06	Nut . . . . .	X		3
63	NAS1149FN632P	Washer . . . . .	X		3
64	A426-5	Cap - Upper (left-hand thread) . . . . .	X		1
65	A428-1	Rod . . . . .	X		3
66	A426-6	Cap - Lower . . . . .	X		1
67	AN315-3R	Nut . . . . .	X		3
68	A127-3	Rod End . . . . .	X		1
69	A429-1*	Spring - Collective (90 lb/in. silver) . . . . .	X		1
70	A429-2*	Spring - Collective (35 lb/in. chromate) . . . . .	X		1
71	A429-3	Spring - Collective (weak; 50 lb/in. gray, 3.70 inches free length) . . . . .	X		1
72	A429-4*	Spring - Collective (70 lb/in. black) . . . . .	X		1
73	A429-5	Spring - Collective (standard; 50 lb/in. gold, 4.05 inches free length) . . . . .	X		1
74	A429-8	Spring - Collective (strong; 71 lb/in. white, 3.75 inches free length) . . . . .	X		1
75	A429-10	Spring - Collective (114 lb/in. chromate; for spares) . . . . .	X		1
76	B162-3	Clipnut . . . . .	X		1
77	A231-4	Anchor . . . . .	X		1
78	A473-1	Guard . . . . .	X		1
79	A205-1	Fork Assembly . . . . .	X		1
80	C342-1	Arm (Ref)			
81	B280-1	Switch Assembly (Ref. see Figure 8-69)			
<p>*A038-5 spring assembly replaces A038-2 assembly.                      A038-6 spring assembly replaces A038-1, -3, and -4 assemblies. A429-1, -2, and -4 collective <u>springs</u> are available for replacement on older R22s with A038-1, -2, -3, and -4 <u>spring assemblies</u>. (Cont'd)</p>					

X - Available as separate spares item  
 0 - Available only as part of assembly

REV JUN 2000

7-13

**ROBINSON ILLUSTRATED PARTS CATALOG**

**MODEL R22**

FIGURE AND INDEX NUMBER	PART NUMBER	DESCRIPTION	PARTS AVAIL	USABLE ON CODE	QTY PER ASSY
COLLECTIVE CONTROL SYSTEM (Cont'd)					
7-11-82	A795-7	Pin Assembly .....	X		1
83	B247-5	Governor Assembly (Ref, see Figure 8-69) * * *			
84	A783-1	Retainer (spares item for older R22s) .....	X		1
85	MS3367-4-9	Ty-Rap (small) .....	X		1
86	MS3367-5-9	Ty-Rap (large) .....	X		1
87	A758-2	Stick Assembly (LH [co-pilot] removable assembly; obsolete. Replaced by item 2.)			

7-13A

X - Available as separate spares item  
 0 - Available only as part of assembly

REV MAR 2004

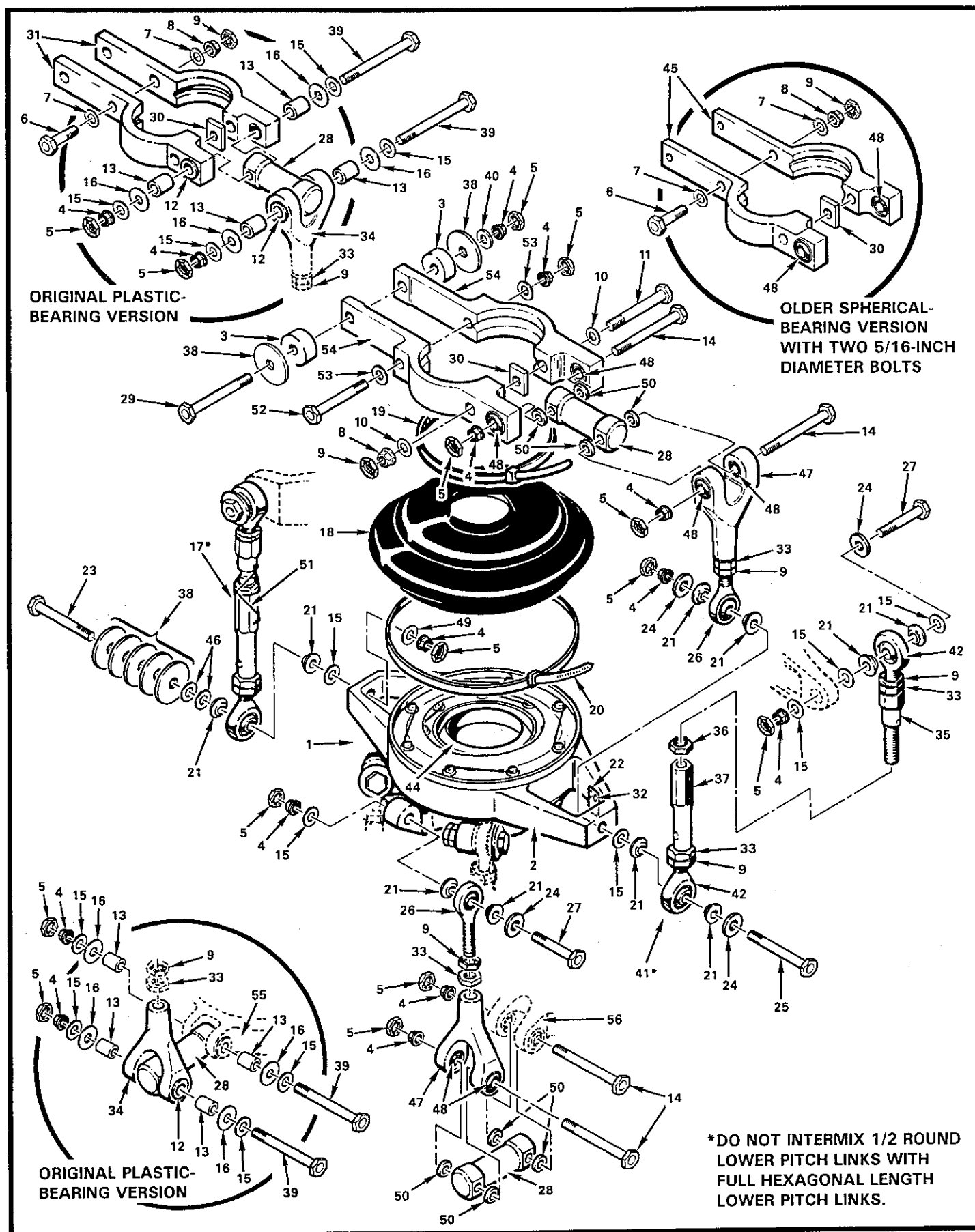

FIGURE 7-15 SWASHPLATE ASSEMBLY  
(Original equipment on Ship S/N 3539 and prior)

# ROBINSON ILLUSTRATED PARTS CATALOG

MODEL R22

FIGURE AND INDEX NUMBER	PART NUMBER	DESCRIPTION	PARTS AVAIL	USABLE ON CODE	QTY PER ASSY
		<b>SWASHPLATE ASSEMBLY</b> (Original equipment on Ship S/N 3539 and prior)			
7-15-1	A017-1.CS	Swashplate Assembly (Ref; see Figure 7-17B.)			
2	A017-2	Swashplate Sub-Assembly (Includes items 22 and 32, upper and lower swashplates, item 44, and all internal components as an assembled unit) . . . . .	X		1
3	A255-1 or A255-2	Counter Weight (1.10 in. O.D.) . . . . . Counter Weight (1.90 in. O.D.) . . . . .	X X		A/R A/R
4	MS21042L4	Nut . . . . .	X		14
5	B330-13	Palnut . . . . .	X		12
6	NAS6605-8	Bolt . . . . .	X		1
7	NAS1149F0532P	Washer . . . . .	X		2
8	MS21042L5	Nut . . . . .	X		2
9	B330-16	Palnut . . . . .	X		4
10	NAS1149F0532P	Washer (or NAS1149F0563P A/R to show 2-4 threads) . .	X		2
11	NAS6605-28	Bolt . . . . .	X		1
12	A139-1	Bearing . . . . .	X		4
13	A105-11	Journal . . . . .	X		4
14	NAS1304-28	Bolt . . . . .	X		4
15	NAS1149F0432P	Washer . . . . .	X		A/R
16	A141-3	Washer . . . . .	X		8
17	A258-1	Pitch Link Assembly (Incl items 9, 33, 35, 36, 41, and 42) . . . . .	X		2
18	A480-1	Boot . . . . .	X		1
19	MS3367-7-9	Ty-Rap . . . . .	X		1
20	MS3367-6-0	Ty-Rap . . . . .	X		1
21	A115-1	Spacer . . . . .	X		18
22	A769-3	Interrupter - Mag Pickup . . . . .	X		1
23	NAS6604-22	Bolt . . . . .	X		1
24	A214-3	Washer . . . . .	X		8
25	NAS6604-27	Bolt . . . . .	X		1
26	B163-1	Rod End . . . . .	X		2
27	NAS6604-17	Bolt . . . . .	X		6
		(Cont'd)			

X - Available as separate spares item  
0 - Available only as part of assembly

REV MAR 2004

7-15

# ROBINSON ILLUSTRATED PARTS CATALOG

MODEL R22

FIGURE AND INDEX NUMBER	PART NUMBER	DESCRIPTION	PARTS AVAIL	USABLE ON CODE	QTY PER ASSY
<b>SWASHPLATE ASSEMBLY</b> (Original equipment on Ship S/N 3539 and prior) (Cont'd)					
7-15-28	A204-1	Arm - Scissor . . . . .	X		2
29	NAS6604-15 to -31	Bolt (as required to show 2-4 threads) . . . . .	X		1
30	A210-1	Key . . . . .	X		1
31	A203-1	Yoke Assembly (Ref, superseded by item 45.)			
32	MS20470AD3-8	Rivet . . . . .	X		2
33	AN316-5R	Nut . . . . .	X		2
34	A205-1	Fork Assembly (Incl A205-2 fork and item 12) . . . . .	X		2
	A205-2	Fork (Ref, fork only) . . . . .	O		1
35	A258-2	Fitting . . . . .	X		1
36	21FKF616	Nut . . . . .	X		1
37	A258-3	Link (Ref) . . . . .	O		1
38	AN970-4	Washer . . . . .	X		A/R
39	NAS1304-30	Bolt . . . . .	X		4
40	NAS1149F0432P	Washer (or NAS1149F0463P) . . . . .	X		A/R
41	A258-4	Pitch Link Sub-Assembly (Includes items 9 [1], 33 [1], 37, 42 [1], and rivet, assembled.) . . . . .	X		1
42	B163-1	Rod End . . . . .	X		1
43	A769-2	Interrupter (Optional; For use with Strobex Model 135M-10 Series, not shown.) . . . . .	X		1
44	B149-1	Swashplate Ball Assembly (Ref, see Figure 7-19)			
45	A203-5	Yoke Half Assembly (Ref, includes A203-4 yoke half and item 48. Superseded by item 54.)			
	A203-4	Yoke Half (Ref, yoke half only)			
46	NAS1149F0432P	Washer ([2] required at this location) . . . . .	X		2
47	A205-3	Fork Assembly (Includes A205-4 fork and item 48.) . . . . .	X		1
	A205-4	Fork (Ref, fork only) . . . . .	O		1
48	B115-1	Bearing . . . . .	X		2
49	NAS1149F0432P	Washer (as required to show 2-4 threads; one minimum) . . . . .	X		A/R
50	A130-47	Spacer . . . . .	X		8
51	MS20995C32	0.032 in. dia Safety Wire . . . . .	X		A/R
52	NAS6604-24	Bolt . . . . .	X		1
53	NAS1149F0432P	Washer . . . . .	X		2
(Cont'd)					

7-16 X - Available as separate spares item  
O - Available only as part of assembly



# ROBINSON ILLUSTRATED PARTS CATALOG

MODEL R22

FIGURE AND INDEX NUMBER	PART NUMBER	DESCRIPTION	PARTS AVAIL	USABLE ON CODE	QTY PER ASSY
		<b>SWASHPLATE ASSEMBLY</b> (Original equipment on Ship S/N 3539 and prior) (Cont'd)			
7-15-54	A203-7*	Yoke Half Assembly (Includes A203-6 yoke half and item 48) . . . . .	X		2
	A203-6	Yoke Half (Ref, yoke half only) . . . . .	O		1
55	A283-2	Mast Assembly (Ref, for older R22's)			
56	A283-4	Mast Assembly (Ref, see Figure 5-1)			
57	AN970-4	Washer ([5] required at this location) . . . . .	X		5
*Must be installed in pairs. <u>Do not mix</u> A203-5 with A203-7 yoke halves.					

X - Available as separate spares item  
O - Available only as part of assembly

REV MAR 2004

7-17