

DCA-06-FR-004

**Norfolk Southern Collision
Derailment**

Train No. 226 & Train No. 22R

Lincoln, AL

January 18, 2006

**Derailment Engineering Drawing—
Accident scene**

4 pages, including cover

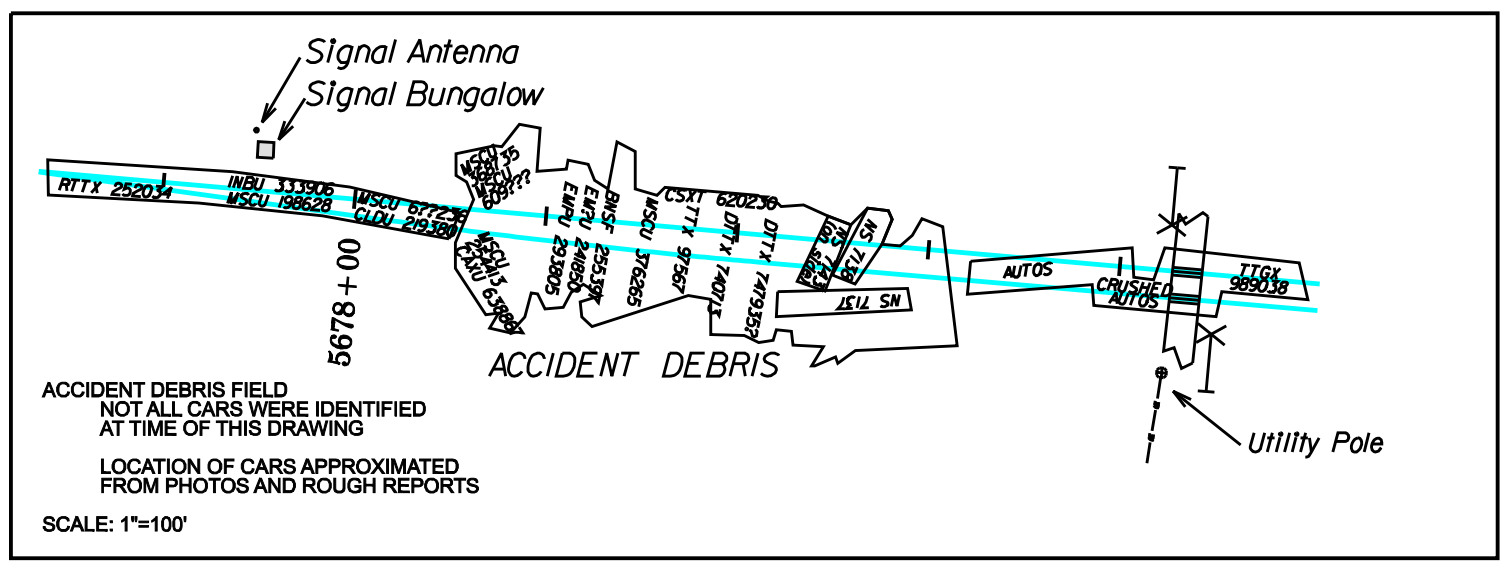
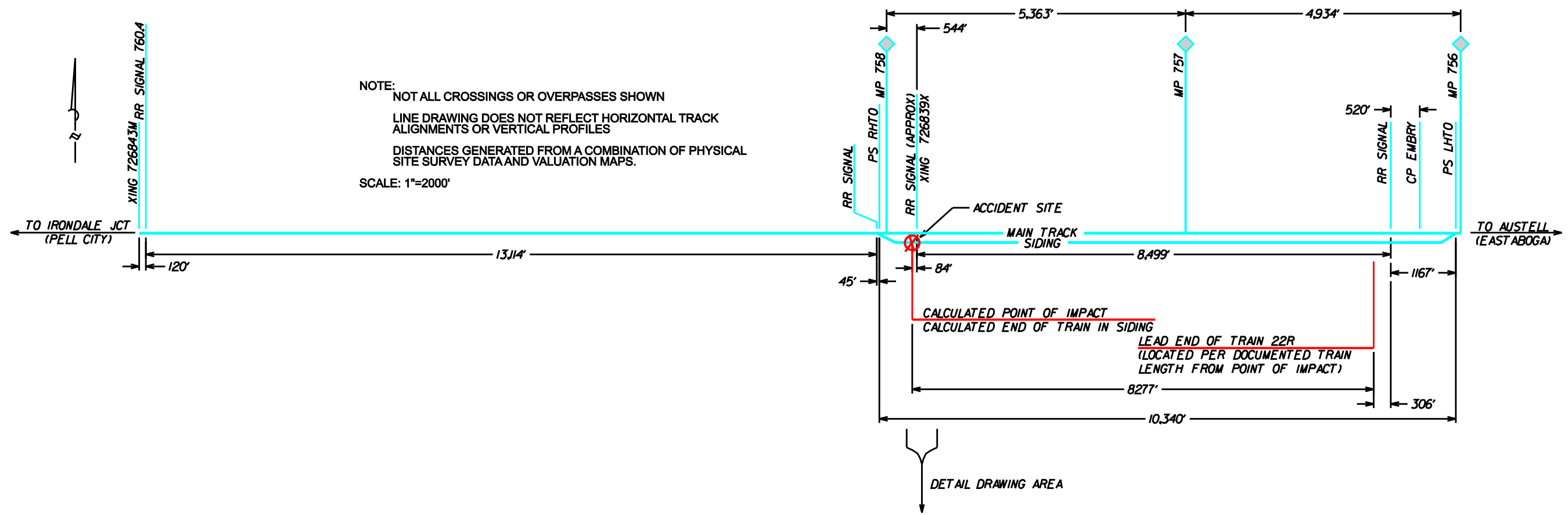

SCALE: NTS
 DO NOT SCALE THIS DRAWING FOR DIMENSIONS NOT GIVEN

NORFOLK SOUTHERN
 NORFOLK SOUTHERN RAILWAY COMPANY
 OWNING COMPANY
 ALABAMA
 OPERATING DIVISION
 OFFICE OF THE CHIEF ENGINEER - DESIGN AND CONSTRUCTION - ATLANTA, GA.

| | | | |
|--|------|-----------------------|--|
| 3 | JRT | 10/26/06 | CORRECTED SIGHT DISTANCE VALUES TRANSPONED ON R2 |
| 2 | JRT | 03/28/06 | ADDED PELL CITY AND RIVERSIDE SIGNAL DETAILS |
| 1 | JRT | 01/25/06 | ADDED SWITCHPOINT SIGHT DISTANCES |
| 1 | JRT | 01/25/06 | REVISED SIGNAL SIGHT DISTANCE LOCATION |
| REV BY | DATE | DESCRIPTION | |
| LOCATION RIVERSIDE, ALABAMA | | | |
| TITLE JANUARY 18, 2006 ACCIDENT REPORT DRAWING | | | |
| DGN | JRT | PID No. D738 | VRN 062300A MILE POST 758 |
| OWN | JRT | FILE No. 107-1-1119 | DRAWING NUMBER |
| CHK | DAB | DATE JANUARY 20, 2006 | TB-2006-3 R3 |

EASTBOUND SITE DISTANCE TO SIGNAL 758.1

NOTE:
 DETAILED DRAWING CREATED FROM PHYSICAL SITE SURVEY PERFORMED JANUARY 19, 2006. DUE TO ONGOING RECOVERY EFFORTS SOME TRACK DETAILS IN ACCIDENT DEBRIS AREA ARE RE-ESTABLISHED FROM KNOWN POINTS.
 SCALE 1"=200'

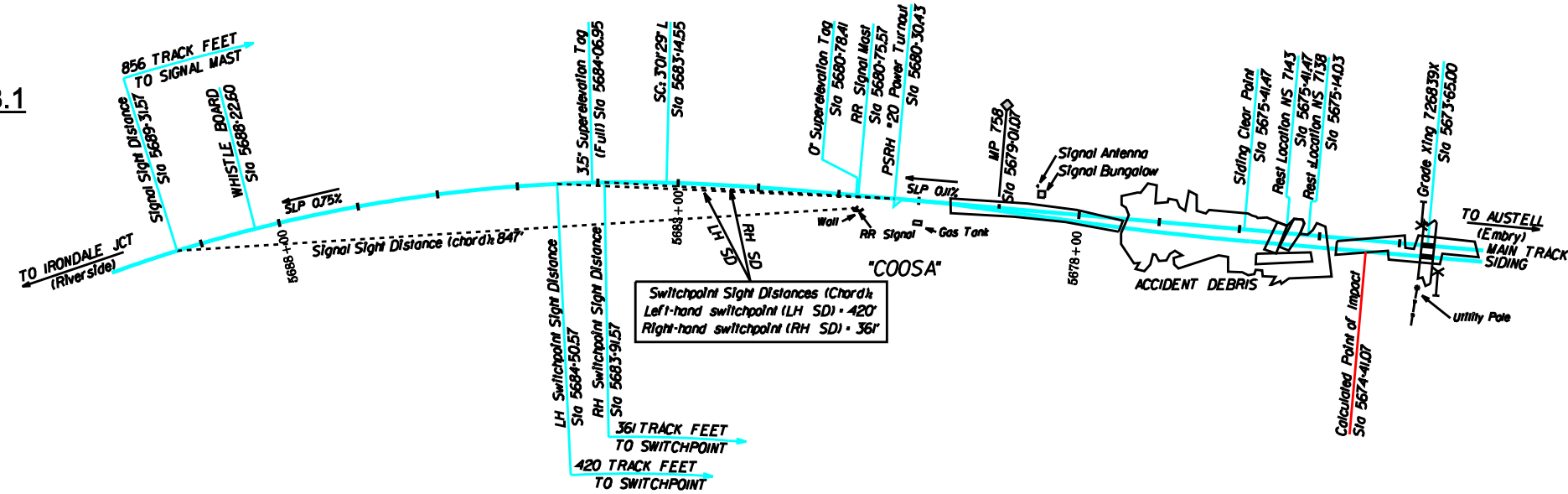

EASTBOUND SITE DISTANCE TO SIGNAL 760.5

NOTE:
 DETAILED DRAWING CREATED FROM PHYSICAL SITE SURVEY PERFORMED JANUARY 31, 2006.
 SCALE 1"=200'

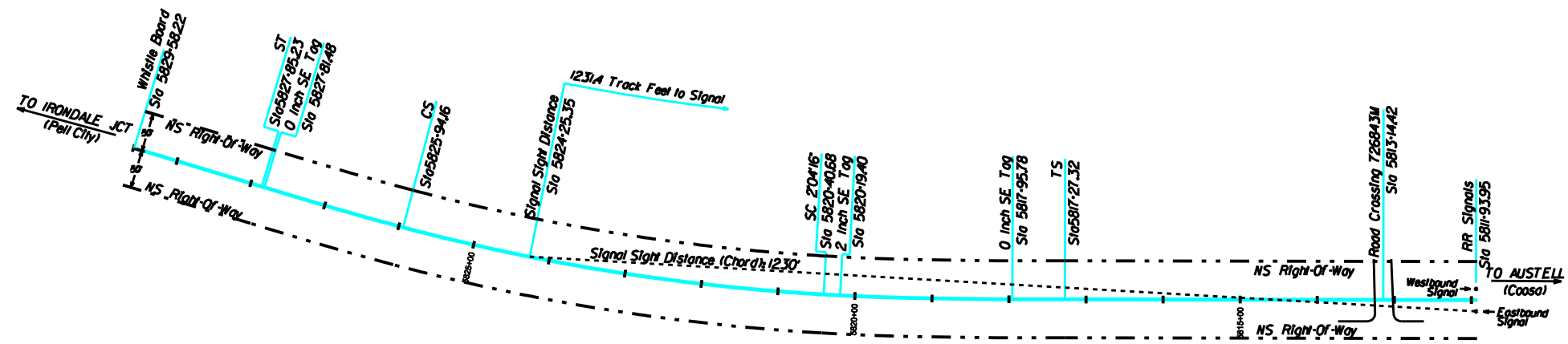

EASTBOUND SITE DISTANCE TO SIGNAL 762.9

NOTE:
 DETAILED DRAWING CREATED FROM PHYSICAL SITE SURVEY PERFORMED MARCH 28, 2006.
 SCALE 1"=200'

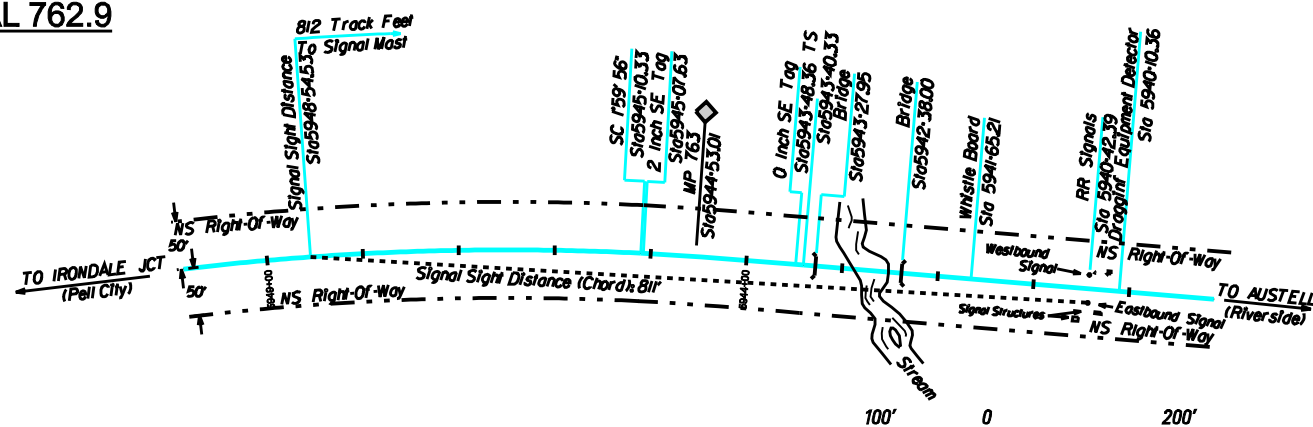

SCALE: 1"=200' DO NOT SCALE THIS DRAWING FOR DIMENSIONS NOT GIVEN

| | | | |
|---|------|-----------------------|--|
| 3 | JRT | 10/26/06 | CORRECTED SIGHT DISTANCE VALUES TRANSPONED ON R2 |
| 2 | JRT | 03/28/06 | ADDED PELL CITY AND RIVERSIDE SIGNAL DETAILS |
| 1 | JRT | 01/25/06 | ADDED SWITCHPOINT SIGHT DISTANCES |
| 1 | JRT | 01/25/06 | REVISED SIGNAL SIGHT DISTANCE LOCATION |
| REV BY | DATE | DESCRIPTION | |
| LOCATION: RIVERSIDE, ALABAMA | | | |
| TITLE: JANUARY 18, 2006 ACCIDENT REPORT DRAWING | | | |
| DGN | JRT | PID No. D738 | VRN 062300A MILE POST 758 |
| DWN | JRT | FILE No. 107-1-1119 | DRAWING NUMBER |
| CHK | DAB | DATE JANUARY 20, 2006 | TB-2006-3 R3 |