

EXTRACT

MODEL 172RG SERVICE MANUAL

SECTION 11

ENGINE

WARNING

When performing any inspection or maintenance that requires turning on the master switch, installing a battery, or pulling the propeller through by hand, treat the propeller as if the ignition switch were ON. Do not stand, nor allow anyone else to stand, within the arc of the propeller, since a loose or broken wire, or a component malfunction, could cause the propeller to rotate.

TABLE OF CONTENTS	Page No. Aerofiche/ Manual		
ENGINE COWLING	2A4/11-3	OIL SYSTEM	2A18/11-17
Description	2A4/11-3	Description	2A18/11-17
Removal/Installation	2A4/11-3	Trouble Shooting	2A21/11-20
Cleaning/Inspection	2A4/11-3	Full-Flow Oil Filter	2A24/11-23
Repair	2A4/11-3	Description	2A24/11-23
COWL FLAPS	2A4/11-3	Removal/Installation	2A24/11-23
Description	2A4/11-3	Oil Cooler	2A24/11-23
Removal/Installation	2A4/11-3	Description	2A24/11-23
Rigging	2A7/11-6	ENGINE FUEL SYSTEM	2A24/11-23
ENGINE	2A7/11-6	Description	2A24/11-23
Description	2A7/11-6	Carburetor	2A24/11-23
Time Between Overhaul (TBO)	2A7/11-6	Removal/Installation	2A24/11-23
Overspeed Limitations	2A7/11-6	Idle Speed and Mixture	
Engine Data	2A7/11-6	Adjustments	2A24/11-23
Trouble Shooting	2A9/11-8	INDUCTION AIR SYSTEM	2B1/11-24
Removal	2A12/11-11	Description	2B1/11-24
Cleaning	2A14/11-13	Installation of Induction	
Accessories Removal	2A14/11-13	Air System Ducts	2B2/11-24A
Inspection	2A14/11-13	Airbox	2B2/11-24A
Build-Up	2A14/11-13	Removal/Installation	2B2/11-24A
Installation	2A14/11-13	Cleaning/Inspection	2B3/11-25
Flexible Fluid Hoses	2A16/11-15	Induction Air Filter	2B3/11-25
Leak Test	2A16/11-15	Description	2B3/11-25
Replacement	2A16/11-15	Removal/Installation	2B3/11-25
Static Run-Up Procedures	2A16/11-15	Cleaning/Inspection	2B3/11-25
Engine Baffles	2A17/11-16	IGNITION SYSTEM	2B3/11-25
Description	2A17/11-16	Description	2B3/11-25
Cleaning/Inspection	2A17/11-16	Trouble Shooting	2B3/11-25
Removal/Installation	2A17/11-16	Magnetos (Slick 4191)	2B5/11-27
Repair	2A17/11-16	Description	2B5/11-27
Engine Mount	2A17/11-16	Removal/Installation	2B5/11-27
Description	2A17/11-16	Internal Timing	2B5/11-27
Removal/Installation	2A18/11-17	Magneto-to-Engine-Timing	2B5/11-27
Repair	2A18/11-17	Maintenance	2B7/11-29
Painting	2A18/11-17	Magnetos (Slick 4251)	2B7/11-29
Engine Shock-Mount Pads	2A18/11-17	Description	2B7/11-29

MODEL 172RG SERVICE MANUAL

Removal/Installation	2B8/11-30
Magneto-to-Engine-	
Timing	2B8/11-30
Maintenance	2B8/11-30
Disassembly	2B9/11-30A
Contact Assembly Check	2B9/11-30A
Points	2B9/11-30A
Carbon Brush	2B9/11-30A
High Tension Lead	2B9/11-30A
Impulse Coupling Shell	
and Lead	2B9/11-30A
Cleaning/Inspection	2B9/11-30A
Reassembly	2B9/11-30A
Magneto Check	2B10/11-31
Spark Plugs	2B10/11-31
ENGINE CONTROLS	2B10/11-31
Description	2B10/11-31
Rigging	2B11/11-32
➔ Throttle Control	2B11/11-32

Mixture Control	2B13/11-34
Carburetor Heat Control	2B13/11-34
Propeller Control	2B13/11-34
STARTING SYSTEM	2B13/11-34
Description	2B13/11-34
Trouble Shooting	2B14/11-35
Primary Maintenance	2B15/11-36
Starter Motor	2B15/11-36
Removal/Installation	2B15/11-36
EXHAUST SYSTEM	2B16/11-37
Description	2B16/11-37
Removal/Installation	2B16/11-37
Inspection	2B16/11-37
EXTREME WEATHER	
MAINTENANCE	2B18/11-39
Cold Weather	2B18/11-39
Dusty Conditions	2B19/11-40
Seacoast and Humid Areas	2B19/11-40

MODEL 172RG SERVICE MANUAL

- 11-76. **RIGGING.** When adjusting any engine control it is important to check that the control slides smoothly throughout its full range of travel, that it locks securely if equipped with a locking device and the arm or lever it operates moves through its full arc of travel.

CAUTION

Whenever engine controls are being disconnected, pay particular attention to the **EXACT** position, size and number of attaching washers and spacers. Be sure to install attaching parts as noted when connecting controls.

NOTE

Refer to the inspection chart in Section 2 for inspection, replacement and/or lubrication interval for the throttle control.

11-77. THROTTLE CONTROL.

NOTE

Before rigging throttle control, check that control end (13) is secure. If any indication of looseness or breakage is apparent, replace throttle control.

- a. Screw friction lock nut (2) into threads of barrel (7).
- b. Ensure washer (5) and nut (6) on forward side of panel are secure.
- c. Push knob assembly (1) full in against friction lock nut (2), then pull knob assembly out approximately 1/8-inch to obtain "cushion."
- d. Tighten friction lock nut (2) against barrel (7).
- e. At the carburetor, attach throttle arm hardware to rod end (16).

NOTE

Ensure palnut (17) is on threads of plunger (18) before installing rod end (16).

- f. Screw rod end (16) up threads of plunger (18) until throttle arm contacts full power stop; secure rod end with palnut (17).

NOTE

→ Ensure that rod end (16) is threaded on to plunger (18) so that .020-inch safety wire cannot be installed through drilled hole in rod end.

- g. Check control end (13) clamping in bracket (12) and clamp (15).
- h. Pull knob assembly full out and check that idle stop on carburetor is contacted.
- i. Work throttle control in and out several times to check for binding.

MODEL 172RG SERVICE MANUAL

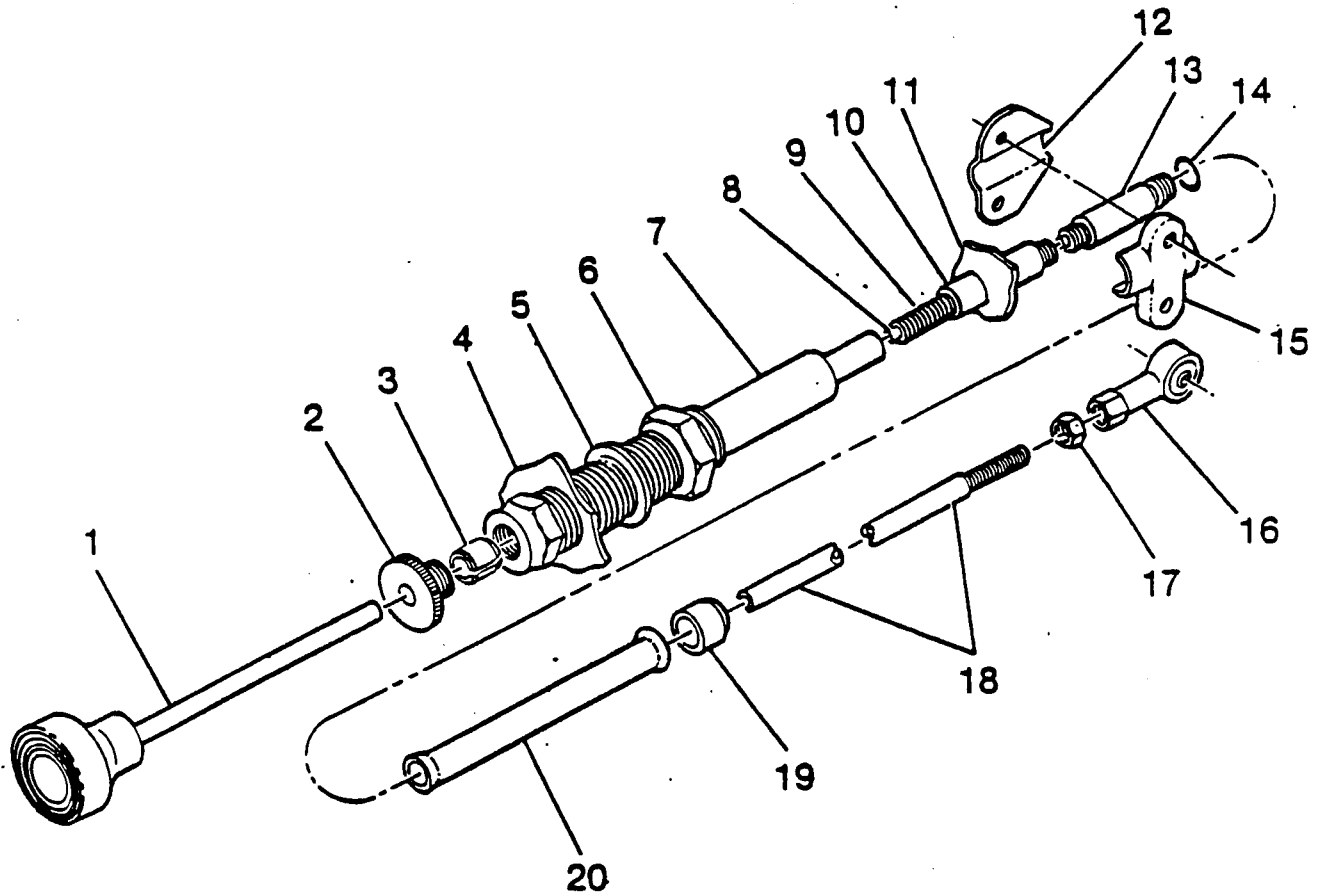

1. Knob Assembly
2. Friction Lock Nut
3. Locking Collet
4. Instrument Panel
5. Washer
6. Nut
7. Barrel
8. Core
9. Casing
10. Clamping Sleeve
11. Firewall
12. Bracket
13. Control End
14. Packing
15. Clamp
16. Rod End
17. Palnut
18. Plunger
19. Plunger Seal
20. Plunger Guide

Note serrated faces of throttle arm and stop.

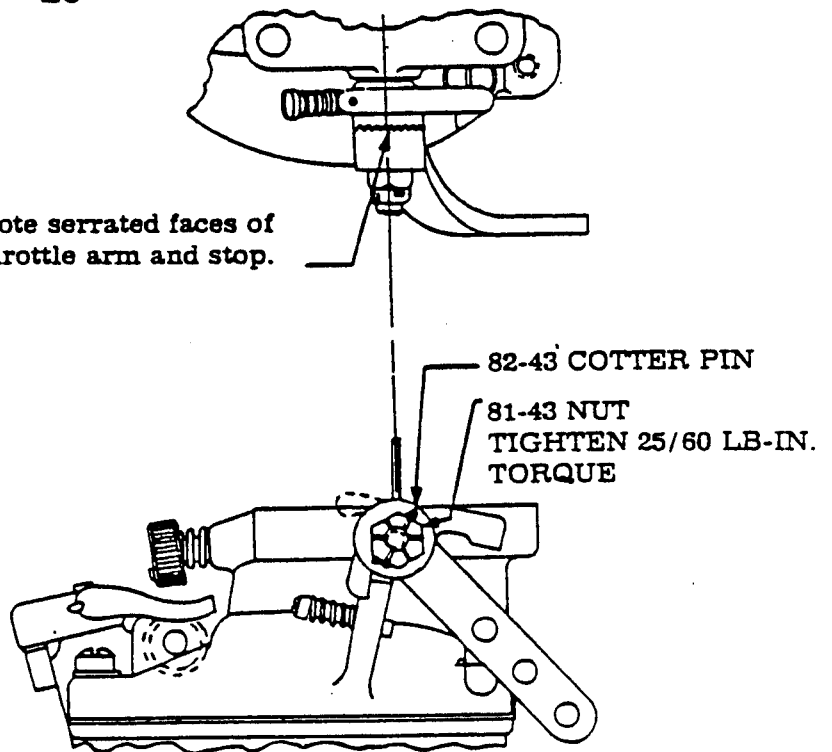

Figure 11-3. Throttle Control and Throttle Arm to Idle Stop Adjustment