

210 & T210 Parts Catalog

Hydraulic System (Cont)

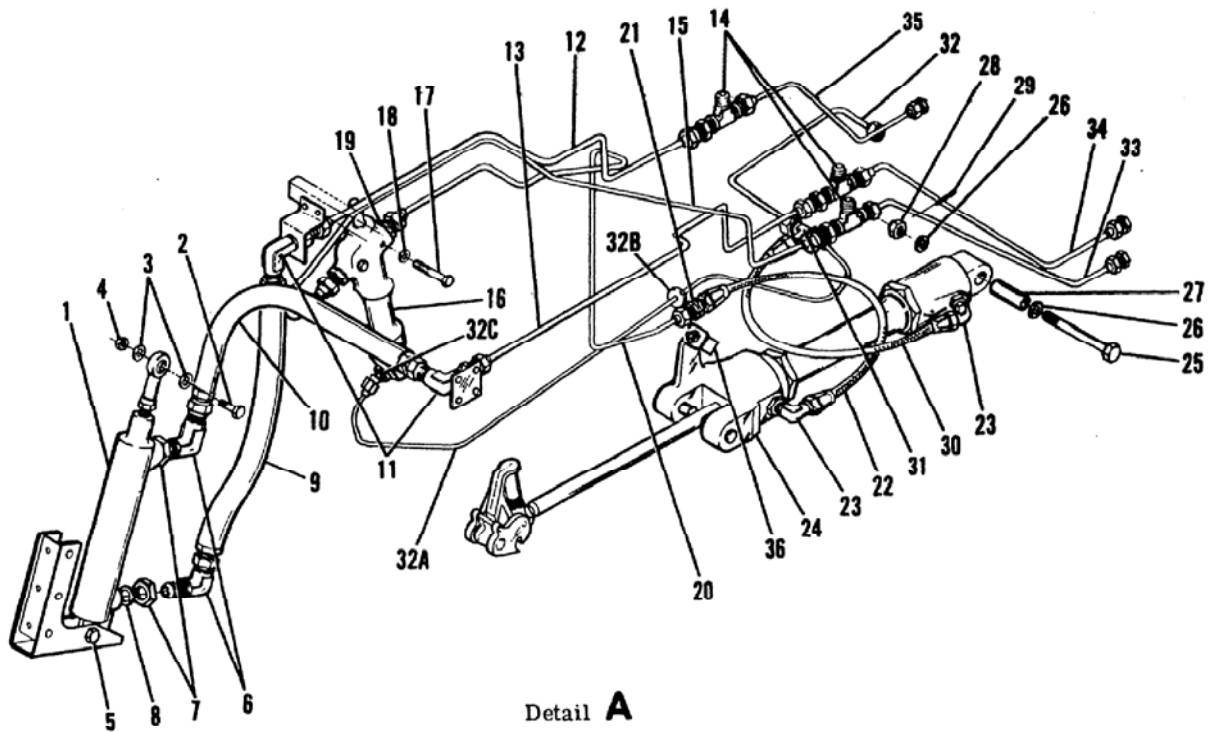
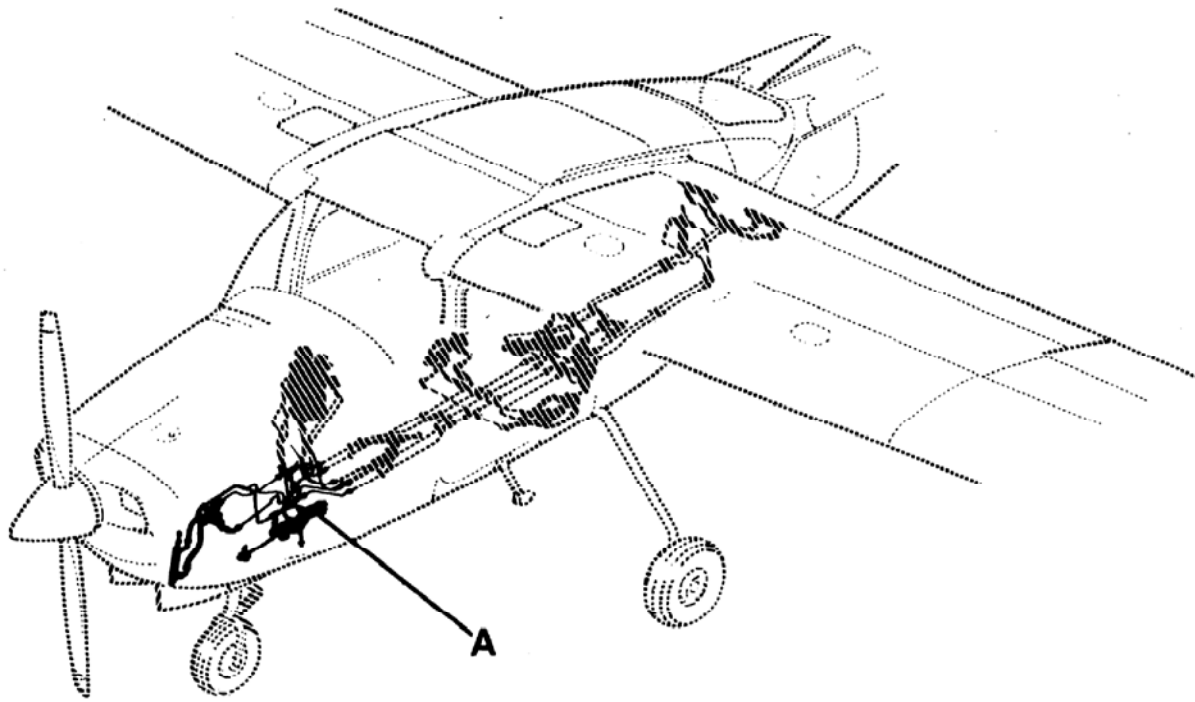

Detail **A**

210 & T210 SERIAL 21059503 THRU 21061694

Figure 122A. Nose Gear Hydraulic System

210 & T210 Parts Catalog

FIGURE AND INDEX NO.	PART NUMBER	DESCRIPTION	UNITS PER ASSY	USABLE ON CODE
		1 2 3 4 5 6 7		
122A-		HYDRAULIC SYSTEM--NOSE GEAR -----	NP	A
- 1	SEE FIG 128	ACTUATOR--NOSE GEAR DOORS -----	1	
		ATTACHING PARTS -----		
- 2	AN3-7A	BOLT -----	1	
- 3	AN960-10	WASHER -----	AR	
- 4	MS21044N3	NUT -----	1	
- 5	AN3-13A	BOLT -----	1	
	AN960-10L	WASHER -----	2	
	NAS43HT3-19	SPACER -----	1	
	MS21044N3	NUT -----	1	
		-----*		
- 6	AN833-40	ELBOW -----	2	
- 7	AN924-40	NUT -----	2	
- 8	MS28778-4	PACKING -----	2	
- 9	S2178-4-0095A	HOSE ASSEMBLY--DOOR OPEN -----	1	
-10	S2178-4-0126A	HOSE ASSEMBLY--DOOR CLOSE -----	1	
-11	AN833-40	ELBOW -----	2	
	AN960PD716	WASHER -----	4	
	AN924-40	NUT -----	2	
-12	1280506-126	LINE ASSEMBLY--DOOR OPEN -----	1	
-13	1280506-125	LINE ASSEMBLY--DOOR CLOSE -----	1	
-14	AN804-40	TEE -----	3	
	AN960PD716	WASHER -----	6	
	AN924-40	NUT -----	3	
-15	1280509-53	LINE ASSEMBLY--GEAR DOWN -----	1	
-16	SEE FIG 131A	ACTUATOR ASSEMBLY--UNLOCK -----	1	
		ATTACHING PARTS -----		
-17	AN4-14A	BOLT -----	2	
-18	AN960-416	WASHER -----	2	
	MS21042L4	NUT -----	2	
		-----*		
-19	AN919-2D	REDUCER -----	1	
	MS28778-4	O RING -----	1	
-20	1280506-128	LINE ASSEMBLY--GEAR DOWN -----	1	
-21	AN832-3D	UNION -----	1	
	AN924-3D	NUT -----	1	
	AN960PD616	WASHER -----	1	
-22	S2178-3-0144	HOSE ASSEMBLY--GEAR DOWN -----	1	
-23	AN833-3D	ELBOW -----	2	
	AN924-3D	NUT -----	2	
	MS28778-3	PACKING -----	2	
-24	SEE FIG 126A	ACTUATOR ASSEMBLY--NOSE GEAR -----	1	
		ATTACHING PARTS -----		
-25	NAS464P7-42	BOLT -----	1	
-26	AN960-716L	WASHER -----	2	
-27		BUSHING--ACTUATOR -----	NP	
-28	AN320-7	NUT -----	1	
-29	MS24665-136	PIN--COTTER -----	1	
		-----*		
-30	S2178-3-0122	HOSE ASSEMBLY--GEAR UP -----	1	
-31	AN804D3	TEE -----	1	
	AN924-3D	NUT -----	1	
	AN960PD616	WASHER -----	2	
-32	1280506-54	LINE ASSEMBLY--GEAR UP -----	1	
-32A	1280509-75	LINE ASSEMBLY--GEAR UP -----	1	
-32B	MS35489-5	GROMMET -----	1	
-32C	AN919-2D	REDUCER -----	1	
	MS28778-4	PACKING -----	1	
-33	1280509-54	LINE ASSEMBLY--GEAR DOWN -----	1	
-34	1280506-138	LINE ASSEMBLY--DOOR CLOSE -----	1	
-35	1280506-139	LINE ASSEMBLY--DOOR OPEN -----	1	
-36	SL377-1	SWITCH--DOWNLOCK -----	1	
		NOTE. %WHEN ORDERING THIS PART FOR AIRCRAFT SERIAL 21059503 THRU 21061039 ALSO ORDER ALL PARTS MARKED %.		
		NOTE. %%THIS PART IS NOT AVAILABLE FOR SPARES, FOR REPLACEMENT ORDER ALL PARTS MARKED %.		
		A---210 & T210 SERIAL 21059503 THRU 21061694		