

ISLAND LADY Top Deck Safety Equipment Locations

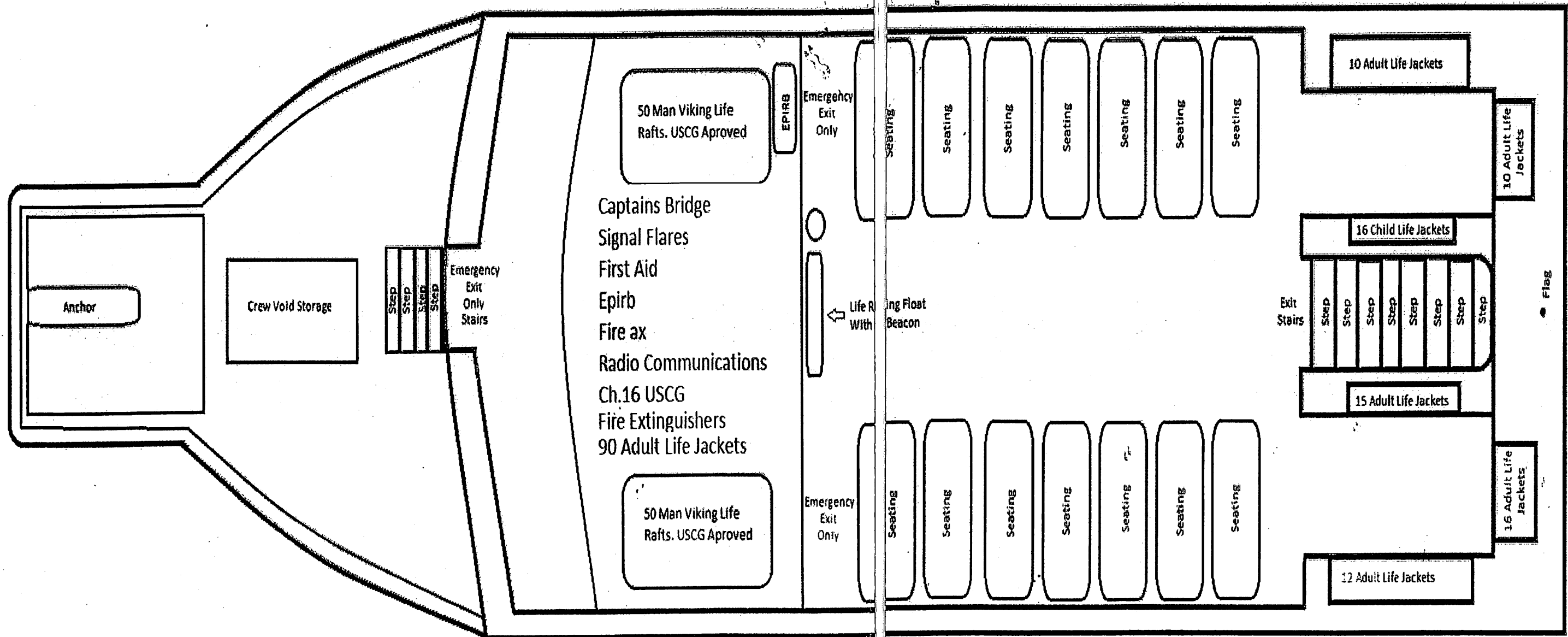

Life Jackets Are located On the Top Deck In Bridge And Stern Of Vessel
154 Adult and 16 Child.

ISLAND LADY Main Deck Safety Equipment Locations

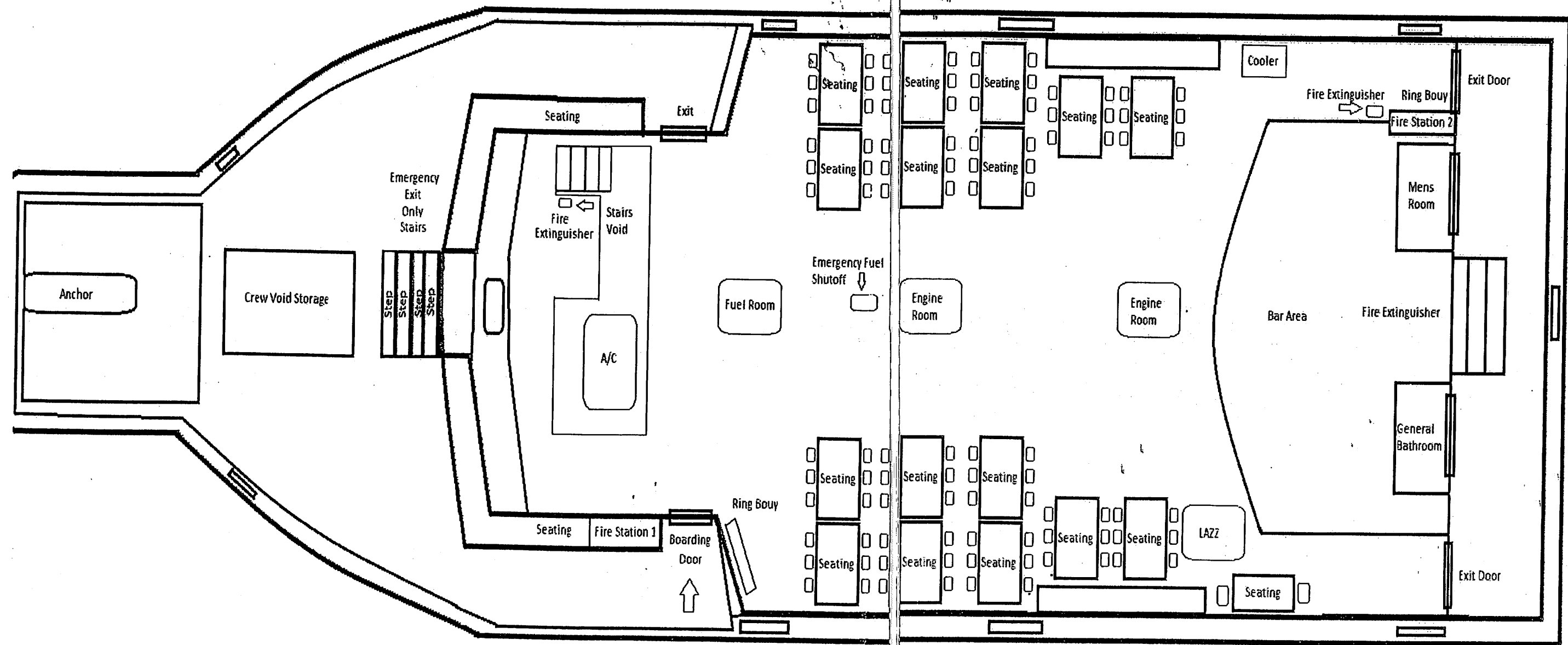

Life Jackets Are located On the Top Deck In Bridge And Stern Of Vessel
154 Adult and 16 Child

**ISLAND LADY
*** SAFETY ANNOUNCEMENTS*****

LADIES AND GENTLEMEN WELCOME ABOARD THE "ISLAND LADY" OF PORT RICHEY CASINO. AT THIS TIME MAY WE HAVE YOUR ATTENTION FOR A BRIEF SAFETY ANNOUNCEMENT...

FOR YOUR SAFETY, AND IN THE UNLIKELY EVENT OF AN EMERGENCY, LIFE JACKETS ARE LOCATED ON THE TOP DECK IN THE LIFE-JACKET LOCKERS.

LIFE RAFTS ARE LOCATED ON TOP OF THE VESSEL, FIRE EXTINGUISHERS ARE LOCATED THROUGHOUT THE VESSEL AND A FIRST AID KIT IS LOCATED ON THE BRIDGE.

PLEASE REMEMBER THIS VESSEL IS ALWAYS SUBJECT TO CONSTANT MOTION, SO PLEASE USE CAUTION WHEN MOVING ABOUT THE VESSEL AND PLEASE USE THE HAND RAILS WHENEVER POSSIBLE.

ALSO, PLEASE REMEMBER THAT SMOKING IS NOT PERMITTED INSIDE THIS VESSEL, HOWEVER SMOKING IS PERMITTED ON THE TOP DECK.

ON BEHALF OF THE CAPTAIN & THE CREW, WE WOULD LIKE TO THANK YOU FOR SAILING WITH US ABOARD THE "ISLAND LADY" OF PORT RICHEY CASINO AND WE WISH GOOD LUCK TO ALL PLAYERS.

ISLAND LADY

Engine Room Daily Check List

DAY:

DATE:

Name:

24Volt CCW	3406 Caterpillar Main Motors	DEIO400 SAE15W40
CAT TDTO Transmission Fluid		

STARBOARD MAIN

- EIC Coolant Added
- Oil Added
- Trans Fluid Added
- Sea Strainers Cleaned
- Belts Ok
- Hoses Ok
- Visual Inspection

PORT MAIN

- EIC Coolant Added
- Oil Added
- Trans Fluid Added
- Sea Strainers Cleaned
- Belts Ok
- Hoses Ok
- Visual Inspection

Dont Just Check off the Lines, Actually do it and put down how much Added, Complete Every Morning

12 Volt	Kubota Generators	DEIO400 SAE15W40
---------	-------------------	------------------

STARBOARD GENERATOR

- Water Added
- Oil Added
- Sea Strainers Cleaned
- Hoses Ok
- Visual Inspection

PORT GENERATOR

- Water Addec
- Oil Added
- Sea Strainers Cleaned
- Hoses Ok
- Visual Inspection

Notes will be written down and read everyday by proceeding Engineer the next day, No Exeptions

General Check List

- | | |
|---|---|
| <ul style="list-style-type: none"> <input type="checkbox"/> Fuel Level Tank 1 <input type="checkbox"/> Tank 2 <input type="checkbox"/> Tank 3 <input type="checkbox"/> <input type="checkbox"/> A/C Strainers Bow/Stern Cleaned <input type="checkbox"/> A/C Filters Checked <input type="checkbox"/> Check Voids For Water <input type="checkbox"/> Empty Sewage 3 Miles <input type="checkbox"/> Bilges Clean <input type="checkbox"/> Tools Organized <input type="checkbox"/> Order Stock <input type="checkbox"/> Resupply Oil 15w 40 <input type="checkbox"/> Refuel Diesel Can <input type="checkbox"/> Clean Engine Room | <ul style="list-style-type: none"> <input type="checkbox"/> Check Steering Fluid <input type="checkbox"/> Check Fresh Water Filter <input type="checkbox"/> Take Inventory <input type="checkbox"/> Take Out Trash <input type="checkbox"/> Wipe Down Motors |
| <p>Notes: _____</p> <p>_____</p> <p>_____</p> <p>_____</p> | |

ISLAND LADY

Time Departed:

Time Arrived:

Tide:

DAY:	DATE:	DEIO400 SAE15W40
------	-------	------------------

CAPTAIN: _____

CREW: _____

WEATHER: _____

EMPLOYEES: _____

PASSENGERS: _____

TOTAL: _____

LITTLE BANK INSPECTION

STRB MAIN

PORT MAIN

_____ RPM
_____ Temperature
_____ Oil PSI
_____ Trans Temp
_____ Trans PSI
_____ Load
_____ Fuel

STRB GEN

PORT GEN

_____ Temperature

FUEL TANKS 1 _____ 2 _____ 3 _____

WATER TANK _____

Time Departed:

Time Arrived:

Tide:

DAY:	DATE:	DEIO400 SAE15W40
------	-------	------------------

CAPTAIN: _____

CREW: _____

WEATHER: _____

EMPLOYEES: _____

PASSENGERS: _____

TOTAL: _____

LITTLE BANK INSPECTION

STRB MAIN

PORT MAIN

_____ RPM
_____ Temperature
_____ Oil PSI
_____ Trans Temp
_____ Trans PSI
_____ Load
_____ Fuel

STRB GEN

PORT GEN

_____ Temperature

FUEL TANKS 1 _____ 2 _____ 3 _____

WATER TANK _____